

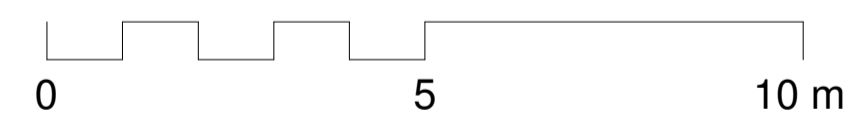

Photos (1)
Existing elevation to the lightwell.
Windows to be replaced by aluminium louvres indicated by red boundaries.

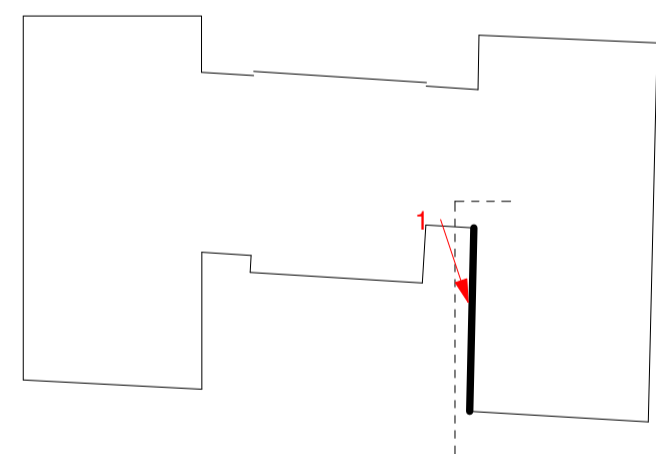

Notes

1. Do not scale this drawing.
2. All dimensions must be checked on site and any discrepancies verified with the architect.
3. Unless shown otherwise, all dimensions are to structural surfaces.
4. Drawing to be read with all other issued information. Any discrepancies to be brought to the attention of the architect.
5. This drawing is the copyright of Levitt Bernstein and may not be copied, altered or reproduced in any form, or passed to a third party without license or written consent.

This is not a construction drawing, it is unsuitable for the purpose of construction and must on no account be used as such.

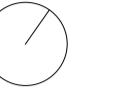

Two existing windows overlooking the internal lightwell to be replaced by aluminium louvres (reversible)

DESIGN INTENT: These are design intent drawings and do not show full construction information. The Contractor must develop the details, without changing the visual, spatial or other performances, to provide a fully developed scheme including all concealed components such as wind posts, vapour barriers and cavity barriers. All dimensions on this drawing are taken to finished surfaces unless specifically indicated on the dimensions itself.

Rev	Date	Description	Initials
T1	27.06.17	Tender Issue	ID
P1	16.06.17	Preliminary Issue	ID

Project name

UCL Agile 2

Drawing number	Rev
3437 - L - 240	T1

Drawing

Existing Elevation

Purpose of issue	Date
Tender Issue	27/06/17
Scale	Drawn
1 : 100 @ A1	ID
Client	Checked
University College London	TG

London
1 Kingsland Passage
London E8 2BB
+44 (0)20 7275 7676

Manchester
3rd HQ Building
2 Atherton Street
Manchester M3 3GS
+44 (0)16 1669 8740

Levitt Bernstein
levittbernstein.co.uk