

General notes:
 This drawing is copyright of KSR architects. This drawing must be read in conjunction with the Designer's Risk Assessment, specification and all other relevant documentation and drawings. KSR architects accept no liability for any expense, loss or damage of whatsoever nature and however arising from any variation made to this drawing or in the execution of the work to which it relates which has not been referred to them and their approval obtained.
 Do not scale from this drawing or the digital data, only figured dimensions are to be used. For Planning refer to linear scale. Check all dimensions on site prior to carrying out any works - advise any discrepancy

Notes/Legends

Key:
 - - - - - Line of existing building

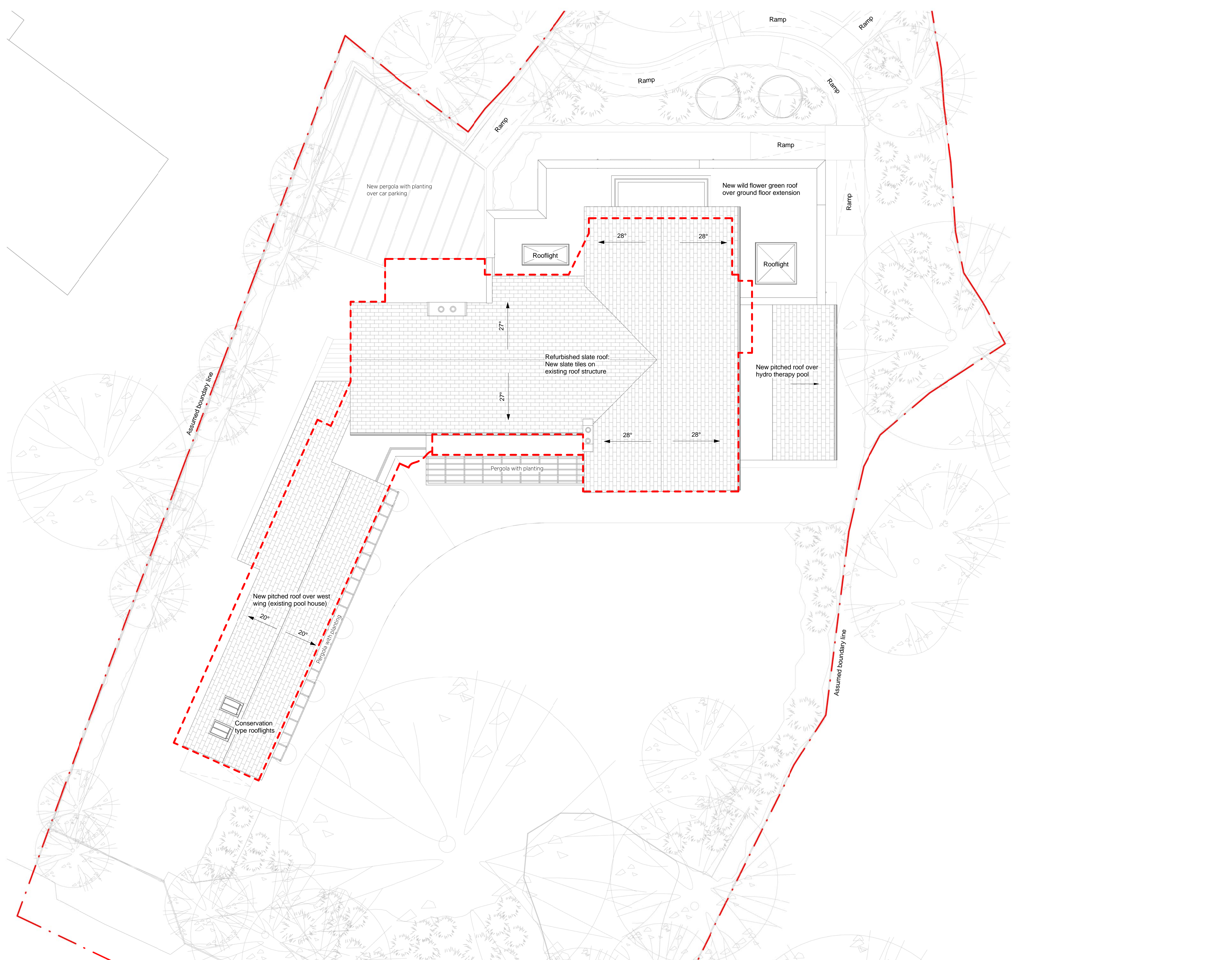

A Planning Application 26/06/2017
 Risk Description Date CHD

© KSR architects
 Stamp:

PLANNING

Key Plan



KSRARCHITECTS
 KSR Architects LLP
 14 Gower Street
 London WC1E 6BT
 Email: info@ksrarchitects.com
 Tel: +44 (0)20 7692 5000
 Website: www.ksrarchitects.com

Project:
THE WATER HOUSE

Title:
Proposed Roof Plan

Date: 05/02/17 Drawn By: IT Checked: RM

Scale: 1:100 Sheet: A1 Status: Planning

Project Ref: 17007 Drawing No: 17007-P190 Revision: A

1 Proposed Roof
 1:100 @ A1

