

EXISTING MATERIALS

- Concrete interlocking roof tiles (Redland 49 or similar)
- Brick-on-edge party wall parapets, rendered front elevation parapet
- Lead lined valley gutter
- Lead abutment flashings
- Black plastic RW hopper and downpipes
- Black plastic SVPs
- Lead covered access hatch

PROPOSED MATERIALS

- Marley Eternit fibre-cement slates, size 600 x 300mm, colour: Blue Black
- Precast concrete copings to party walls, painted rendered front elevation parapets (render repairs as necessary)
- Lead lined valley gutter
- Lead abutment flashings
- Black plastic RW hopper and downpipes
- Black plastic SVPs
- Lead covered access hatch

A COPINGS OMITTED TO STREET ELEVATION PARAPET 7/17

Do not scale this drawing. All dimensions to be checked by the Contractor before construction proceeds.  
© Randall Shaw Billingham

**RANDALL SHAW BILLINGHAM**  
Architects Energy Consultants Planners  
54 Harcombe Road London N16 0SA  
e-mail : [rsb@randallshaw.co.uk](mailto:rsb@randallshaw.co.uk)  
tel : 020 7254 7472

JOB TITLE  
CAMDEN MAJOR REPAIRS

DWG TITLE  
101 - 103 ROYAL COLLEGE STREET  
ROOF PLAN

SCALE	1: 50 @ A3	DWN.	bs
DATE	05/ 17	CHK.	kr
DWG NO.	254/ 06	REV.	A

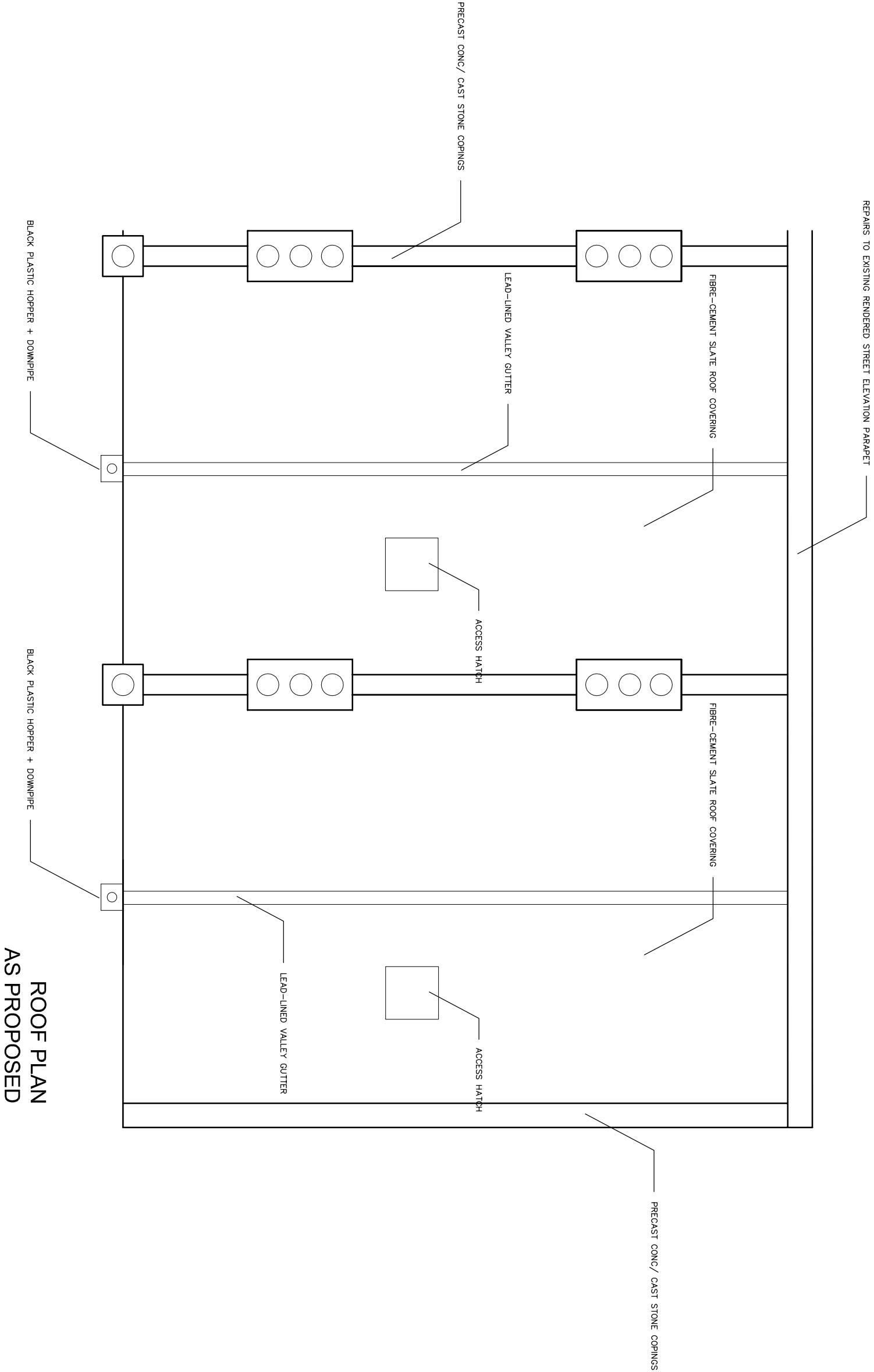

ROOF PLAN  
AS PROPOSED

