



© THE BRITISH LIBRARY BOARD. ALL RIGHTS RESERVED. Licence No:8048

0 100 m



## Historical Aerial Photography

Published 1946

Source map scale - 1:1,250

The Historical Aerial Photos were produced by the Ordnance Survey at a scale of 1:1,250 and 1:10,560 from Air Force photography. They were produced between 1944 and 1951 as an interim measure, pending preparation of conventional mapping, due to post war resource shortages. New security measures in the 1950's meant that every photograph was re-checked for potentially unsafe information with security sites replaced by fake fields or clouds. The original editions were withdrawn and only later made available after a period of fifty years although due to the accuracy of the editing, without viewing both revisions it is not easy to spot the edits. Where available Landmark have included both revisions.

© THE BRITISH LIBRARY BOARD. ALL RIGHTS RESERVED. Licence No:8048

### Map Name(s) and Date(s)

TQ2685SE TQ2785SW  
1946 1946  
1:1,250 1:1,250  
TQ2684NE TQ2784NW  
1946 1946  
1:1,250 1:1,250  
TQ2684SE TQ2784SW  
1946 1946  
1:1,250 1:1,250

### Historical Aerial Photography - Segment A13

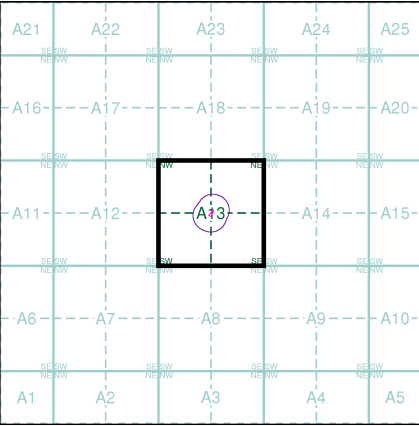

### Order Details

Order Number: 117160731\_1\_1  
Customer Ref: J17062  
National Grid Reference: 526930, 184810  
Slice: A  
Site Area (Ha): 0.05  
Search Buffer (m): 100

### Site Details

The Coach House, 50A Belsize Square, LONDON, NW3 4HN



Tel: 0844 844 9952  
Fax: 0844 844 9951  
Web: www.envirocheck.co.uk





## Ordnance Survey Plan

Published 1954

Source map scale - 1:1,250

The historical maps shown were reproduced from maps predominantly held at the scale adopted for England, Wales and Scotland in the 1840's. In 1854 the 1:2,500 scale was adopted for mapping urban areas and by 1896 it covered the whole of what were considered to be the cultivated parts of Great Britain. The published date given below is often some years later than the surveyed date. Before 1938, all OS maps were based on the Cassini Projection, with independent surveys of a single county or group of counties, giving rise to significant inaccuracies in outlying areas.

## Map Name(s) and Date(s)

TQ2685SE	Q2785SW
1954	954
1:1,250	1:1,250
TQ2684NE	Q2784NW
1954	954
1:1,250	1:1,250
TQ2684SE	Q2784SW
1954	954
1:1,250	1:1,250

## Historical Map - Segment A13

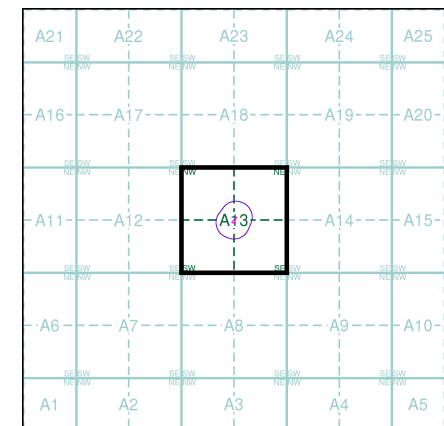

## Order Details

Order Number: 117160731\_1\_1  
 Customer Ref: J17062  
 National Grid Reference: 526930, 184810  
 Slice: A  
 Site Area (Ha): 0.05  
 Search Buffer (m): 100

## Site Details

The Coach House, 50A Belsize Square, LONDON, NW3 4HN



Tel: 0844 844 9952  
 Fax: 0844 844 9951  
 Web: www.envirocheck.co.uk



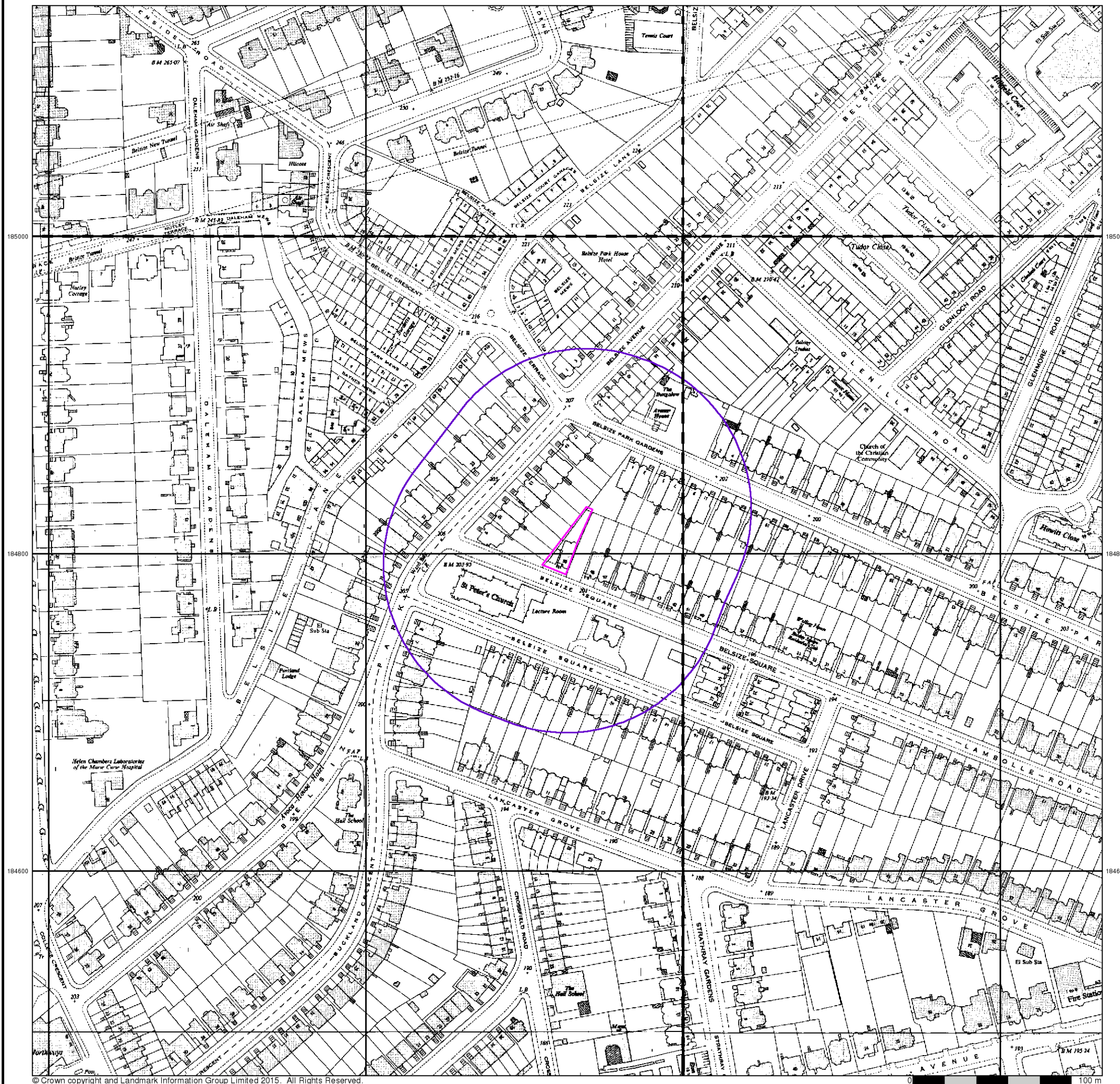

## Ordnance Survey Plan

Published 1954 - 1955

Source map scale - 1:2,500

The historical maps shown were reproduced from maps predominantly held at the scale adopted for England, Wales and Scotland in the 1840's. In 1854 the 1:2,500 scale was adopted for mapping urban areas and by 1896 it covered the whole of what were considered to be the cultivated parts of Great Britain. The published date given below is often some years later than the surveyed date. Before 1938, all OS maps were based on the Cassini Projection, with independent surveys of a single county or group of counties, giving rise to significant inaccuracies in outlying areas.

## Map Name(s) and Date(s)

TQ2685 1955 1:2,500	TQ2785 1954 1:2,500
TQ2684 1955 1:2,500	TQ2784 1954 1:2,500

## Historical Map - Segment A13

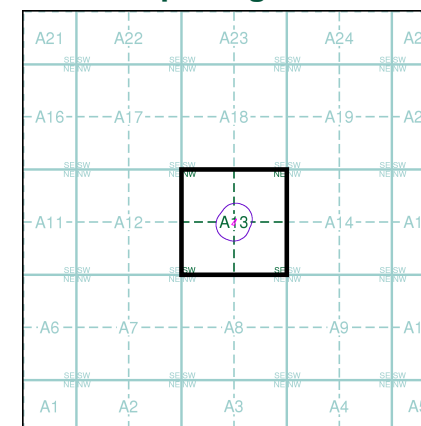

## Order Details

Order Number: 117160731\_1\_1  
 Customer Ref: J17062  
 National Grid Reference: 526930, 184810  
 Slice: A  
 Site Area (Ha): 0.05  
 Search Buffer (m): 100

## Site Details

The Coach House, 50A Belsize Square, LONDON, NW3 4HN



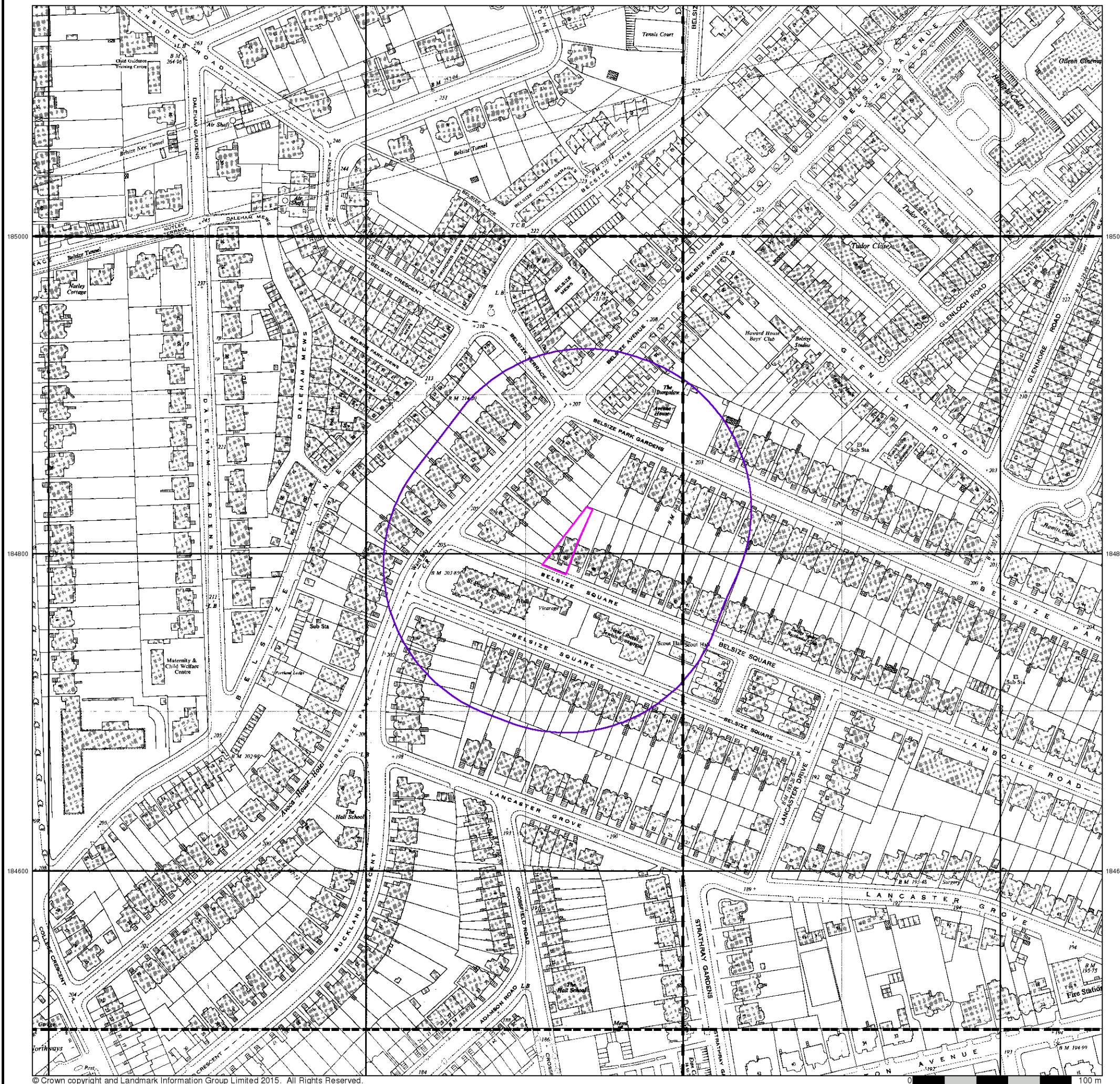

## Ordnance Survey Plan

Published 1962 - 1969

Source map scale - 1:1,250

The historical maps shown were reproduced from maps predominantly held at the scale adopted for England, Wales and Scotland in the 1840's. In 1854 the 1:2,500 scale was adopted for mapping urban areas and by 1896 it covered the whole of what were considered to be the cultivated parts of Great Britain. The published date given below is often some years later than the surveyed date. Before 1938, all OS maps were based on the Cassini Projection, with independent surveys of a single county or group of counties, giving rise to significant inaccuracies in outlying areas.

## Map Name(s) and Date(s)

TQ2685SE	Q2785SW
1966	966
1:1,250	1:1,250
TQ2684NE	Q2784NW
1967	969
1:1,250	1:1,250
TQ2684SE	Q2784SW
1962	966
1:1,250	1:1,250

## Historical Map - Segment A13

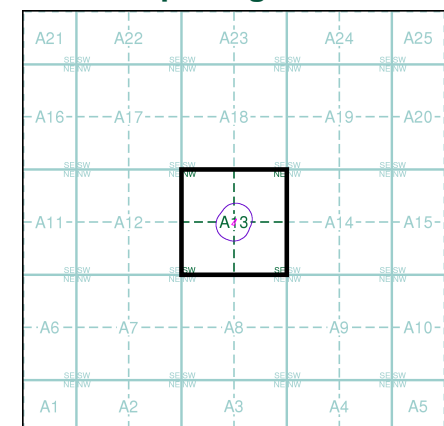

## Order Details

Order Number: 117160731\_1\_1  
 Customer Ref: J17062  
 National Grid Reference: 526930, 184810  
 Slice: A  
 Site Area (Ha): 0.05  
 Search Buffer (m): 100

## Site Details

The Coach House, 50A Belsize Square, LONDON, NW3 4HN



Tel: 0844 844 9952  
 Fax: 0844 844 9951  
 Web: www.envirocheck.co.uk



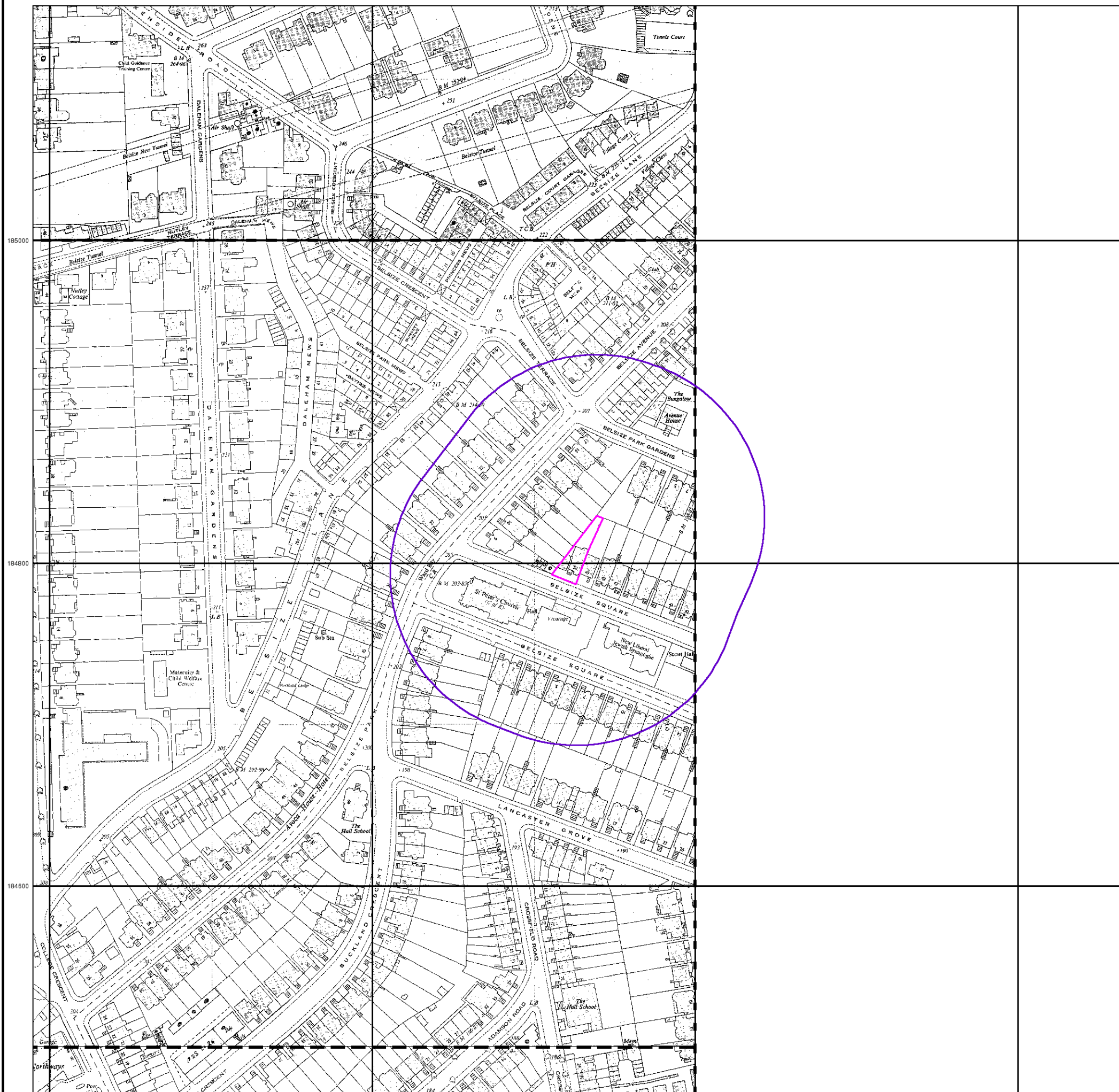

## Supply of Unpublished Survey Information

Published 1973 - 1974

Source map scale - 1:1,250

SUSI maps (Supply of Unpublished Survey Information) were produced between 1972 and 1977, mainly for internal use at Ordnance Survey. These were more of a 'work-in-progress' plan as they showed updates of individual areas on a map. These maps were unpublished, and they do not represent a single moment in time. They were produced at both 1:2,500 and 1:1,250 scales.

### Map Name(s) and Date(s)

Q2685SE  
1974  
1:1,250

Q2684NE  
1974  
1:1,250

Q2684SE  
1973  
1:1,250

### Historical Map - Segment A13

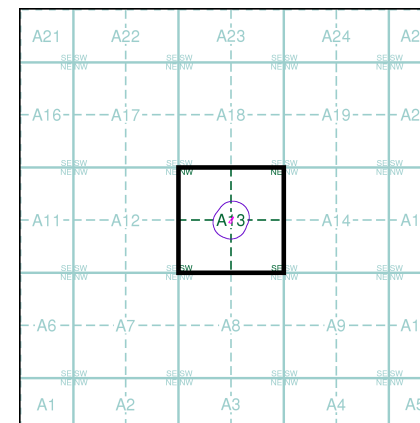

### Order Details

Order Number: 117160731\_1\_1  
Customer Ref: J17062  
National Grid Reference: 526930, 184810  
Slice: A  
Site Area (Ha): 0.05  
Search Buffer (m): 100

### Site Details

The Coach House, 50A Belsize Square, LONDON, NW3 4HN



Tel: 0844 844 9952  
Fax: 0844 844 9951  
Web: [www.envirocheck.co.uk](http://www.envirocheck.co.uk)



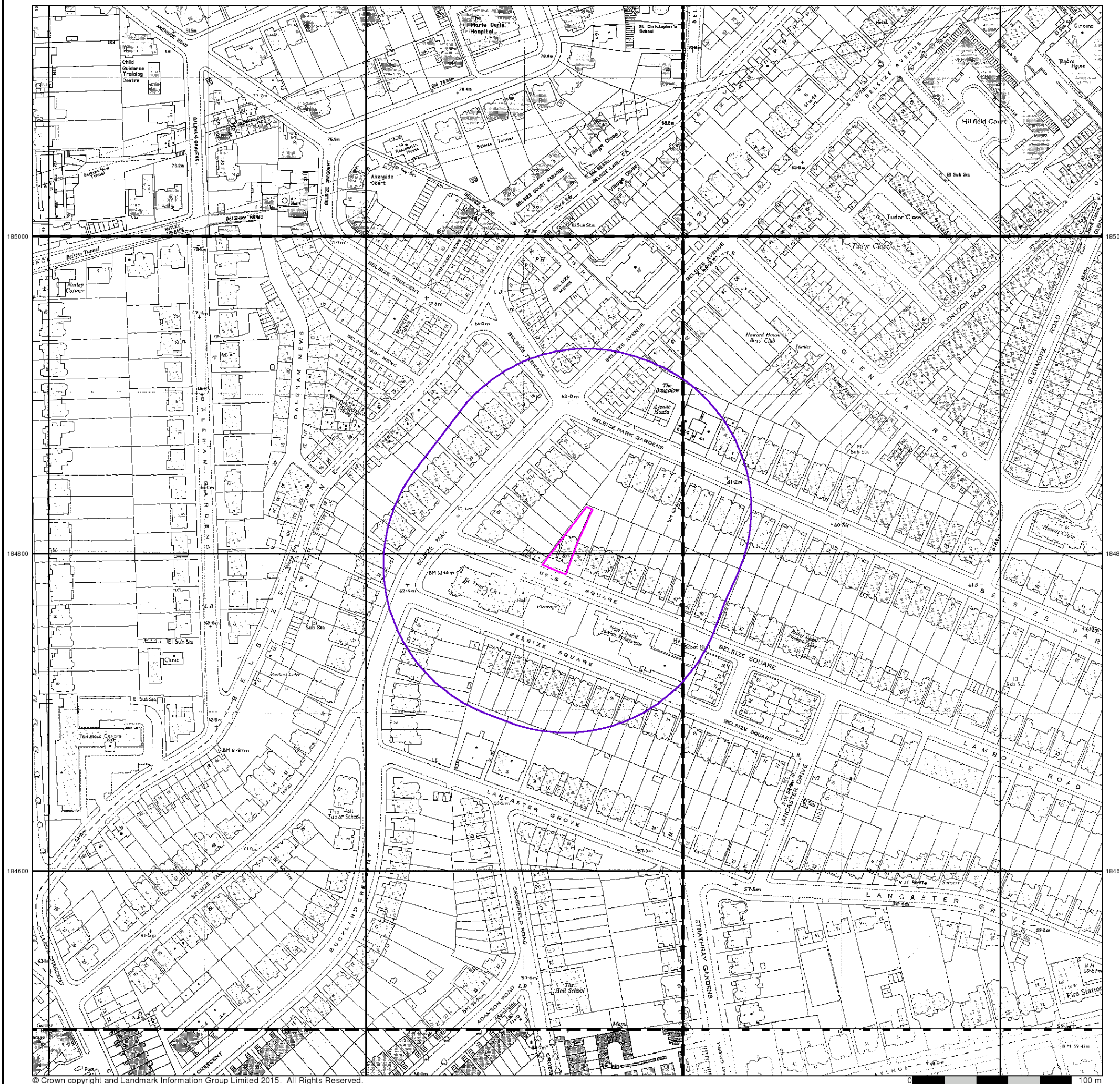

### Additional SIMs

Published 1978 - 1990

Source map scale - 1:1,250

The SIM cards (Ordnance Survey's 'Survey of Information on Microfilm') are further, minor editions of mapping which were produced and published in between the main editions as an area was updated. They date from 1947 to 1994, and contain detailed information on buildings, roads and land-use. These maps were produced at both 1:2,500 and 1:1,250 scales.

### Map Name(s) and Date(s)

TQ2685SE	Q2785SW
1986	1985
1:1,250	1:1,250
TQ2684NE	Q2784NW
1985	1990
1:1,250	1:1,250
TQ2684SE	Q2784SW
1979	1978
1:1,250	1:1,250

### Historical Map - Segment A13

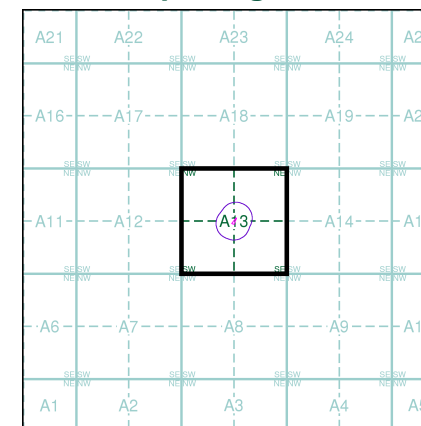

### Order Details

Order Number: 117160731\_1\_1  
 Customer Ref: J17062  
 National Grid Reference: 526930, 184810  
 Slice: A  
 Site Area (Ha): 0.05  
 Search Buffer (m): 100

### Site Details

The Coach House, 50A Belsize Square, LONDON, NW3 4HN



Tel: 0844 844 9952  
 Fax: 0844 844 9951  
 Web: www.envirocheck.co.uk