

New steps to light well to replace non original steps to allow space below for better access to the Vault

Existing ceiling to be retained where practicable, existing cornice to be retained if original

Fireplace and mantelpiece to be renovated, new hearth

New timber floor finish, existing sub floor to be retained if original fabric

B
C

Existing ceiling to be retained where practicable, existing cornice to be retained if original

Fire place to be widened to allow for new oven

Existing kitchen units to be removed and replaced with new

New timber floor finish, existing sub floor to be retained if original fabric

New three tier sliding sash window, lowered cill

Proposed walk on roof light

New stone finish to rear garden

A

D

E

A

D

E

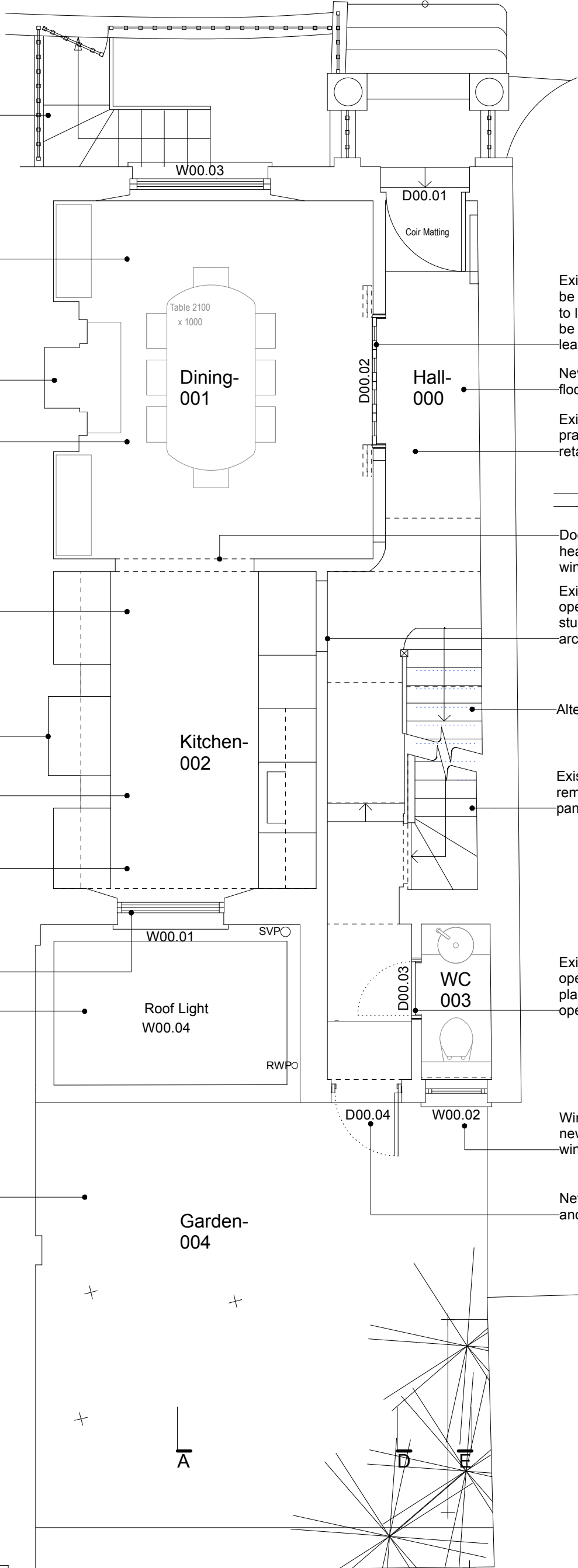

Existing non original glazed doors to be replaced, door head to be raised to line with window height- doors to be two panel glazed bi-fold door leaves

New timber floor finish, existing sub floor to be retained if original fabric

Existing ceiling to be retained where practicable, existing cornice to be retained if original

B
C

Door width to be increased, door head to be raised to line with window height, non original wall

Existing door to be fixed and non openable, or opening closed with studwork and plasterboard with architrave retained

Alterations to stair to level treads

Existing glass balustrade to be removed and replaced with timber panelling

Existing door to be removed, opening adjusted with studwork and plasterboard to form new door opening, new door

Window opening to be enlarged, new timber framed casement window

New timber framed, glazed door and fanlight to replace existing

