

ALL DIMENSIONS MUST BE CHECKED ON SITE BEFORE THE START OF ANY WORKS. MAKE TO CONSTRUCTION INTERNAL LAYOUTS BEARING.

KEY PLAN

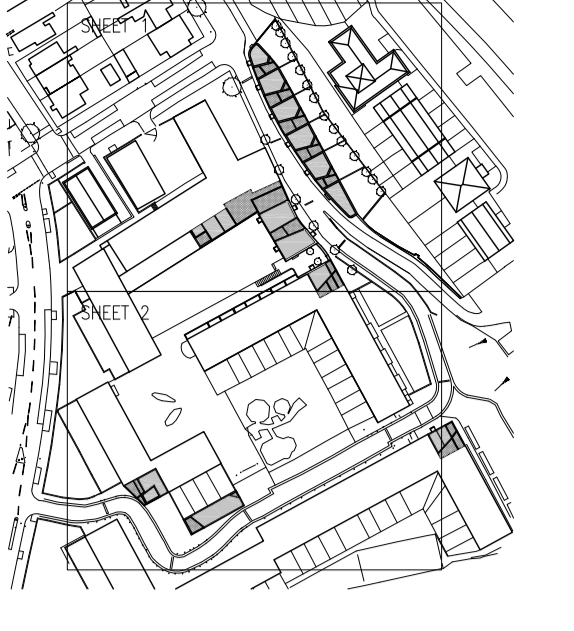

NOTES

- NON-RENEWABLE FINISH:**
 - KILN-DRIED WOOD PANELS, BLOCK COLOURS
 - LEAD TO DIFFERENT PATTERNS IN TUBES EDGED FINISHES, CHARCOAL, PINK, CORN COLOURS & WHITE WASHES
- RENEWABLE FINISH:**
 - HANSON ECOCONCRETE SQUELTET FINISH
 - MED GREEN COLOUR / TONES / 100-100mm IN CONCRETE, BLENDED & VICTORIA FINISH
- Master Plan with the 1st with climbing plants and trees
- Bench
- Dark metal bins in line with the 1st.
 - Planted tree species (EG:
 - Prunus Sparganii (Flowering Cherry)
 - Prunus Cerasifera (Cherry Laurel)
 - Acer Compens (Striped Maple)
- Lighting with FSL, position shown inductively
- External wall light, position shown inductively
- Concrete domestic external wall light adjacent to individual front doors, position shown inductively
- 1st
- 1st

ALL HANDLE COVERS TO BE RECESSED AND CAPABLE TO HAVE THE HARD LANDSCAPING MATERIAL SLID.

Red Line Boundary of Application Site

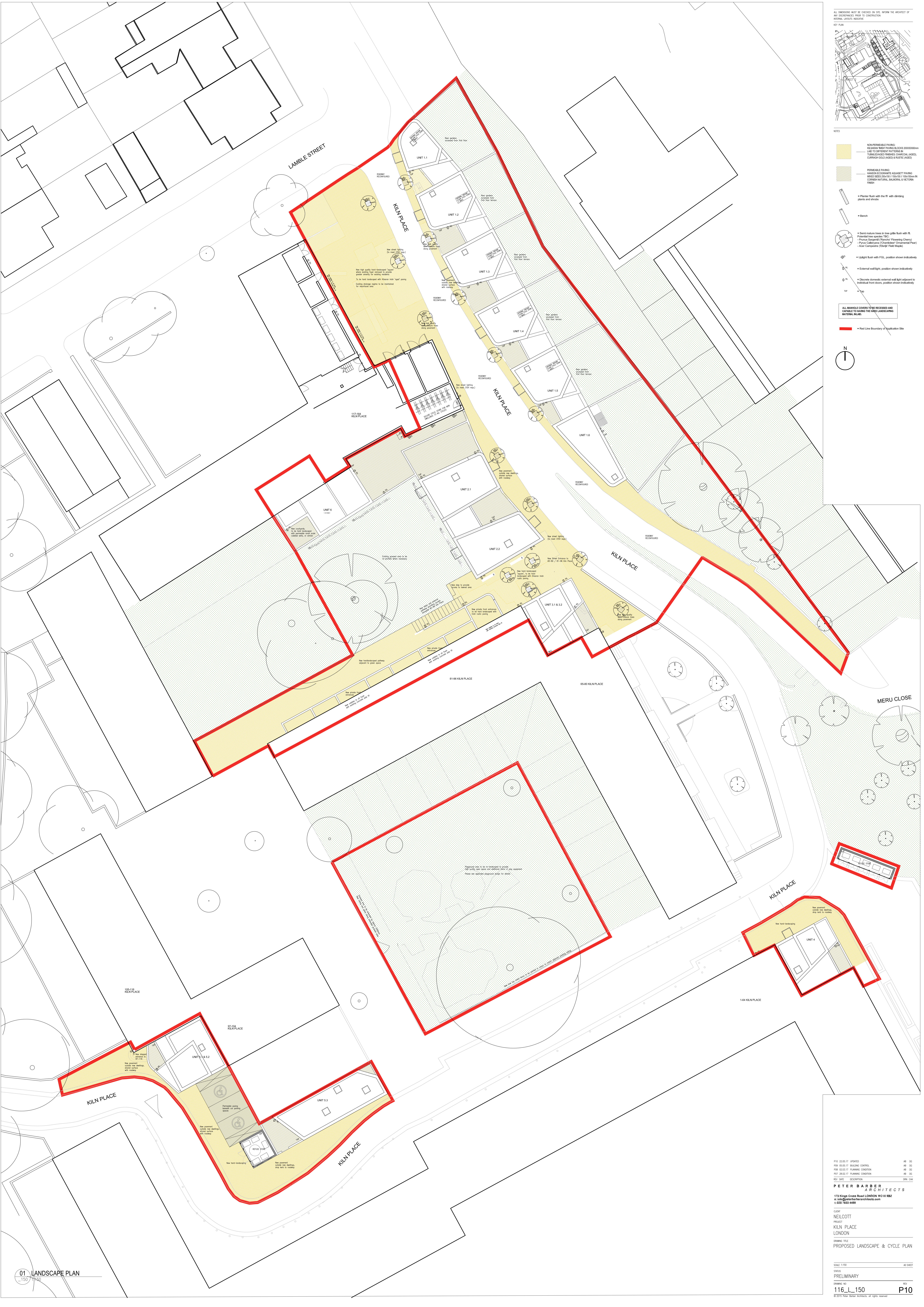

REV	DATE	DESCRIPTION	DRN	CHK
P10	22.02.17	UPDATED		BB
P09	05.05.17	BUILDING CONTROL		BB
P08	03.02.17	PLANNING CONSULT		BB
P07	28.02.17	PLANNING CONSULT		BB
REV	DATE	DESCRIPTION	DRN	CHK

PETER BARBER ARCHITECTS
 173 Kings Cross Road LONDON WC1X 9BZ
 p.barber@peterbarberarchitects.com
 t. 020 7533 4488

CLIENT: NEILCOTT PROJECT: KILN PLACE LONDON DRAWING TITLE: PROPOSED LANDSCAPE & CYCLE PLAN

SCALE: 1:150 NO SHEET: PRELIMINARY

DRAWING NO: 116_L_150 P10

© 2017 Peter Barber Architects, all rights reserved