

Approved Basement Plan - 2016/3133/P

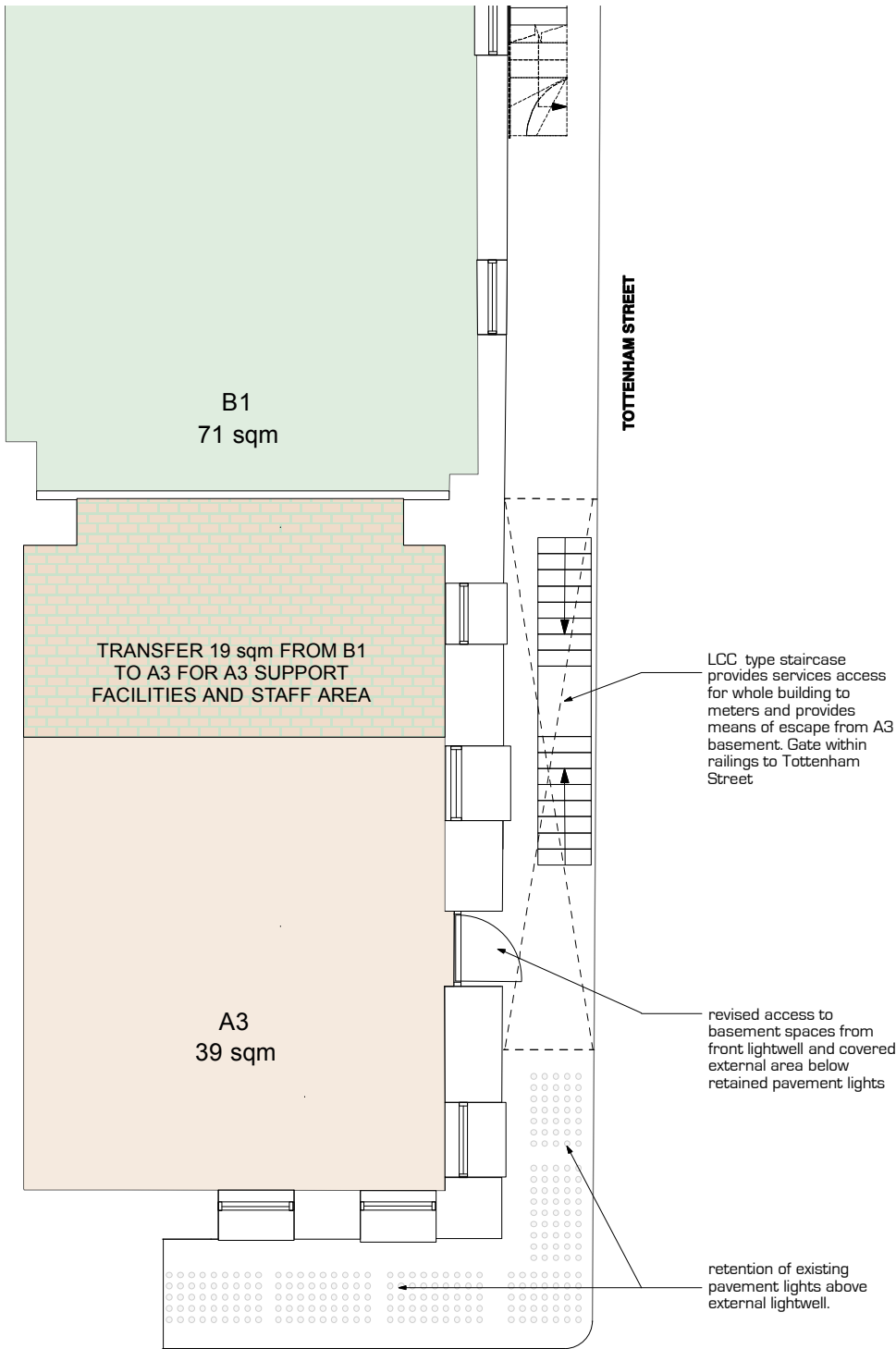

Proposed Basement Plan

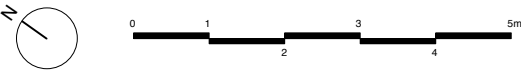

cdm statement

Any information given on this drawing must be used in conjunction with the construction health and safety plan prepared by the principal contractor. The planning supervisor must be consulted before any construction work commences. Any changes in design, or conditions arising or information becoming known at a later date that may adversely impact upon health and safety of any person, must be notified to the planning supervisor and principal contractor as soon as possible.

spaced out ltd.
4a godson street
london n1 9gz
tel: +44 (0)20 78 33 9236
email: info@spacedout.co.uk
www.spacedout.co.uk

 RIBA Chartered Architects

- all dimensions to be checked on site by contractor
- all dimensions remain the responsibility of the contractor
- all project activity to be covered by CDM regs, rev2015
- all designs are the property of spaced out © 2017

revisions:

A 25.06.2017 - external well

project: KAZU 和

drawing:
Approved and Proposed
Basement Plans

client: Paragon Holdings Ltd

scale:1:100 @ A3

dwg.no: 17.227.103 A

purpose of issue:

original issue date:
21.02.2017