

Do not scale this drawing. Contractor to confirm all dimensions on site. Notify architect immediately of any discrepancies.

Revisions:  
00 CH 22.05.17 Issued for Planning.

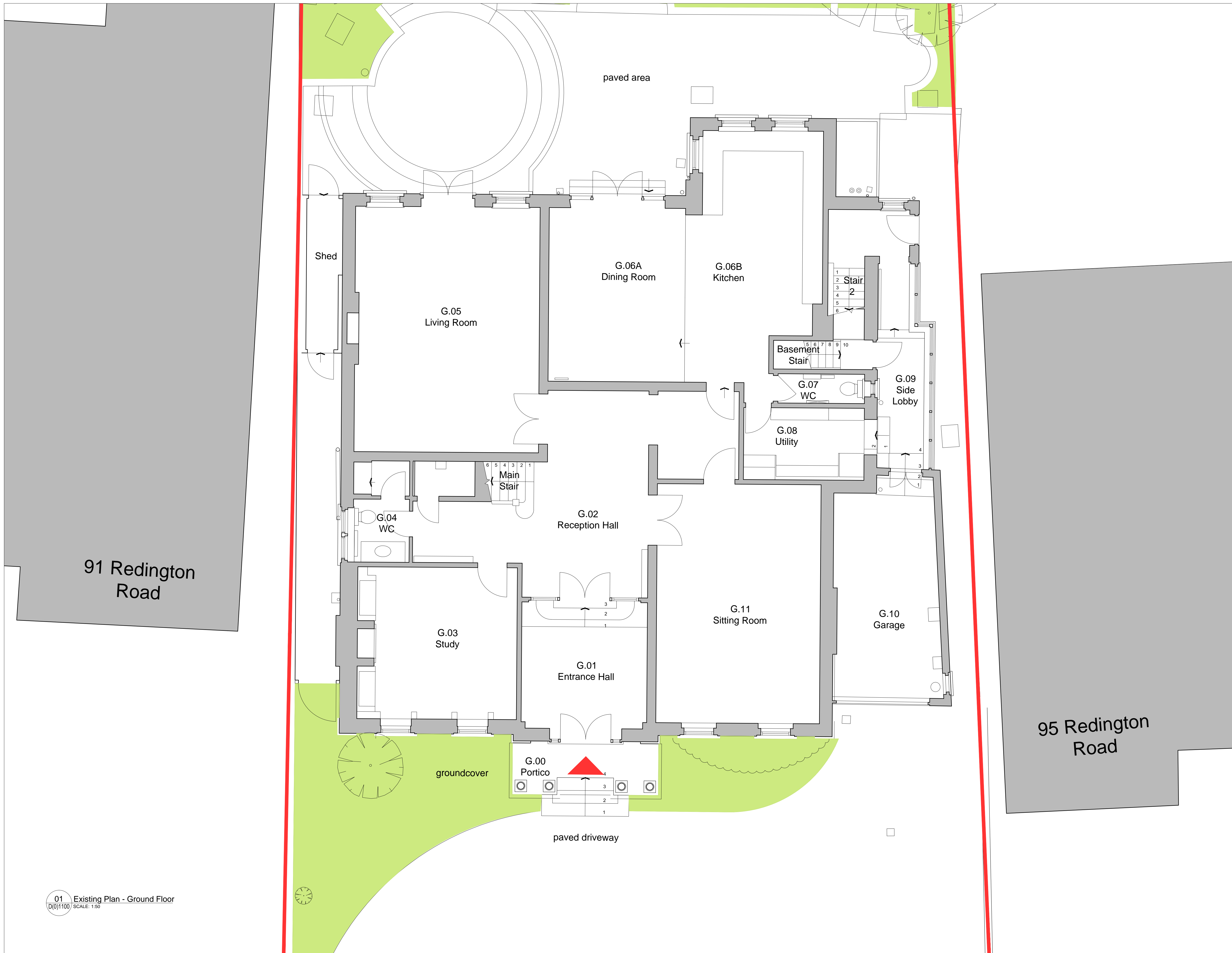

Key:

- Existing building
- Existing front entrance
- Site Boundary

Note:

- Do not scale this drawing. Refer to written dimensions only.
- This drawing is based on the 3Sixty measured survey.

Key Plan

91 Redington Road

95 Redington Road

**FORMATION ARCHITECTS**

Winchester House 1-3 Brixton Road London SW9 6DE  
T 020 7251 0781 W formationarchitects.co.uk

Project  
93 Redington Road  
Hampstead  
London  
NW3 7RR

Client  
Lev Leviev

Drawing Title  
Existing Plan  
Ground Floor

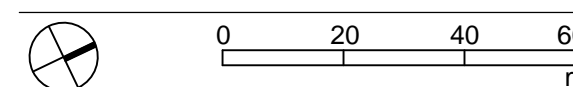

Drawn by CH Checked by JvW Scale 1:50@A1

Status  
**For Planning**

Job number 6610 Drawing number D(0)1100 Revision 00

01 Existing Plan - Ground Floor  
D(0)1100 SCALE: 1:50