

Summary ASS 70.HI

DO NOT SCALE - IF IN DOUBT ASK

DOUBLE TRACK DESIGN - TYPE 2

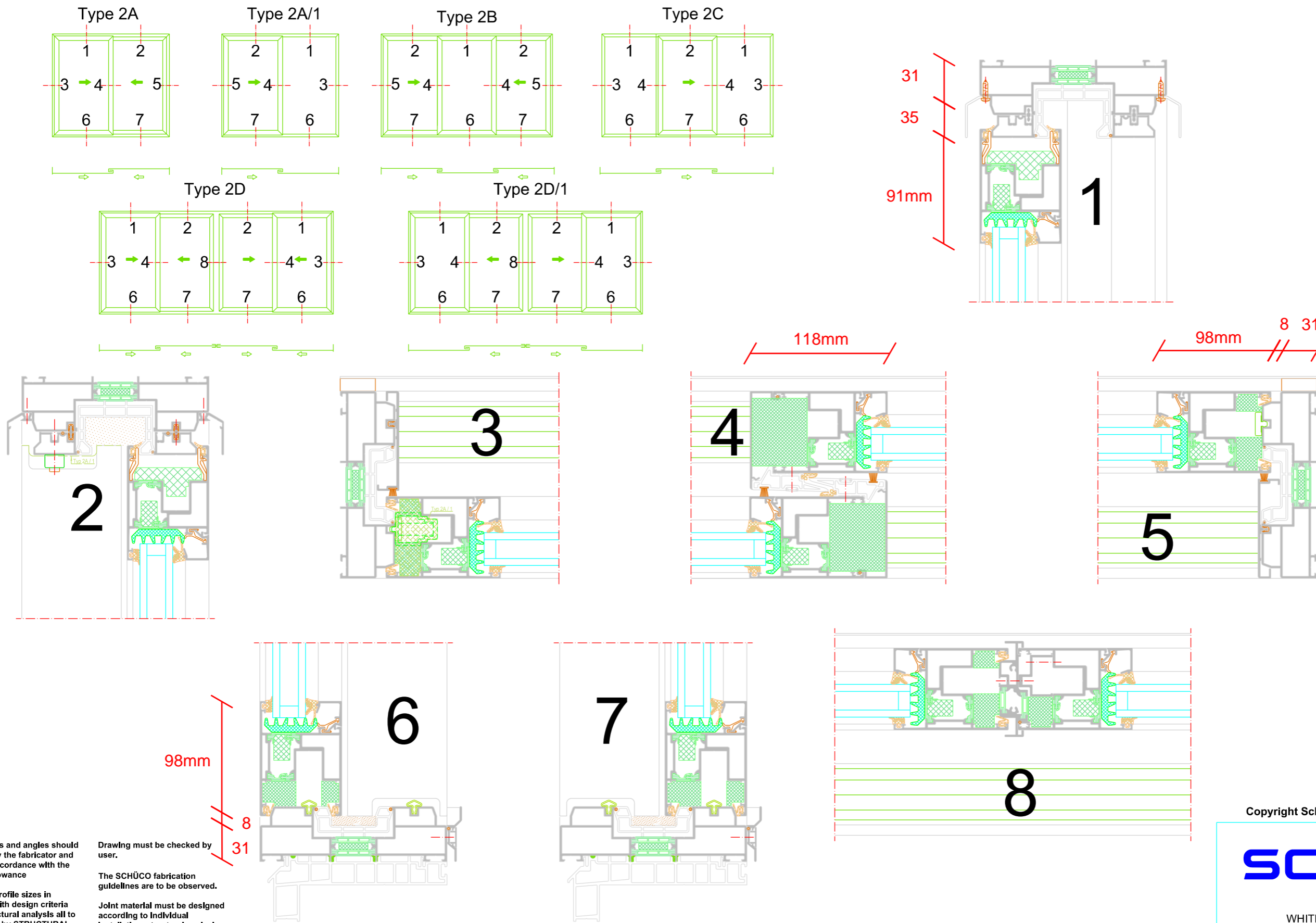

All dimensions and angles should be checked by the fabricator and finalised in accordance with the obligatory allowance

Selection of profile sizes in accordance with design criteria and final structural analysis all to be carried out by STRUCTURAL ENGINEER employed by fabricator.

All "hair line" mitre, toe and butt joints to be sealed in accordance with SCHÜCO guidelines.

Drawing must be checked by user.

The SCHÜCO fabrication guidelines are to be observed.

Joint material must be designed according to individual installation, structural analysis and standards applicable.

Direct contact between aluminum and steel profiles has to be avoided with the use of sealing or barrier tapes.

Description:	SECTION DETAILS	Systems:	ASS 70.HI	CAD Format	Scale	Drawn	Date
Project:	CAD LIBRARY	Fabricator:	ALL	AutoCAD	NTS	JS	11/07/2012
				File Number	Drawing Number		CL-AL-12-084

Copyright Schüco UK Ltd. All rights reserved

SCHÜCO

SCHÜCO UK LTD.
 TEL: 01908 282111
 WHITEHALL AVENUE, KINGSTON
 MILTON KEYNES, BUCKS MK10 0AL