

Information contained within this drawing is the sole copyright of HDCA Ltd, and is not to be reproduced without express permission. No implied licence exists. This drawing is not to be used for land transfer or valuation purposes. Do not scale from this drawing. All dimensions & levels are to be checked on site by the contractor. Issued for purposes indicated only. Drawing errors and omissions to be reported to the architect.

**Notes**

- Existing building fabric
- Proposed building fabric

Drawings based on outline survey from different sources

**Schedule Of Accommodation**

Floor	No.Units
Basement Level	0
Lower Ground Floor	26
Upper Ground Floor	24
Mezzanine Floor	1
First Floor	28
Second Floor	24
Third Floor	24
Fourth Floor	24
Fifth Floor	20
Sixth Floor	20
Seventh Floor	14
Eighth Floor	6
<b>TOTAL:</b>	<b>211</b>

**Note:**  
 10% of rooms fully wheelchair accessible (i.e. 21 rooms), split as following:  
 5% fully accessible and 5% adaptable (i.e. 11 wheelchair accessible rooms and 10 adaptable rooms).

- Key**
- external wheelchair accessible route
  - internal wheelchair accessible route
  - accessible entrance
  - accessible emergency exit
  - passenger lift
  - passenger / fire-fighting lift
  - platform lift
  - accessible WC
  - escape stairs
  - safe refuge
  - wheelchair adaptable room
  - wheelchair accessible room
  - tracked ceiling hoist route
  - ramp ( 1:20)
- P1 12/6/17 Planning Application Submission

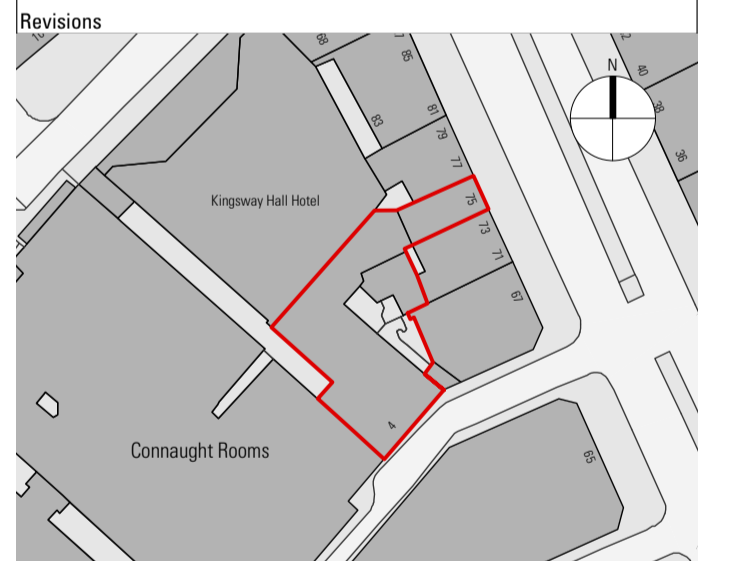

**HARPER DOWNIE**  
 CREATIVE ARCHITECTURE

Third Floor  
 77 Bastwick Street  
 London EC1V 3PZ  
 T +44 20 7490 7674  
 studio@harperdownie.com  
 www.harperdownie.com

Client  
 Z Hotels

Project  
 4 Wild Court  
 London  
 WC2B 4AU

Drawing Title  
 Access Plans  
 Proposed Mezzanine Floor Plan

Status Planning	Drawn LF	Checked PR
Scale 1:100 @ A1 / 1:200 @ A3	Date Feb 2017	

Drwg. No. & Revision  
**646-GAMEZ/Acc-P1**

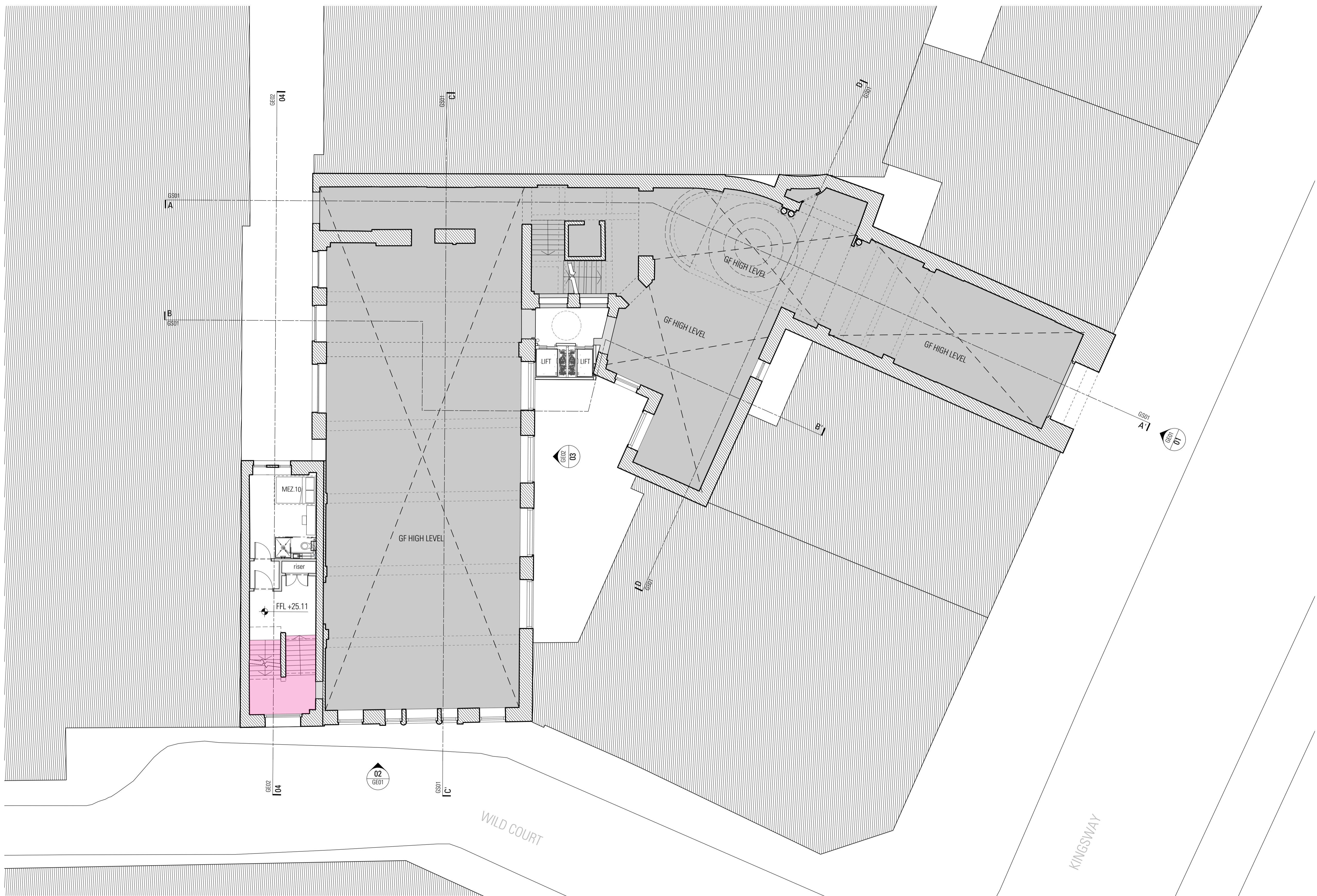

**MEZ Proposed Mezzanine Floor**

Scale 1:100 @ A1 / 1:200 @ A3

