

All windows to be replaced with aluminium framed double glazed windows. Colour - Dark grey, RAL 7022

All existing railings to be replaced with frameless glass balustrades

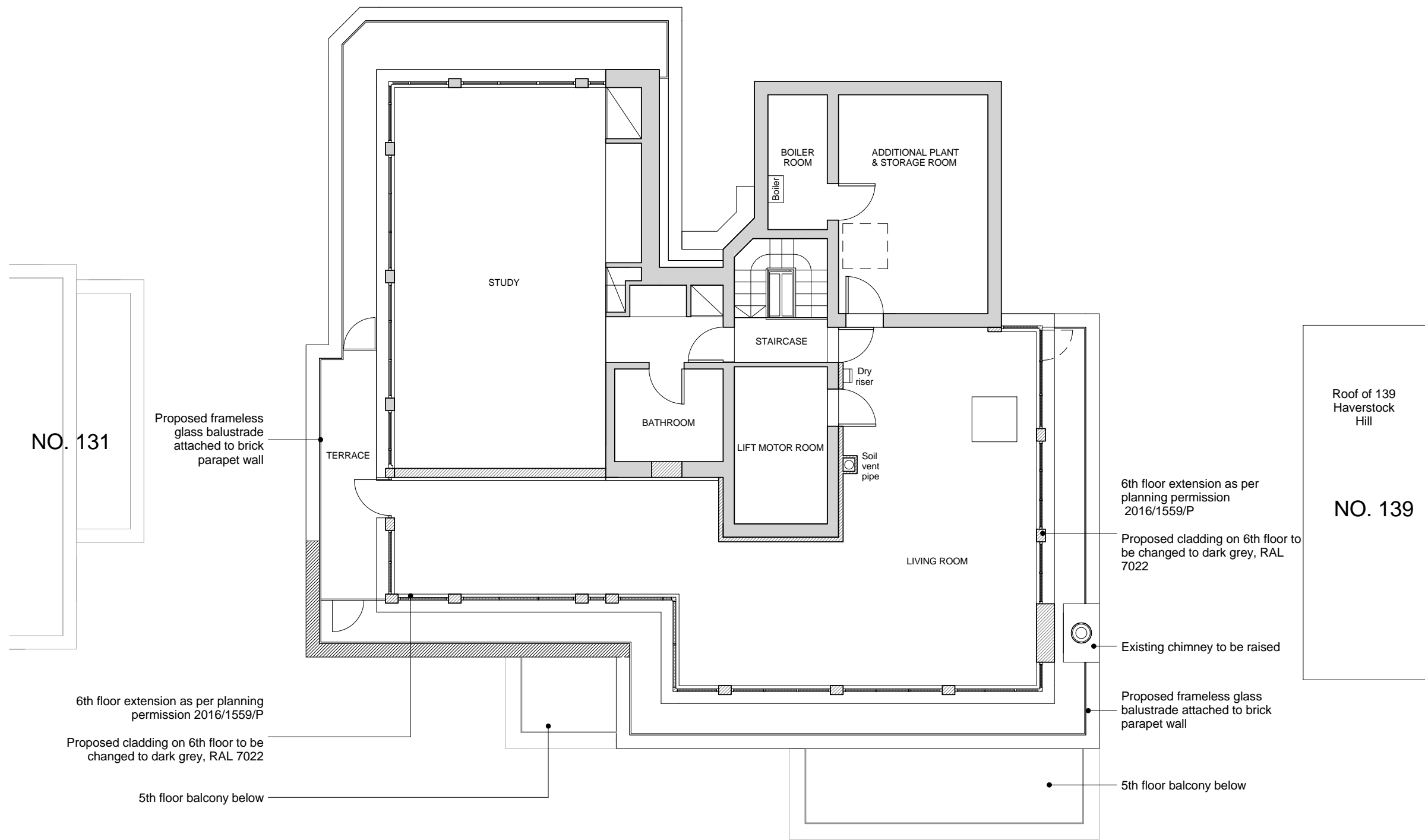

NO. 131

Proposed frameless glass balustrade attached to brick parapet wall

TERRACE

STUDY

BOILER ROOM

ADDITIONAL PLANT & STORAGE ROOM

Boiler

STAIRCASE

BATHROOM

LIFT MOTOR ROOM

Dry riser

Soil vent pipe

LIVING ROOM

Roof of 139 Haverstock Hill

NO. 139

6th floor extension as per planning permission 2016/1559/P

Proposed cladding on 6th floor to be changed to dark grey, RAL 7022

Existing chimney to be raised

Proposed frameless glass balustrade attached to brick parapet wall

5th floor balcony below

6th floor extension as per planning permission 2016/1559/P

Proposed cladding on 6th floor to be changed to dark grey, RAL 7022

5th floor balcony below

Sixth Floor Plan

**NOTES**

DO NOT SCALE FROM DRAWING. ALL DIMENSIONS, LEVELS, COORDINATES, SETTING OUT, TO BE CHECKED ON SITE AND ANY DISCREPANCY REPORTED IMMEDIATELY TO THE ARCHITECT AND PROJECT MANAGER.

**PROJECT**

135 Haverstock Hill

**CLIENT**

Michael Gross

**DRAWING NAME**

Proposed Sixth Floor Plan

**REVISIONS**

Rev A 12 05 17  
Rev B 14 06 17

STATUS	SCALE
Planning	1 : 100@A3
DRAWING NUMBER	DATE
HYA 15042 (P) 308 B	31/01/17

**HIGGS YOUNG**  
**ARCHITECTS**

HIGGS YOUNG ARCHITECTS LTD  
54 BOSTON PLACE  
LONDON NW1 6ER  
Tel: 0044 (0)20 7724 9395  
E-mail: info@higgsyoung.com



Scale 1:100 meters

