

This drawing is the Copy right of LATIS limited.
 This drawing has been produced electronically and may have been photo reduced or enlarged when copied. Do not scale from drawing. Work only to figured dimensions
 This drawing is to be read in conjunction with relevant consultants and engineers drawings and specifications.

LATIS LIMITED
 19-21 GREAT QUEEN STREET, LONDON, WC2B 5BE
 T: +44 (0)207 499 2800
 info@latisgroup.com
 www.latis.co.uk

| REV | DATE | COMMENTS |
|-----|----------|-------------|
| - | 21.06.17 | First Issue |

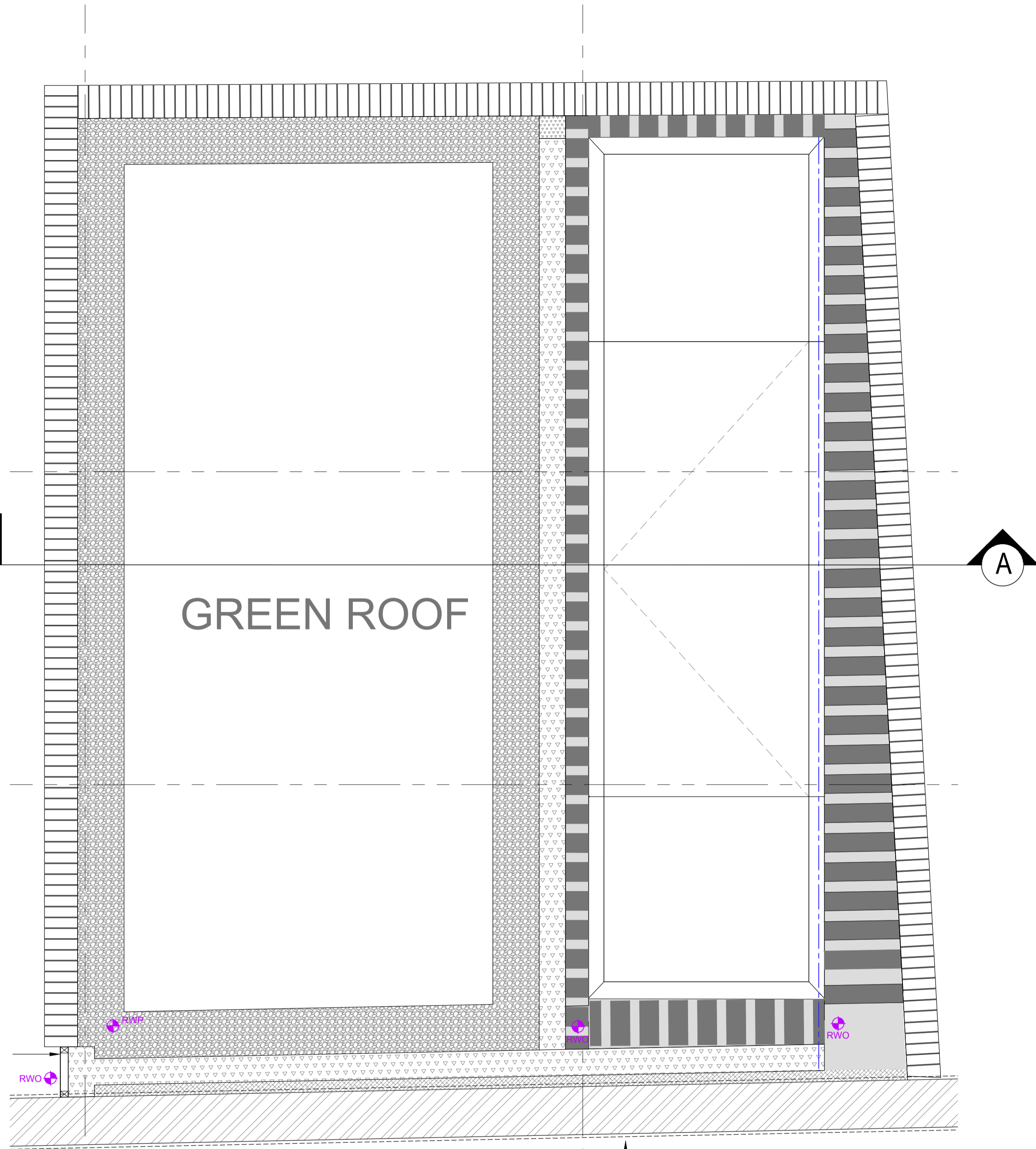

Dashed line denotes coping over

GREEN ROOF PLAN

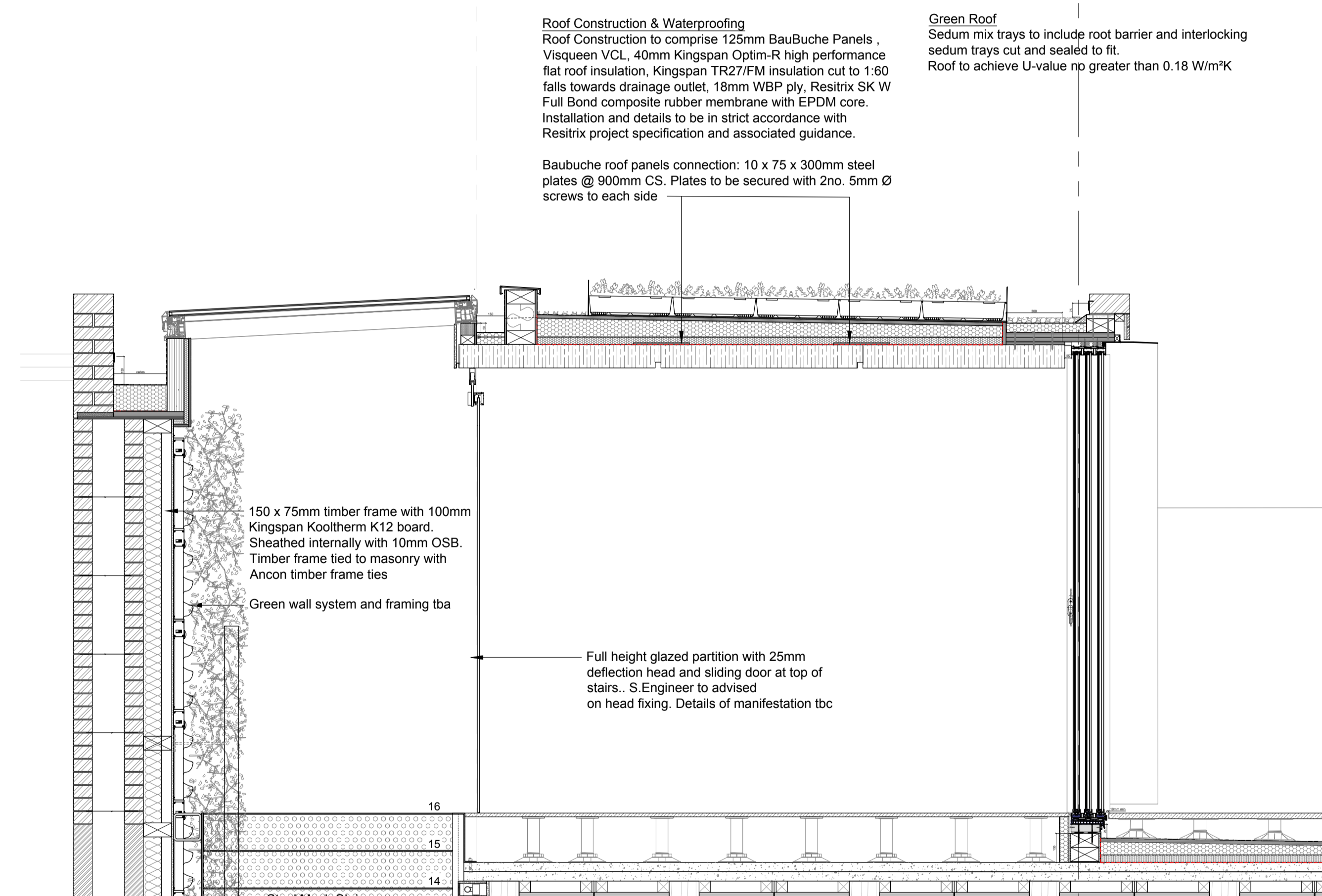

Roof Construction & Waterproofing
 Roof Construction to comprise 125mm BauBuche Panels, Visqueen VCL, 40mm Kingspan Optim-R high performance flat roof insulation, Kingspan TR27/FM insulation cut to 1:80 falls towards drainage outlet, 18mm WBP ply, Resitrix SK W Full Bond composite rubber membrane with EPDM core. Installation and details to be in strict accordance with Resitrix project specification and associated guidance.

Green Roof
 Sedum mix trays to include root barrier and interlocking sedum trays cut and sealed to fit.
 Roof to achieve U-value no greater than 0.18 W/m²K

Baubuche roof panels connection: 10 x 75 x 300mm steel plates @ 900mm CS. Plates to be secured with 2no. 5mm Ø screws to each side

150 x 75mm timber frame with 100mm Kingspan Kooltherm K12 board. Sheathed internally with 10mm OSB. Timber frame tied to masonry with Ancon timber frame ties

Green wall system and framing tba

Full height glazed partition with 25mm deflection head and sliding door at top of stairs. S.Engineer to advised on head fixing. Details of manifestation tbc

GREEN ROOF SECTION A



CLIENT:
 LATIS HOMES

TITLE:
 Green Roof Details

PROJECT:
 GREAT JAMES STREET

SCALE:
 1:20 @ A1

DRG NO:
 0065_PLN_55

DRAWN: CHECKED: DATE: REV:
 - - June 2017 -