

1 ECD - M2 - West Elevation - Zone 02  
 1 : 100

**Status Code (as defined in BS1192)**  
 D3 - Issued for contractor design  
 D4 - Issued for manufacture/procurement

**Work In Progress (WIP)**  
 S0 - Initial Status or WIP

**Shared**  
 S1 - Issued for co-ordination  
 S2 - Issued for information  
 S3 - Issued for internal review  
 S4 - Issued for construction approval

**Documentation (Pre-construction)**  
 D1 - Issued for costing  
 D2 - Issued for tender

**Documentation (Contractual)**  
 A - Issued for construction  
 B - Issued for construction but with comments  
 C - Comprehensive revision required

**Archive**  
 AB - Record Drawing

rev	by	chkd	date	description
003	JSG	IAW	31/05/17	Updates to reflect Status C comments received 24/11/16.
002	TM	MWB	31/10/16	UPDATED AS CLOUDED

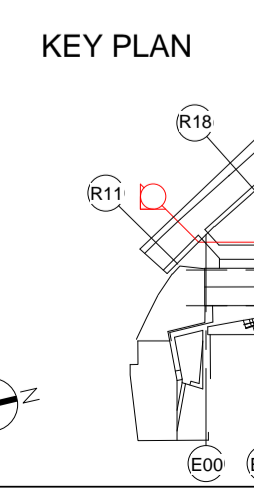

**bam**  
 BAM Design Ltd  
 An operating company of  
 BAM Construct UK Ltd

Architecture  
 Interior Design  
 3D Visualisation  
 Feasibility Studies  
 Structural Engineering  
 Environmental Services  
 Building Information Modelling

Centrium Business Park  
 Giffords Way, St Albans  
 Hemel Hempstead, AL1 2RD  
 01727 848001  
 design@bam.co.uk  
 www.bam.co.uk

project COAL DROPS YARD

title Proposed West Elevation - East  
 Coal Drop Sheet 02

purpose of issue CONSTRUCTION

scale 1 : 100 @ A1

date 06/30/16

drawn TM

checked DGW

design@bam.co.uk

BAM job no. 4389

rev 003

01727 848001

design@bam.co.uk

www.bam.co.uk

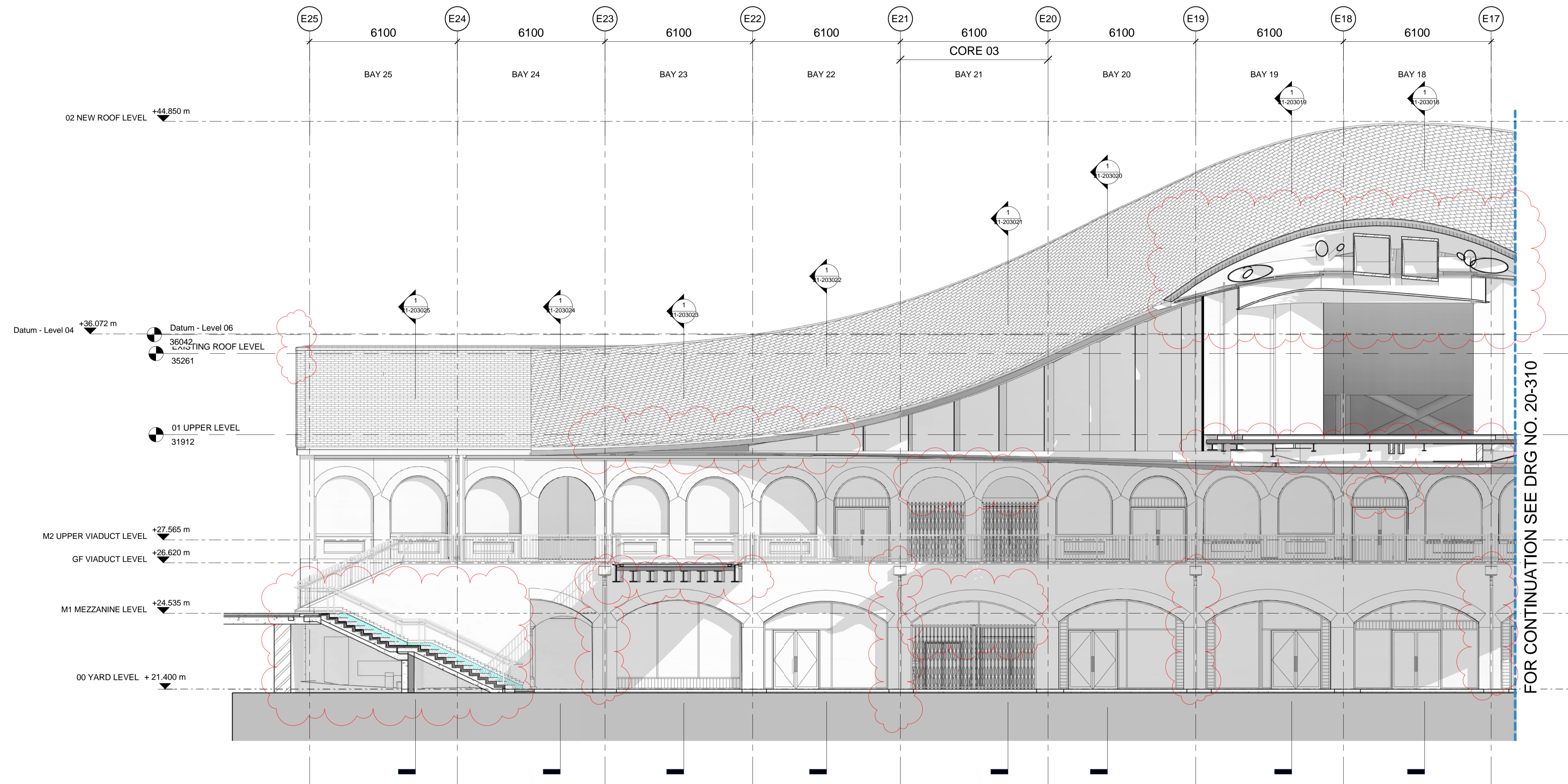

1 ECD - M2 - West Elevation - Zone 03  
 1 : 100

**Status Code (as defined in BS1192)**  
 S0 - Initial Status or WIP  
 S1 - Issued for co-ordination  
 S2 - Issued for information  
 S3 - Issued for internal review  
 S4 - Issued for construction approval  
 D1 - Issued for costing  
 D2 - Issued for tender

**Documentation (Contractual)**  
 A - Issued for construction  
 B - Issued for construction but with comments  
 C - Comprehensive revision required  
 AB - Record Drawing

**Documentation (Pre-construction)**  
 D3 - Issued for contractor design  
 D4 - Issued for manufacture/procurement

rev	by	chkd	date	description
003	JSG	IAW	31/05/17	Updates to reflect Status C comments received 24/11/16.
002	TM	MWB	31/10/16	UPDATED AS CLOUDED

KEY PLAN

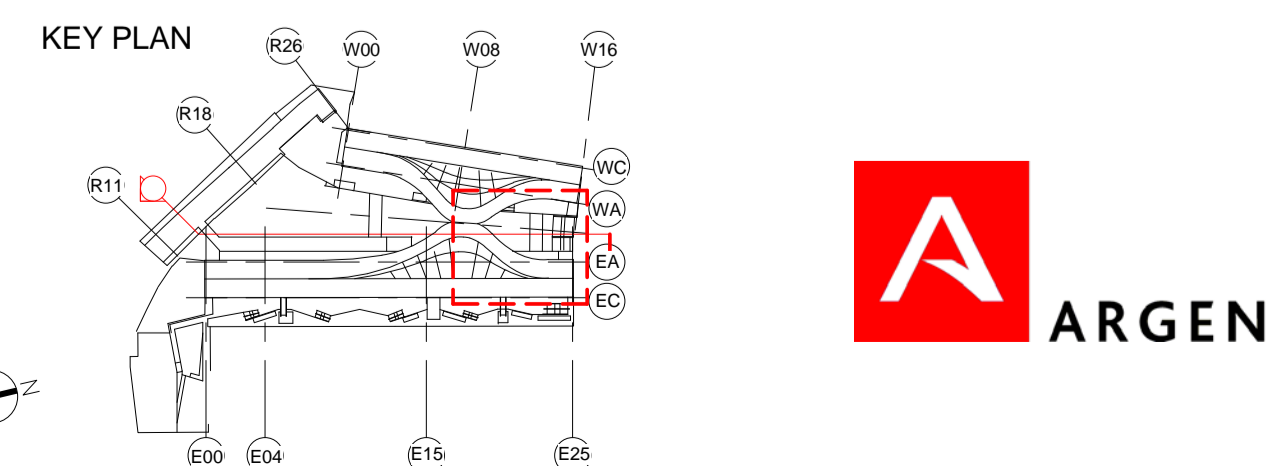

**bam**  
 BAM Design Ltd  
 An operating company of  
 BAM Construct UK Ltd  
 Architecture  
 Interior Design  
 3D Visualisation  
 Feasibility Studies  
 Structural Engineering  
 Environmental Services  
 Building Information Modelling

Centrium Business Park  
 Giffords Way, St Albans  
 Hemel Hempstead, AL1 2RD  
 01727 86000  
 design@bam.co.uk  
 www.bam.co.uk

project COAL DROPS YARD

title Proposed West Elevations - East Coal Drop Sheet 03

scale 1 : 100 @ A1

date 06/30/16

site KXC-M2- 001-BD4389-A- 20-311

drawn TM

checked DGW

consultant Bate

role C/SFR

content

rev 003

purpose of issue CONSTRUCTION

BAM job no. 4389

dig. status S4

CONTINUATION M1-ZONE 02 -DWG 20-100116

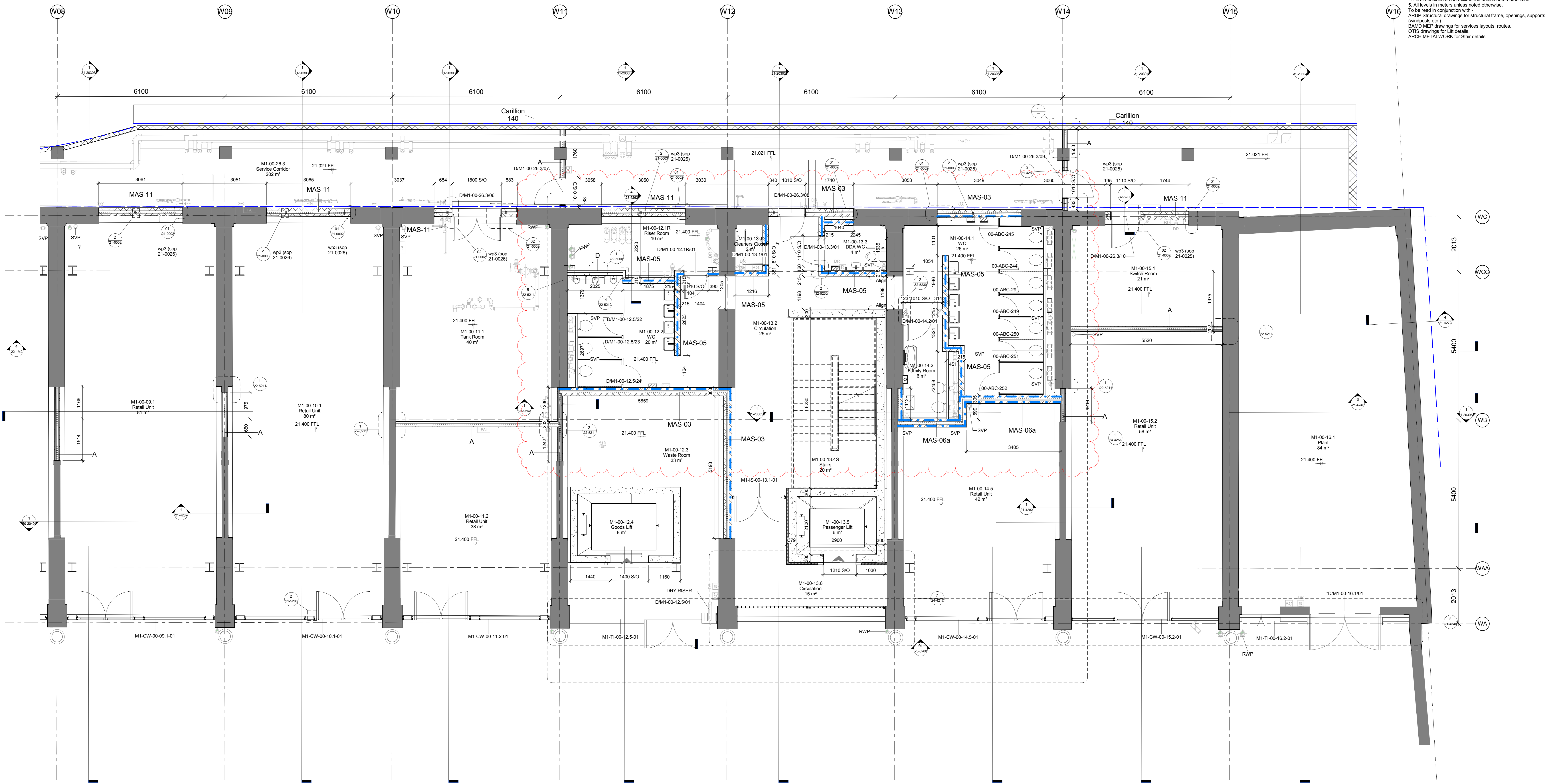

1-50 - M1-Zone 01 - Yard Level (00) - GA  
1:50

DO NOT SCALE FROM THIS DRAWING.  
ALL DIMENSIONS TO BE CHECKED ON SITE.  
FOR REFERENCED VIEWS REFER TO KXC-M1-001-A-SERIES OF DRAWINGS.

NOTES:  
1. This drawing shows design intent only & is subject to detailed design from specialists.  
2. Figured dimensions only are to be taken from this drawing. All contractors must visit site & are responsible for taking & checking all dimensions relating to their work. BAM design to be advised of any variation between drawings & site conditions.  
3. All vertical dimensions to be taken from FFL. Please note that all manufacturing schedules are to take this into account.  
4. All dimensions are in millimetres unless noted otherwise.  
5. All levels in meters unless noted otherwise.  
To be read in conjunction with:  
- ARUP Structural drawings for structural frame, openings, supports (windposts etc.)  
- BAMD MEP drawings for services layouts, routes.  
- OTIS drawings for lift details.  
- ARCH METALWORK for Stair details.

Wall Type	Colour	Description
A	Green	202 thk - 2 x 12.5 Soundblock - d146 s'C' 90 Studs - 50mm APR 1200 ONS - 18m Service Support Plate Ply - 3mm Multi Skim (See NBS Spec K10-125)
A2	Red	202 thk - 2 x 12.5 Soundblock - d146 s'C' 90 Studs - 50mm APR 1200 ONS - 18m Service Support Plate Ply - 3mm Multi Skim (See NBS Spec K10-125)
B	Blue	118 thk - 2 x 12.5 Soundblock - 92 'I' 90 Studs - 18m Service Support Plate Ply - 3mm Multi Skim (See NBS Spec K10-126)
C	Dark Blue	98 thk - 2 x 12.5 Soundblock - 92 'I' Studs - 18m Service Support Plate Ply - 3mm Multi Skim (See NBS Spec K10-127)
D	Purple	Toilet Framing - Final Spec TBC (See NBS Spec K10-128)
D2	Grey	110 thk - 15 Soundblock - d146 s'C' 70 Studs - 50mm APR 1200 ONS - 3mm Multi Skim - Ceramic Tile finish. (FINAL SPEC TBC) (See NBS Spec K10)

Type	Colour	Description
MAS 01	Red	215mm fully bonded brickwork, minimum compressive strength of >20N/mm <sup>2</sup> , walls to flush finish internally. NOTE: Final spec. TBC (See NBS Spec F10)
MAS 02	Yellow	170 thk - 100mm blockwork, 70mm Insulation (See NBS Spec F10)
MAS 03	Green	303 thk - 102.5mm brickwork, 50mm Cavity, 50mm Insulation, 100mm blockwork (See NBS Spec F10)
MAS 04	Blue	343 thk - 102.5mm brickwork, 50mm Cavity, 50mm Insulation, 140mm blockwork (See NBS Spec F10)
MAS 05	Pink	215 thk - 215mm new heritage brickwork (See NBS Spec F10)
MAS 06a	Purple	305 thk - 102.5mm brickwork, 50mm Cavity, 50mm Insulation, 102.5mm brickwork (See NBS Spec F10)

Type	Colour	Description
MAS 06b	Yellow	328 thk - 102.5mm brickwork, 50mm Cavity, 50mm Insulation, 100mm blockwork, 10mm dabs, 12.5mm Plasterboard with 3mm MultiSkim (See NBS Spec F10)
MAS 06c	Blue	400 thk - 102.5mm brickwork, 120mm Cavity, 75mm Insulation, 102.5mm brickwork (See NBS Spec F10)
MAS 06d	Red	365 thk - 102.5mm brickwork, 110mm Cavity, 50mm Insulation, 102.5mm brickwork (See NBS Spec F10)
MAS 08	Blue	102.5mm brickwork (See NBS Spec F10)
MAS 09	Brown	140mm blockwork (See NBS Spec F10)
MAS 10	Orange	210 thk - 100mm blockwork, 10mm mortar, 100mm blockwork (See NBS Spec F10)
MAS 11	Grey	300 thk - 100mm blockwork, 50mm Cavity, 50mm Insulation, 100mm blockwork (See NBS Spec F10)
MAS 12	Green	153 thk - 102.5mm brickwork, 50mm Insulation (See NBS Spec F10)

**Ref 22-7000 for Wall Types Schedule & Key plus 21-0000 for wall details**  
**All retail partitions to have perimeter shadow gap reveal ref 22-5211**  
--- Brickwork Stretcher Bond.

NOTES:  
Refer to:  
- ARUP Structural drawings for structural frame, openings, supports (windposts etc.) & SOFT SPOT setting out.  
- APR-19870-S-20-1GF01-103.  
- APR-19870-S-20-500000

BAMD MEP drawings for services layouts, routes. Exact sizing of duct pipe work please refer to dwgs.  
P-52 series  
E-1001,1002 + 1ZZ

OTIS drawings for Lift details.  
Structural Stairways for Stair details

No	Rev	Date	Description
001	IAW	10/03/17	Additional Setting out dimensions shown
006	VAH	23/01/17	Brick Stretcher Bond indicated. Partition callouts added. Updated to comments 24.11.16 & 20.12.16. Future Stairs omitted.
004	YTB	04/11/16	WCD corridor detail references updated
001	YTB	18/10/16	WCD corridor detail references updated
003	YTB	30/09/16	Service Corridor masonry eRFI panel references added
002	VH	12/05/16	Issued for Construction. GL WAA & WCC added. RWP & soft spots noted.
001	VH	15/04/16	Issued for Construction Approval

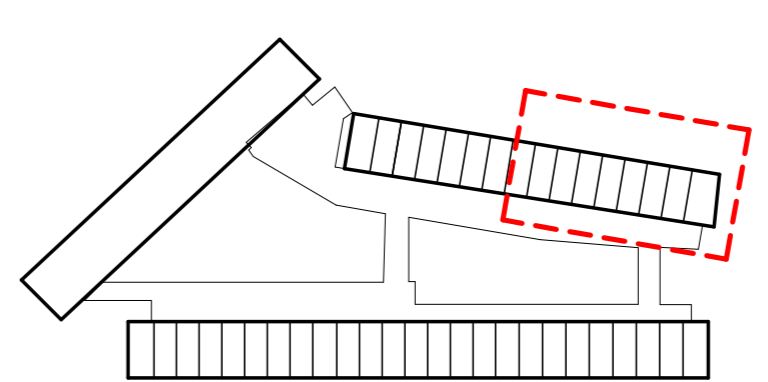

CONTINUATION M1-ZONE 03 - DWG 20-100143

CONTINUATION M1-ZONE 01 - DWG 20-100115

DO NOT SCALE FROM THIS DRAWING.  
 ALL DIMENSIONS TO BE CHECKED ON SITE.  
 FOR REFERENCED VIEWS REFER TO KXC-M1-001-A-SERIES OF DRAWINGS

NOTES:  
 1. This drawing shows design intent only & is subject to detailed design from specialists.  
 2. Figured dimensions only are to be taken from this drawing. All contractors must visit site & are responsible for taking & checking all dimensions relating to their work. BAM Design to be advised of any variation between drawings & site conditions.  
 3. All vertical dimensions to be taken from FFL, please note that all manufacturing schedules are to take this into account.  
 4. All dimensions are in millimetres unless noted otherwise.  
 5. All levels in meters unless noted otherwise.  
 To be read in conjunction with -  
 ARUP Structural drawings for structural frame, openings, supports (windposts etc.)  
 BAMD MEP drawings for services layouts, routes.  
 OTIS drawings for Lift details.  
 ARCH METALWORK for stair details

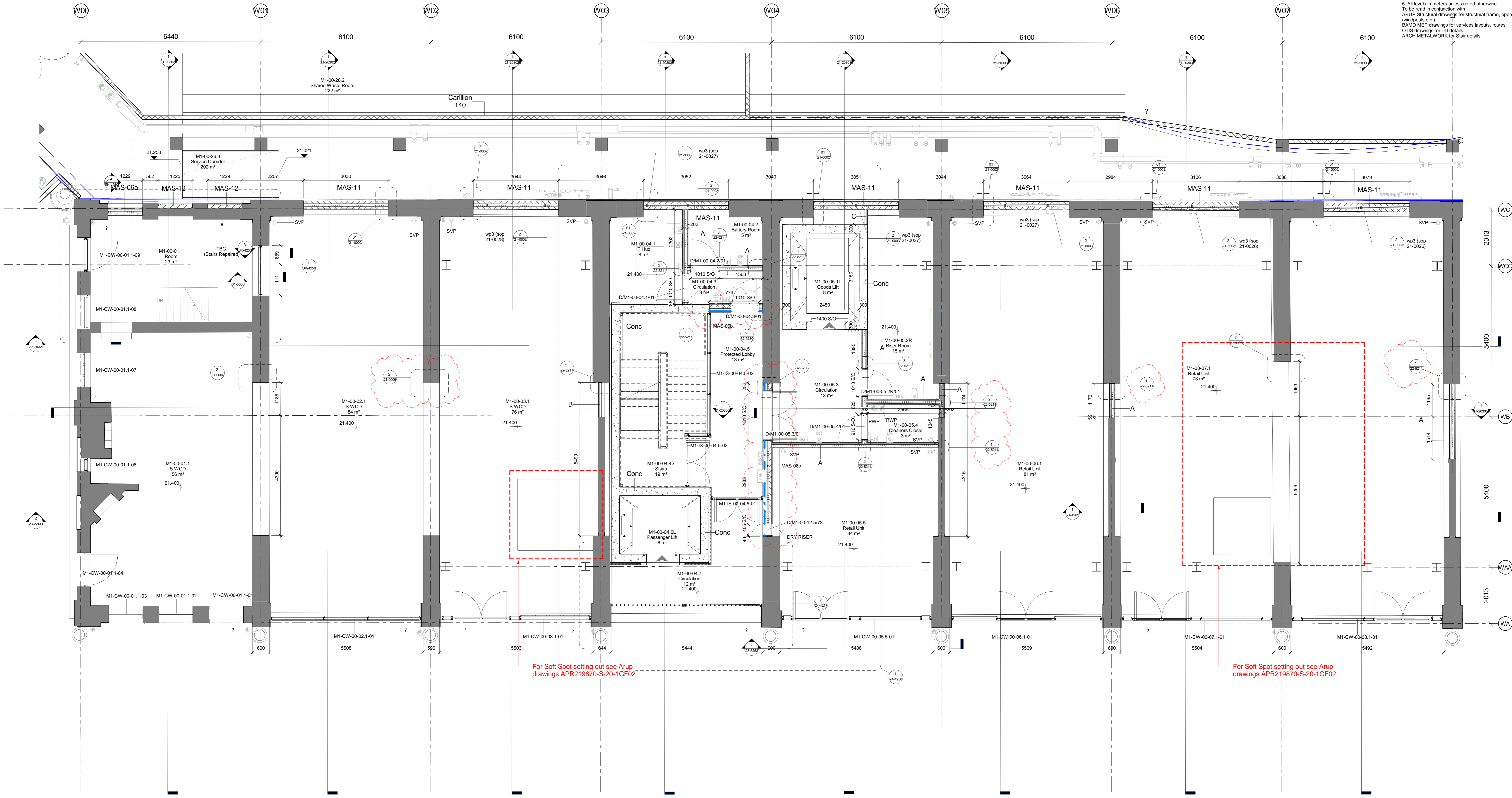

1 1-50 - M1-Zone 02 - Yard Level (00) - GA  
 1:50

Wall Type	Colour	Description
A	Green	202 thk - 2 x 12.5 Soundblock - d146 s 'C' 90 Studs - 50mm APR 1200 ONS - 18m Service Support Plate Ply - 3mm Multi Skim (See NBS Spec K10-125)
A2	Red	202 thk - 2 x 12.5 Soundblock - d146 s 'C' 90 Studs - 50mm APR 1200 ONS - 18m Service Support Plate Ply - 3mm Multi Skim (See NBS Spec K10-125)
B	Cyan	118 thk - 2 x 12.5 Soundblock - 92 'I' 90 Studs - 18m Service Support Plate Ply - 3mm Multi Skim (See NBS Spec K10-126)
C	Blue	98 thk - 2 x 12.5 Soundblock - 92 'I' Studs - 18m Service Support Plate Ply - 3mm Multi Skim (See NBS Spec K10-127)
D	Purple	Toilet Framing - Final Spec TBC (See NBS Spec K10-128)
D2	Grey	110 thk - 15 Soundblock - d146 s 'C' 70 Studs - 50mm APR 1200 ONS - 3mm Multi Skim - Ceramic Tile finish, (FINAL SPEC TBC) (See NBS Spec K10)

Type	Colour	Description
MAS 01	Red	215mm fully bonded brickwork, minimum compressive strength of >20N/mm <sup>2</sup> , walls to flush finish internally. NOTE: Final spec. TBC (See NBS Spec F10)
MAS 02	Yellow	170 thk - 100mm blockwork, 70mm Insulation (See NBS Spec F10)
MAS 03	Green	303 thk - 102.5mm brickwork, 50mm Cavity, 50mm Insulation, 100mm blockwork (See NBS Spec F10)
MAS 04	Blue	343 thk - 102.5mm brickwork, 50mm Cavity, 50mm Insulation, 140mm blockwork (See NBS Spec F10)
MAS 05	Pink	215 thk - 215mm new heritage brickwork (See NBS Spec F10)
MAS 06a	Purple	305 thk - 102.5mm brickwork, 50mm Cavity, 50mm Insulation, 102.5mm brickwork (See NBS Spec F10)

Type	Colour	Description
MAS 06b	Yellow	328 thk - 102.5mm brickwork, 50mm Cavity, 50mm Insulation, 100mm blockwork, 10mm dabs, 12.5mm Plasterboard with 3mm MultiSkim (See NBS Spec F10)
MAS 06c	Blue	400 thk - 102.5mm brickwork, 120mm Cavity, 75mm Insulation, 102.5mm brickwork (See NBS Spec F10)
MAS 06d	Orange	365 thk - 102.5mm brickwork, 110mm Cavity, 50mm Insulation, 102.5mm brickwork (See NBS Spec F10)
MAS 08	Light Blue	102.5mm brickwork (See NBS Spec F10)
MAS 09	Brown	140mm blockwork (See NBS Spec F10)
MAS 10	Light Orange	210 thk - 100mm blockwork, 10mm mortar, 100mm blockwork (See NBS Spec F10)
MAS 11	Grey	300 thk - 100mm blockwork, 50mm Cavity, 50mm Insulation, 100mm blockwork (See NBS Spec F10)
MAS 12	Green	153 thk - 102.5mm brickwork, 50mm Insulation (See NBS Spec F10)

**Ref 22-7000 for Wall Types Schedule & Key plus 21-0000 for wall details**  
**All retail partitions to have perimeter shadow gap reveal ref 22-5211**  
 - - - - - Brickwork Stretcher Bond.

NOTES:  
 Refer to:  
 ARUP Structural drawings for structural frame, openings, supports (windposts etc.) & SOFT SPOT setting out.  
 APR-19870-S-20-1GF01-103.  
 APR-19870-S-20-500000

BAMD MEP drawings for services layouts, routes. Exact sizing of duct pipe work please refer to dwgs.  
 P-52 series  
 E-1001,1002 + 1ZZ

OTIS drawings for Lift details.  
 Structural Stairways for Stair details

006	YH	IAW	23/01/17	Brickwork Stretcher Bond Indicated. Partitions colours added. Updated to comments 24.11.16 & 20.12.16
005	YTB	IAW	04/11/16	Future Stairs omitted
004	YTB	IAW	18/10/16	WCD consider detail references updated
003	YTB	MWB	30/09/16	Service Corridor masonry infill panel references added
002	VH	MWB	12/05/16	Issued for Construction. GL WAA & WCC added. RWP & soft spots noted.
001	VH	MWB	15/04/16	Issued for Construction Approval

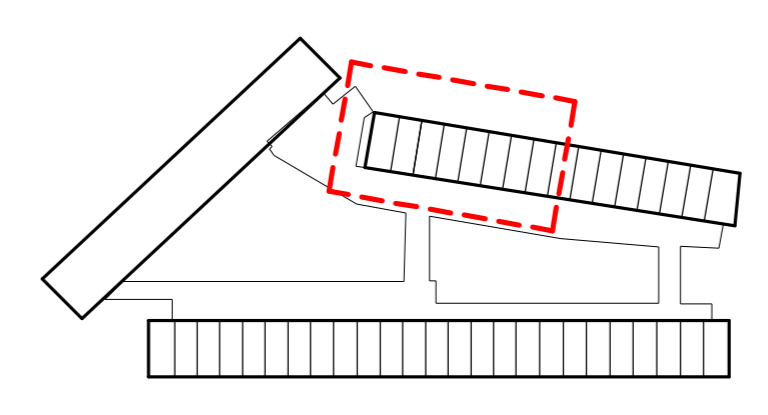

**bam**  
 BAM Design  
 30 Victoria Road  
 London, SE18 2JF  
 020 7461 1000  
 www.bam.co.uk

CONTINUATION M2-ZONE 02 - DWG 20-100119

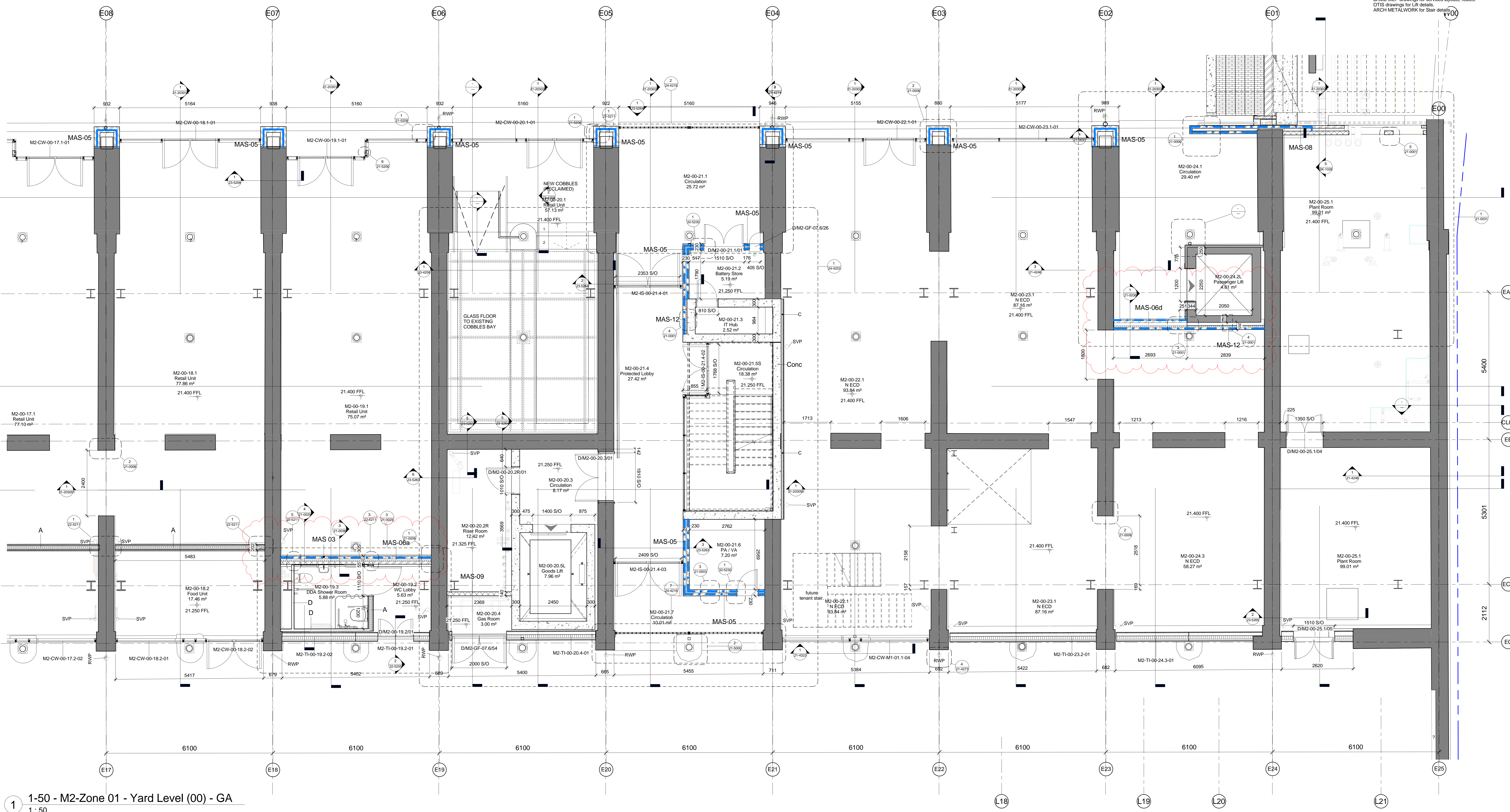

1-50 - M2-Zone 01 - Yard Level (00) - GA  
1:50

DO NOT SCALE FROM THIS DRAWING.  
ALL DIMENSIONS TO BE CHECKED ON SITE.  
FOR REFERENCED VIEWS REFER TO KXC-M2-001-A SERIES OF DRAWINGS.

NOTES:  
1. This drawing shows design intent only & is subject to detailed design from specialists.  
2. Figured dimensions only are to be taken from this drawing. All dimensions relating to their work, BAM Design to be advised of any variation between drawings & site conditions.  
3. All vertical dimensions to be taken from FFL, please note that all manufacturing schedules are to take this into account.  
4. All dimensions are in millimetres unless noted otherwise.  
5. All levels in meters unless noted otherwise.  
To be read in conjunction with:  
- ARUP Structural drawings for structural frame, openings, supports (windposts etc.)  
- BAMD MEP drawings for services layouts, routes.  
- OTIS drawings for Lift details.  
- ARCH METALWORK for Stair details.

Wall Type	Colour	Description	Type	Colour	Description
A	Green	202 thk - 2 x 12.5 Soundblock - d146 s' C' 90 Studs - 50mm APR 1200 ONS - 18m Service Support Plate Ply - 3mm Multi Skim (See NBS Spec K10-125)	MAS 01	Red	215mm fully bonded brickwork, minimum compressive strength of >20N/mm <sup>2</sup> , walls to flush finish internally. NOTE: Final spec. TBC (See NBS Spec F10)
A2	Red	202 thk - 2 x 12.5 Soundblock - d146 s' C' 90 Studs - 50mm APR 1200 ONS - 18m Service Support Plate Ply - 3mm Multi Skim (See NBS Spec K10-125)	MAS 02	Yellow	170 thk - 100mm blockwork, 70mm Insulation (See NBS Spec F10)
B	Cyan	118 thk - 2 x 12.5 Soundblock - 92' I' 90 Studs - 18m Service Support Plate Ply - 3mm Multi Skim (See NBS Spec K10-126)	MAS 03	Green	303 thk - 102.5mm brickwork, 50mm Cavity, 50mm Insulation, 100mm blockwork (See NBS Spec F10)
C	Blue	98 thk - 2 x 12.5 Soundblock - 92' I' Studs - 18m Service Support Plate Ply - 3mm Multi Skim (See NBS Spec K10-127)	MAS 04	Light Blue	343 thk - 102.5mm brickwork, 50mm Cavity, 50mm Insulation, 140mm blockwork (See NBS Spec F10)
D	Purple	Toilet Framing - Final Spec TBC (See NBS Spec K10-128)	MAS 05	Pink	215 thk - 215mm new heritage brickwork (See NBS Spec F10)
D2	Grey	110 thk -15 Soundblock - d146 s' C' 70 Studs - 50mm APR 1200 ONS - 3mm Multi Skim - Ceramic Tile finish. (FINAL SPEC TBC) (See NBS Spec K10)	MAS 06a	Magenta	305 thk - 102.5mm brickwork, 50mm Cavity, 50mm Insulation, 102.5mm brickwork (See NBS Spec F10)
			MAS 06b	Yellow-Green	328 thk - 102.5mm brickwork, 50mm Cavity, 50mm Insulation, 100mm blockwork, 10mm dabs, 12.5mm Plasterboard with 3mm MultiSkim (See NBS Spec F10)
			MAS 06c	Blue	400 thk - 102.5mm brickwork, 120mm Cavity, 75mm Insulation, 102.5mm brickwork (See NBS Spec F10)
			MAS 06d	Orange	365 thk - 102.5mm brickwork, 110mm Cavity, 50mm Insulation, 102.5mm brickwork (See NBS Spec F10)
			MAS 08	Light Blue	102.5mm brickwork (See NBS Spec F10)
			MAS 09	Brown	140mm blockwork (See NBS Spec F10)
			MAS 10	Light Orange	210 thk - 100mm blockwork, 10mm mortar, 100mm blockwork (See NBS Spec F10)
			MAS 11	Grey	300 thk - 100mm blockwork, 50mm Cavity, 50mm Insulation, 100mm blockwork (See NBS Spec F10)
			MAS 12	Green	153 thk - 102.5mm brickwork, 50mm Insulation (See NBS Spec F10)

**Ref 22-7000 for Wall Types Schedule & Key plus 21-0000 for wall details**  
**All retail partitions to have perimeter shadow gap reveal ref 22-5211**  
--- Brickwork Stretcher Bond.

NOTES:  
Refer to:  
ARUP Structural drawings for structural frame, openings, supports (windposts etc.) & SOFT SPOT setting out.  
APR-19870-S-20-1GF01-103.  
APR-19870-S-20-500000

BAMD MEP drawings for services layouts, routes. Exact sizing of duct pipe work please refer to dwgs.  
E-1001, 1002 + 1ZZ

OTIS drawings for Lift details.  
Structural Stairways for Stair details

No	ISC	MWB	15/05/17	Revised wall type + detail references added
007	DCW	MWB	05/04/17	North Anchor updated with future tenant stair and reinstated cobbles floor updated.
006	VH	IAW	23/01/17	Brickwork Stretcher Bond indicated. Partition colours added. Updated to comments 24.11.16 & 20.12.16
004	IAW	IAW	16/11/16	Updated as clouded
005	TM	MWB	16/11/16	Updated for masonry package & call outs added
003	VH	MWB	12/05/16	Updated to suit HG comments 28.04.16. Minor amendments
002	VH	MWB	25/04/16	Issued for Construction. GL EAA & EEC added. RVP's added
001	VH	MWB	20/04/16	Issued for Contractors Approval

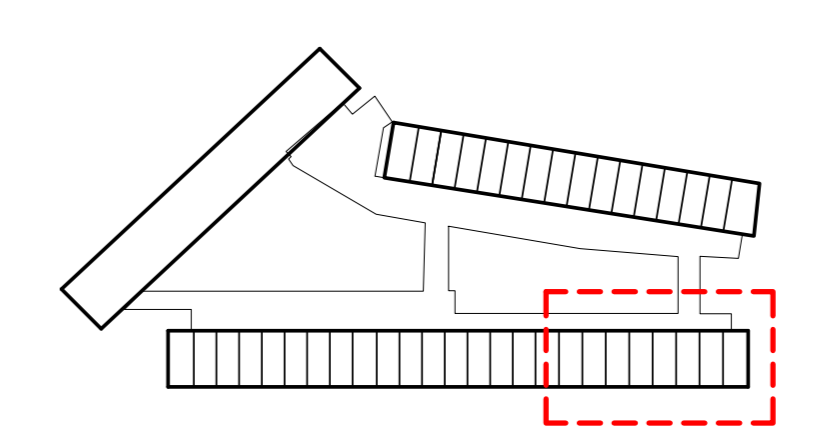

**bam**  
BAM Design  
Architectural  
Interior Design  
3D Visualisation  
Quantity Estimation  
Environmental Services  
Building Performance Modelling

**COAL DROPS YARD**

M2 - Zone 01 - Yard Level (00)  
GA

Construction

As indicated @ A0  
03/16/16  
DCW  
MWB  
4389  
S4

KXC-M2-001-BD4389-A-20-100117 008

CONTINUATION M2-ZONE 03 - DWG 20-100120

NOT SCALE FROM THIS DRAWING.  
 ALL DIMENSIONS TO BE CHECKED ON SITE.  
 FOR REFERENCED VIEWS REFER TO KXC-M2-001-A-  
 SERIES OF DRAWINGS

NOTES:  
 1. This drawing shows design intent only & is subject to detailed design from specialists.  
 2. Figured dimensions only are to be taken from this drawing. All contractors must visit site & are responsible for taking & checking all dimensions relating to their work. BAM Design to be advised of any variation between drawings & site conditions.  
 3. All vertical dimensions to be taken from FFL, please note that all manufacturing schedules are to take this into account.  
 4. All dimensions are in millimetres unless noted otherwise.  
 5. All levels in meters unless noted otherwise.  
 To be read in conjunction with:  
 ARUP Structural drawings for structural frame, openings, supports (windposts etc.)  
 BAMD MEP drawings for services layouts, routes, OTIS drawings for Lift details.  
 ARCH METALWORK for Stair details

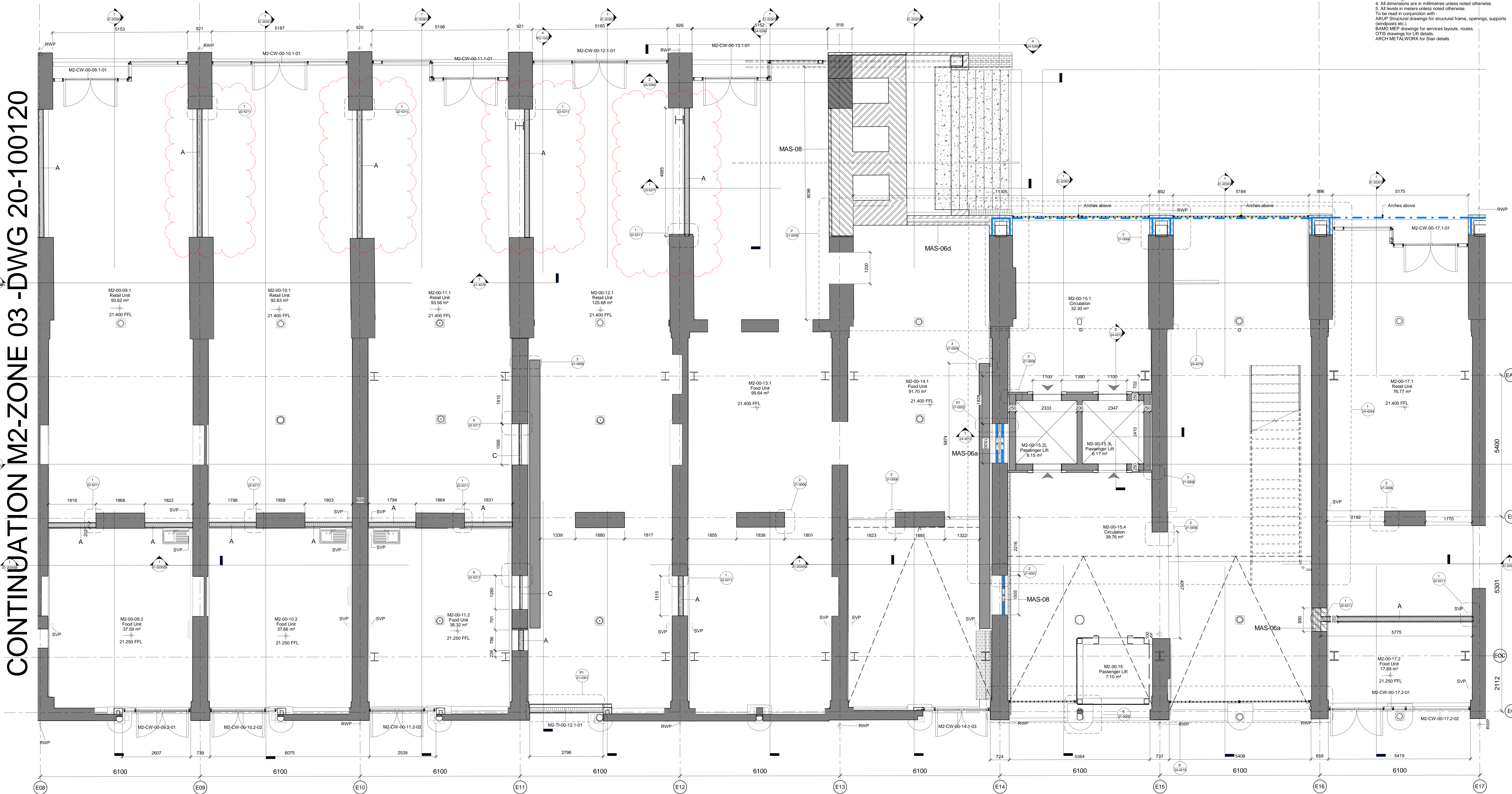

1-50 - M2-Zone 02 - Yard Level (00) GA  
 1 : 50

Wall Type	Colour	Description	Type	Colour	Description
A	Green	202 thk - 2 x 12.5 Soundblock - d146 s' C' 90 Studs - 50mm APR 1200 ONS - 18m Service Support Plate Ply - 3mm Multi Skim (See NBS Spec K10-125)	MAS 01	Red	215mm fully bonded brickwork, minimum compressive strength of >20N/mm <sup>2</sup> , walls to flush finish internally. NOTE: Final spec. TBC (See NBS Spec F10)
A2	Red	202 thk - 2 x 12.5 Soundblock - d146 s' C' 90 Studs - 50mm APR 1200 ONS - 18m Service Support Plate Ply - 3mm Multi Skim (See NBS Spec K10-125)	MAS 02	Yellow	170 thk - 100mm blockwork, 70mm Insulation (See NBS Spec F10)
B	Cyan	118 thk - 2 x 12.5 Soundblock - 92 'I' 90 Studs - 18m Service Support Plate Ply - 3mm Multi Skim (See NBS Spec K10-126)	MAS 03	Light Green	303 thk - 102.5mm brickwork, 50mm Cavity, 50mm Insulation, 100mm blockwork (See NBS Spec F10)
C	Blue	98 thk - 2 x 12.5 Soundblock - 92 'I' Studs - 18m Service Support Plate Ply - 3mm Multi Skim (See NBS Spec K10-127)	MAS 04	Light Blue	343 thk - 102.5mm brickwork, 50mm Cavity, 50mm Insulation, 140mm blockwork (See NBS Spec F10)
D	Purple	Toilet Framing - Final Spec TBC (See NBS Spec K10-128)	MAS 05	Pink	215 thk - 215mm new heritage brickwork (See NBS Spec F10)
D2	Grey	110 thk - 15 Soundblock - d146 s' C' 70 Studs - 50mm APR 1200 ONS - 3mm Multi Skim - Ceramic Tile finish. (FINAL SPEC TBC) (See NBS Spec K10)	MAS 06a	Magenta	305 thk - 102.5mm brickwork, 50mm Cavity, 50mm Insulation, 102.5mm blockwork (See NBS Spec F10)
			MAS 06b	Yellow	328 thk - 102.5mm brickwork, 50mm Cavity, 50mm Insulation, 100mm blockwork, 10mm dabs, 12.5mm Plasterboard with 3mm MultiSkim (See NBS Spec F10)
			MAS 06c	Blue	400 thk - 102.5mm brickwork, 120mm Cavity, 75mm Insulation, 102.5mm brickwork (See NBS Spec F10)
			MAS 06d	Orange	365 thk - 102.5mm brickwork, 110mm Cavity, 50mm Insulation, 102.5mm brickwork (See NBS Spec F10)
			MAS 08	Light Blue	102.5mm brickwork (See NBS Spec F10)
			MAS 09	Brown	140mm blockwork (See NBS Spec F10)
			MAS 10	Orange	210 thk - 100mm blockwork, 10mm mortar, 100mm blockwork (See NBS Spec F10)
			MAS 11	Grey	300 thk - 100mm blockwork, 50mm Cavity, 50mm Insulation, 100mm blockwork (See NBS Spec F10)
			MAS 12	Green	153 thk - 102.5mm brickwork, 50mm Insulation (See NBS Spec F10)

**Ref 22-7000 for Wall Types Schedule & Key plus 21-0000 for wall details**  
 All retail partitions to have perimeter shadow gap reveal ref 22-5211  
 - - - - - Brickwork Stretcher Bond.

NOTES:  
 Refer to:  
 ARUP Structural drawings for structural frame, openings, supports (windposts etc.) & SOFT SPOT setting out.  
 APR-19870-S-20-1GF01-103.  
 APR-19870-S-20-500000

BAMD MEP drawings for services layouts, routes. Exact sizing of duct pipe work please refer to dwgs.  
 P-52 series  
 E-1001,1002 + 1ZZ

OTIS drawings for Lift details.  
 Structural Stairways for Stair details

Rev	By	Date	Description
001	VH	12/03/17	Wall type A partition added
002	VH	12/03/17	Brickwork Stretcher Bond Indicated. Partition callouts added. Updated to comments 24.11.16 & 20.12.16
003	IAW	17/10/16	Updated for masonry package & call outs added
004	IAW	17/10/16	Updated for masonry package & call outs added
005	VH	12/05/16	Updated to suit HS comments 28.04.16. Minor amendments
006	VH	25/04/16	Issued for Construction, GL EAA & EEC addit. RWP's added
007	VH	20/04/16	Issued for Contractors Approval

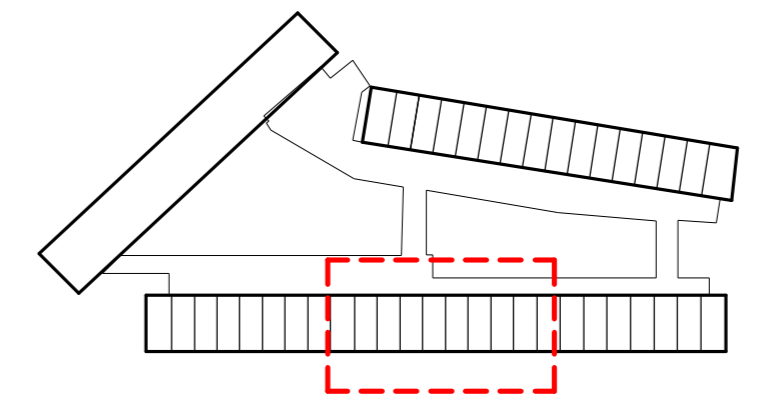

**NOTES:**  
 1. This drawing shows design intent only & is subject to detailed design from specialists.  
 2. Figured dimensions only are to be taken from this drawing. All contractors must visit site & are responsible for taking & checking all dimensions relating to their work. BAM Design to be advised of any variation between drawings & site conditions.  
 3. All vertical dimensions to be taken from FFL, please note that all manufacturing schedules are to take this into account.  
 4. All dimensions are in millimetres unless noted otherwise.  
 5. All levels in meters unless noted otherwise.  
 To be read in conjunction with:  
 - ARUP Structural drawings for structural frame, openings, supports (windposts etc.)  
 - BAMD MEP drawings for services layouts, routes.  
 - OTIS drawings for Lift details.  
 - ARCH METALWORK for Stair details

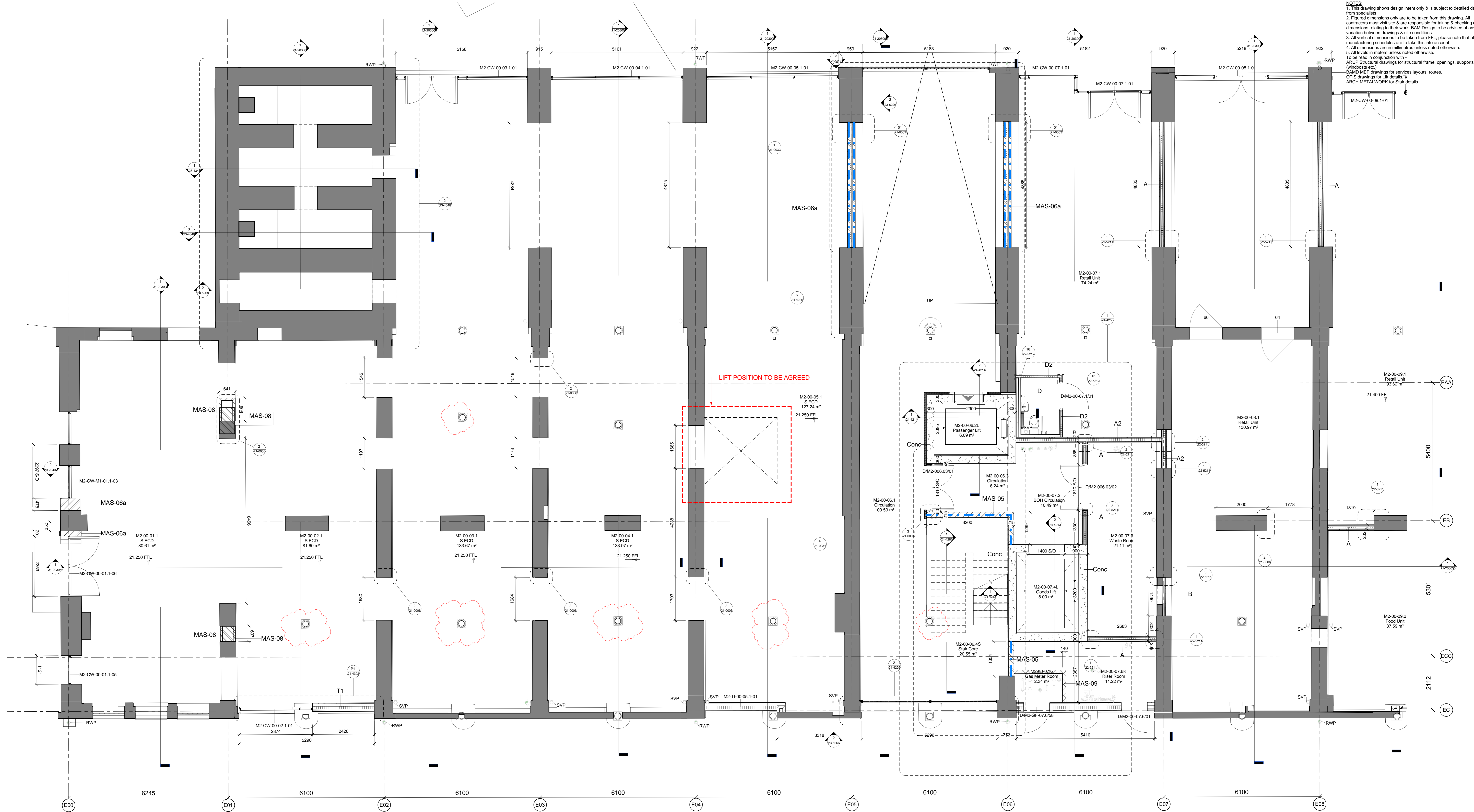

1-50 - M2-Zone 03 - Yard Level (00) - GA  
 1 : 50

Wall Type	Colour	Description
A	Green	202 thk - 2 x 12.5 Soundblock - d146 s 'C' 90 Studs - 50mm APR 1200 ONS - 18m Service Support Plate Ply - 3mm Multi Skim (See NBS Spec K10-125)
A2	Red	202 thk - 2 x 12.5 Soundblock - d146 s 'C' 90 Studs - 50mm APR 1200 ONS - 18m Service Support Plate Ply - 3mm Multi Skim (See NBS Spec K10-125)
B	Cyan	118 thk - 2 x 12.5 Soundblock - 92 'I' 90 Studs - 18m Service Support Plate Ply - 3mm Multi Skim (See NBS Spec K10-126)
C	Blue	98 thk - 2 x 12.5 Soundblock - 92 'I' Studs - 18m Service Support Plate Ply - 3mm Multi Skim (See NBS Spec K10-127)
D	Purple	Toilet Framing - Final Spec TBC (See NBS Spec K10-128)
D2	Grey	110 thk -15 Soundblock - d146 s 'C' 70 Studs - 50mm APR 1200 ONS - 3mm Multi Skim - Ceramic Tile finish. (FINAL SPEC TBC) (See NBS Spec K10)

Type	Colour	Description
MAS 01	Red	215mm fully bonded brickwork, minimum compressive strength of >20N/mmsq, walls to flush finish internally. NOTE: Final spec. TBC (See NBS Spec F10)
MAS 02	Yellow	170 thk - 100mm blockwork, 70mm Insulation (See NBS Spec F10)
MAS 03	Green	303 thk - 102.5mm brickwork, 50mm Cavity, 50mm Insulation, 100mm blockwork (See NBS Spec F10)
MAS 04	Blue	343 thk - 102.5mm brickwork, 50mm Cavity, 50mm Insulation, 140mm blockwork (See NBS Spec F10)
MAS 05	Pink	215 thk - 215mm new heritage brickwork (See NBS Spec F10)
MAS 06a	Purple	305 thk - 102.5mm brickwork, 50mm Cavity, 50mm Insulation, 102.5mm brickwork (See NBS Spec F10)

Type	Colour	Description
MAS 06b	Yellow	328 thk - 102.5mm brickwork, 50mm Cavity, 50mm Insulation, 100mm blockwork, 10mm dabs, 12.5mm Plasterboard with 3mm MultiSkim (See NBS Spec F10)
MAS 06c	Blue	400 thk - 102.5mm brickwork, 120mm Cavity, 75mm Insulation, 102.5mm brickwork (See NBS Spec F10)
MAS 06d	Orange	365 thk - 102.5mm brickwork, 110mm Cavity, 50mm Insulation, 102.5mm brickwork (See NBS Spec F10)
MAS 08	Blue	102.5mm brickwork (See NBS Spec F10)
MAS 09	Brown	140mm blockwork (See NBS Spec F10)
MAS 10	Orange	210 thk - 100mm blockwork, 10mm mortar, 100mm blockwork (See NBS Spec F10)
MAS 11	Grey	300 thk - 100mm blockwork, 50mm Cavity, 50mm Insulation, 100mm blockwork (See NBS Spec F10)
MAS 12	Green	153 thk - 102.5mm brickwork, 50mm Insulation (See NBS Spec F10)

**Ref 22-7000 for Wall Types Schedule & Key plus 21-0000 for wall details**  
**All retail partitions to have perimeter shadow gap reveal ref 22-5211**  
 - - - - Brickwork Stretcher Bond.

**NOTES:**  
 Refer to:  
 - ARUP Structural drawings for structural frame, openings, supports (windposts etc.) & SOFT SPOT setting out.  
 - APR-19870-S-20-1GF01-103.  
 - APR-19870-S-20-500000

BAMD MEP drawings for services layouts, routes. Exact sizing of duct pipe work please refer to dwgs.  
 P-52 series  
 E-1001,1002 + 1ZZ

OTIS drawings for Lift details.  
 Structural Stairways for Stair details

Rev	By	Date	Description	
006	VH	agw	06-04-17	Col reinstated as per review.
005	VH	IAW	23/01/17	Brickwork Stretcher Bond Indicated. Partition callouts added. Updated to comments 24.11.16 & 20.12.16
004	IAW	IAW	17/10/16	Updated for masonry package & call outs added
003	VH	MWB	12/05/16	Updated to suit HS comments 28.04.16. Minor amendments
002	VH	MWB	25/04/16	Issued for Construction. GL EAA & ECC added. RWP's added
001	VH	MWB	20/04/16	Issued for Contractors Approval

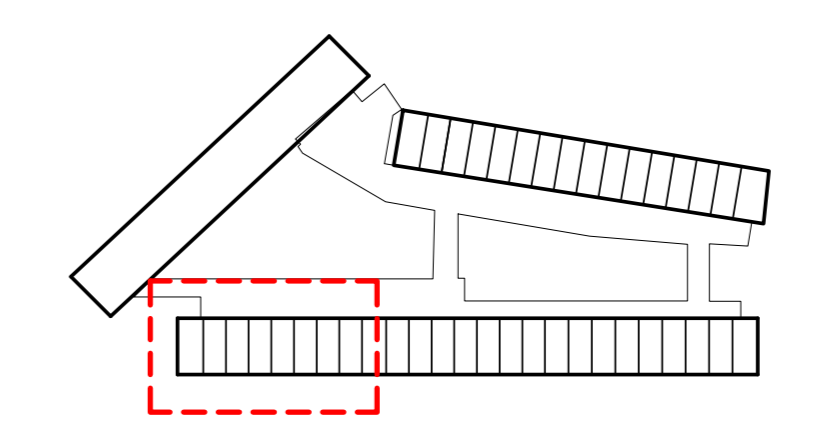

**bam**  
 BAM Design  
 30 Southmead  
 Avonmouth  
 Bristol  
 BS11 8AA  
 0117 933000  
 www.bam.co.uk

CONTINUATION M1-ZONE 02 -DWG 20-100125

DO NOT SCALE FROM THIS DRAWING.  
 ALL DIMENSIONS TO BE CHECKED ON SITE.  
 FOR REFERENCED VIEWS REFER TO KXC-M1-001-A-  
 SERIES OF DRAWINGS

NOTES:  
 1. This drawing shows design intent only & is subject to detailed design from specialists.  
 2. Figured dimensions only are to be taken from this drawing. All contractors must visit site & are responsible for taking & checking all dimensions relating to their work. BAM Design to be advised of any variation between drawings & site conditions.  
 3. All vertical dimensions to be taken from FFL, please note that all manufacturing schedules are to take this into account.  
 4. All dimensions are in millimetres unless noted otherwise.  
 5. All levels in meters unless noted otherwise.  
 To be read in conjunction with:  
 ARUP Structural drawings for structural frame, openings, supports (windposts etc.)  
 BAMD MEP drawings for services layouts, routes, OTIS drawings for Lift details.  
 ARCH METALWORK for Stair details

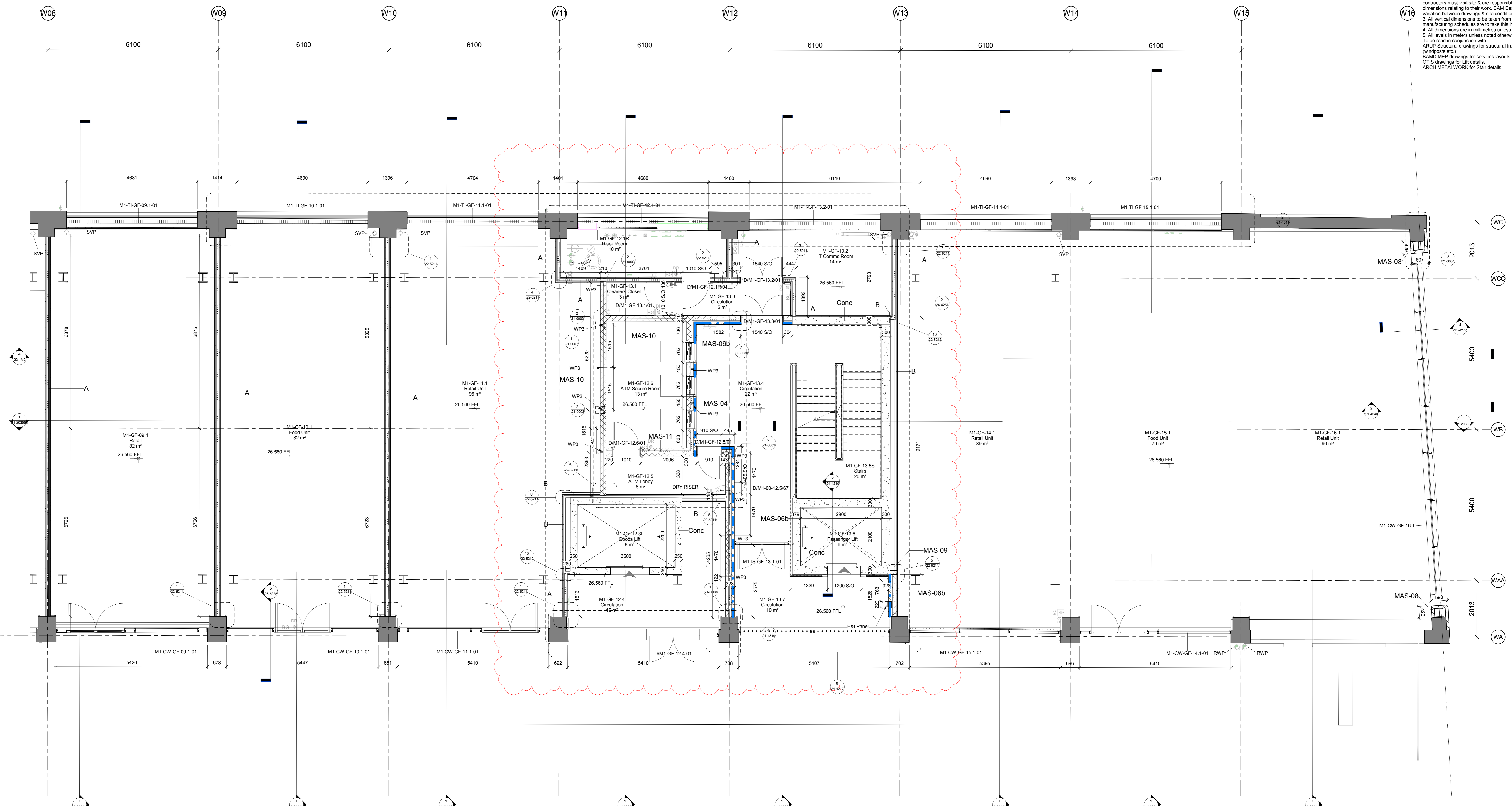

1 1-50 - M1-Zone 01 - Viaduct Level (GF) - GA  
 1 : 50

Wall Type	Colour	Description
A	Green	202 thk - 2 x 12.5 Soundblock - d146 s'C 90 Studs - 50mm APR 1200 ONS - 18m Service Support Plate Ply - 3mm Multi Skim (See NBS Spec K10-125)
A2	Red	202 thk - 2 x 12.5 Soundblock - d146 s'C 90 Studs - 50mm APR 1200 ONS - 18m Service Support Plate Ply - 3mm Multi Skim (See NBS Spec K10-125)
B	Blue	118 thk - 2 x 12.5 Soundblock - 92 'I' 90 Studs - 18m Service Support Plate Ply - 3mm Multi Skim (See NBS Spec K10-126)
C	Dark Blue	98 thk - 2 x 12.5 Soundblock - 92 'I' Studs - 18m Service Support Plate Ply - 3mm Multi Skim (See NBS Spec K10-127)
D	Purple	Toilet Framing - Final Spec TBC (See NBS Spec K10-128)
D2	Grey	110 thk - 15 Soundblock - d146 s'C 70 Studs - 50mm APR 1200 ONS - 3mm Multi Skim - Ceramic Tile finish. (FINAL SPEC TBC) (See NBS Spec K10)

Type	Colour	Description
MAS 01	Red	215mm fully bonded brickwork, minimum compressive strength of >20N/mmsq, walls to flush finish internally. NOTE: Final spec. TBC (See NBS Spec F10)
MAS 02	Yellow	170 thk - 100mm blockwork, 70mm Insulation (See NBS Spec F10)
MAS 03	Green	303 thk - 102.5mm brickwork, 50mm Cavity, 50mm Insulation, 100mm blockwork (See NBS Spec F10)
MAS 04	Blue	343 thk - 102.5mm brickwork, 50mm Cavity, 50mm Insulation, 140mm blockwork (See NBS Spec F10)
MAS 05	Pink	215 thk - 215mm new heritage brickwork (See NBS Spec F10)
MAS 06a	Purple	305 thk - 102.5mm brickwork, 50mm Cavity, 50mm Insulation, 102.5mm brickwork (See NBS Spec F10)

Type	Colour	Description
MAS 06b	Yellow	328 thk - 102.5mm brickwork, 50mm Cavity, 50mm Insulation, 100mm blockwork, 10mm dabs, 12.5mm Plasterboard with 3mm MultiSkim (See NBS Spec F10)
MAS 06c	Blue	400 thk - 102.5mm brickwork, 120mm Cavity, 75mm Insulation, 102.5mm brickwork (See NBS Spec F10)
MAS 06d	Red	365 thk - 102.5mm brickwork, 110mm Cavity, 50mm Insulation, 102.5mm brickwork (See NBS Spec F10)
MAS 08	Blue	102.5mm brickwork (See NBS Spec F10)
MAS 09	Red	140mm blockwork (See NBS Spec F10)
MAS 10	Green	210 thk - 100mm blockwork, 10mm mortar, 100mm blockwork (See NBS Spec F10)
MAS 11	Grey	300 thk - 100mm blockwork, 50mm Cavity, 50mm Insulation, 100mm blockwork (See NBS Spec F10)
MAS 12	Green	153 thk - 102.5mm brickwork, 50mm Insulation (See NBS Spec F10)

**Ref 22-7000 for Wall Types Schedule & Key plus 21-0000 for wall details**  
**All retail partitions to have perimeter shadow gap reveal ref 22-5211**  
 - - - Brickwork Stretcher Bond.

NOTES:  
 Refer to:  
 ARUP Structural drawings for structural frame, openings, supports (windposts etc.) & SOFT SPOT setting out.  
 APR-19870-S-20-1GF01-103.  
 APR-19870-S-20-5000000

BAMD MEP drawings for services layouts, routes. Exact sizing of duct pipe work please refer to dwgs.  
 P-52 series  
 E-1001,1002 + 1ZZ

OTIS drawings for Lift details.  
 Structural Stairways for Stair details

No	Rev	Date	Description
006	IAW	10/03/17	Additional Setting out dimensions shown
005	VH	23/01/17	Brick Stretcher Bond indicated. Partition callouts added. Updated to comments 24.11.16 & 25.12.16
004	YTB	25/10/16	Windposts added, recessed E&P panels added / updated
003	IAW	17/10/16	Updated for masonry package & call outs added
002	VH	12/05/16	Issued for Construction. GL WAA & WCC added. RWP & soft spots noted
001	VH	15/04/16	Issued for Construction Approval

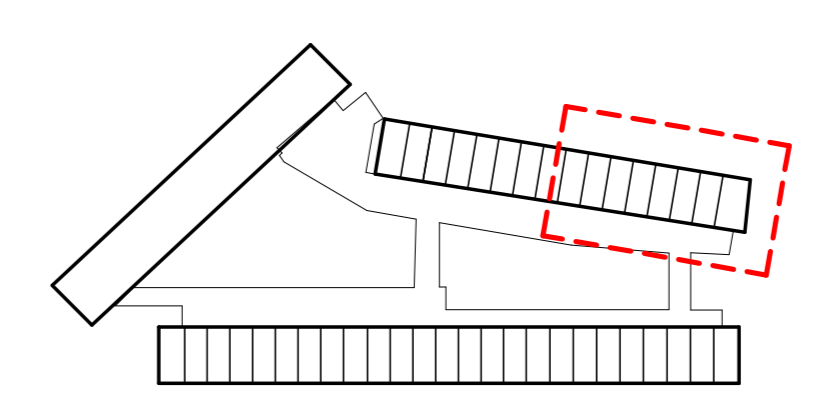

**bam**  
 BAM Design  
 30 St Leonards  
 Newcastle, NSW 2202  
 Australia  
 Tel: +61 2 4939 6000  
 Fax: +61 2 4939 6001  
 www.bam.com.au

PROJECT COAL DROPS YARD  
 M1 - Zone 01 - Viaduct Level (GF) GA  
 Construction  
 As indicated @ A0  
 03/16/16  
 DCW  
 MWB  
 4389  
 S4  
 KXC-M1-001-BD4389-A-20-100124 006



NOTES:  
 1. This drawing shows design intent only & is subject to detailed design from specialists.  
 2. Figured dimensions only are to be taken from this drawing. All contractors must visit site & are responsible for taking & checking all dimensions relating to their work. BAM Design to be advised of any variation between drawings & site conditions.  
 3. All vertical dimensions to be taken from FTL, please note that all manufacturing schedules are to take this into account.  
 4. All dimensions are in millimetres unless noted otherwise.  
 5. All levels in meters unless noted otherwise.  
 To be read in conjunction with:  
 ARUP Structural drawings for structural frame, openings, supports (windposts etc.)  
 BAMD MEP drawings for services layouts, routes, OTIS drawings for Lift details.  
 ARCH METALWORK for Stair details

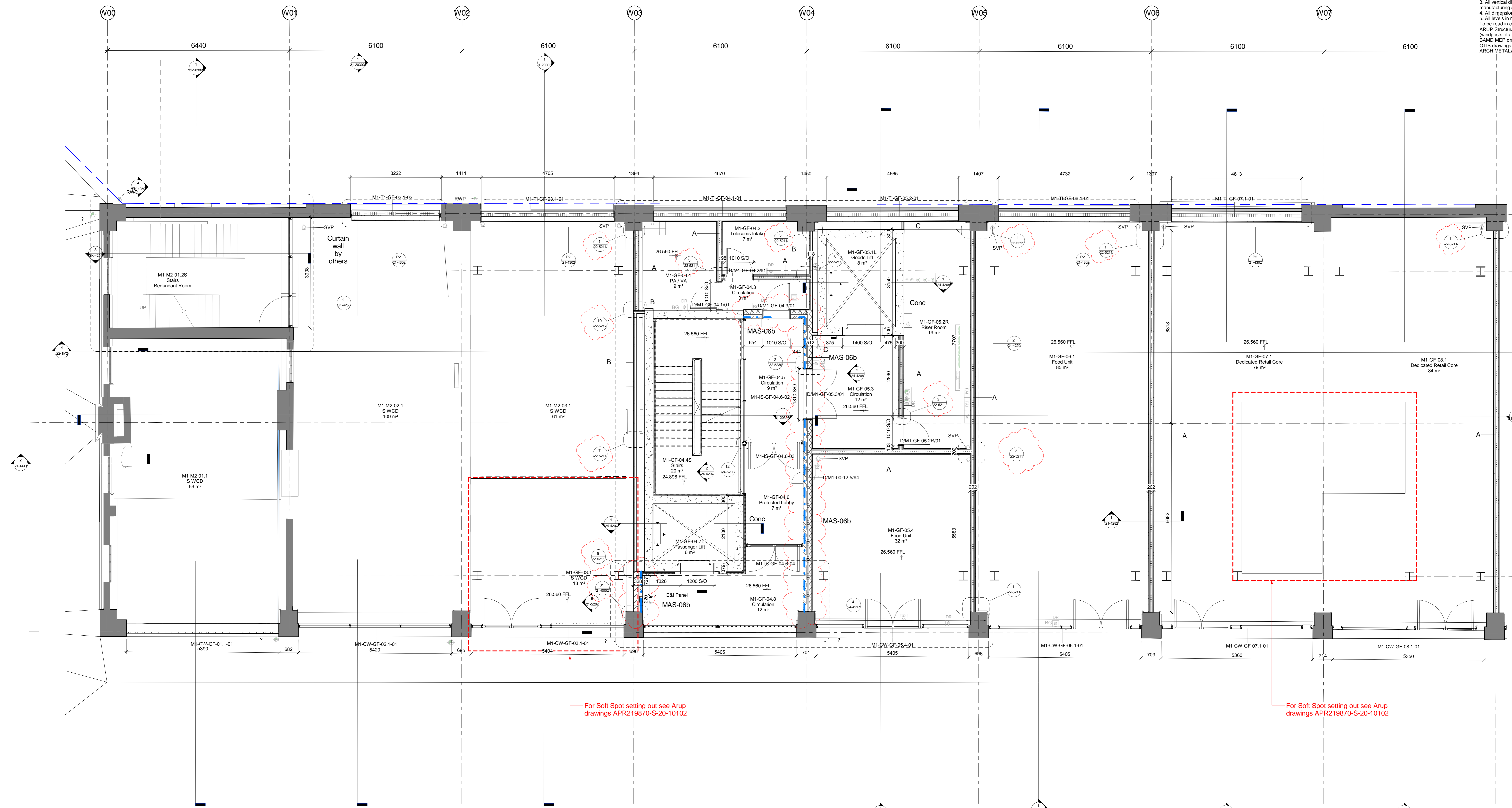

CONTINUATION M1-ZONE 01 - DWG 20-1001124

1 1-50 - M1-Zone 02 - Viaduct Level (GF) - GA  
 1: 50

Wall Type	Colour	Description
A	Green	202 thk - 2 x 12.5 Soundblock - d146 s' C' 90 Studs - 50mm APR 1200 ONS - 18m Service Support Plate Ply - 3mm Multi Skim (See NBS Spec K10-125)
A2	Red	202 thk - 2 x 12.5 Soundblock - d146 s' C' 90 Studs - 50mm APR 1200 ONS - 18m Service Support Plate Ply - 3mm Multi Skim (See NBS Spec K10-125)
B	Cyan	118 thk - 2 x 12.5 Soundblock - 92 'I' 90 Studs - 18m Service Support Plate Ply - 3mm Multi Skim (See NBS Spec K10-126)
C	Blue	98 thk - 2 x 12.5 Soundblock - 92 'I' Studs - 18m Service Support Plate Ply - 3mm Multi Skim (See NBS Spec K10-127)
D	Purple	Toilet Framing - Final Spec TBC (See NBS Spec K10-128)
D2	Grey	110 thk - 15 Soundblock - d146 s' C' 70 Studs - 50mm APR 1200 ONS - 3mm Multi Skim - Ceramic Tile finish. (FINAL SPEC TBC) (See NBS Spec K10)

Type	Colour	Description
MAS 01	Red	215mm fully bonded brickwork, minimum compressive strength of >20N/mmsq, walls to flush finish internally. NOTE: Final spec. TBC (See NBS Spec F10)
MAS 02	Yellow	170 thk - 100mm blockwork, 70mm Insulation (See NBS Spec F10)
MAS 03	Green	303 thk - 102.5mm brickwork, 50mm Cavity, 50mm Insulation, 100mm blockwork (See NBS Spec F10)
MAS 04	Blue	343 thk - 102.5mm brickwork, 50mm Cavity, 50mm Insulation, 140mm blockwork (See NBS Spec F10)
MAS 05	Pink	215 thk - 215mm new heritage brickwork (See NBS Spec F10)
MAS 06a	Purple	305 thk - 102.5mm brickwork, 50mm Cavity, 50mm Insulation, 102.5mm brickwork (See NBS Spec F10)

Type	Colour	Description
MAS 06b	Yellow	328 thk - 102.5mm brickwork, 50mm Cavity, 50mm Insulation, 100mm blockwork, 10mm dabs, 12.5mm Plasterboard with 3mm MultiSkim (See NBS Spec F10)
MAS 06c	Blue	400 thk - 102.5mm brickwork, 120mm Cavity, 75mm Insulation, 102.5mm brickwork (See NBS Spec F10)
MAS 06d	Orange	365 thk - 102.5mm brickwork, 110mm Cavity, 50mm Insulation, 102.5mm brickwork (See NBS Spec F10)
MAS 08	Blue	102.5mm brickwork (See NBS Spec F10)
MAS 09	Brown	140mm blockwork (See NBS Spec F10)
MAS 10	Orange	210 thk - 100mm blockwork, 10mm mortar, 100mm blockwork (See NBS Spec F10)
MAS 11	Grey	300 thk - 100mm blockwork, 50mm Cavity, 50mm Insulation, 100mm blockwork (See NBS Spec F10)
MAS 12	Green	153 thk - 102.5mm brickwork, 50mm Insulation (See NBS Spec F10)

**Ref 22-7000 for Wall Types Schedule & Key plus 21-0000 for wall details**  
**All retail partitions to have perimeter shadow gap reveal ref 22-5211**  
 --- Brickwork Stretcher Bond.

NOTES:  
 Refer to:  
 ARUP Structural drawings for structural frame, openings, supports (windposts etc.) & SOFT SPOT setting out.  
 APR-19870-S-20-1GF01-103.  
 APR-19870-S-20-500000

BAMD MEP drawings for services layouts, routes. Exact sizing of duct pipe work please ref to dwgs.  
 P-52 series  
 E-1001,1002 + 1ZZ

OTIS drawings for Lift details.  
 Structural Stairways for Stair details

Rev	By	Date	Description
005	VH	23/01/17	Brickwork Stretcher Bond indicated. Partition colours added. Updated to comments 24.11.16 & 20.12.16
004	YTB	25/10/16	Increased E&I panels added / updated
003	IAW	17/10/16	Updated for masonry package & call outs added
002	MWB	12/05/16	Issued for Construction, GL WAA & WCC added. RWP & soft spots noted.
001	VH	15/04/16	Issued for Construction Approval

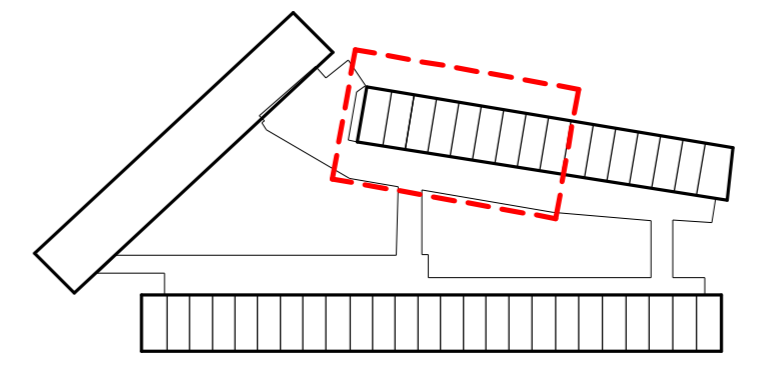

PROJECT: COAL DROPS YARD

M1 - Zone 02 - Viaduct Level (GF) GA

As indicated @ A0  
 03/16/16  
 KXC-M1-001-BD4389-A-20-100125 005

drawn DCW  
 checked MWB  
 4389

Construction  
 S4