

PLANNING

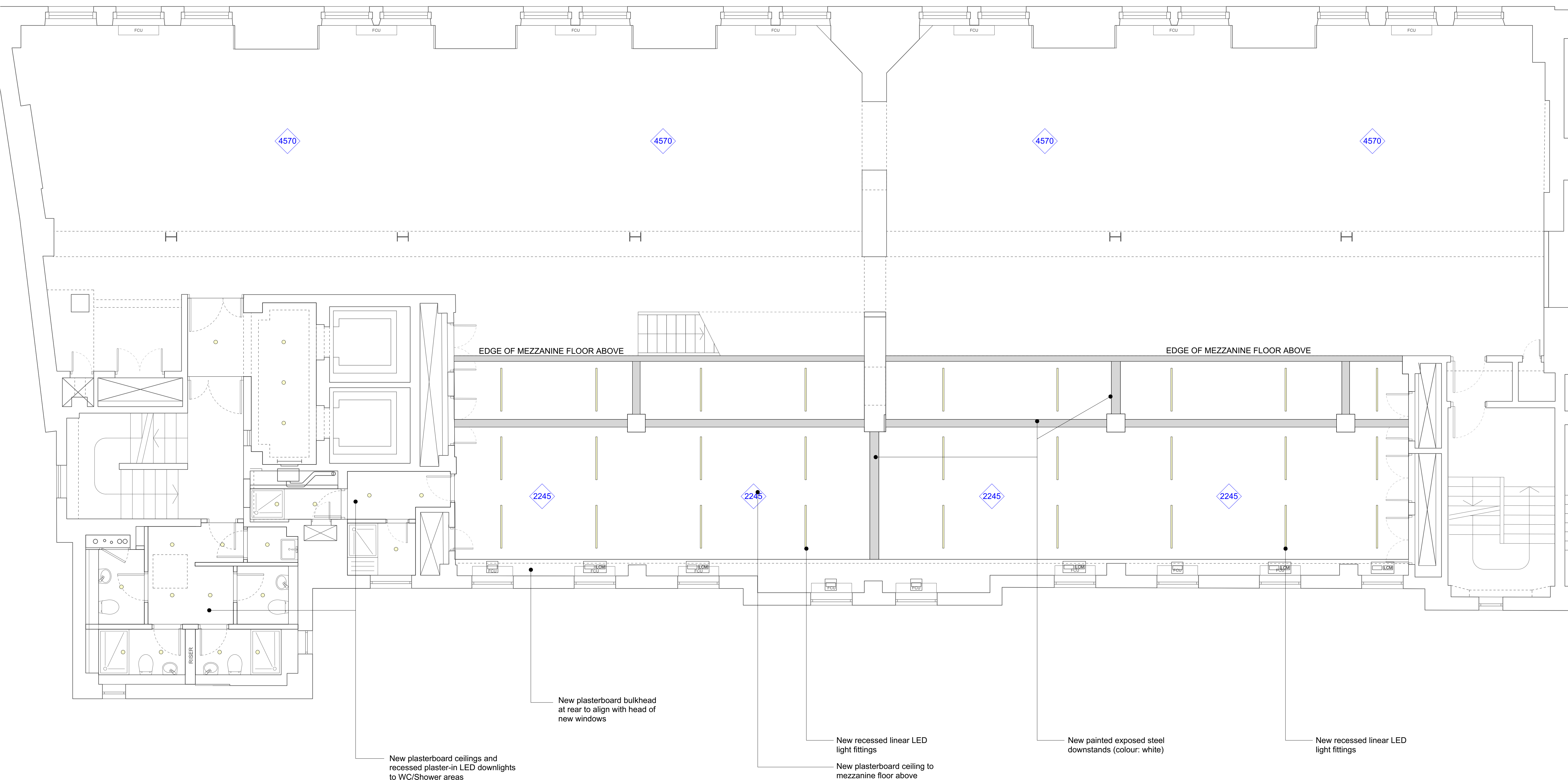

01 Proposed Second Floor RCP - Low Level (203)
Scale 1:50@A1/1:100@A3



<p>NOTES:-</p> <ul style="list-style-type: none"> - All dimensions to be checked on site prior to commencement of any works, and/or preparation of any shop drawings. - Sizes of and dimensions to any structural or services elements are indicative only. See structural and service engineers drawings for actual sizes / dimensions. - This drawing to be read in conjunction with all other Architect's drawings, specifications and other Consultants' information. - All proprietary systems shown on this drawing are to be installed strictly in accordance with the Manufacturers/Suppliers recommended details. - Any discrepancies between information shown on this drawing and any other contract information or manufacturers/suppliers recommendations is to be brought to the attention of the Architect. 	Revision	Date	Amendment	<div> <div>Date</div> <div>June 2017</div> <div>Scale</div> <div>1:50 @A1</div> <div>Status</div> <div>Planning</div> <div>Architect</div> <div>Hale Brown Architects Ltd, Unit 2.01 Chester House, Kennington Park, 1-3 Brixton Rd, London SW9 6DE T: 020 8977 6946 E: mail@halebrown.com W: www.halebrown.com</div> </div>
	PL1	21.06.17	Issued for Planning	
	-	-	-	
	-	-	-	
	-	-	-	
	-	-	-	
	-	-	-	
				<div> <div>Project</div> <div>Eversholt St, Euston</div> <div>Title</div> <div>Proposed Second Floor RCP - Low Level (203)</div> <div>Client Ref</div> <div>Drwg. no. 258(PL)208</div> <div>Rev.</div> <div>PL1</div> <div>Job Ref</div> <div>258 NEV</div> </div> <div>  </div>