

Rev	Date	By	Check	Details	Appr.
A	18/07/16	EF	AC	Pedestrian path and additional details added	PGK
B	12/08/16	EF	AC	Status updated to "Contractors Proposals"	PGK

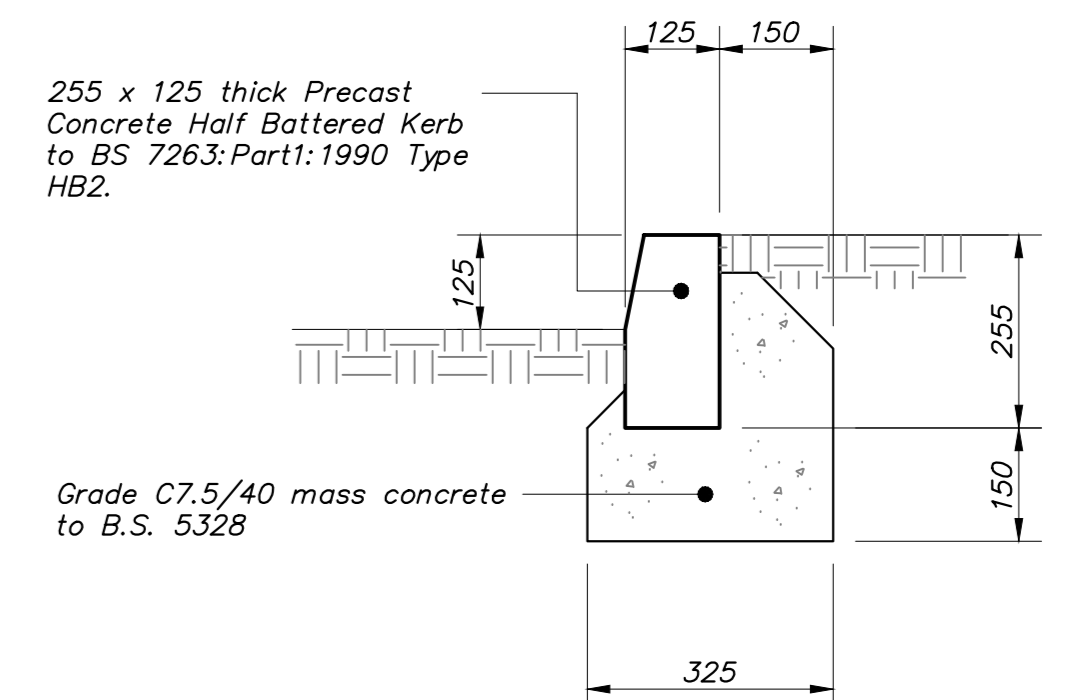

Half Battered Kerb  
1:10

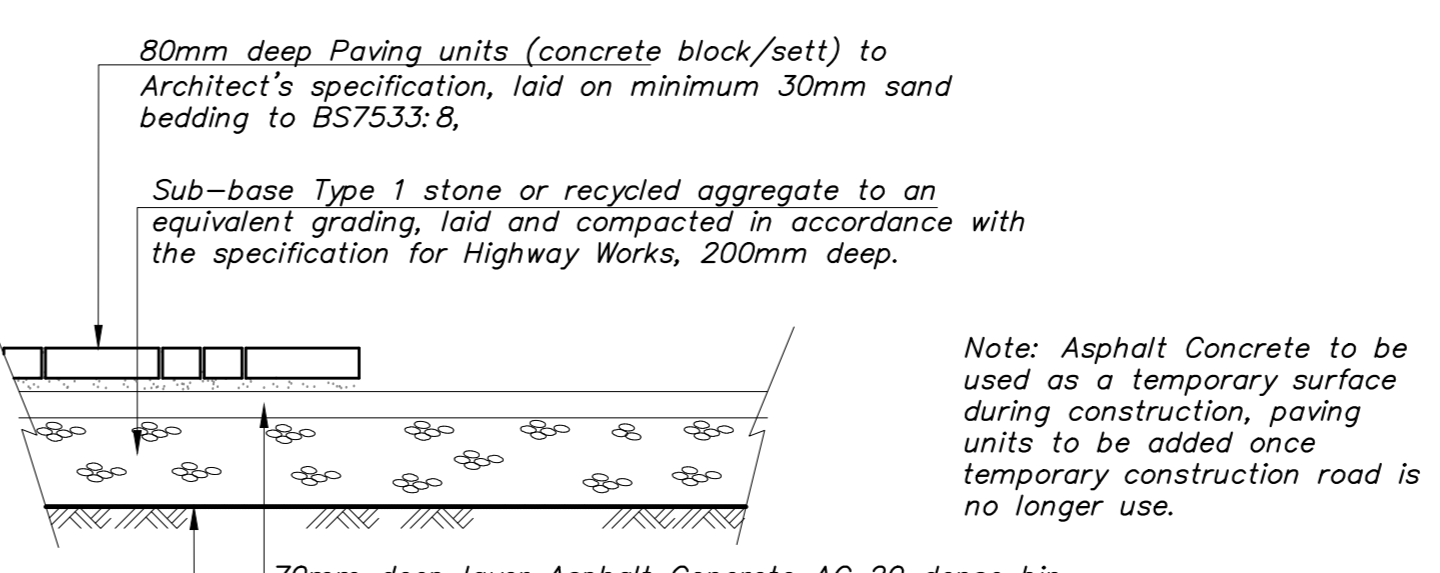
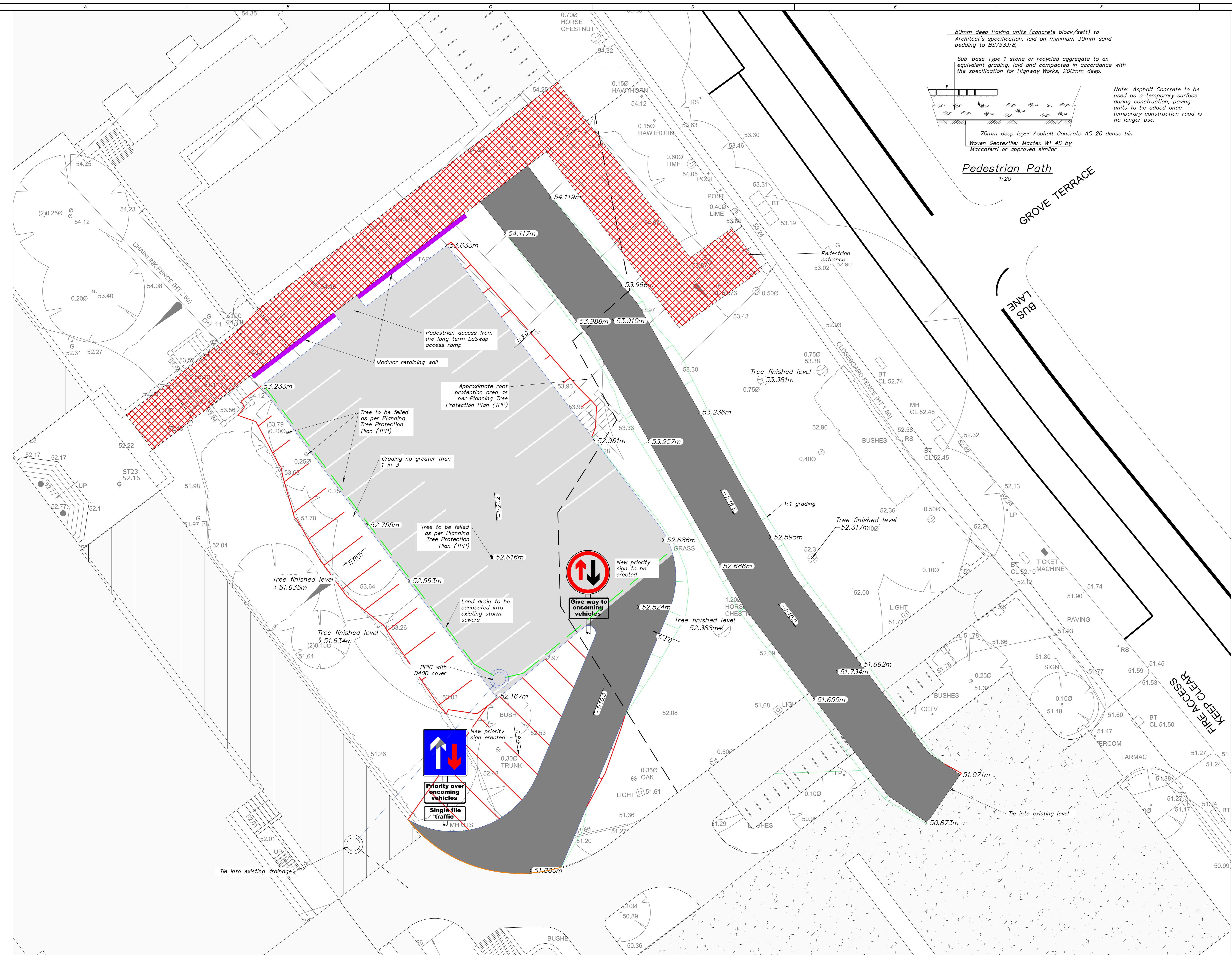
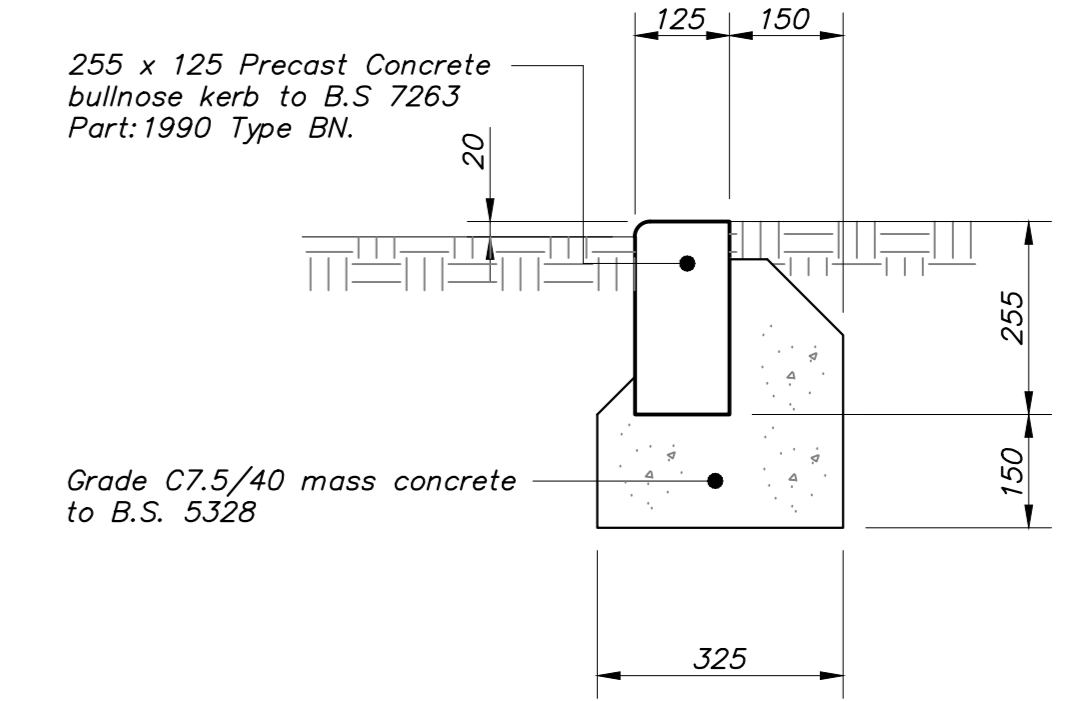

Bullnose Kerb  
1:10

**Legend**

- Fill Slope
- Cut Slope
- Half Battered Kerb
- Drop Kerb

**Note**

Input from Arboriculturist required to insure proposed layout and construction details are acceptable.

**Cut/Fill Volumes**

Top soil to be removed for Carpark = 110m<sup>3</sup>\*  
Top soil to be removed for Road = 35m<sup>3</sup>\*

**Carpark**

Cut = 39m<sup>3</sup>  
(Note that the location the proposed formation levels are higher than the existing levels of the nearby trees, therefore it is assumed that this cut will not damage the tree roots. An arboriculturist required to insure that this assumption is correct.)

**Temporary Road**

Cut = 7m<sup>3</sup>  
Fill = 30m<sup>3</sup>  
Net = 23m<sup>3</sup>

**Total**

Net = 368m<sup>3</sup> (Cut)

\*Estimate assuming topsoil to be 150mm deep  
\*\*Above volumes estimated by comparing approximate existing levels (after topsoil has been removed) and proposed formation levels.

Status	Date	By	Check	Drawing Status	Details	Appr.

**CONTRACTORS PROPOSALS DRAWING**

Project Title:  
**Parliament Hill School**  
London

Drawing Title:  
**Proposed Temporary Carpark Layout & Build Up Details**

Client/Architect:	Farrons (Construction) LTD	Date:	June 2016
Drawn by:	EF	Scale:	Varies
Checked by:	AC	Sheet Size:	A0
Approved by:	PGK	Drawing Number:	

Project Number:	Orig.	Zone:	Level:	Type:	Disc.	Number:	Revision:
152046	DC	SW	XX	GA	C	016	B

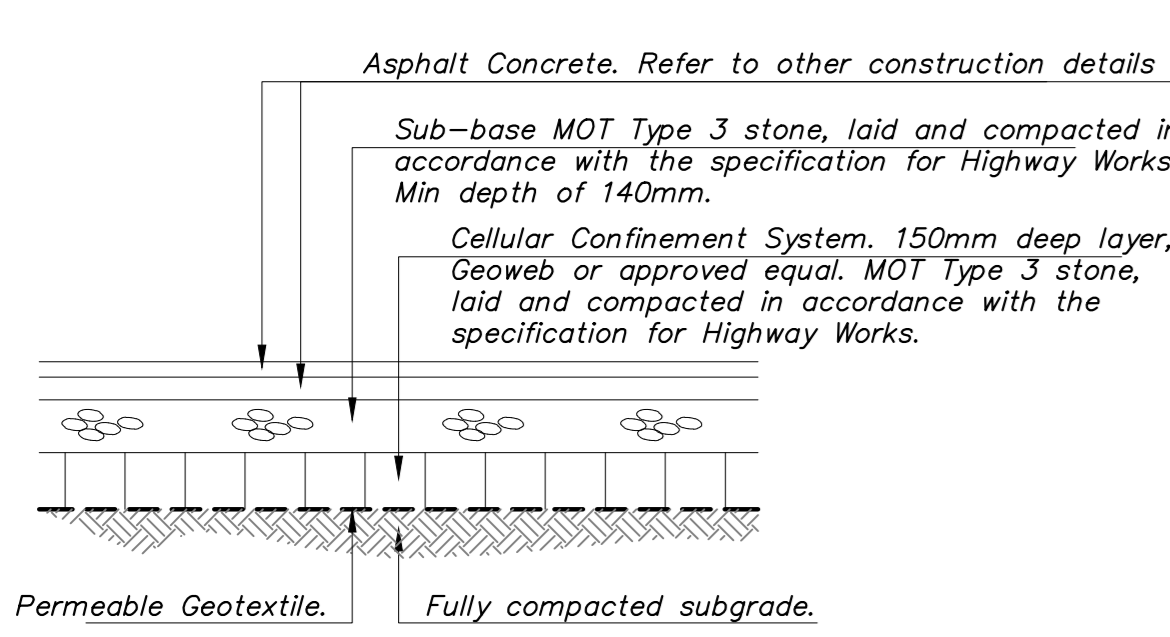

Temporary Car Park Construction in Tree Root Protection Areas  
1:20

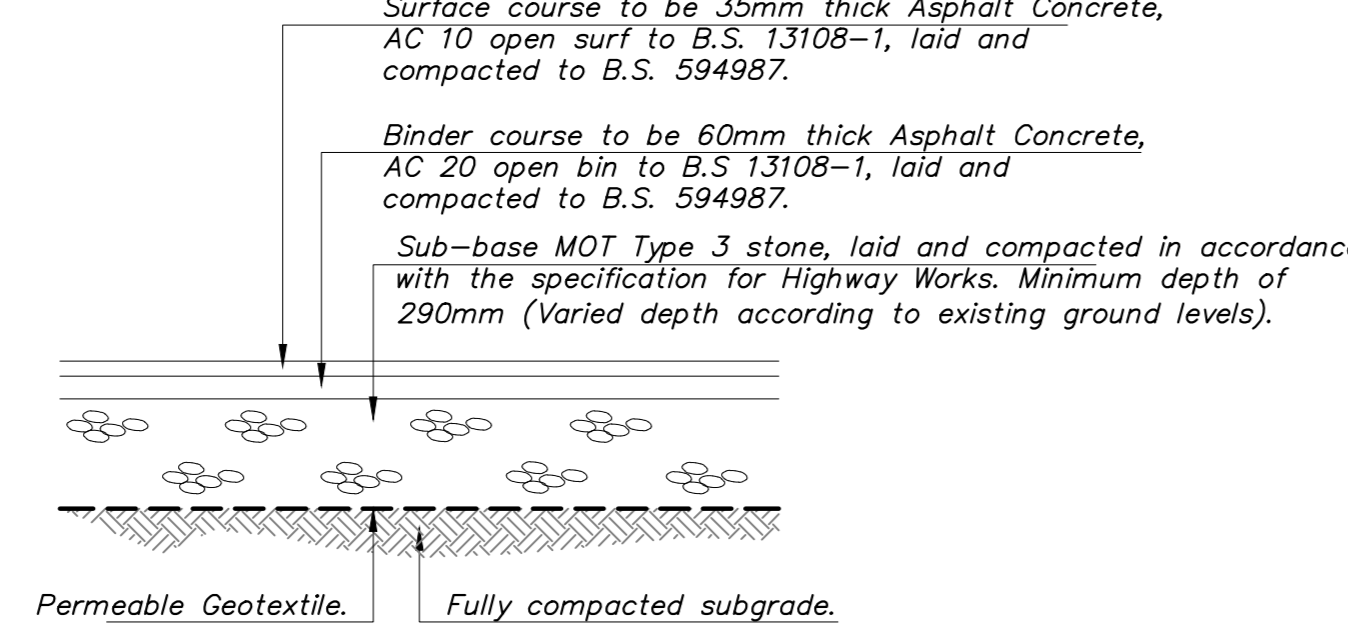

Temporary Car Park Construction  
1:20

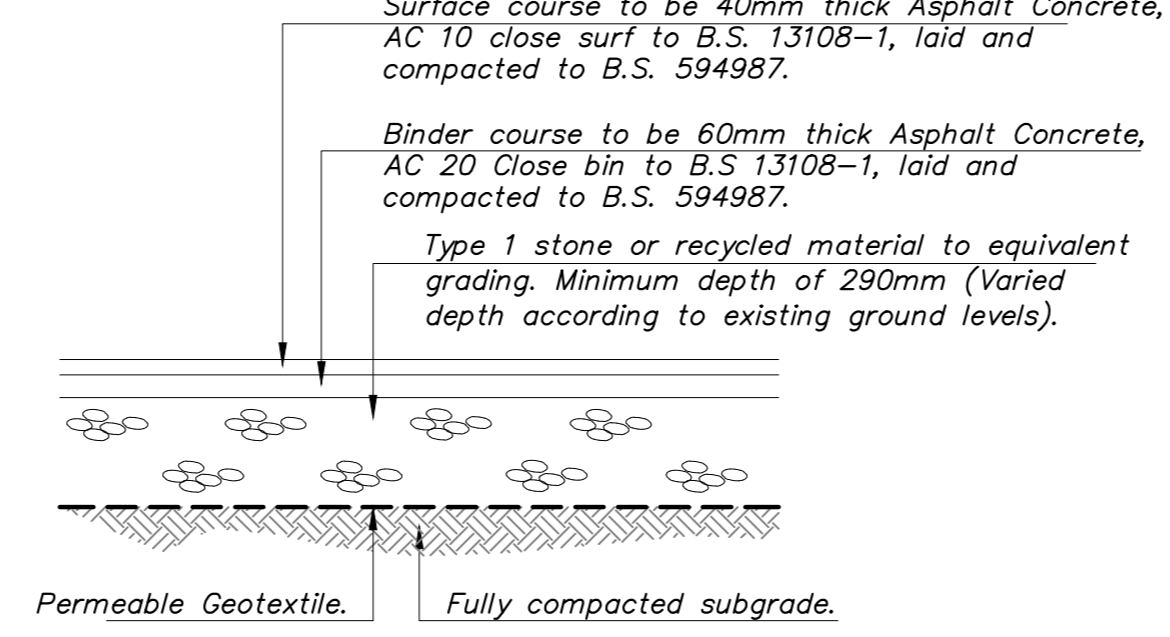

Temporary Car Park Entrance Construction  
1:20

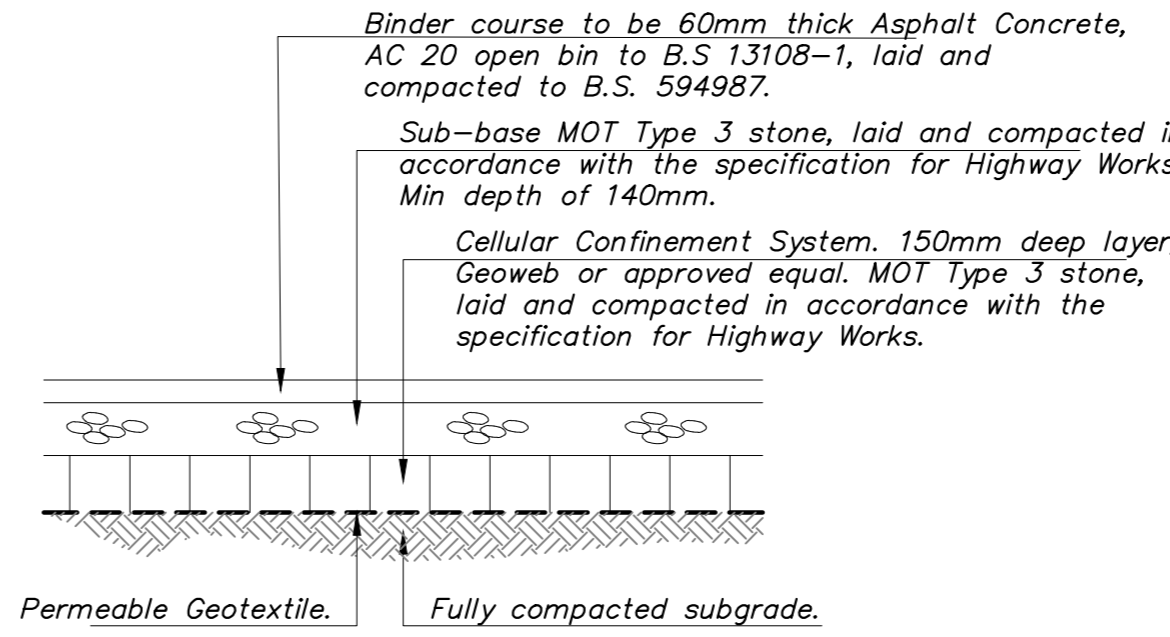

Temporary Road Construction in Tree Root Protection Areas  
1:20

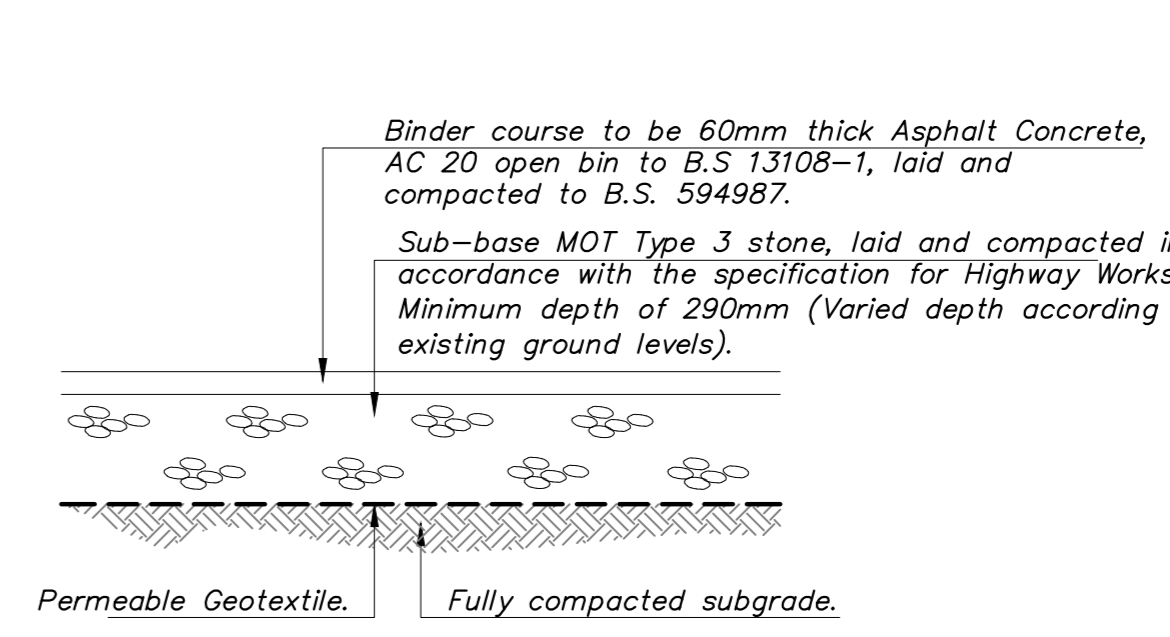

Temporary Road Construction  
1:20