

Demolish existing mass concrete external steps, dig out earth below in preparation for new retaining wall to existing lightwell

Strip out redundant internal doors and associated partitions

Remove Entrance door to upper maisonette flat

Remove and reclaim entrance door to lower ground floor flat

Strip out joinery and sanitaryware fixtures and fittings

Demolish rear chimney breast

Remove kitchen and entrance lobby associated with LGF flat.

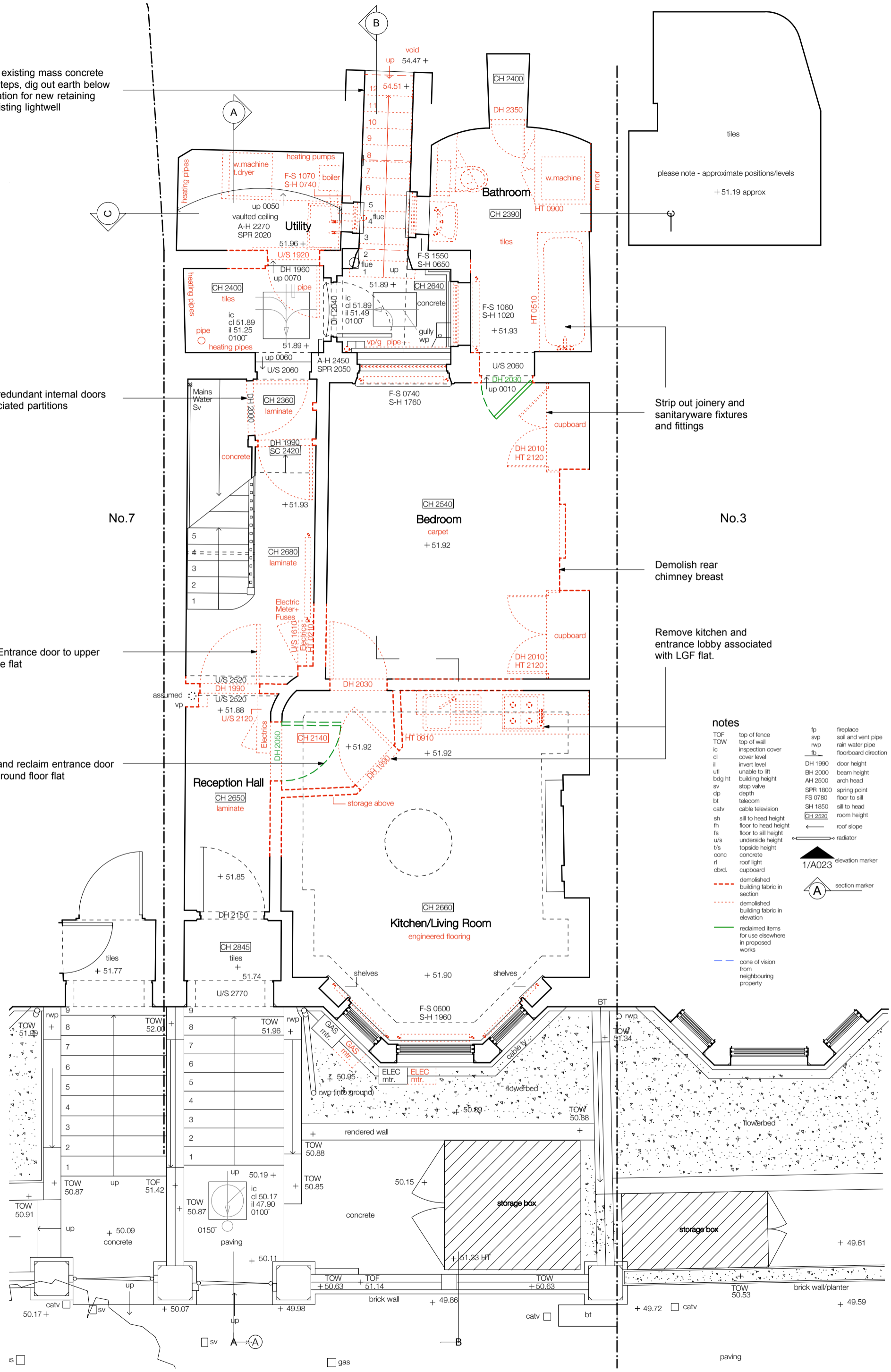
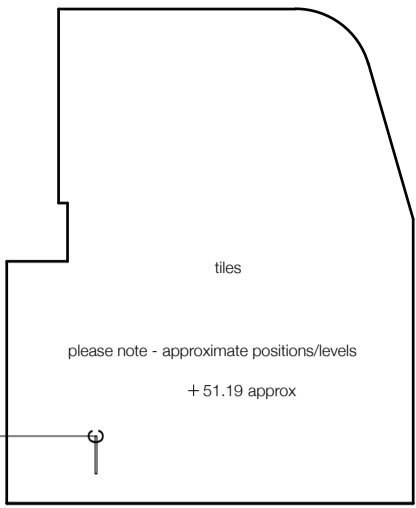

- notes**
- | | | | |
|--------|----------------------|----------|----------------------|
| TOF | top of fence | fp | fireplace |
| TOW | top of wall | svp | soil and vent pipe |
| ic | inspection cover | rwp | rain water pipe |
| cl | cover level | fb | floorboard direction |
| il | invert level | DH 1990 | door height |
| util | unable to lift | BH 2000 | beam height |
| bdg ht | building height | AH 2500 | arch head |
| sv | stop valve | SPR 1800 | spring point |
| dp | depth | FS 0780 | floor to sill |
| bt | telecom | SH 1850 | sill to head |
| catv | cable television | CH 2520 | room height |
| sh | sill to head height | | |
| fh | floor to head height | | |
| fs | floor to sill height | | |
| u/s | underside height | | |
| t/s | topside height | | |
| conc | concrete | | |
| rl | roof light | | |
| cbrd. | cupboard | | |
- ▲ elevation marker
 1/A023
 ○ section marker
- - - demolished building fabric in section
 - - - demolished building fabric in elevation
 - reclaimed items for use elsewhere in proposed works
 - cone of vision from neighbouring property