

existing open light well

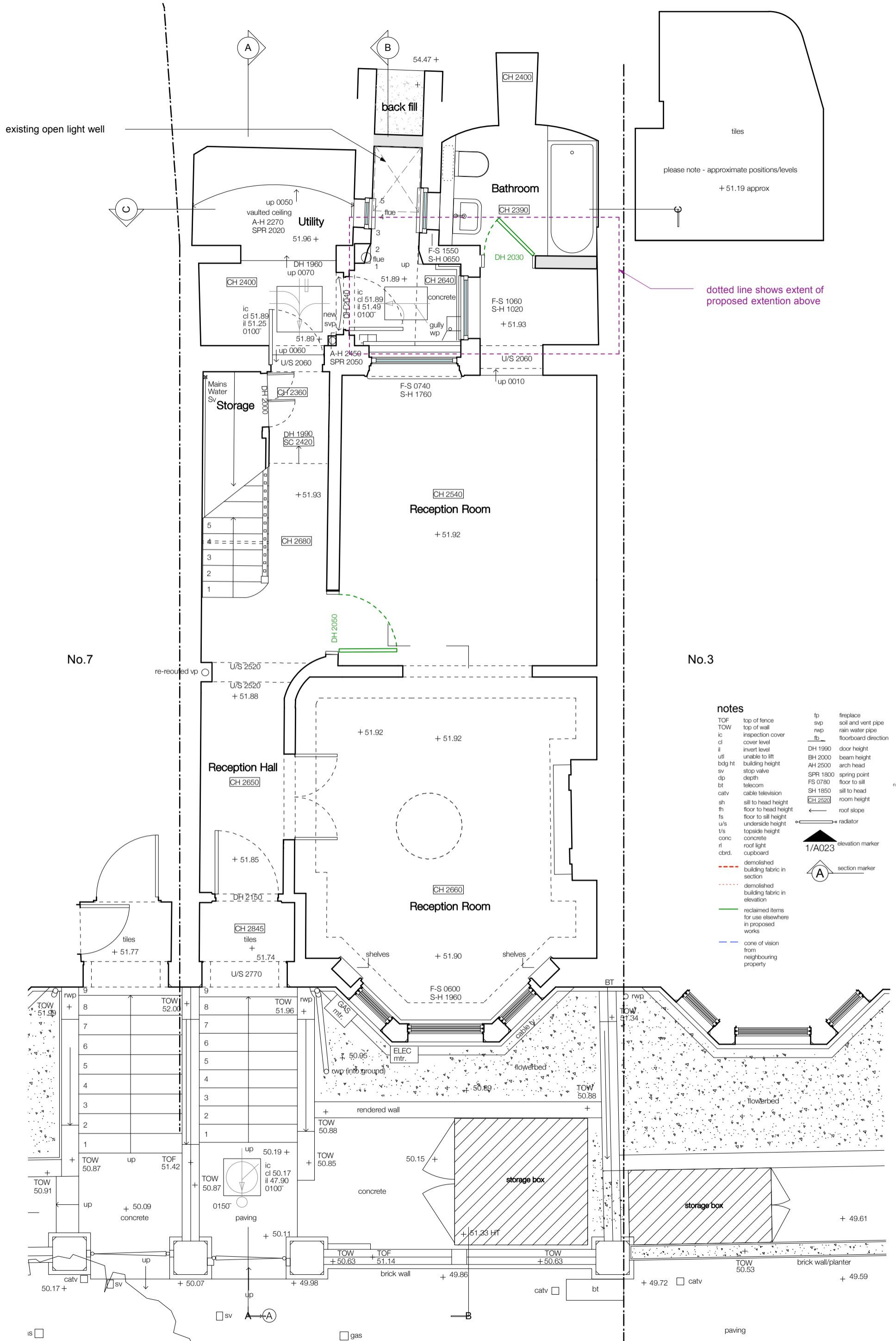

dotted line shows extent of proposed extension above

please note - approximate positions/levels
+ 51.19 approx

No.7

No.3

- notes**
- TOF top of fence
 - TOW top of wall
 - ic inspection cover
 - cl cover level
 - il invert level
 - utl unable to lift
 - bdg ht building height
 - sv stop valve
 - dp depth
 - bt telecom
 - catv cable television
 - sh sill to head height
 - fh floor to head height
 - fs floor to sill height
 - u/s underside height
 - t/s topside height
 - conc concrete
 - rl roof light
 - cbrd. cupboard
 - fp fireplace
 - svp soil and vent pipe
 - rwp rain water pipe
 - fb floorboard direction
 - DH 1990 door height
 - BH 2000 beam height
 - AH 2500 arch head
 - FS 0780 spring point
 - SH 1850 floor to sill
 - SH 1850 sill to head
 - CH 2520 room height
 - roof slope
 - radiator
 - 1/A023 elevation marker
 - A section marker
- demolished building fabric in section
--- demolished building fabric in elevation
--- reclaimed items for use elsewhere in proposed works
--- cone of vision from neighbouring property

TITLE: Ground Floor Plan (proposed)

NO: P1100 REV: P1

SANYA POLESCUK ARCHITECTS

PROJECT: 5 South Hill Park, NW3 2ST

SCALE: 1:50

PAPER: A3

DATE: 19 June 2017

8a BELSIZE COURT GARAGES LONDON NW3 5AJ
T:0207 431 8580 e-mail:enquiries@polescukarchitects.com