

BASED ON SURVEY BY OTHERS

General notes:

- 1. Shading indicates new construction.
- 2. All existing bathroom, kitchen and sanitaryware fittings to be removed.
- 3. Original joinery to be recorded and set aside for resale where removal necessary.
- 4. No original door survived throughout the house. New door details to follow those of DIA drawings.
- 5. Fireplaces and hearth surrounds to be retained unless noted otherwise. Existing chimney flues to be unblocked and lined.
- 6. Existing services and drains removed and replaced throughout.
- 7. Overhaul and repair all windows/shutters and mouldings, including paneled aprons (except where stated as new items).
- 8. All rooms to be fitted with smoke/heat detectors and sounders at ceiling level with air sampling detection system in fire rooms
- 9. Repair floor joists as necessary. Consult with Architect and Structural Engineer. Strengthen existing joists where new stone floor finish to be installed.
- 10. Provide new appropriately detailed and sized cornices of traditional design throughout to replace existing modern cornices.

Notes on Lower Ground Floor:

- Internal doors: S/F new traditionally detailed painted SW door and architraves throughout except where indicated otherwise.

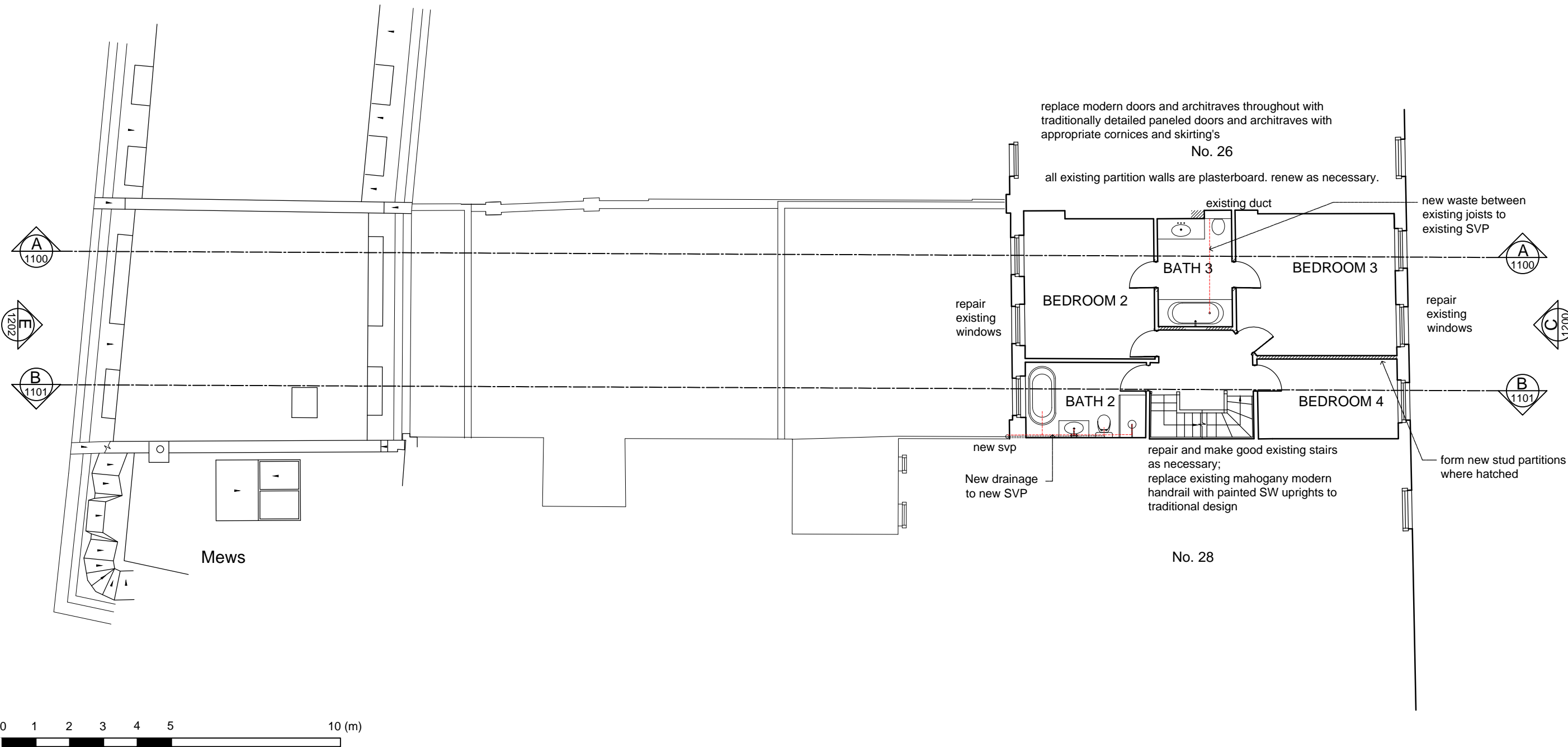

No.	NOTES (STATUS: F. FEASIBILITY S. SKETCH DESIGN P. PLANNING B. BUILDING CONTROL D. DESIGN DEV / PRELIM M. MEASUREMENT T. TENDER C. CONSTRUCTION R. RECORD)					
1	For construction use only if status 'C' and checked against current revision					
2	All dimensions to be checked on site by contractor					
3	Do not scale from this drawing	D	16/06/2017	TOB	ACS	Amendments to notes
4	Unless otherwise indicated all dimensions are in millimetres	C	17/02/2014	JXA	ACS	Re-submission of planning issue
		B	10/01/2014	JXA	ACS	Amendments to ground floor mews roof
		A	29/08/2013	JXA	ACS	Adding Notes and alterations to layout
		-	30/07/2013	JXA	ACS	Initial Issue
		Rev	Date	Dwn	Auth	REVISIONS

DONALD INSALL ASSOCIATES LIMITED

12 Devonshire Street London W1G 7AB Tel: 020 7245 9888 Email: london@insall-architects.co.uk

Job 27 John Street & 21 John's Mews

Title Proposed Third Floor Plan

CHARTERED ARCHITECTS
PLANNING CONSULTANTS

Job JS27.02	Status P			
No 2004	Rev D			
Scale (A3) 1:	1	2	5	