

existing open light well

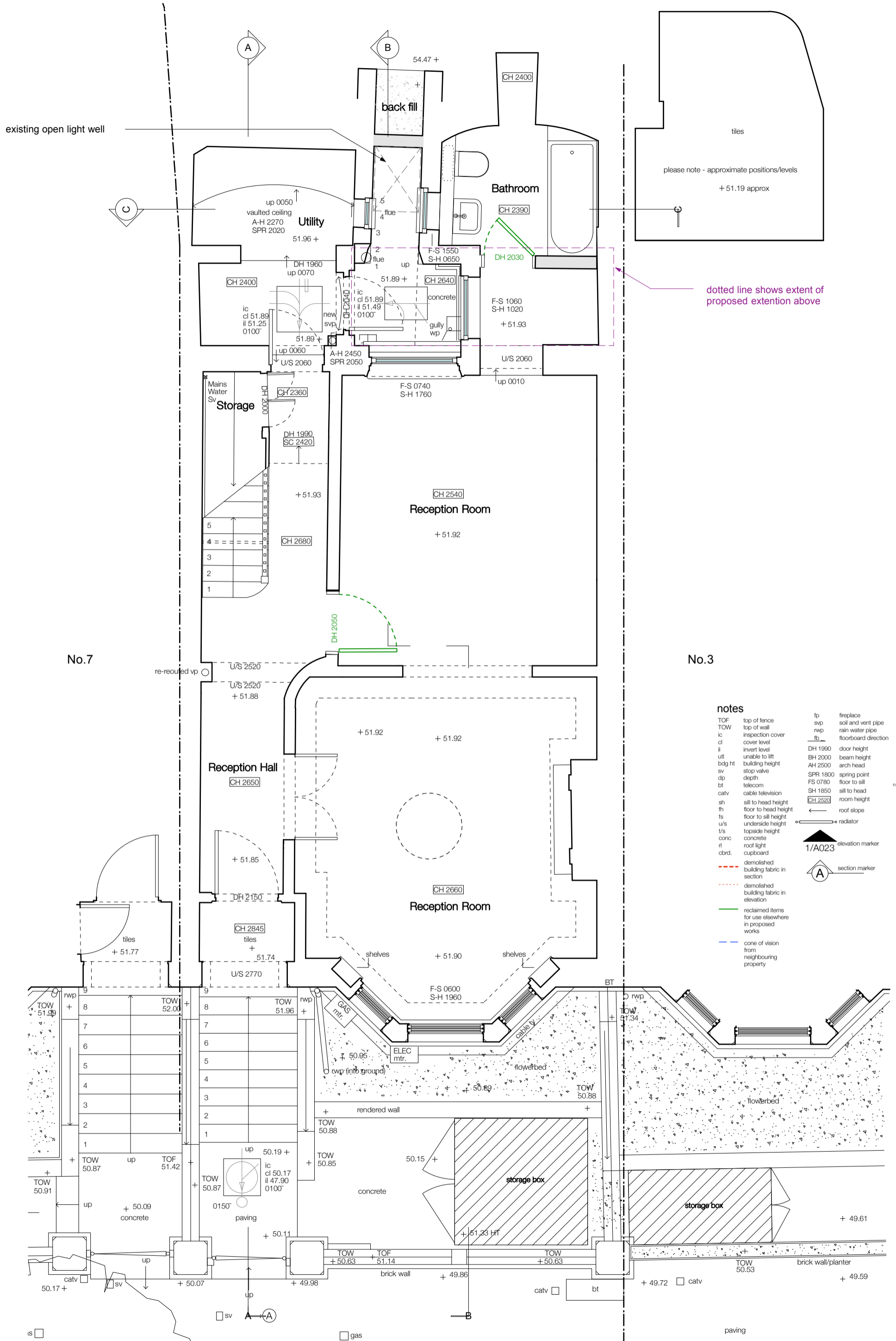

dotted line shows extent of proposed extension above

- notes**
- TOF top of fence
  - TOW top of wall
  - ic inspection cover
  - cl cover level
  - il invert level
  - utl unable to lift
  - bdg ht building height
  - sv stop valve
  - dp depth
  - bt telecom
  - catv cable television
  - sh sill to head height
  - fh floor to head height
  - fs floor to sill height
  - u/s underside height
  - t/s topside height
  - conc concrete
  - rl roof light
  - cbrd. cupboard
  - fp fireplace
  - svp soil and vent pipe
  - rwp rain water pipe
  - fb floorboard direction
  - DH 1990 door height
  - BH 2000 beam height
  - AH 2500 arch head
  - SPR 1800 spring point
  - FS 0780 floor to sill
  - SH 1850 sill to head
  - CH 2520 room height
  - roof slope
  - radiator
  - 1/A023 elevation marker
  - A section marker
- - - demolished building fabric in section
  - - - demolished building fabric in elevation
  - - - reclaimed items for use elsewhere in proposed works
  - - - cone of vision from neighbouring property