

# 4 John Street / 5 & 6 King's Mews

REV	DATE (dd.mm.yy)	DESCRIPTION
-	09.06.2017	Planning Submission

DO NOT SCALE FROM THIS DRAWING. ALL DIMENSIONS ARE TO BE CHECKED ON SITE. ALL OMISSIONS AND DISCREPANCIES TO BE REPORTED TO THE ARCHITECT IMMEDIATELY. THIS DRAWING IS TO BE READ IN CONJUNCTION WITH ALL CONSULTANTS INFORMATION. QUINN ARCHITECTS LTD RETAIN COPYRIGHT OF ALL INFORMATION IN THIS DRAWING.

KEY PLAN

Notes

## Quinn Architects

Rochelle School Arnold Circus London E2 7ES  
+44 (0)20 7613 3843 [www.quinnuk.com](http://www.quinnuk.com)

DRAWING TITLE

### Ground & First Floor Plan Demolitions

SCALE  
1:50 @ A1 / 1:100 @ A3

DRAWN BY  
VH

DATE CREATED  
JUNE 2017

CHECKED BY  
LQ

DRAWING STATUS  
PLANNING

PROJECT NO.  
QA169

DRAWING NO.  
P031

REV.  
-

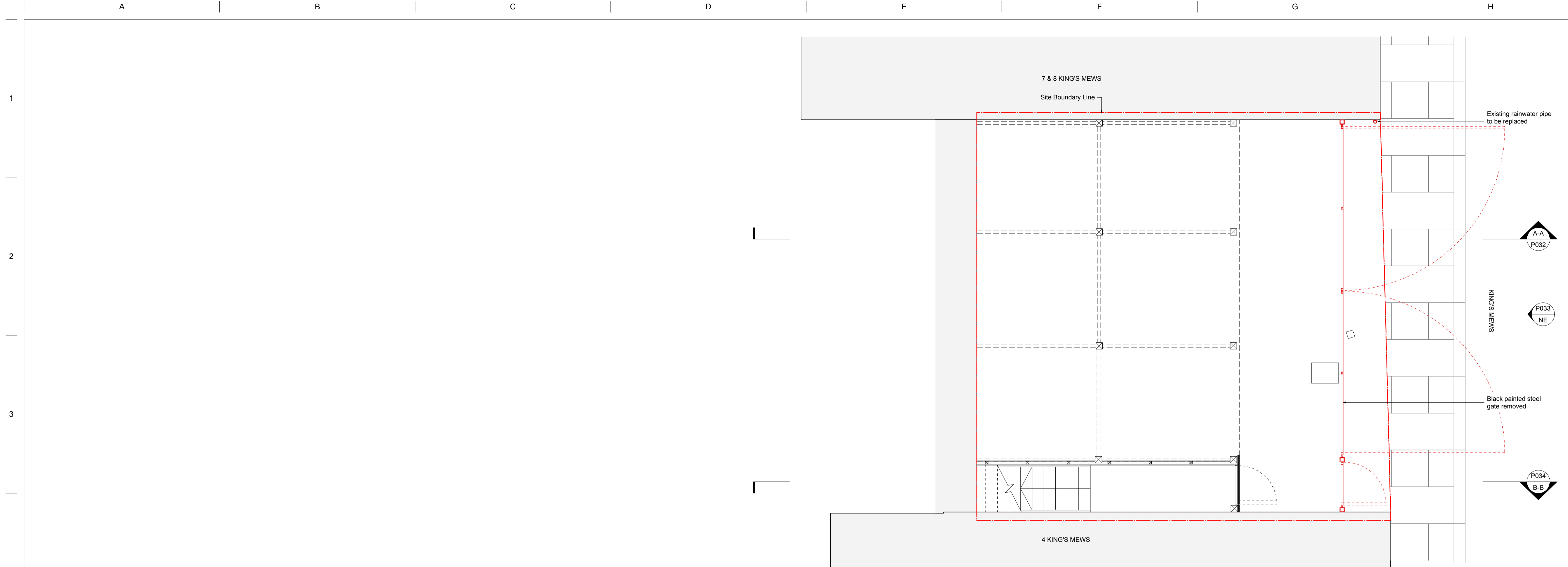

**A** Ground Floor Plan - Demolitions  
1:50 @ A1 / 1:100 @ A3

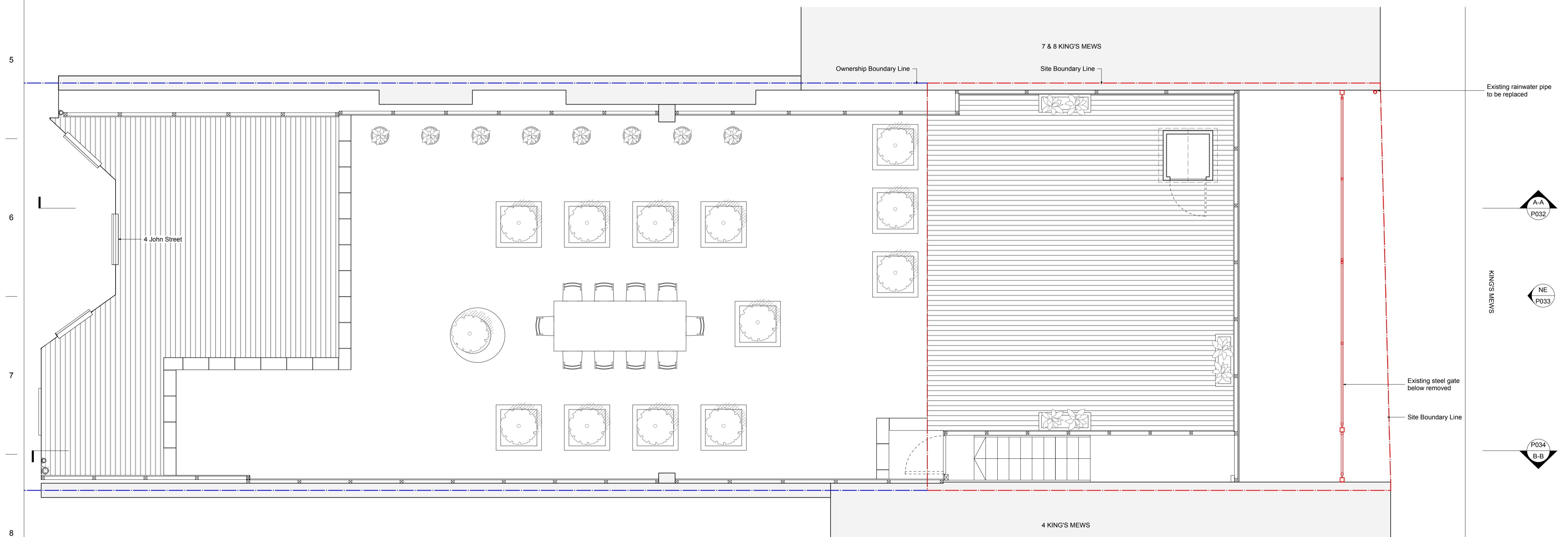

**B** First Floor Plan - Demolitions  
1:50 @ A1 / 1:100 @ A3

