

Notes:

Do not scale from this drawing except for Planning purposes.
Work from figured dimensions only.
All dimensions to be checked on site prior to commencement of work.

 Boundary of Boydell Court Residential Estate

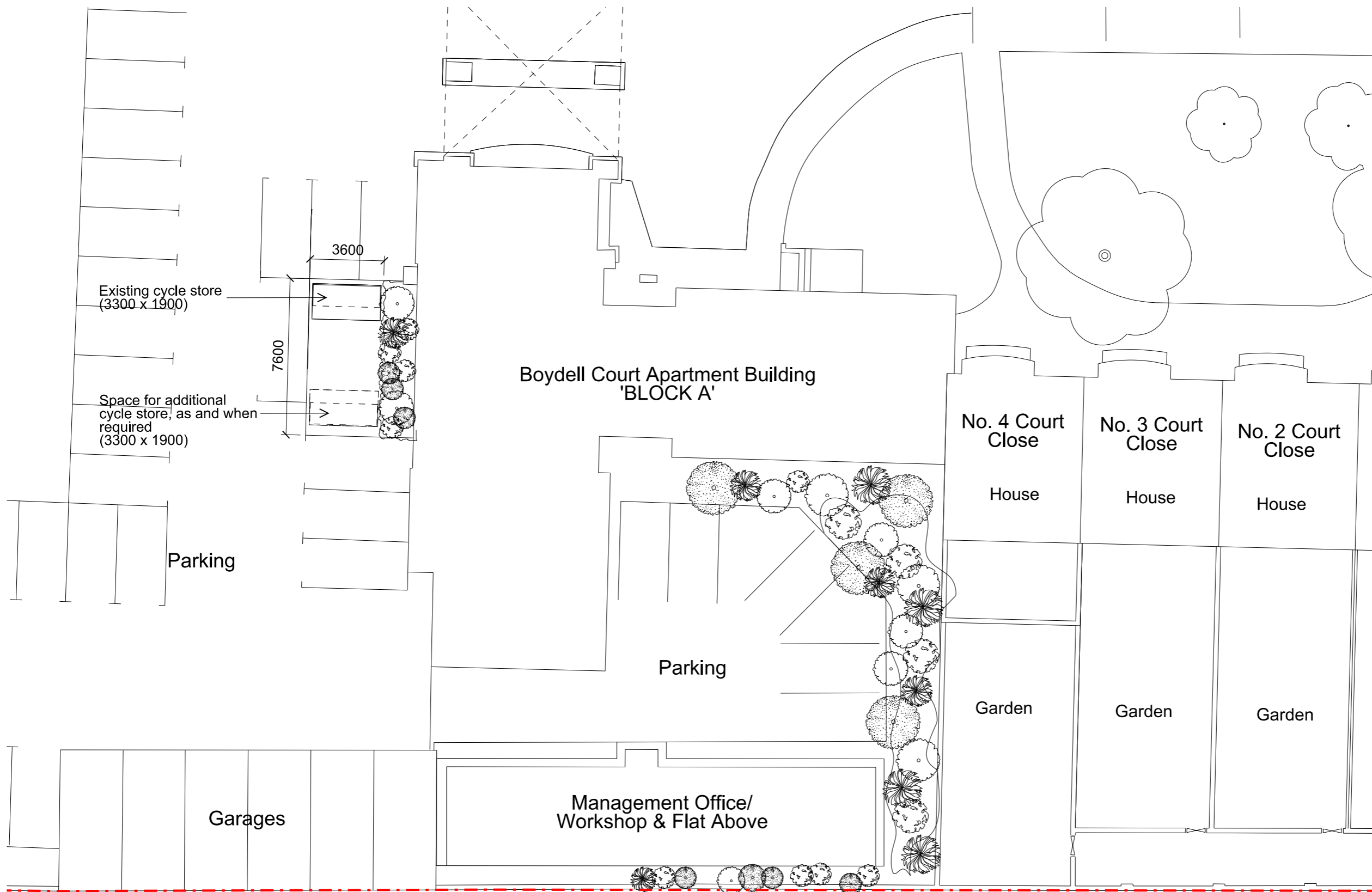

Revisions:

- A: (23.05.17) Updated and cycle stores shown.
- B: (02.06.17) Site boundary clarified.

Project:

Proposed Side Extension and New First Floor Residential Unit to Existing Management Workshop/ Office at Boydell Court, St John's Wood Park London NW8 6NJ

Title: Site Plan

Scale: 1:200 @ A3

Date: May 2017

Oakley Hough.

The Barn, Stebbing Farm
Fishers Green, Stevenage,
Hertfordshire SG1 2JB

Tel: 01438 745288
Mobile: 07710 549 270
e-mail: john@oakleyhough.co.uk

Drawing Number:

717/405 B

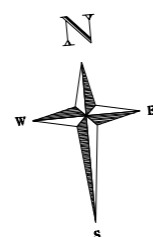

Scale 1:200 @ A3