

- WEL DRAWING IS DERIVED FROM THE FOLLOWING DRAWINGS:
- | Drawing No.       | Revision | Description |
|-------------------|----------|-------------|
| 1_529-00-114-1 GA | F        | GA CORE E   |
| 8465-M-300-1      | T1       | CONSULTANTS |
- NOTES:
- THIS DRAWING IS TO BE READ IN CONJUNCTION WITH THE SPECIFICATION, ARCHITECTS AND STRUCTURAL ENGINEERS DIMENSIONED LAYOUTS AND ALL OTHER RELEVANT CONTRACT DOCUMENTS.
  - THIS DRAWING IS TO BE READ IN CONJUNCTION WITH ALL RELEVANT MECHANICAL, PUBLIC HEALTH AND SAFETY DOCUMENTATION.
  - ANY GRID LINES, BUILDING LINES ETC. ARE TO BE SET OUT IN ACCORDANCE WITH THE RELEVANT ARCHITECTS PLAN.
  - DIMENSIONS ARE NOT TO BE SCALED FROM THIS DRAWING.
  - ALL WORKS AND EQUIPMENT TO COMPLY WITH THE CURRENT WATER REGULATIONS, APPLICABLE BRITISH STANDARDS & RELEVANT MANUFACTURERS' INSTALLATION REQUIREMENTS.
  - ALL DUCTWORK TO COMPLY WITH DM144 OR DM172.
  - ALL FIRE DAMPERS TO HAVE ACCESS DOORS.
  - ALL FLEXIBLE DUCTWORK TO BE NO LONGER THAN 600mm.
  - ALL DUCTWORK TO BE FITTED SUFFICIENT DISTANCES APART TO ALLOW FOR THERMAL ISOLATION.
  - ALL LOW LEVEL PIPEWORK TO BE FITTED WITH DRAIN VALVES.
  - ALL HIGH LEVEL PIPEWORK TO BE FITTED WITH AIR VENTS.
  - ALL GAS PIPEWORK TO BE PAINTED AND LABELED IN ACCORDANCE WITH GAS SAFE REGULATIONS.
  - ALL GAS PIPEWORK TO BE INSTALLED AND TESTED IN ACCORDANCE WITH GAS SAFE REGULATIONS.
  - ALL PIPEWORK TO BE FITTED SUFFICIENT DISTANCES APART TO ALLOW FOR THERMAL ISOLATION.
  - ALL DOUBLE REGULATING VALVES TO BE FITTED IN ACCORDANCE WITH THE MANUFACTURERS' RECOMMENDATIONS. I.E. PIPEWORK IS TO BE STRAIGHT AND THE SAME EQUIVALENT SIZES FOR A PIPE DIAMETER ON THE INLET OF THE VALVE AND 2 DIAMETERS ON THE OUTLET. IF INSTALLED NEAR TO A PUMP OUTLET, IT IS ESSENTIAL THE STRAIGHT LENGTH OF PIPEWORK BETWEEN THE PUMP AND THE VALVE INLET IS A MINIMUM OF 10 DIAMETERS.
  - ALL THERMAL ISOLATION TO BE AFFIXED WITH CORRECT IDENTIFICATION, TO COMPLY WITH BRITISH STANDARDS.
  - ALL EXCESS DRAIN PIPES TO BE CUT BACK TO A SUFFICIENT LENGTH BLACK PLASTIC END CAPS INSTALLED.
  - ANY CEILING MOUNTED ACCESS DOORS SHOWN ARE NOT EXHAUSTIVE AND ARE SUBJECT TO ADDITIONAL ACCESS DOORS THROUGHOUT THE CONTRACT PERIOD TO ENSURE COMPLIANCE WITH COM REGULATIONS.
  - ALL WOODEN PARAPETTES/ROSGONS TO BE SUPPLIED AND INSTALLED BY THE MAIN CONTRACTOR, I.E. FOR GRILLES, LUMINAIRES, PIPEWORK, SANITARYWARE, BRACKETRY ETC.
  - ALL HOLES UNDER 51mm TO BE FORMED THROUGH PLASTERBOARD AND NOT STRUCTURAL WALLS. ALL HOLES OVER 51mm TO BE FORMED THROUGH STRUCTURAL WALLS OR SLABS ARE TO BE UNDERTAKEN BY THE MAIN CONTRACTOR.
  - ALL HOLES/CHARGES MARKED OUT BY WEL FOR OUR SERVICES ARE NOT EXHAUSTIVE AND ARE SUBJECT TO ADDITIONAL HOLES/CHARGES BEING MARKED OUT/DETAILED THROUGHOUT THE CONTRACT PERIOD.
  - ALL HEATING AND WATER SERVICES PIPEWORK SHALL BE FULLY INSULATED, IN COMPLIANCE WITH BS 5422.
  - PIPE SERVICE SHALL BE PROVIDED FOR ALL PIPES PENETRATING WALLS OR SLABS AND PRESTOPPING SHALL BE INSTALLED TO ALL PIPEWORK PENETRATING THROUGH FIRE COMPARTMENTS TO THE EQUIVALENT RATING OF THE COMPARTMENT.
  - THE MAIN ISOLATING VALVE FOR EACH GLT SHALL BE PROVIDED WITHIN ACCESS MATHS ALONG THE CORRIDOR BEFORE ENTERING THE PLANT.
  - REFER TO SCHEDULES/TYPICAL DETAILS FOR VALUING ARRANGEMENT.

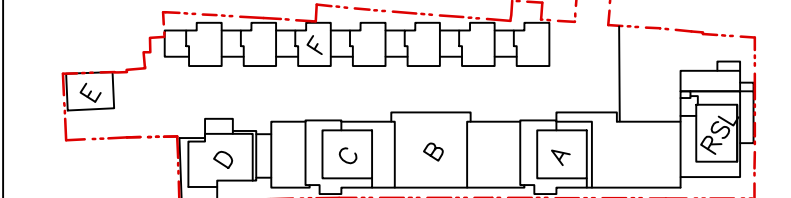

Rev	Date	Description
C1	19.01.17	CONSTRUCTION ISSUE
P2	06.12.16	VENT ADDED
P1	01.12.16	ISSUED FOR APPROVAL



Drawing Status  
**CONSTRUCTION**

Client  
**REGAL HOMES LONDON**

Job Title  
**GRAY'S INN ROAD**

Drawing Title  
**BASEMENT PLANTROOM  
CO-ORDINATED SERVICES**

Drawn By <b>PD</b>	Checked By <b>RH</b>
Date <b>DEC 16</b>	Scale <b>1:20@A0</b>

Drawing No. <b>CE7494-ME300-1</b>	Rev <b>C1</b>
--------------------------------------	------------------