

DO NOT SCALE FROM THIS DRAWING. ALL DIMENSIONS ARE TO BE CHECKED ON SITE PRIOR TO BUILD. DIMENSIONAL DIFFERENCES TO BE CONFIRMED WITH THE ARCHITECT. THIS DRAWING IS TO BE READ IN CONJUNCTION WITH ALL CONSULTANTS INFORMATION. MACKAY AND PARTNERS LLP RETAIN THE COPYRIGHT OF ALL INFORMATION WITHIN THIS DRAWING.

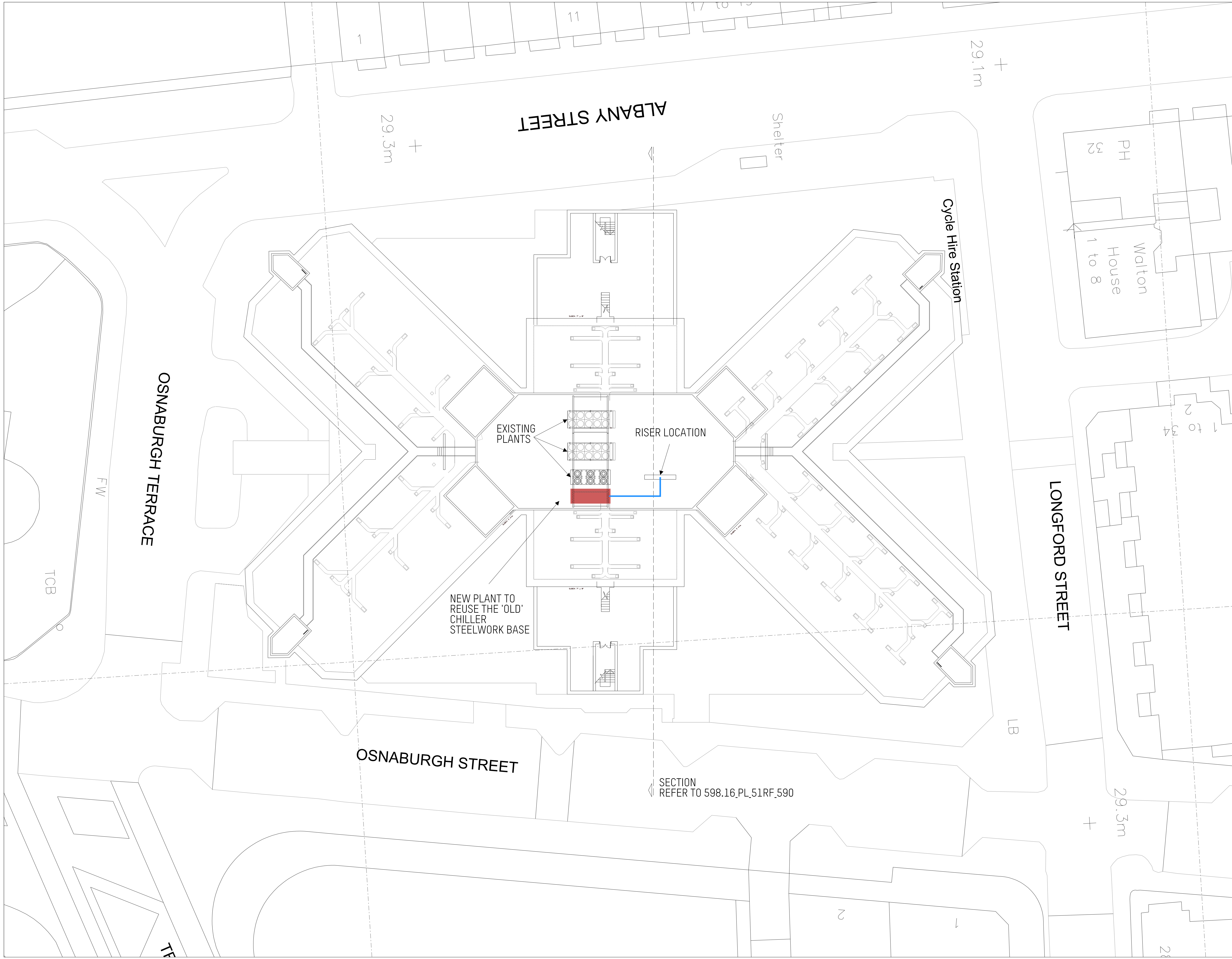

 SERVICES ROUTE

 PROPOSED NEW PLANT

New Air Handling Unit to be attenuated acoustically according to Acoustic Report submitted with the planning Application.

1. - Suitable silencers by fitting to the Air Handling Unit inlet air and outlet air atmospheric connections.
2. - Proposed new plant to be isolated from the structure of the building using double deflection neoprene-in-shear anti-vibration mounts to prevent the transmission of structure borne noise.

A Acoustic Attenuation 02/06/17

Rev	Description	Date

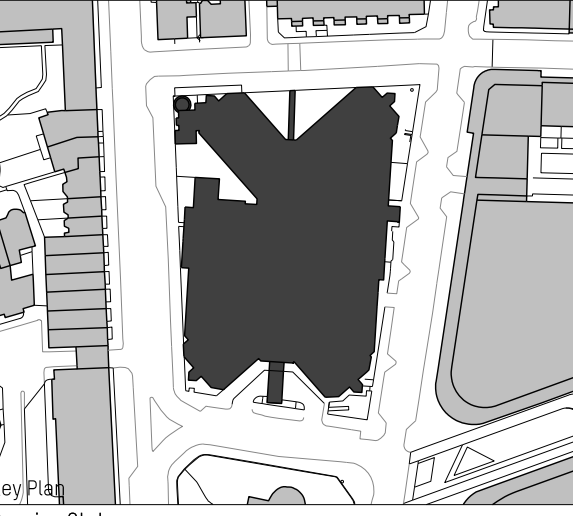

Key Plan  
Drawing Status  
**PLANNING**  
Issued only for purpose indicated

**Mackay + Partners**

ARCHITECTS & DESIGNERS  
Florin Studios, Florin Court, 6-8 Charterhouse Square  
London EC1M 6EY Tel +44 (0)207 608 1177  
e mail: contact@mackayandpartners.co.uk

Job Title  
**White House Hotel**

Drawing Title  
**PROPOSAL  
ROOF PLAN  
PLANT SPACE AND SERVICES ROUTE**

Scale @ A1 1:200 Scale @ A3 1:400 Drawn by **MT**

Date **05/05/2017** Checked by **KM**

Drawing No. **598.16\_PL\_51RF\_290** Rev. **A**

SECTION REFER TO 598.16\_PL\_51RF\_590