

EASTERN RANGE SECOND FLOOR OVERVIEW

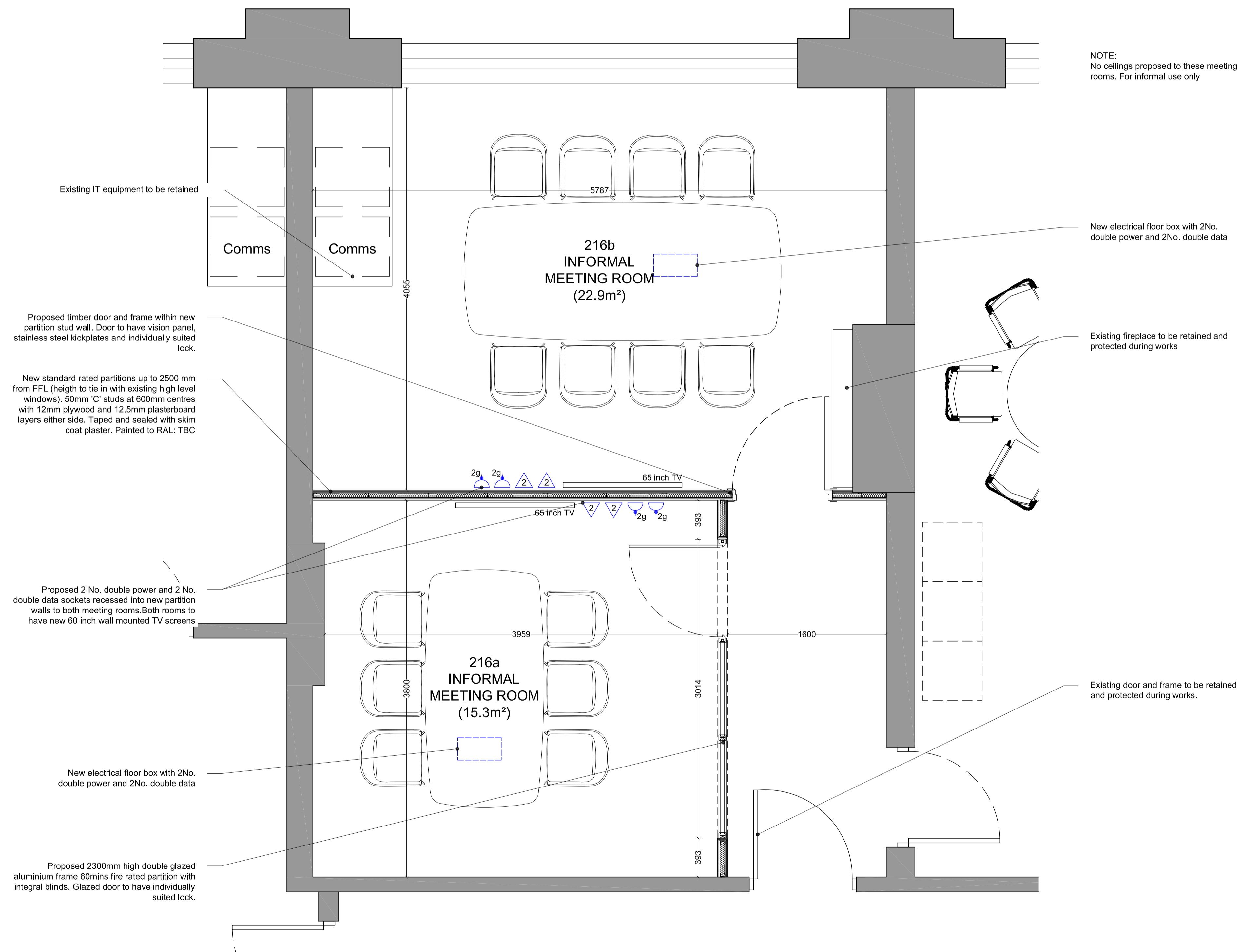

ROOM 216 PROPOSED GA PLAN
Scale 1 : 25

©
DO NOT SCALE. Use figured dimensions only. Contractor to check all dimensions before commencement of works. This drawing is copyright. This data to be used as a guide only - not as live data. This drawing must only be used for the purpose for which it is supplied.

NOTES:

NOTES:
Western range existing plans based on PDF drawings provided by VTEC. All stated areas are taken from Accommodation schedule provided by VTEC.

/	22/02/17	MP	FOR LISTED BUILDING CONSENT	AF	RS		
no.	date	by	revision details	Ckd	App		

STRALA architects
Studio 103
The Courtyard Royal Mills
Ancoats Manchester M4 6BA
Tel: 0161 236 5866
Fax: 0161 236 5884
E: office@strzarch.co.uk



NETWORK RAIL TECHNICAL APPROVAL AUTHORISED FOR ISSUE:
DESIGNER.....
CHECKER.....
AUTHORISER (CRE).....
DATE.....

APPROVED FOR FORM (NOT APPLICABLE)
CEM.....
DATE.....

project
**LONDON KING'S CROSS TRAIN STATION
VTEC ACCOMMODATION PLANS**

drawing status
FOR LISTED BUILDING CONSENT

drawing title
**EASTERN RANGE
SECOND FLOOR
ROOM 216
PROPOSED GA PLAN**

drawn by	date	checked by	date
MP	20/02/17	AF	22/02/17

CRE Approved by	date	CEM Reviewed by	date
RS	22/02/17		

Network Rail dwg no.	revision no.	sht no.
	/	1 of 1

consultant dwg no.	scale	sht size
2525-508	1:25	A1