

Timber surround with ventilation slots  
Existing concrete lintel

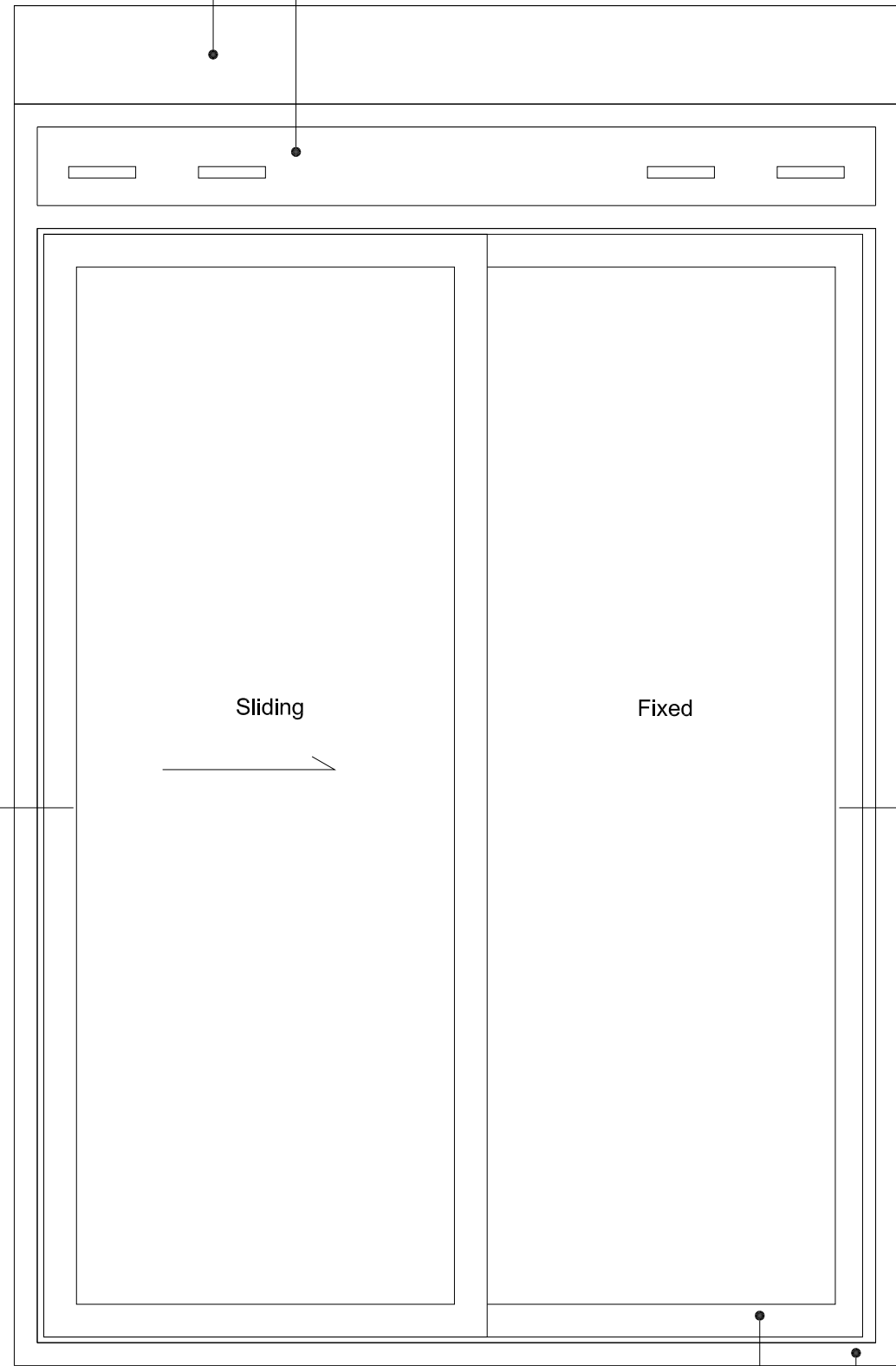

Existing elevation of typical sliding door

Existing metal frame sliding door - silver  
Existing timber surround - dark brown  
Existing timber surround - dark brown  
Existing metal frame sliding door - silver

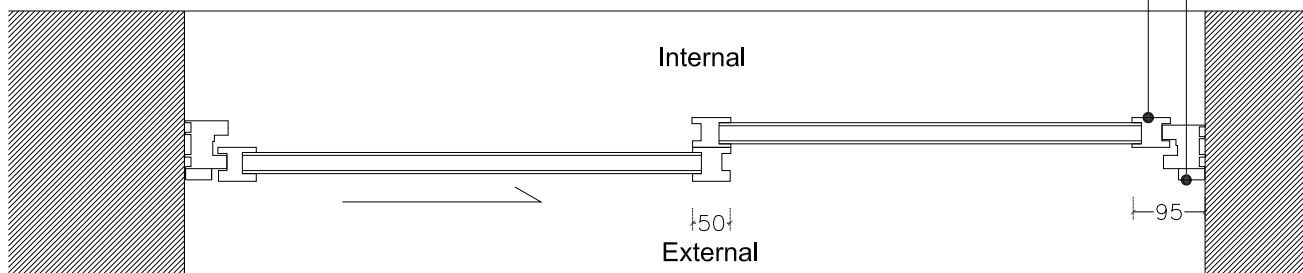

Existing plan of typical sliding door

Existing concrete lintel

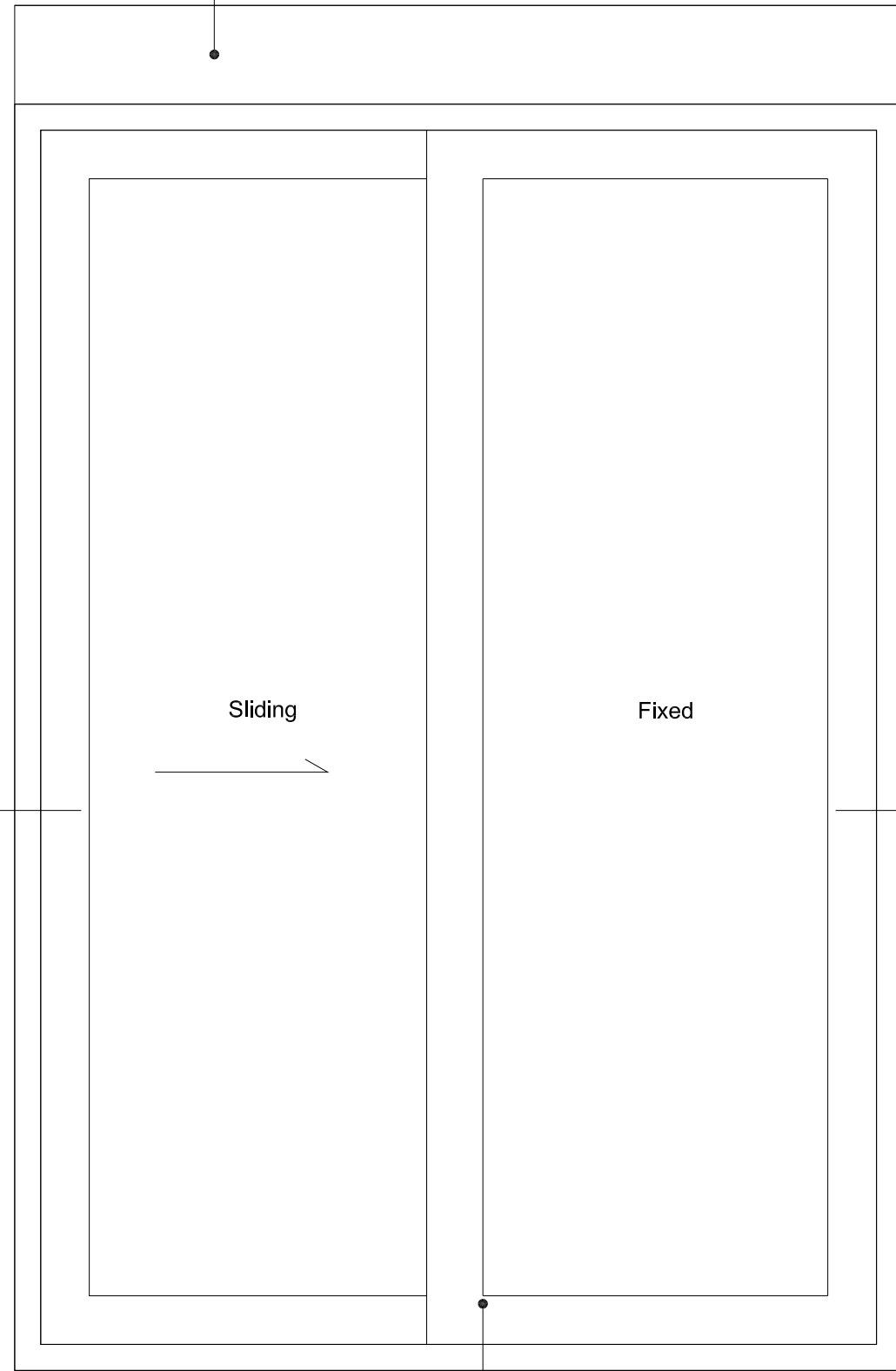

Proposed elevation of typical sliding door

Proposed aluminium frame, grey RAL 7022, double glazed sliding door

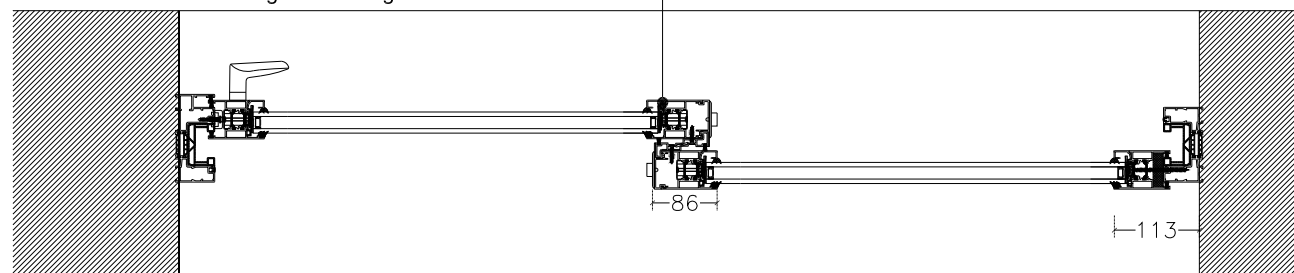

Proposed plan of typical sliding door

Proposed aluminium frame, grey RAL 7022, double glazed sliding door

0 100 200 500mm

Please note all dimensions are approximate

**NOTES**

DO NOT SCALE FROM DRAWING. ALL DIMENSIONS, LEVELS, COORDINATES, SETTING OUT, TO BE CHECKED ON SITE AND ANY DISCREPANCY REPORTED IMMEDIATELY TO THE ARCHITECT AND PROJECT MANAGER.

**PROJECT**

135 Haverstock Hill

**CLIENT**

Michael Gross

**DRAWING NAME**

Typical detail of existing and proposed sliding door - Type B

**REVISIONS**

STATUS	SCALE
Planning	1 : 10@A3
DRAWING NUMBER	DATE
HYA 15042 (P) 323	25/05/17

**HIGGS YOUNG**  
**ARCHITECTS**

HIGGS YOUNG ARCHITECTS LTD  
54 BOSTON PLACE  
LONDON NW1 6ER  
Tel: 0044 (0)20 7724 9395  
E-mail: info@higgsgyoung.com