

Tree Protection Method Statement in Accordance with BS 5837:2012

The method statement specifies the measures necessary to protect trees against damage from construction activity. The site manager should ensure that all persons working on the site are aware of those aspects, which appertain to their work. This includes service installation engineers and operators of plant machinery.

The information contained within this Arboricultural Method Statement conforms to British Standard (BS) 5837:2012 'Trees in relation to Design, Demolition and Construction - Recommendations'.

No site works (including any temporary enabling works, site clearance and demolition) or development shall take place until the temporary tree protection shown on the tree protection plan approved under this condition has been erected around existing trees on site. This protection shall remain in position until after the development works are completed and no material or soil shall be stored within these fenced areas at any time. The development shall be implemented in accordance with the protection plan and method statement as approved under this condition.

Sequence of Events

The following sequence is governed by operational constraints and subject to change. The developer's arboriculturalist must be informed of any changes to this schedule:

Pre-development Stage

1. Pre-commencement site meeting between relevant parties, e.g. client, arboriculturalist, project manager, architect and Local Planning Authority (where appropriate). This meeting must take place before any development activity begins to confirm the timing and implementation of the agreed Tree Works and installation of Tree protection measures.
2. Pruning / removal of trees directly/indirectly impacted by development, as per approved plans.
3. Tree protection measures (e.g. fencing, ground protection) installed as per drawing 133-PL-005 Tree Protection Plan.
4. Site to be inspected by Developer's Arboriculturalist.

Development Stage

Trees at the Front of the Development T15, T16, T17 and T18

1. Care to be taken when removing existing walling, Developer's Engineer and Arboriculturalist to supervise this process.
2. Tree roots to be wrapped in wet hessian as existing wall is removed to keep the soil moist and prevent roots from drying out and being killed during the process.
3. Use tree sand to fill in behind the wall once it's been re-built.
4. Where parking bay wall is being installed excavate by hand Arboriculturalist to check for any significant roots and advise accordingly.
5. Mulch around the base of the trees to help them recover.
6. Arboricultural supervision is required for this area during the construction process.

Trees in Neighbouring Garden, Cherry Trees T12 and T13 and T11

1. Tree protection fencing to be installed as shown on drawing 133-PL-005
2. Care needs to be taken when excavating the existing walls/rockery around the raised sections of the two new rear gardens. Wherever possible excavation work should be done by hand. The Developer's Arboriculturalist should supervise the excavation work
3. The existing sub-base should not be excavated but should be preserved in situ and re-used as the sub-base for the new paving so as not to disturb any tree roots that may be present.
3. The area is re-paved with sand-jointed block paving similar to the existing type of paving which is present.
4. Arboricultural supervision is required for this area during the construction process.

T1 Large Oak Tree

1. Care to be taken when removing the existing brickwork. If in doubt leave the existing brickwork in place rather than replace it.
2. Tree roots to be wrapped in wet hessian as existing wall is removed to keep the soil moist and prevent roots from drying out and being killed during the process.
3. Use tree sand to fill in behind the wall once it's been re-built.
4. Mulch around the base of the tree to help it recover.
5. Developer's Arboriculturalist to supervise the process.

T2, T3, T7 and T8 Trees in Neighbouring Properties Around Rear Garden

1. Existing hard paving to be removed with care.
2. Following this removal, area to be completely fenced off.
2. No excavation to take place in this area (with the exception of the three new trees to be planted)
3. No site materials or other items to be stored in this area.
4. No site vehicles to access this area, once the hard standing has been removed.

Nb. This stage is subject to site monitoring visits by the developer's Arboriculturalist at intervals as agreed at the pre-commencement site meeting. These visits are to ensure that the agreed protection measures are functional and correctly achieving their purpose.

Root Protection Areas

Some of the trees that are potentially affected by the development are on neighbouring property, the exact locations, trunk diameters and root protection areas have been estimated. It is the responsibility of everyone engaged in the construction process to respect the tree protection measures and observe the necessary precautions within and adjacent to them. Inside the exclusion area of the Protective Fencing, the following rules shall apply:

- No mechanical excavation
- No excavation by any other means without arboricultural supervision
- No ground level changes whatsoever
- No storage of plant or materials
- No storage or handling of any concrete or chemicals
- No vehicular access

Tree Protection Fencing

The tree protection fencing locations are shown on the tree protection plan. This should be installed before any site activities begin.

Once installed this fencing should not be moved or altered without prior agreement of the arboriculturalist and the local planning authority. Exclusion signs (Fig 3) should be attached to the fencing to warn site operatives.

The tree protection fencing should be fit for purpose. A common method consists of a scaffold framework in accordance with Fig. 2, comprising of a vertical and horizontal framework, braced to resist impacts, with vertical tubes spaced at a maximum interval of 3m. Onto this, weld mesh panels should be securely fixed with wire or scaffold clamps.

A similar suitable form of fencing consisting of weld mesh panels on rubber or concrete feet is suitable on more minor developments where large plant is not in use.

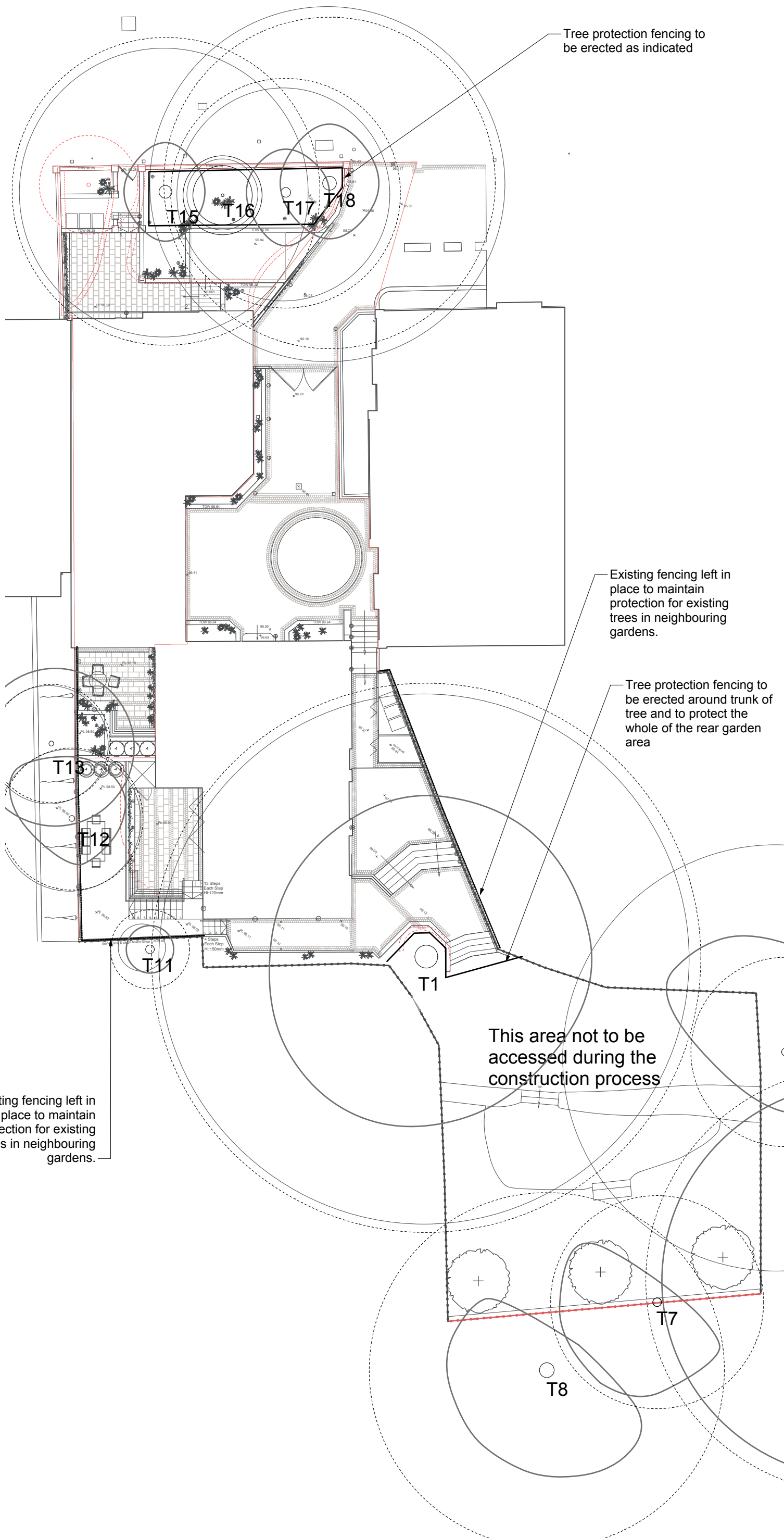

Tree protection fencing to be erected as indicated

Existing fencing left in place to maintain protection for existing trees in neighbouring gardens.

Tree protection fencing to be erected around trunk of tree and to protect the whole of the rear garden area

This area not to be accessed during the construction process

Existing fencing left in place to maintain protection for existing trees in neighbouring gardens.



D		
C		
B		
A		
Rev	Date	Details

Anna French Associates Ltd
 Room 12, The Stable Block
 West Park
 Silsoe, Bedfordshire
 MK45 4HR
 T 01525838796
 E info@annafrenchassociates.co.uk
 W annafrenchassociates.co.uk

Client: _____

Project: **Redington Gardens**

Drawing Title: **Tree Protection Plan**

Phase: **FOR PLANNING**

Drawing Number: 133-PL-005	Rev: -	Date: 24.05.17
Drawn by: AF	Scale: 1:70@A1	

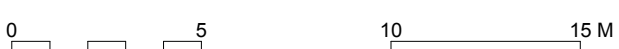

DO NOT SCALE FROM DRAWING.



Pittosporum tenuifolium - with raised crowns



Anemone x hybrida 'September Charm'



Blechnum spicant



Luzula sylvatica 'Marginata'



Polystichum polyblepharum



pachysandra terminalis

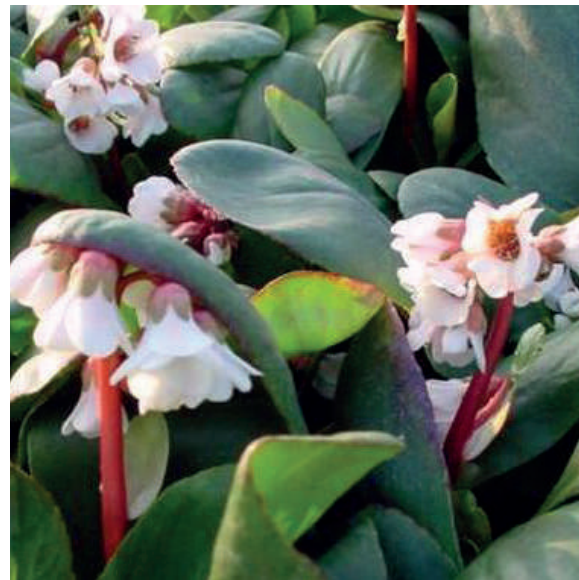

Bergenia 'Silberlicht'

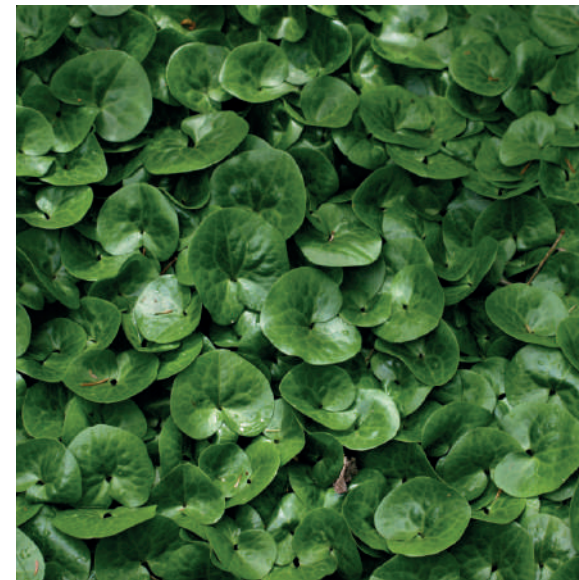

Asarum europaeum

Soft Landscape

Redington Gardens

ANNA FRENCH ASSOCIATES
LANDSCAPE ARCHITECTURE + ECOLOGY





Cornus alba 'Sibirica'



hydrangea seemanii



Agapanthus 'White Heaven'



Prunus lusitanica

Soft Landscape

Redington Gardens

ANNA FRENCH ASSOCIATES
LANDSCAPE ARCHITECTURE + ECOLOGY





Addaset - 6mm-Scandinavian Pearl



Marshalls - Fairstone-Sawn Setts-Silver Birch



Marshalls - Fairstone Riven Harena Garden Paving

Hard Landscape

Redington Gardens

ANNA FRENCH ASSOCIATES
LANDSCAPE ARCHITECTURE + ECOLOGY





DW Windsor - Pharola Max



Lighting For Gardens - Compact Up & Down
Outdoor Wall Light - Black Aluminium 240v GU10



Lighting For Gardens - Compact Spike Spotlight
- Black



Lighting For Gardens - Gemini Outdoor Wall
Light - Warm White - Graphite

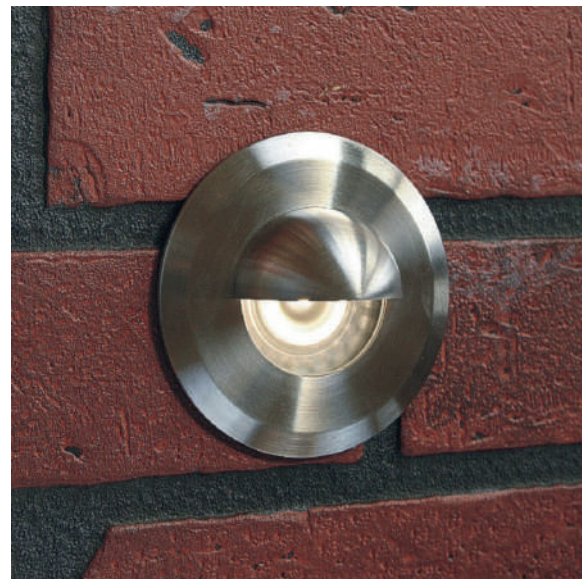

Lighting For Gardens - Smoothie Eyelid Light -
Stainless Steel - 12v



Lighting For Gardens - Waymarker 180 -
Stainless Steel - 12v

Lighting

Redington Gardens

ANNA FRENCH ASSOCIATES
LANDSCAPE ARCHITECTURE + ECOLOGY

