

MONMOUTH STREET

PAVEMENT WIDTH VARIES BETWEEN 3570 AT THE WIDEST AND 3350MM AT THE NARROW POINT

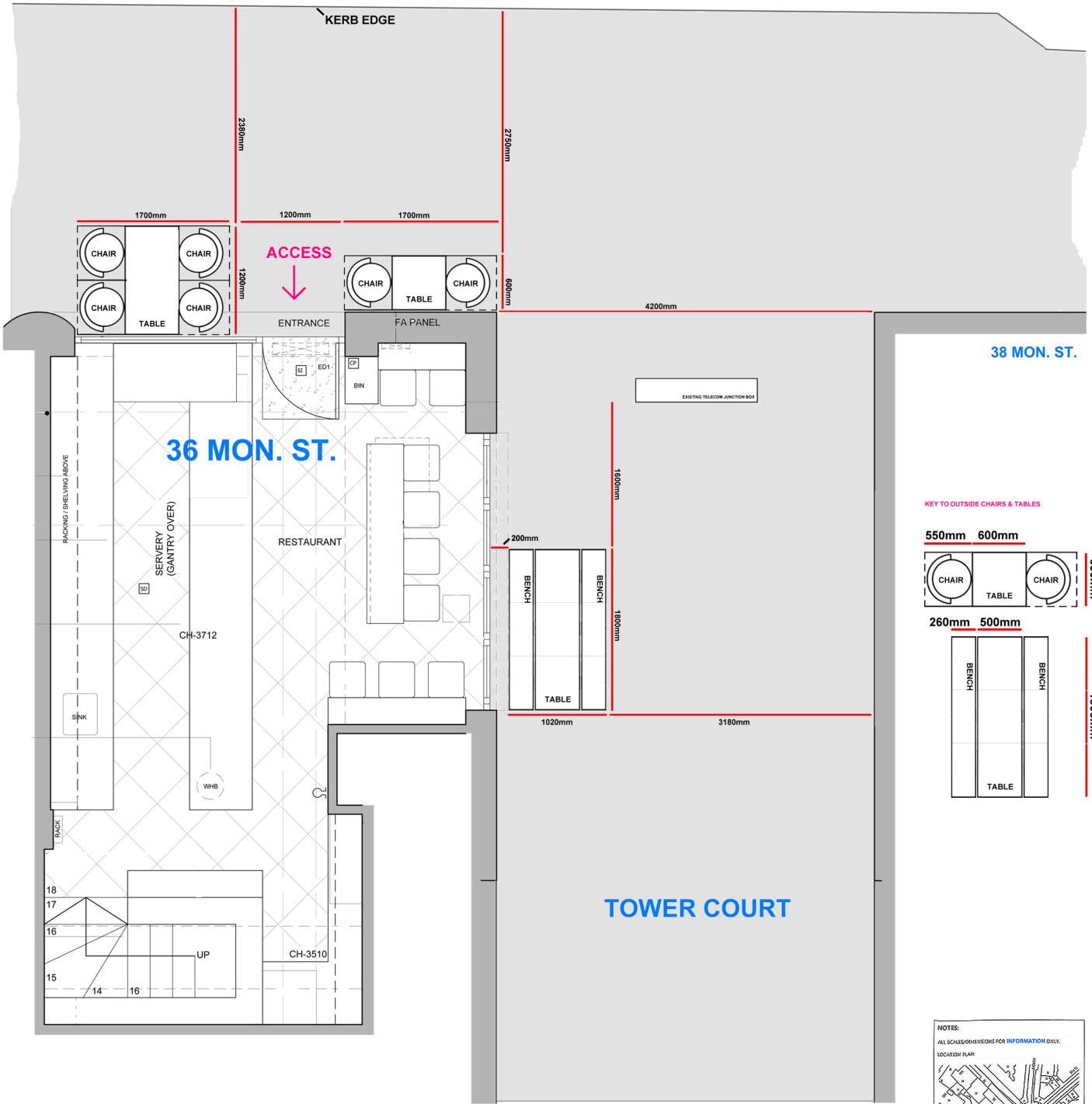

KEY TO OUTSIDE CHAIRS & TABLES

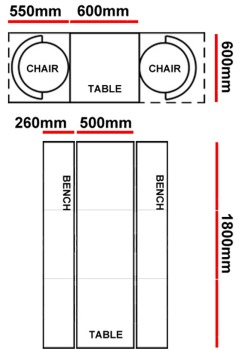

GROUND FLOOR PLAN



STREET CHAIR Application FOR 36 MONMOUTH STREET at Seven Dials, Covent Garden

to Camden Council

PLAN EXTERNAL SEATING DRAWING - 36 MONMOUTH STREET SK 2001A - Applic. EXT SEATING PLAN 14may2017

APPLICATION for 3 No. TABLES, 6 No. CHAIRS & 2 No. 1800mm BENCHES AS SHOWN ON THIS DRAWING. See key for dimensions of the chairs, benches and tables to be used.

nb. This drawing has been prepared with reference to the Camden Councils general guidelines for design and disabled access when making an application to place tables and chairs on the public highway at 36 Mon. St.

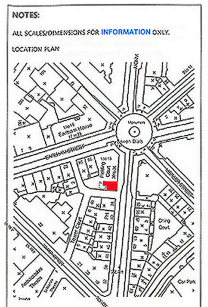

GROUND FLOOR STREET PLAN - EXTERNAL SEATS

36 Monmouth Street London WC2

PLAN MAY 2017 NTS

CURE & CUT SHOP

WICKHAM van EYCK architects
 London tel: +44 7831 644 955
 Holland tel: +31 294 23 3109
 Julyan Wickham
 julyan@wickhamvaneyck.com

36 MONMOUTH STREET