

Plan of unit - Proposed

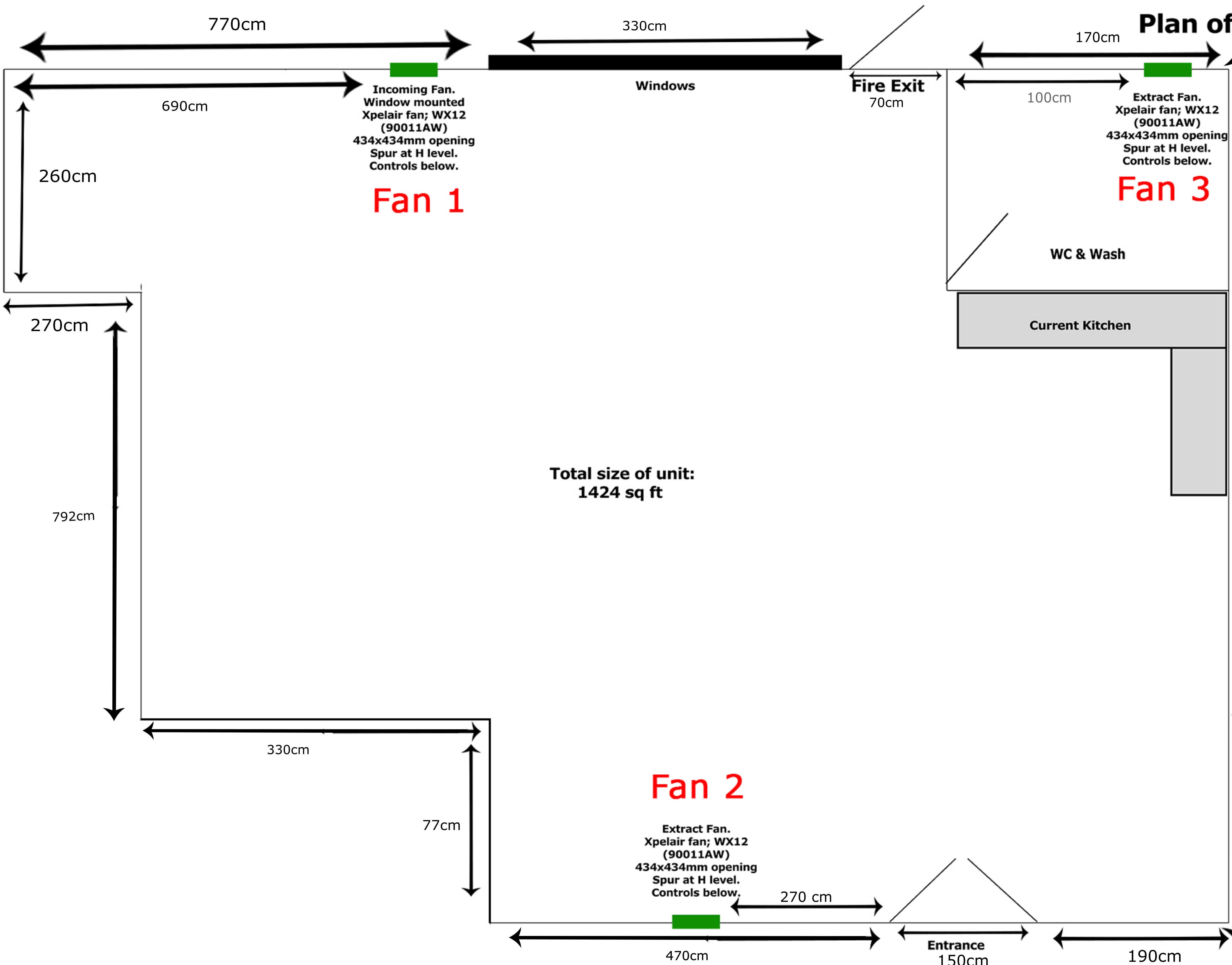

Total size of unit:
1424 sq ft

Project:
Unit 15 Burmarsh Workshop
for Worlds Afar Ltd

Drawing:
Plans for installing 3 Extract
Fans - 434 x 434mm opening
Spur at H Level.

Date Drawn:
30.03.2017

General notes:
To be read in conjunction
with all other relevant
drawings schedules and
specifications.

**For any further information
please contact:**
Jake Williams
Tel: 07456780563
Email: jw@lordfox.com