

**Ordnance Survey Plan
Published 1953 - 1954**

Source map scale - 1:1,250

The historical maps shown were reproduced from maps predominantly held and applied for England, Wales and Scotland in the years 1953 and 1954. The 1:2,500 scale maps were considered to be the cultivated parts of Great Britain. The published date given below is often some years later than the surveyed date. Before 1938, all OS maps were based on the Cassini Projection, with independent surveys of a single county or group of counties, giving rise to significant inaccuracies in outlying areas.

Map Name(s) and Date(s)

TO2784SE 1953 1:1,250	TO2884SW 1954 1:1,250	TO2884SE 1954 1:1,250
TO2784NE 1953 1:1,250	TO2884NE 1953 1:1,250	

Historical Map - Segment A13

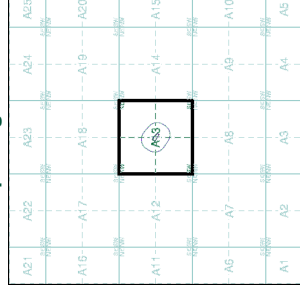

Order Details

Order Number: 62736435_1_1
Customer Ref: J14367
National Grid Reference: 528310, 184030

Site: A
Site Area (Ha): 0.19
Search Buffer (m): 100

Site Details

44a Gloucester Avenue, LONDON, NW1 8JD



Tel: 0844 844 9952
Fax: 0844 844 9951
Web: www.landmark.co.uk

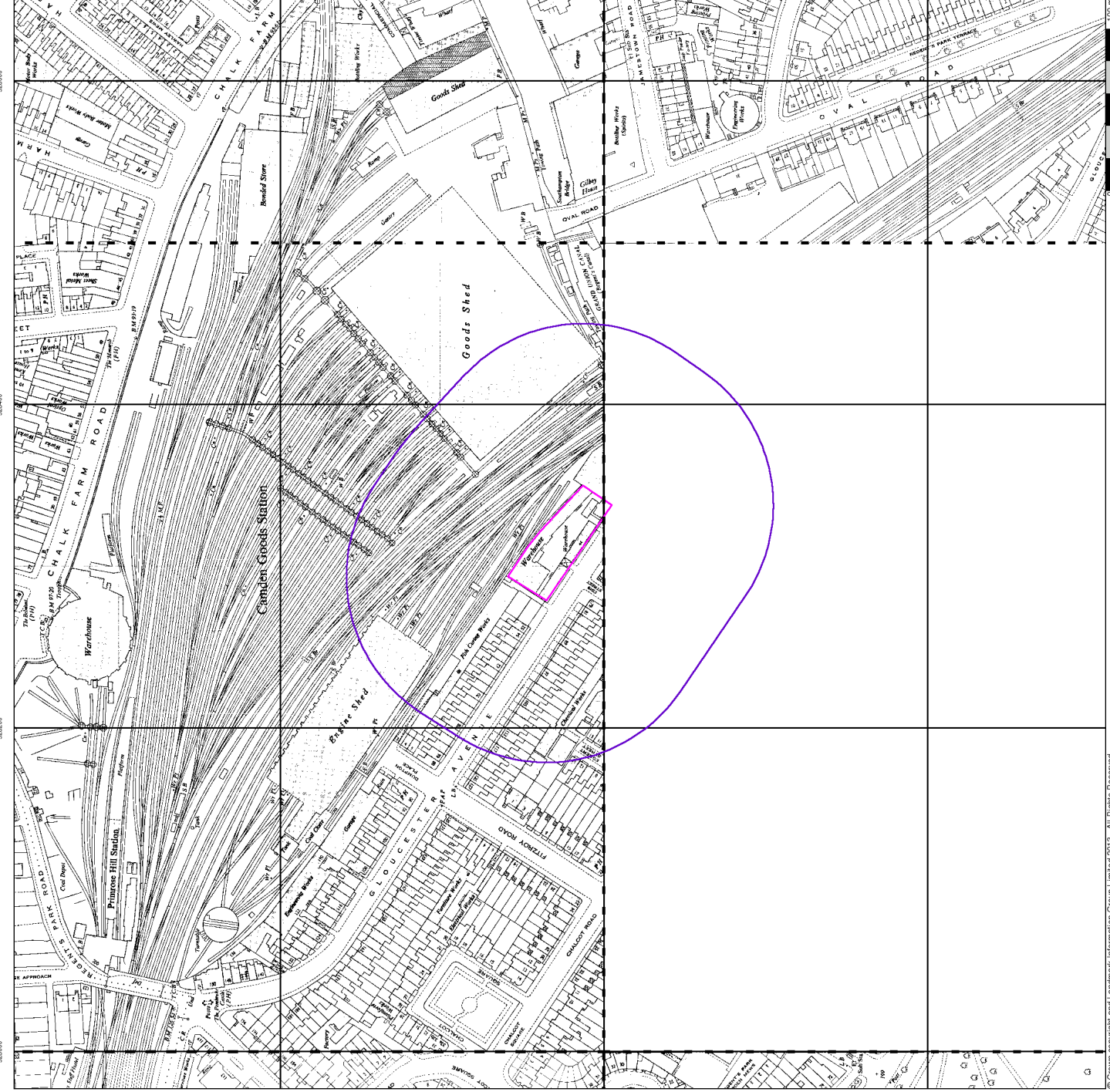

**Additional SIMs
Published 1953 - 1986**

Source map scale - 1:1,250

The SIM cards (Ordnance Survey's Survey of Information on Microfilm) are the most up-to-date maps available. They are based on the main editions as an area was updated. They date from 1947 to 1984, and contain detailed information on buildings, roads and land-use. These maps were produced at both 1:2,500 and 1:1,250 scales.

Map Name(s) and Date(s)

TO2784SE 1983 1:1,250	TO2884SW 1982 1:1,250	TO2884SE 1986 1:1,250
TO2784NE 1978 1:1,250	TO2884NW 1978 1:1,250	TO2884NE 1983 1:1,250

Historical Map - Segment A13

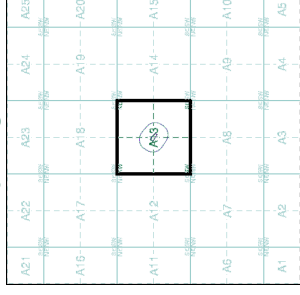

Order Details

Order Number: 62736435_1_1
Customer Ref: J14367
National Grid Reference: 528310, 184030

Site: A
Site Area (Ha): 0.19
Search Buffer (m): 100

Site Details

44a Gloucester Avenue, LONDON, NW1 8JD



Tel: 0844 844 9952
Fax: 0844 844 9951
Web: www.landmark.co.uk

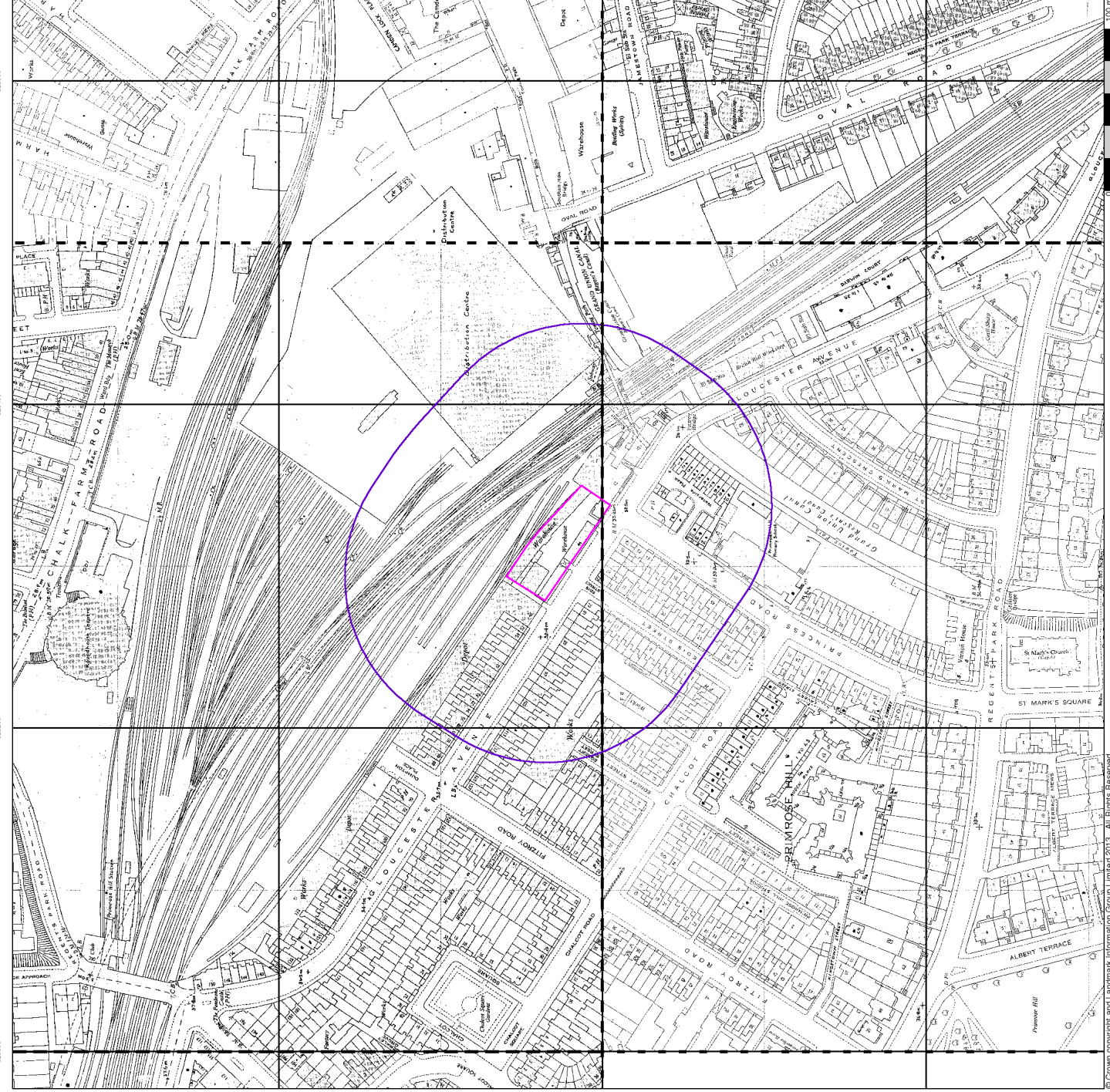

**Ordnance Survey Plan
Published 1954 - 1955**

Source map scale - 1:2,500
The historical maps shown were reproduced from maps predominantly held in the Ordnance Survey archives. The maps were surveyed in 1954 and 1955 and published in 1954 and 1955. The maps covered the whole of what was considered to be the cultivated parts of Great Britain. The published date given below is often some years later than the surveyed date. Before 1938, all OS maps were based on the Cassini Projection, with independent surveys of a single county or group of counties, giving rise to significant inaccuracies in outlying areas.

Map Name(s) and Date(s)

TO2784	1954	12,500
TO2884	1955	12,500
TO2783	1954	12,500
TO2883	1954	12,500

Historical Map - Segment A13

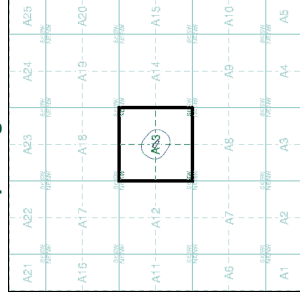

Order Details

Order Number: 62736435_1_1
Customer Ref: J14367
National Grid Reference: 528310, 184030
Slice: A
Site Area (Ha): 0.19
Search Buffer (m): 100

Site Details

44a Gloucester Avenue, LONDON, NW1 8JD



Tel: 0844 844 9952
Fax: 0844 844 9951
Web: www.environmental.co.uk

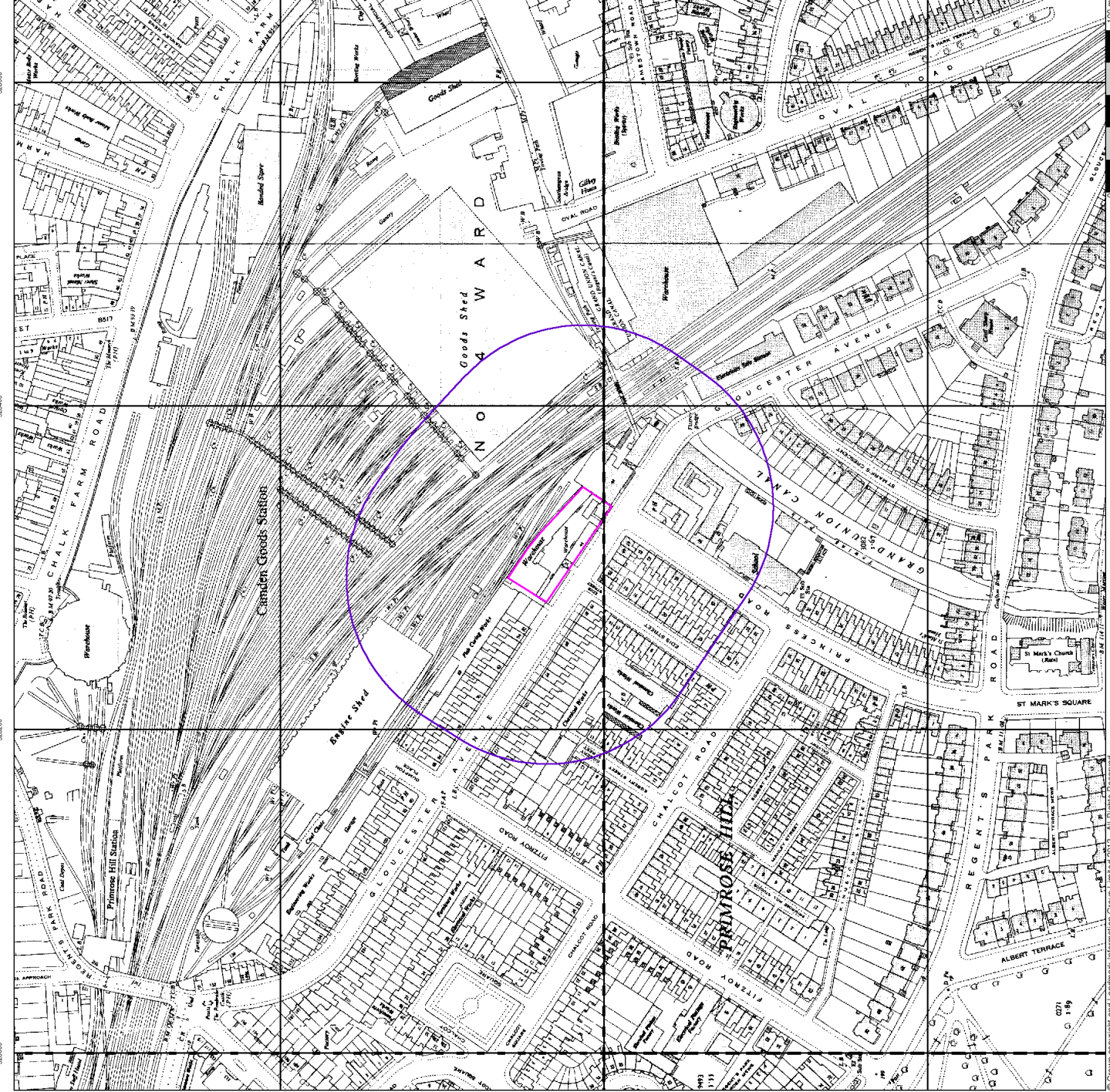

**Additional SIMs
Published 1954 - 1955**

Source map scale - 1:2,500
The SIM cards (Ordnance Survey's Survey of Information on Microfilm) are the same as the OS maps, but they are available on microfilm. The maps between the main editions as an area was updated. They date from 1947 to 1994, and contain detailed information on buildings, roads and land-use. These maps were produced at both 1:2,500 and 1:1,250 scales.

Map Name(s) and Date(s)

TO2884	1955	12,500
TO2783	1954	12,500

Historical Map - Segment A13

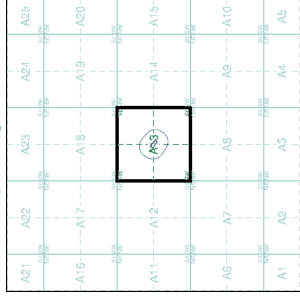

Order Details

Order Number: 62736435_1_1
Customer Ref: J14367
National Grid Reference: 528310, 184030
Slice: A
Site Area (Ha): 0.19
Search Buffer (m): 100

Site Details

44a Gloucester Avenue, LONDON, NW1 8JD



Tel: 0844 844 9952
Fax: 0844 844 9951
Web: www.environmental.co.uk

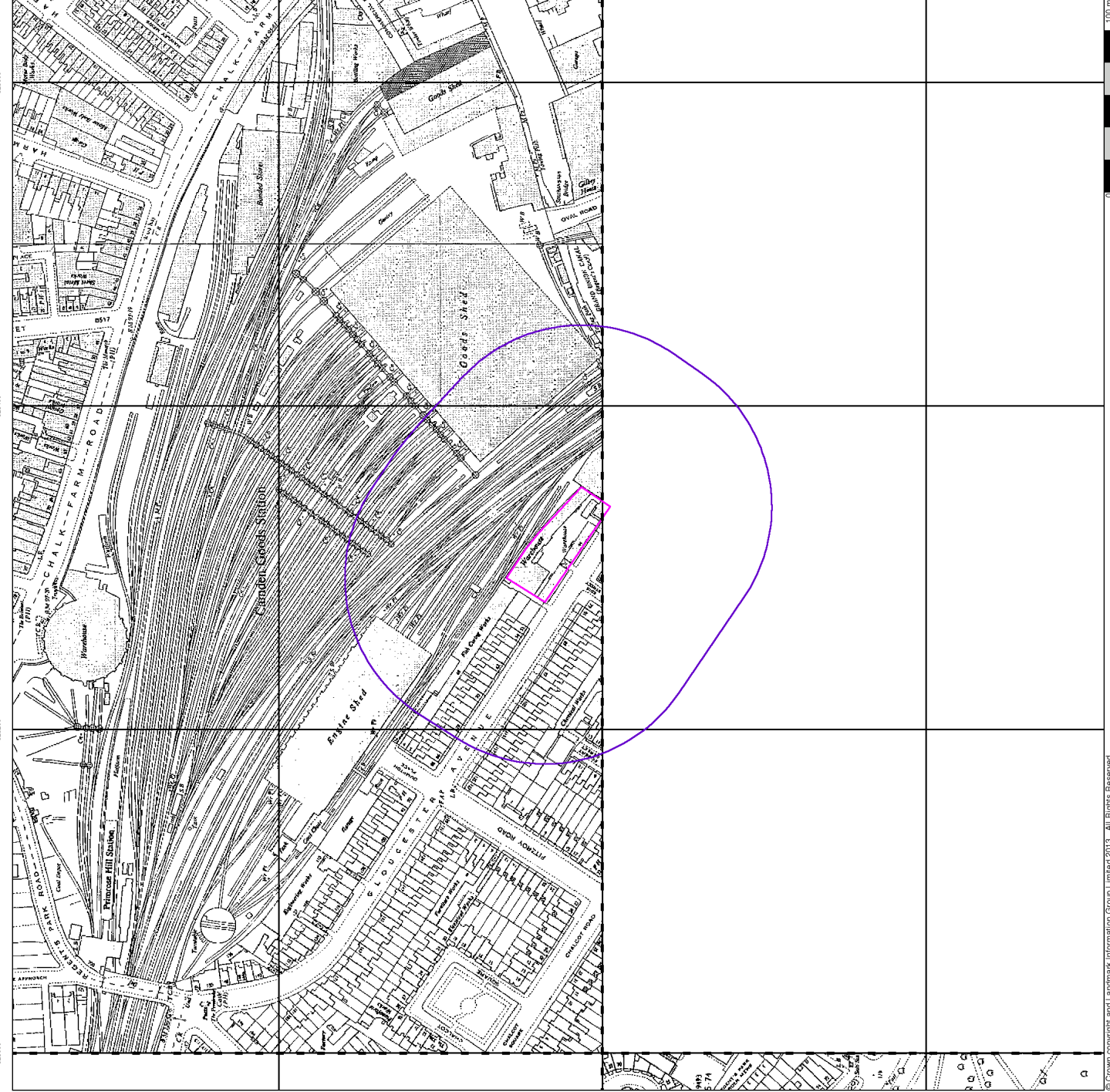

Supply of Unpublished Survey Information

Published 1973 - 1975

Source map scale - 1:1,250

SUSI maps (Supply of Unpublished Survey Information) were produced between 1972 and 1977, mainly for internal use at Ordnance Survey. These were more of a 'work-in-progress' plan as they showed updates of individual areas on a map. These maps were unpublished, and they do not represent a single moment in time. They were produced at both 1:2,500 and 1:1,250 scales.

Map Name(s) and Date(s)

TO2884SW	TO2884SE
1973	1975
1:1,250	1:1,250
TO2883NW	TO2883NE
1973	1975
1:1,250	1:1,250

Historical Map - Segment A13

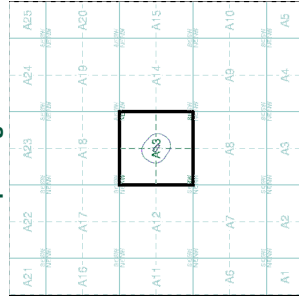

Order Details

Order Number: 62736435_1_1
 Customer Ref: J14367
 National Grid Reference: 528310, 184030
 Slice: A
 Site Area (Ha): 0.19
 Search Buffer (m): 100

Site Details

44a Gloucester Avenue, LONDON, NW1 8JD



Tel: 0844 844 9952
 Fax: 0844 844 9951
 Web: www.landmark.co.uk

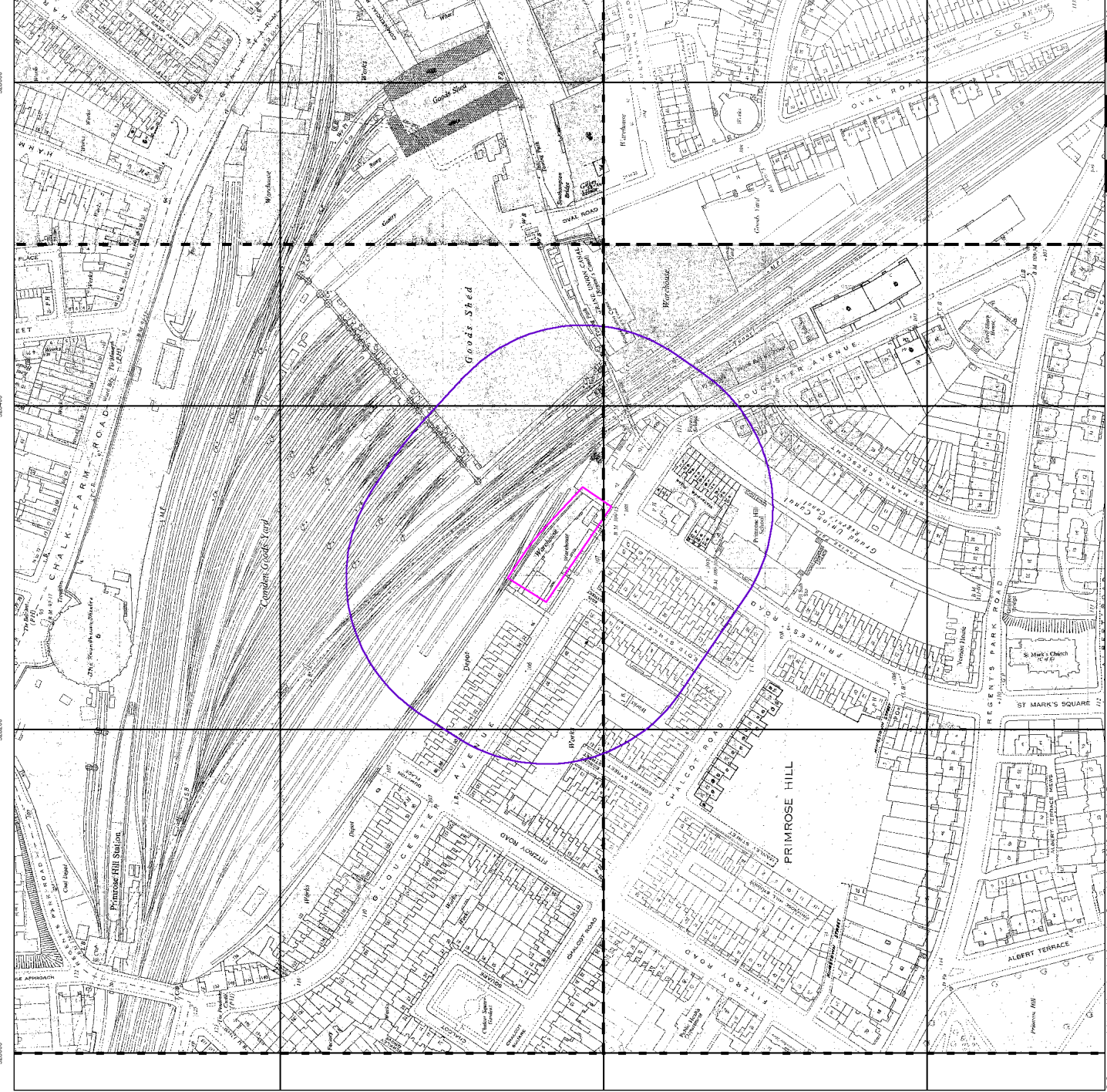

Additional SIMs

Published 1982 - 1987

Source map scale - 1:1,250

The SIM cards (Ordnance Survey's 'Survey of Information on Microfilm') are published on microfilm and are updated between the main editions as an area was updated. They date from 1947 to 1984, and contain detailed information on buildings, roads and land-use. These maps were produced at both 1:2,500 and 1:1,250 scales.

Map Name(s) and Date(s)

TO2884SW	TO2884SE
1987	1982
1:1,250	1:1,250
TO2883NW	TO2883NE
1987	1982
1:1,250	1:1,250

Historical Map - Segment A13

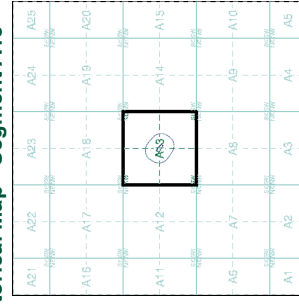

Order Details

Order Number: 62736435_1_1
 Customer Ref: J14367
 National Grid Reference: 528310, 184030
 Slice: A
 Site Area (Ha): 0.19
 Search Buffer (m): 100

Site Details

44a Gloucester Avenue, LONDON, NW1 8JD



Tel: 0844 844 9952
 Fax: 0844 844 9951
 Web: www.landmark.co.uk

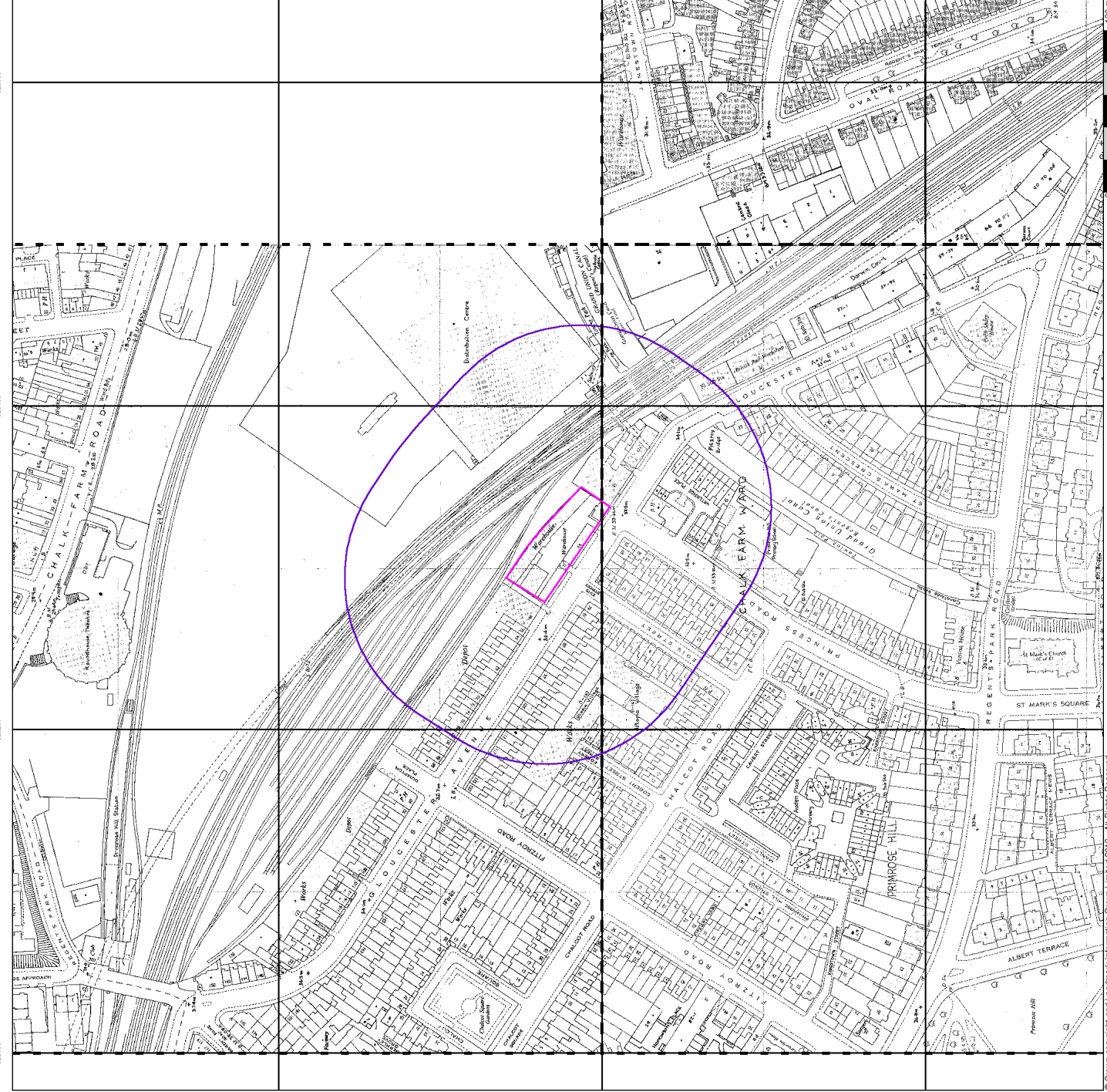

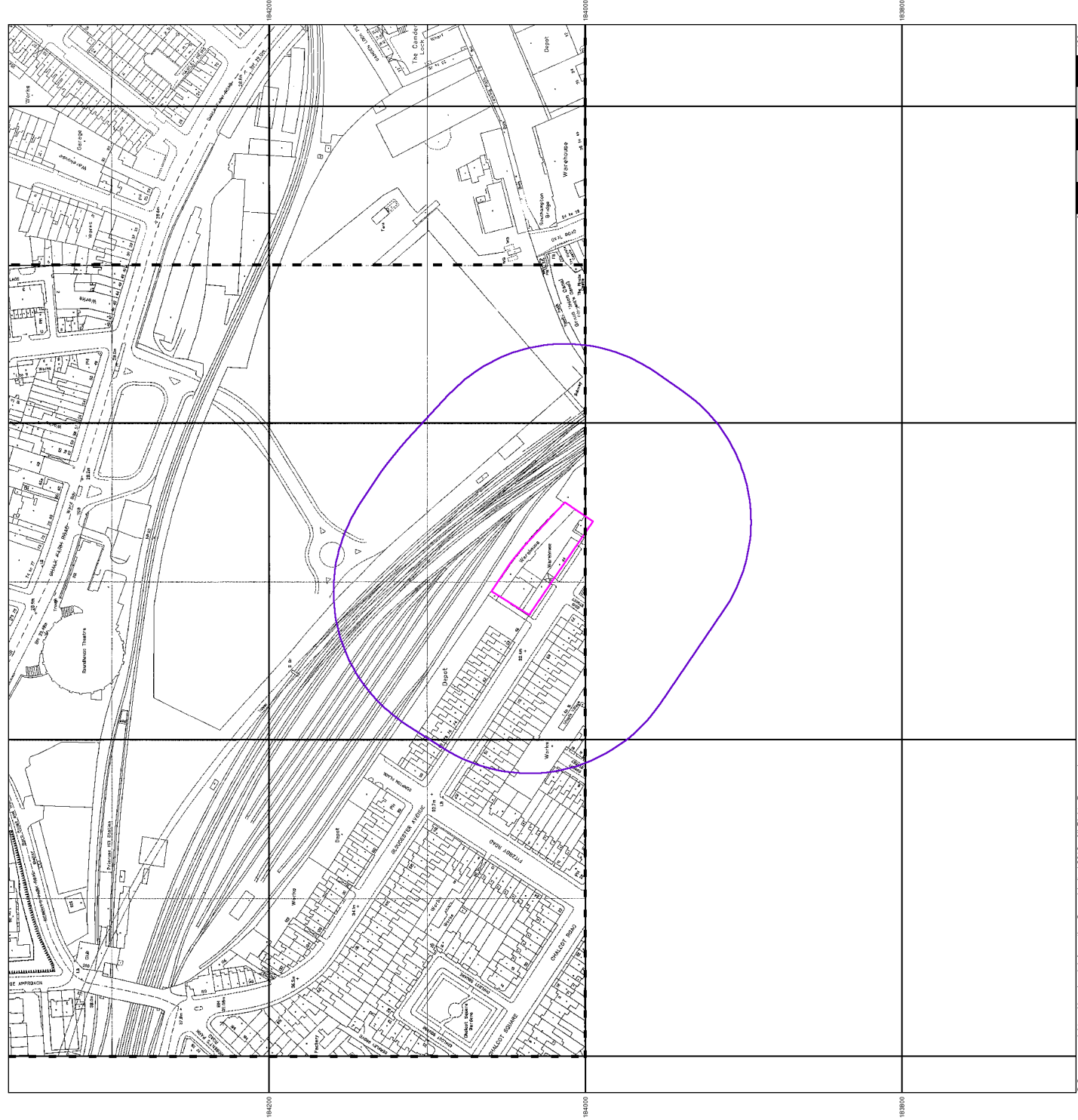

Geotechnical & Environmental Associates
Large-Scale National Grid Data
Published 1991 - 1994
Source map scale - 1:1,250

Large Scale National Grid Data superseded SIM cards (Ordnance Survey's information on Microdots) in 1992, and digital maps were produced until 1999. Information on houses and roads, but tend to show less topographic features such as vegetation. These maps were produced at both 1:2,500 and 1:1,250 scales.

Map Name(s) and Date(s)

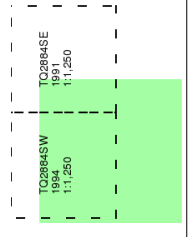

Historical Map - Segment A13

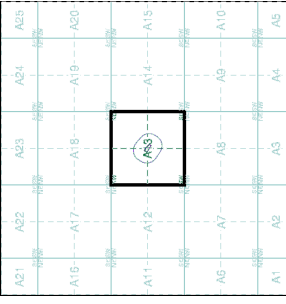

Order Details

Order Number: 62736435_1_1
 Customer Ref: J14367
 National Grid Reference: 528310, 184030
 Slice: A
 Site Area (Ha): 0.19
 Search Buffer (m): 100

Site Details

44a Gloucester Avenue, LONDON, NW1 8JD



Tel: 0844 844 9952
 Fax: 0844 844 9951
 Web: www.landmark.co.uk

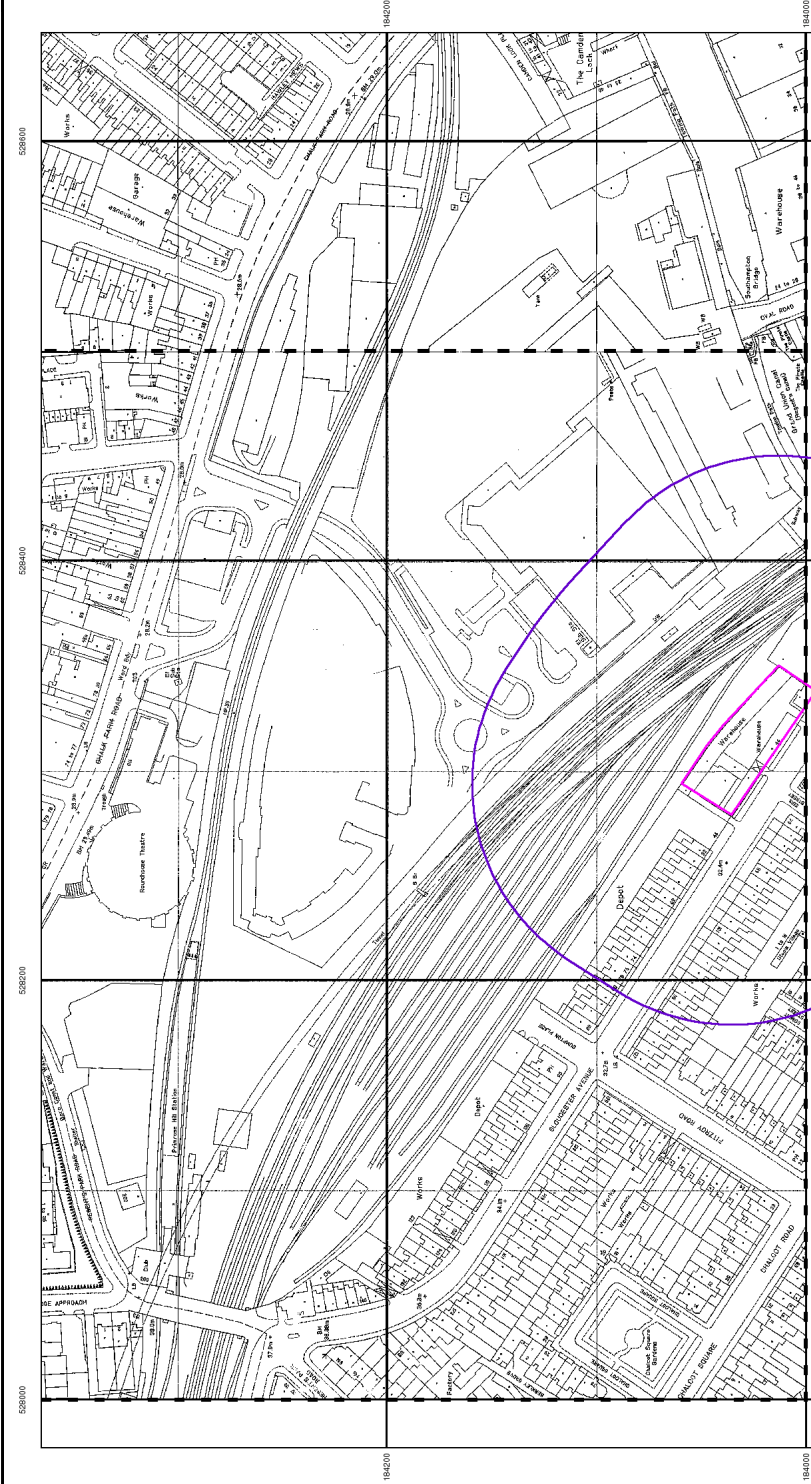

Geotechnical & Environmental Associates
Large-Scale National Grid Data
Published 1992 - 1995
Source map scale - 1:1,250

Large Scale National Grid Data superseded SIM cards (Ordnance Survey's information on Microdots) in 1992, and digital maps were produced until 1999. These maps were the first versions of digital mapping and so provide detailed information on houses and roads, but tend to show less topographic features such as vegetation. These maps were produced at both 1:2,500 and 1:1,250 scales.

Map Name(s) and Date(s)

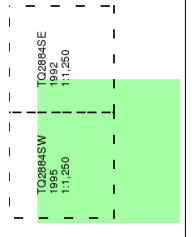

Historical Map - Segment A13

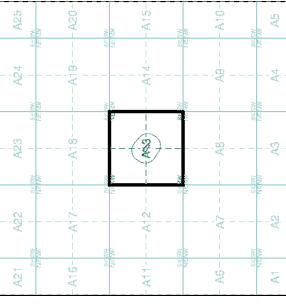

Order Details

Order Number: 62736435_1_1
 Customer Ref: J14367
 National Grid Reference: 528310, 184030
 Slice: A
 Site Area (Ha): 0.19
 Search Buffer (m): 100

Site Details

44a Gloucester Avenue, LONDON, NW1 8JD



Tel: 0844 844 9952
 Fax: 0844 844 9951
 Web: www.landmark.co.uk

Map Name(s) and Date(s)

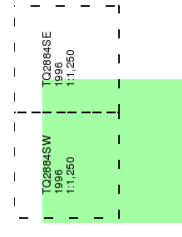

Historical Map - Segment A13

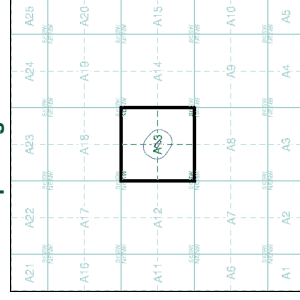

Order Details

Order Number: 62736435_1_1
 Customer Ref: J14367
 National Grid Reference: 528310, 184030
 Slice: A
 Site Area (Ha): 0.19
 Search Buffer (m): 100

Site Details

44a Gloucester Avenue, LONDON, NW1 8JD



Tel: 0844 844 9952
 Fax: 0844 844 9951
 Web: www.landmark.co.uk

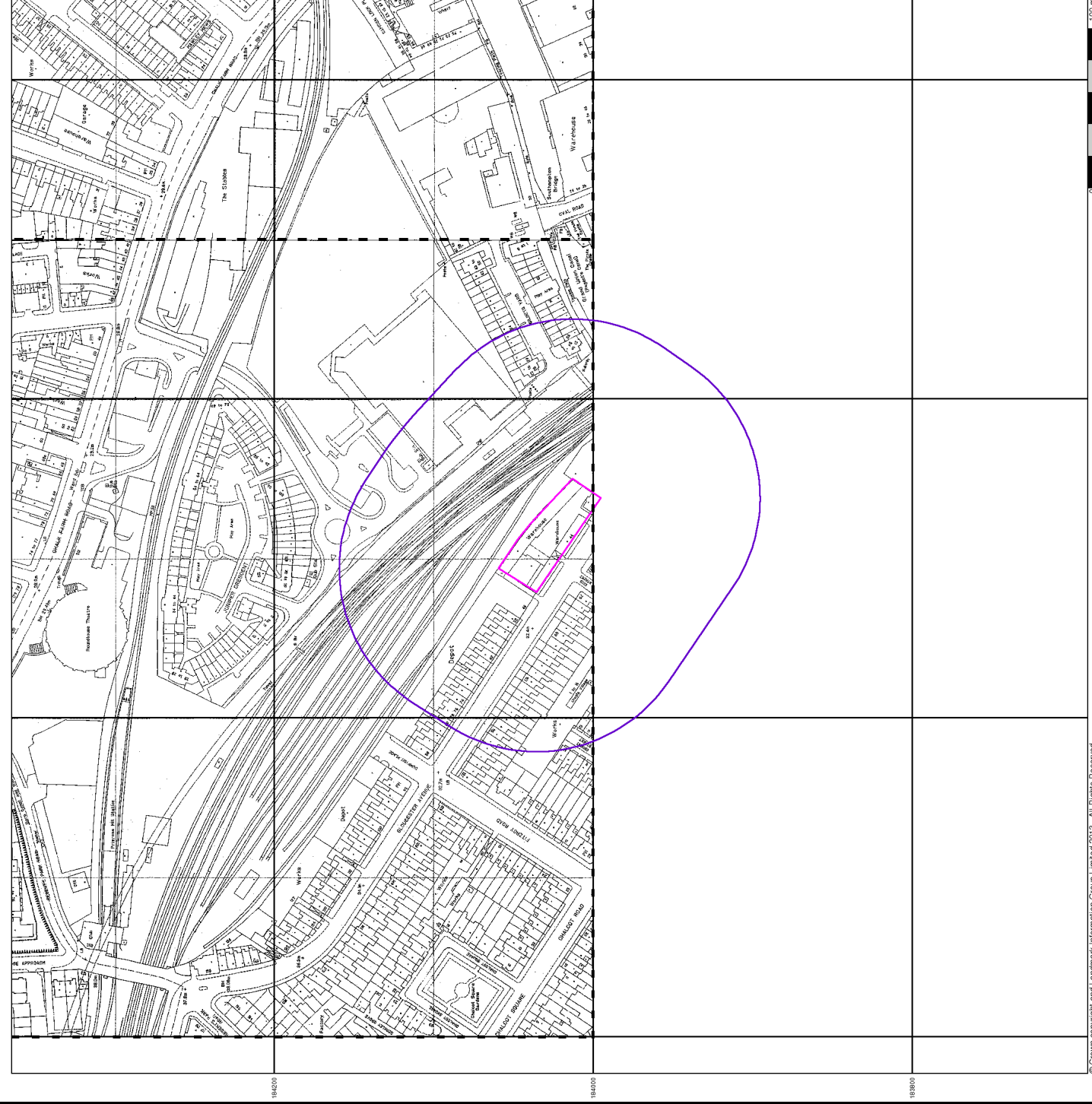

Site 44 Gloucester Avenue, London NW1 8JD

Client Victoria Square Property Company Ltd

Engineer Elliott Wood

Tyttenhanger House
 Coursers Road
 St Albans
 Herts AL4 0PG

Site Plan

Job Number
J14367

Sheet
1 / 2

Railway Line

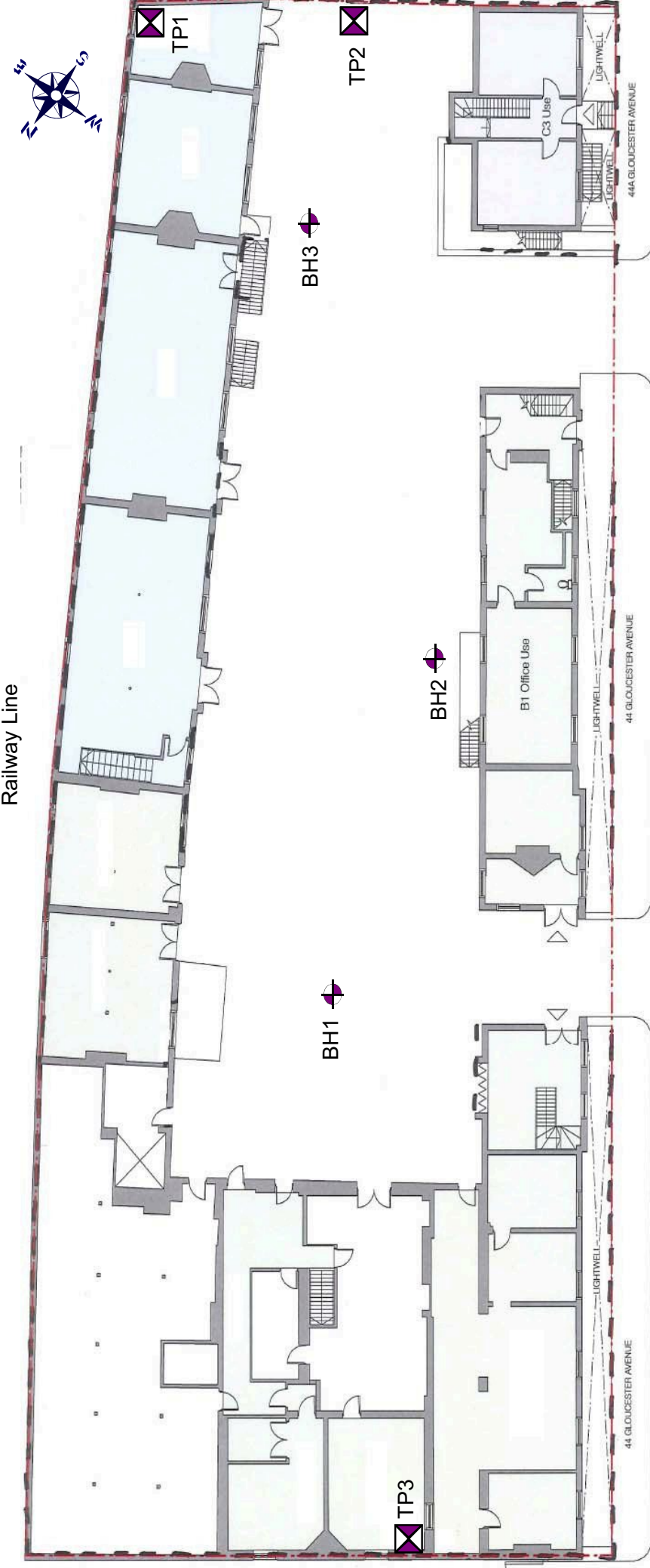

GLOUCESTER AVENUE



Approximate Scale in metres

Ground Floor Plan

Site 44 Gloucester Avenue, London NW1 8JD

Client Victoria Square Property Company Ltd

Engineer Elliott Wood

Job Number
J14367

Sheet
2 / 2

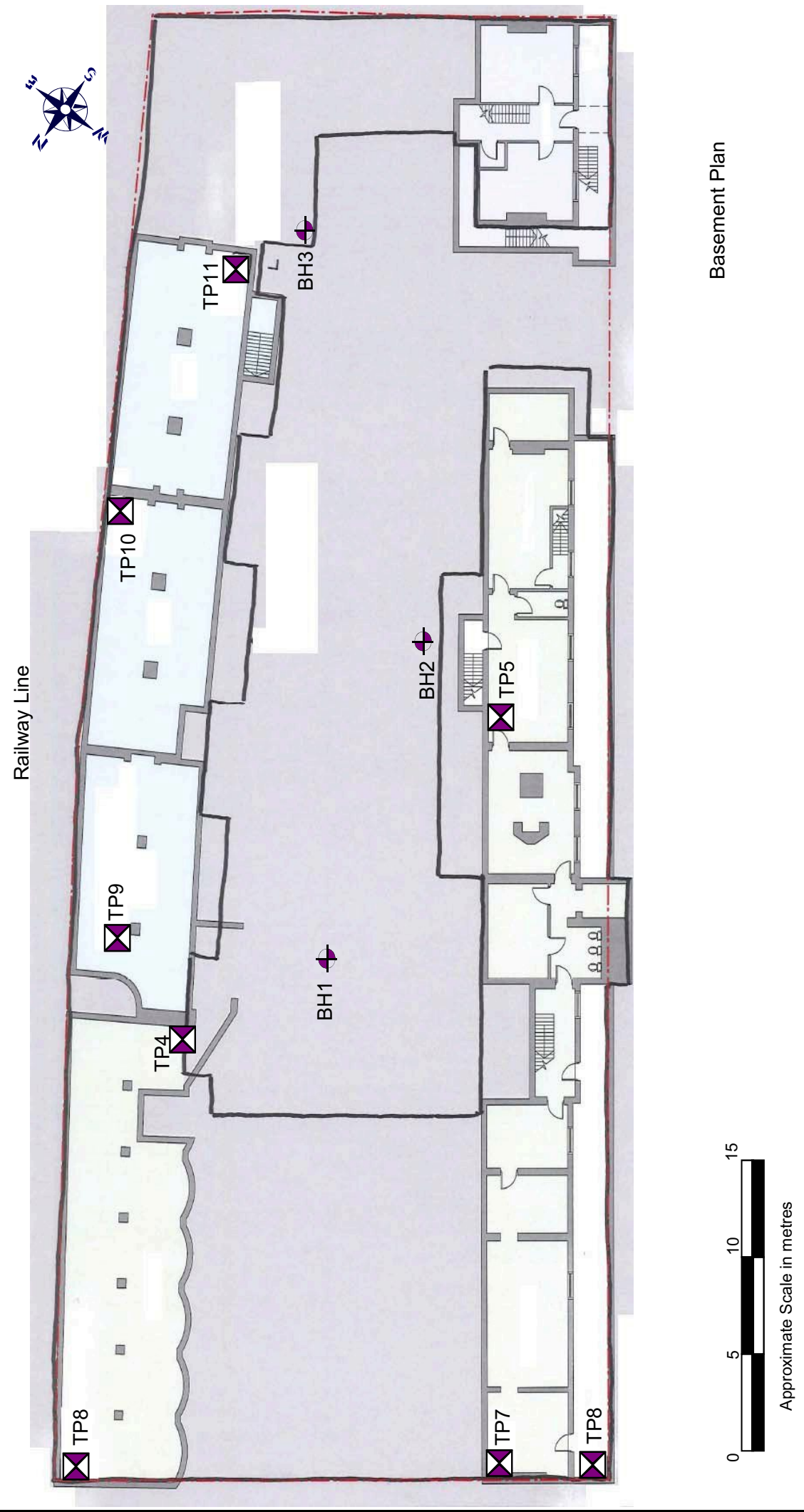

Geotechnical & Environmental Associates (GEA) is an engineer-led and client-focused independent specialist providing a complete range of geotechnical and contaminated land investigation, analytical and consultancy services to the property and construction industries.

We have offices at

Widbury Barn
Widbury Hill
Ware
Hertfordshire
SG12 7QE
tel 01727 824666
mail@gea-ltd.co.uk

Church Farm
Gotham Road
Kingston on Soar
Notts
NG11 0DE
tel 01509 674888
midlands@gea-ltd.co.uk

Enquiries can also be made on-line at

www.gea-ltd.co.uk

where information can be found on all of the services that we offer.

Wimbledon

241 The Broadway
London
SW19 1SD

tel. (020) 8544 0033
fax. (020) 8544 0066

Central London

4 John Prince's Street
London
W1G 0JL

tel. (020) 7499 5888
fax. (020) 7499 5444

Nottingham

1 Sampson's Yard
Halifax Place
Nottingham
NG1 1QN

tel. 0870 460 0061
fax. 0870 460 0062

email: info@elliottwood.co.uk
www.elliottwood.co.uk

elliott wood partnership llp
structural and civil engineers



INVESTOR IN PEOPLE