

PERMITTED DEVELOPMENT CONSIDERATION:

Proposed rear dormer add: 30.6 CuM

Development is within allowance of 40 CuM for roof extension

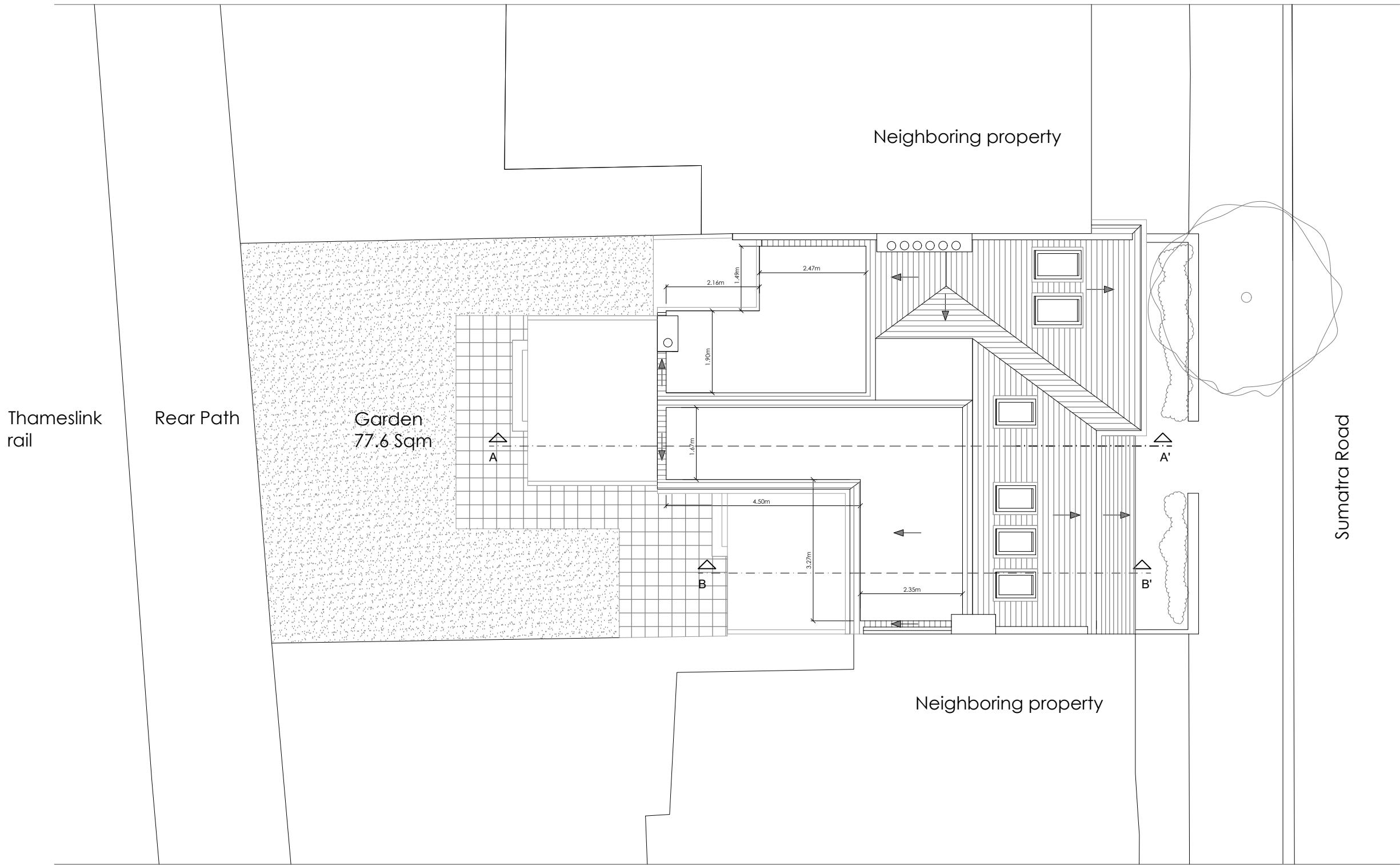

Roof Plan



DRAWING NOTES

Dimensions Written dimensions to be taken in preferences to scaled dimensions. The Contractor is responsible for checking all dimensions before work starts.

Local Authority All work is to be carried out to the requirements, and to the satisfaction of the Local Authority. These drawings are for planning purposes only.

Discrepancies Any discrepancies to be brought to the attention of Drawing And Planning Ltd. immediately.

REVISIONS

REV	DATE	DESCRIPTION	BY	CH

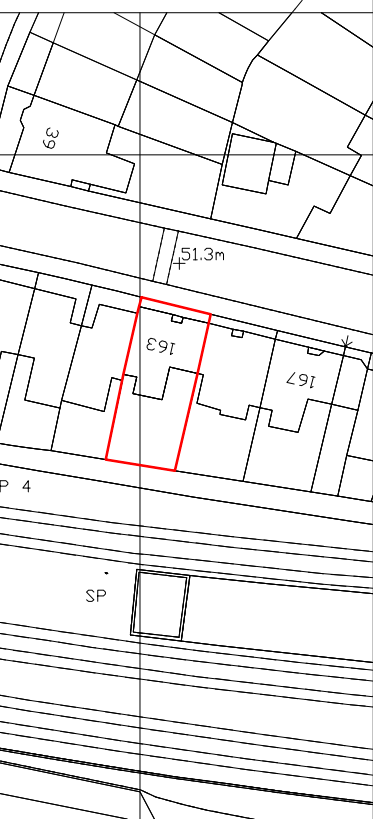

PROJECT TITLE

163 Sumatra Road

DRAWING TITLE

Proposed Roof Plan

CLIENT

Jeremy Stein

DRAWING No

SUTRD-P105

REV

SCALE @ A3 - 1:100

DATE

May 2017

DRAWING STATUS

Planning

