

**PLAN VIEW
GROUND FLOOR FFL+25.600m**

Safety, Health and Environment Information
In addition to the hazards/risks normally associated with the types of work detailed on this drawing, note the following information:

Construction	NO UNUSUAL RISK
Dismantling/ Demolition (Future)	NO UNUSUAL RISK

For information relating to Use, Cleaning and Maintenance see Health and Safety File. It is assumed that all works will be carried out by a competent contractor working, where appropriate, to an approved method statement.

GENERAL NOTES:
STEEL BEAMS GRADE S355J0
ALL STEEL CONNECTIONS GRADE S275 U.N.O
ALL BOLTS GRADE 8.8
FOR STRUCTURAL CHECKING REFER TO:
E101-34-CPW-XX-CALC-024

FINISH:-
SHOT BLAST CLEAN SA2.5 & FACTORY SPRAYED:
- INITIAL COAT: INTERCURE 200 OR SIMILAR
PRIMER RECOMMENDED BY MANUFACTURER -
(100 MICRONS MIN. DFT)
OR AS STRUCTURAL ENGINEER'S SPECIFICATION
FOR CORROSION PROTECTION.
- COLOUR: GREY.
- FINISHING COAT: INTERGARD 400 - MICACEOUS
IRON OXIDE FINISH.
(100 MICRONS MIN. DFT)
- COLOUR: DARK GREY

THIS DRAWING PREPARED IN
ACCORDANCE WITH RMA DRGS:
 600-14025-CPL_C1
 600-14026-CPL_C1
 600-14153-CPH_C1
 600-14154-CPH_C2
 600-42100-CPL_C1
 600-43815-CPL_C1
 600-43816-CPL_C1
 600-43817-CPL_C1
 600-43818-CPL_C1

THIS DRAWING PREPARED IN
ACCORDANCE WITH PF DRGS:
 A12504-VAA-201-S
 A12504-VAA-202-R
 A12504-VAA-214-H
 A12504-VAA-240-B

Rev	Revision Details	Check	Date
D	ATRIUM BALUSTRADE ALTERED	JS	12-05-17
C	FOR CONSTRUCTION	JS	02-03-17
B	UPDATED TO COMMENTS	LBF	14-12-16
A	FIRST ISSUE	LBF	19-07-16

Client:
Almacantar

Contractor:
MULTIPLEX

Lee Warren Fabrication and Design Ltd.
Units 6-9 Silverdale Road Industrial Estate,
Silverdale Road, Hayes, Middlesex
UB8 3BL, United Kingdom

CE
14
0086-CPR-613428

Project:
CENTRE POINT LONDON

Title:
**STAIRCASE 2
PLAN VIEW
GROUND FLOOR**

Status: FOR CONSTRUCTION	Date: 18-07-16	Scale: 1:15
Job No.: 1689-077	Drawn by: JS [DDM]	Checked by: LBF
Origin: E101	CISFB Code: 34	Bldg Code: CPL
Level: XX	Series: 264	Revision: D

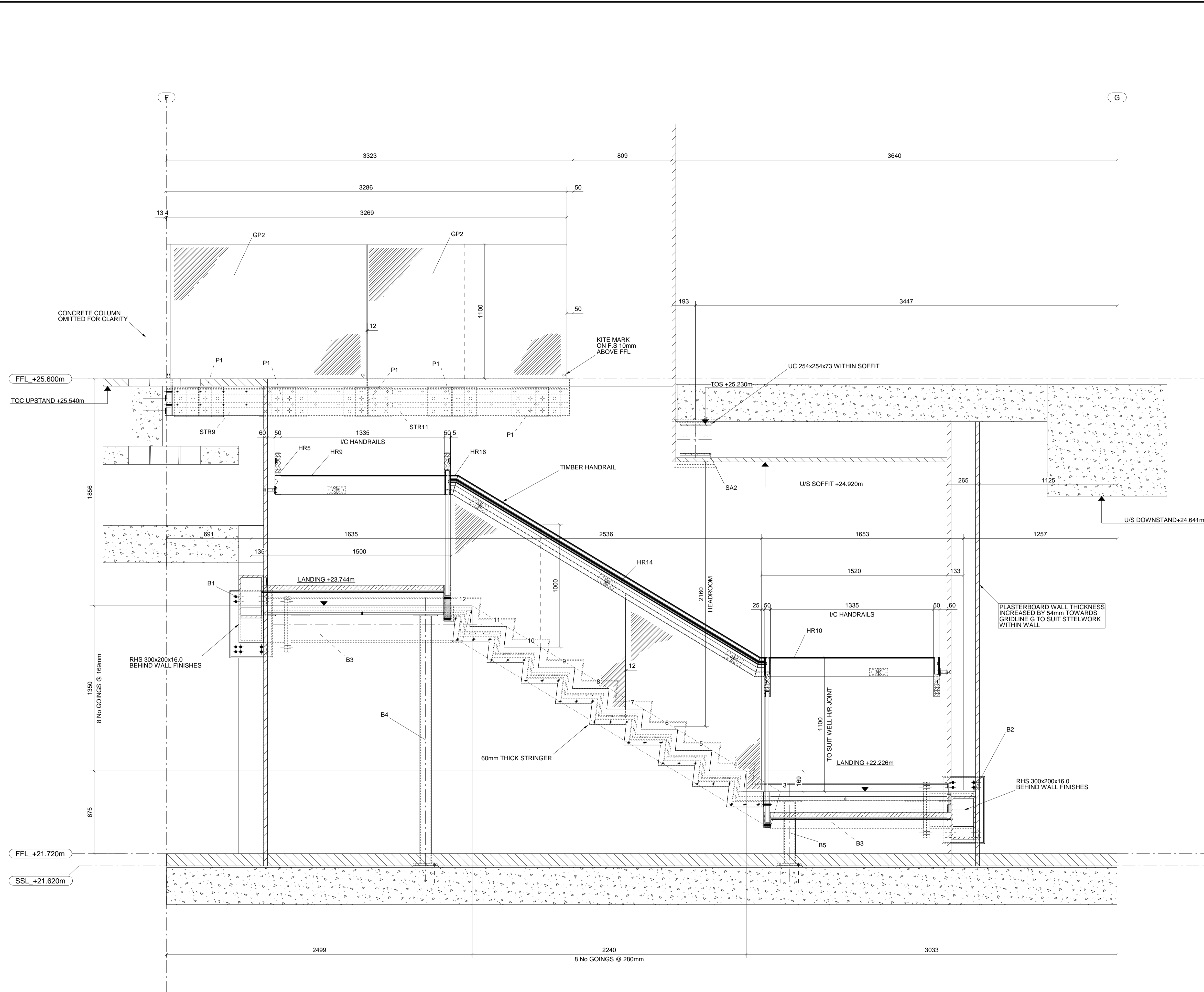

SECTION B - B
E101-34-CPH-X-263

Safety, Health and Environment Information
In addition to the hazards/risks normally associated with the types of work detailed on this drawing, note the following information:

Construction	NO UNUSUAL RISK
Dismantling/ Demolition (Future)	NO UNUSUAL RISK

For information relating to Use, Cleaning and Maintenance see Health and Safety File. It is assumed that all works will be carried out by a competent contractor working, where appropriate, to an approved method statement.

GENERAL NOTES:
STEEL BEAMS GRADE S355J0
ALL STEEL CONNECTIONS GRADE S275 U.N.O
ALL BOLTS GRADE 8.8

FOR STRUCTURAL CHECKING REFER TO:
E101-34-CPW-XX-CALC-024

FINISH:-
SHOT BLAST CLEAN SA2.5 & FACTORY SPRAYED:
- INITIAL COAT: INTERCURE 200 OR SIMILAR
PRIMER RECOMMENDED BY MANUFACTURER –
(100 MICRONS MIN. DFT)
OR AS STRUCTURAL ENGINEER'S SPECIFICATION
FOR CORROSION PROTECTION.
- COLOUR: GREY.
- FINISHING COAT: INTERGARD 400 - MICACEOUS
IRON OXIDE FINISH.
(100 MICRONS MIN. DFT)
- COLOUR: DARK GREY

THIS DRAWING PREPARED IN ACCORDANCE WITH RMA DRGS:
600-14025-CPL_C1
600-14026-CPL_C1
600-14153-CPH_C1
600-14154-CPH_C2
600-42100-CPL_C1
600-43815-CPL_C1
600-43816-CPL_C1
600-43817-CPL_C1
600-43818-CPL_C1

THIS DRAWING PREPARED IN ACCORDANCE WITH PF DRGS:
A12504-VAA-201-S
A12504-VAA-202-R
A12504-VAA-214-H
A12504-VAA-240-B

Rev	Revision Details	Check	Date
D	ATRIUM BALUSTRADE ALTERED	JS	12-05-17
C	FOR CONSTRUCTION	JS	02-03-17
B	UPDATED TO COMMENTS	LBF	14-12-16
A	FIRST ISSUE	LBF	19-07-16

Client:
Almacantar

Contractor:
MULTIPLEX

Lee Warren Fabrication and Design Ltd.
Units 6-9 Silverdale Road Industrial Estate,
Silverdale Road, Hayes, Middlesex
UB8 3BL, United Kingdom

CE
14
0086-CPR-613428



Project:
CENTRE POINT LONDON

Title:
**STAIRCASE 2
SECTION B - B**

Status: FOR CONSTRUCTION	Date: 19-07-16	Scale: 1:15			
Job No.: 1689-077	Drawn by: JS [DDM]	Checked by: LBF			
Origin	CISFB Code	Blig Code	Level	Series	Revision
E101	34	CPL	XX	266	D

Safety, Health and Environment Information
 In addition to the hazards/risks normally associated with the types of work detailed on this drawing, note the following information:

Construction	NO UNUSUAL RISK
Dismantling/ Demolition (Future)	NO UNUSUAL RISK

For information relating to Use, Cleaning and Maintenance see Health and Safety File. It is assumed that all works will be carried out by a competent contractor working, where appropriate, to an approved method statement.

GENERAL NOTES:
 STEEL BEAMS GRADE S355J0
 ALL STEEL CONNECTIONS GRADE S275 U.N.O
 ALL BOLTS GRADE 8.8

FOR STRUCTURAL CHECKING REFER TO:
 E101-34-CPW-XX-CALC-024

FINISH:-
 SHOT BLAST CLEAN SA2.5 & FACTORY SPRAYED:
 - INITIAL COAT: INTERCURE 200 OR SIMILAR PRIMER RECOMMENDED BY MANUFACTURER – (100 MICRONS MIN. DFT)
 OR AS STRUCTURAL ENGINEER'S SPECIFICATION FOR CORROSION PROTECTION.
 - COLOUR: GREY.
 - FINISHING COAT: INTERGARD 400 - MICACEOUS IRON OXIDE FINISH. (100 MICRONS MIN. DFT)
 - COLOUR: DARK GREY

THIS DRAWING PREPARED IN ACCORDANCE WITH RMA DRGS:

- 600-14025-CPL_C1
- 600-14026-CPL_C1
- 600-14153-CPH_C1
- 600-14154-CPH_C2
- 600-42100-CPL_C1
- 600-43815-CPL_C1
- 600-43816-CPL_C1
- 600-43817-CPL_C1
- 600-43818-CPL_C1

THIS DRAWING PREPARED IN ACCORDANCE WITH PF DRGS:

- A12504-VAA-201-S
- A12504-VAA-202-R
- A12504-VAA-214-H
- A12504-VAA-240-B

D	ATRIUM BALUSTRADE ALTERED	JS	12-05-17
C	FOR CONSTRUCTION	JS	02-03-17
B	UPDATED TO COMMENTS	LBF	14-12-16
A	FIRST ISSUE	LBF	19-07-16
Rev	Revision Details	Check	Date

Client:
Almacantar

Contractor:
MULTIPLEX

Lee Warren Fabrication and Design Ltd.
 Units 6-9 Silverdale Road Industrial Estate,
 Silverdale Road, Hayes, Middlesex
 UB3 3BL, United Kingdom

CE

14
 0086-CPR-613428



Project:
CENTRE POINT LONDON

Title:
**STAIRCASE 2
 SECTION C - C**

Status: FOR CONSTRUCTION	Date: 19-07-16	Scale: 1:15
Job No.: 1689-077	Drawn by: JS [DDM]	Checked by: LBF

Origin	CISFB Code	Bldg Code	Level	Series	Revision
E101	34	CPL	XX	267	D

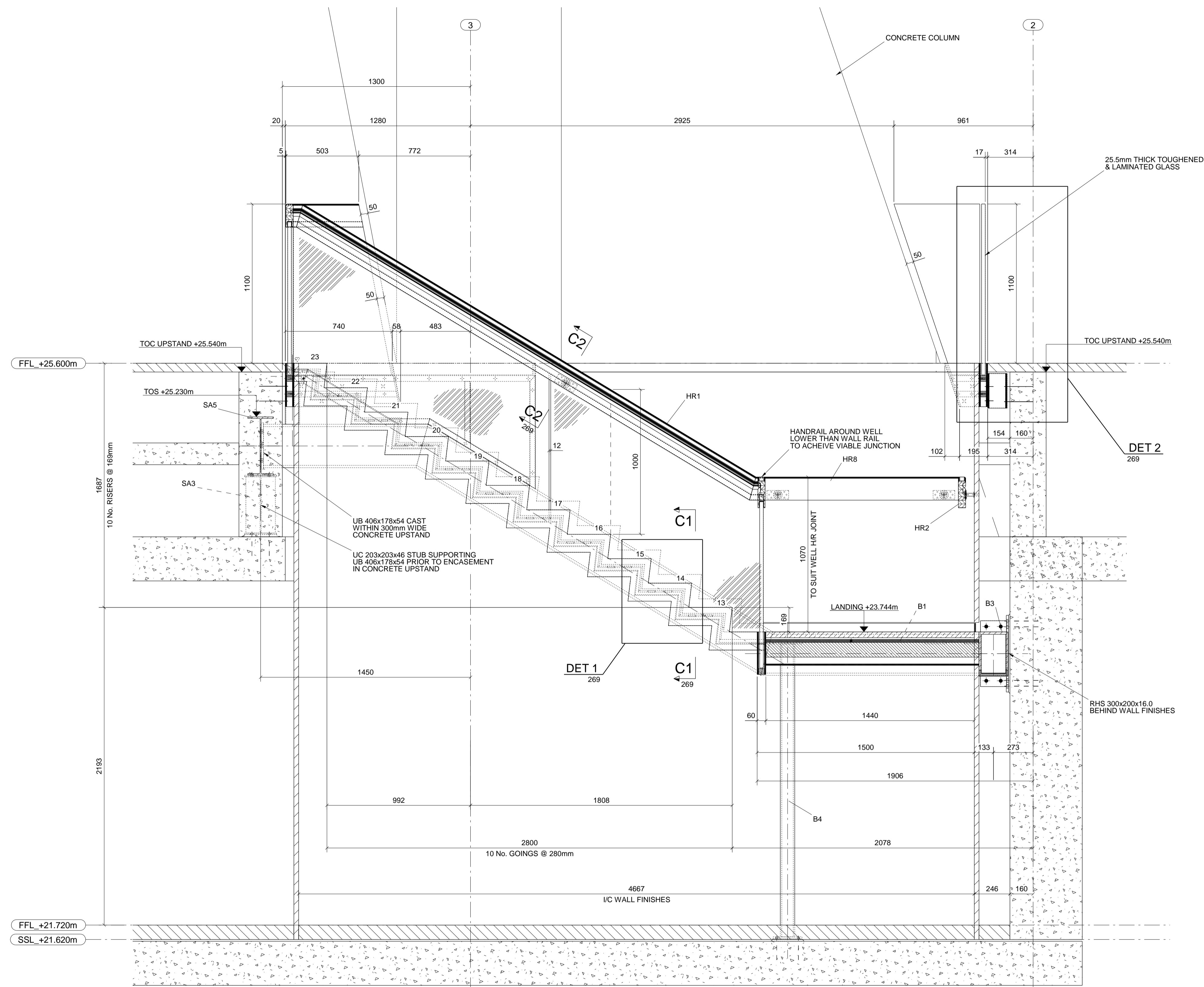

SECTION C - C
 E101-34-CPH-X-264

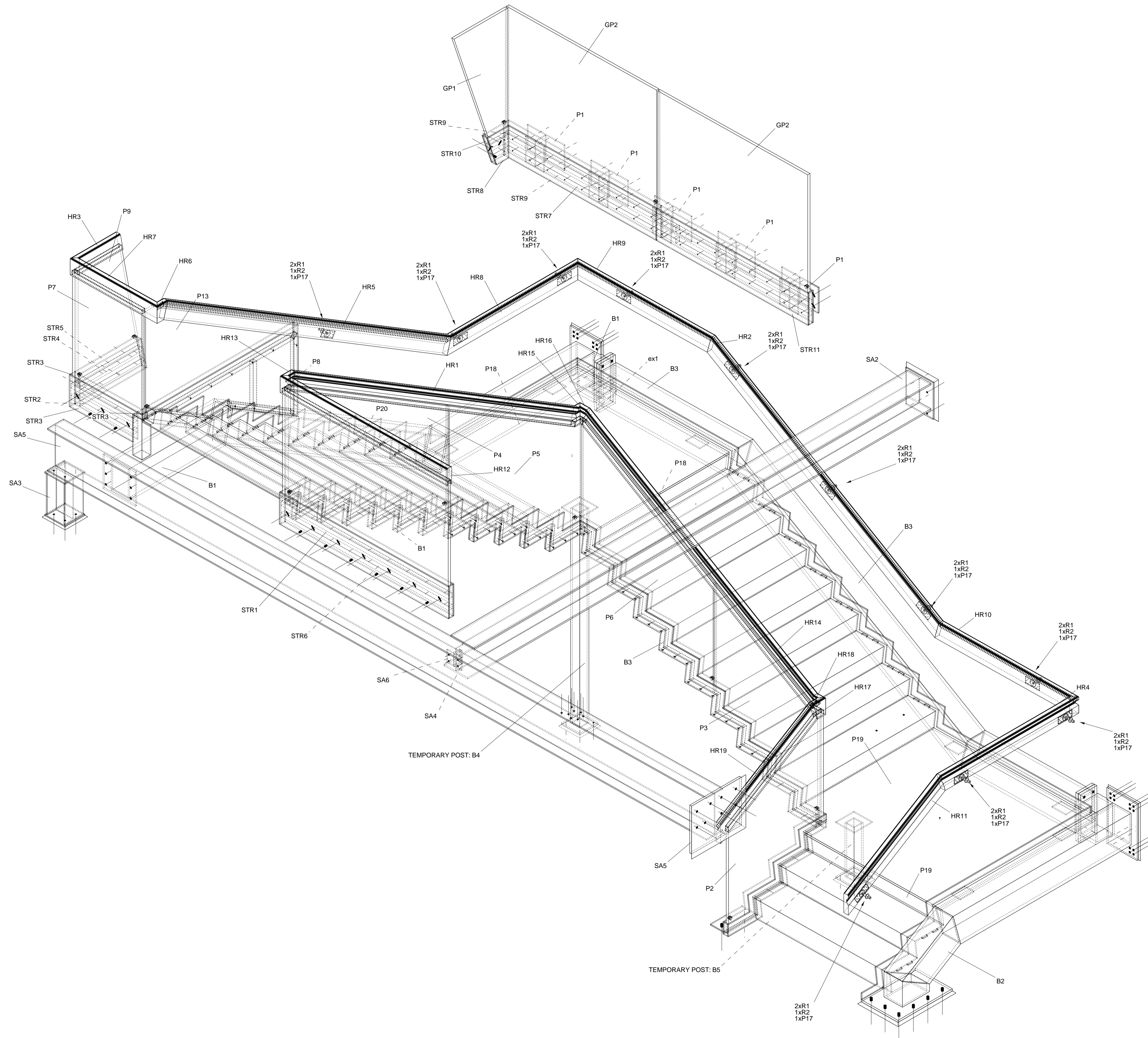

ISOMETRIC VIEW
SECONDARY STEELWORK

Safety, Health and Environment Information
In addition to the hazards/risks normally associated with the types of work detailed on this drawing, note the following information:

Construction	NO UNUSUAL RISK
Dismantling/ Demolition (Future)	NO UNUSUAL RISK

For information relating to Use, Cleaning and Maintenance see Health and Safety File. It is assumed that all works will be carried out by a competent contractor working, where appropriate, to an approved method statement.

GENERAL NOTES:
STEEL BEAMS GRADE S355J0
ALL STEEL CONNECTIONS GRADE S275 U.N.O
ALL BOLTS GRADE 8.8
FOR STRUCTURAL CHECKING REFER TO:
E101-34-CPW-XX-CALC-024

FINISH:-
SHOT BLAST CLEAN SA2.5 & FACTORY SPRAYED:
- INITIAL COAT: INTERCURE 200 OR SIMILAR
PRIMER RECOMMENDED BY MANUFACTURER –
(100 MICRONS MIN. DFT)
OR AS STRUCTURAL ENGINEER'S SPECIFICATION
FOR CORROSION PROTECTION.
- COLOUR: GREY.
- FINISHING COAT: INTERGARD 400 - MICACEOUS
IRON OXIDE FINISH.
(100 MICRONS MIN. DFT)
- COLOUR: DARK GREY

THIS DRAWING PREPARED IN
ACCORDANCE WITH RMA DRGS:
 600-14025-CPL_C1
 600-14026-CPL_C1
 600-14153-CPH_C1
 600-14154-CPH_C2
 600-42100-CPL_C1
 600-43815-CPL_C1
 600-43816-CPL_C1
 600-43817-CPL_C1
 600-43818-CPL_C1

THIS DRAWING PREPARED IN
ACCORDANCE WITH PF DRGS:
 A12504-VAA-201-S
 A12504-VAA-202-R
 A12504-VAA-214-H
 A12504-VAA-240-B

Rev	Revision Details	Check	Date
B	ATRIUM BALUSTRADE ALTERED	JS	12-05-17
A	FIRST ISSUE	JS	02-03-17

Client:
Almacantar

Contractor:
MULTIPLEX

Lee Warren Fabrication and Design Ltd.
 Units 6-9 Silverdale Road Industrial Estate,
 Silverdale Road, Hayes, Middlesex
 UB8 3BL, United Kingdom

CE

14
0086-CPR-613428

Project:
CENTRE POINT LONDON

Title:
STAIRCASE 2
ISOMETRIC VIEW
PART MARK GA

Status: FOR CONSTRUCTION	Date: 16-02-17	Scale: 1:15			
Job No.: 1689-077	Drawn by: JS [DDM]	Checked by: JS			
Origin	CISFB Code	Bldg Code	Level	Series	Revision
E101	34	CPL	XX	451	B

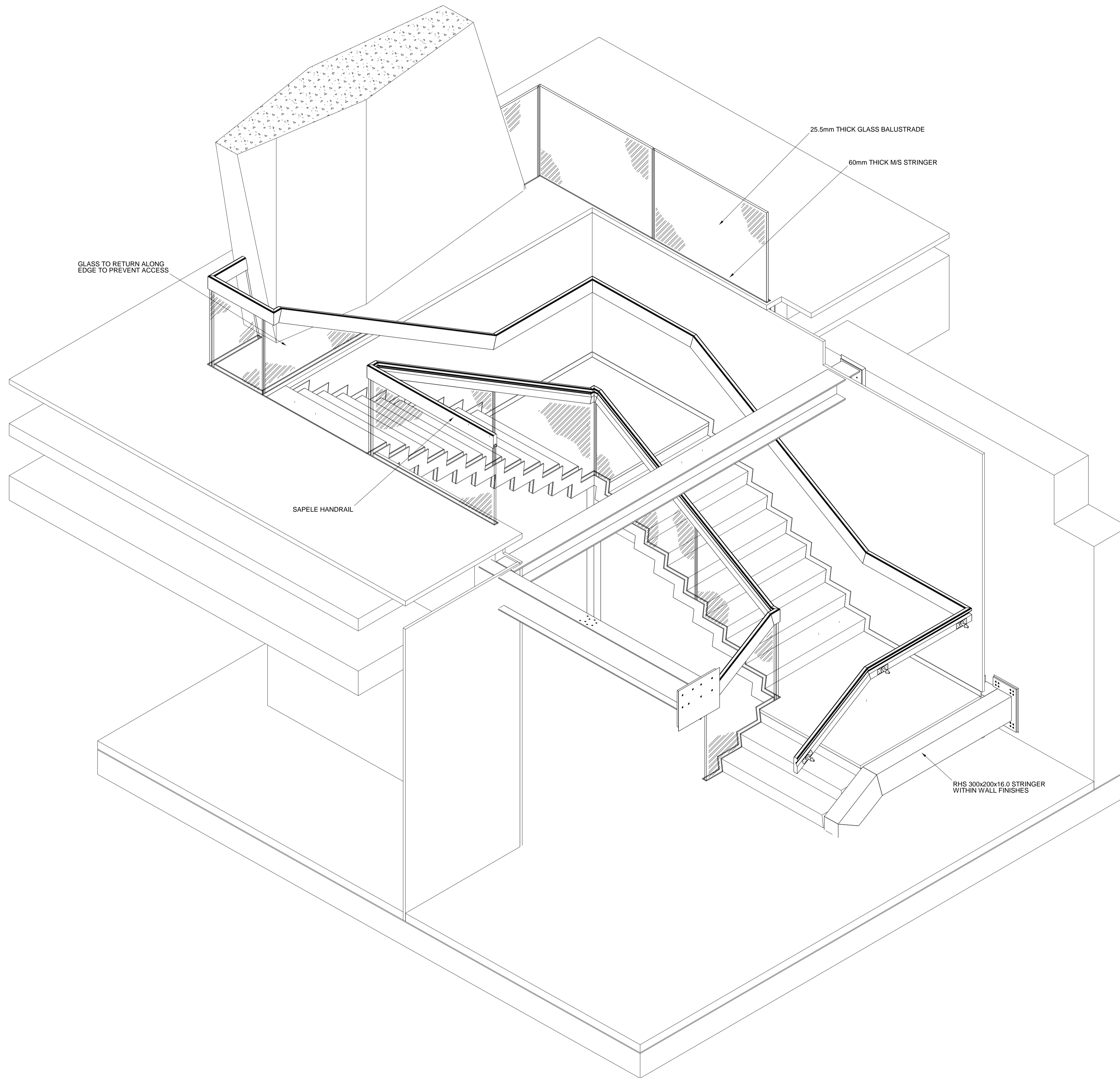

ISOMETRIC VIEW

Safety, Health and Environment Information
 In addition to the hazards/risks normally associated with the types of work detailed on this drawing, note the following information:

Construction	NO UNUSUAL RISK
Dismantling/ Demolition (Future)	NO UNUSUAL RISK

For information relating to Use, Cleaning and Maintenance see Health and Safety File. It is assumed that all works will be carried out by a competent contractor working, where appropriate, to an approved method statement.

GENERAL NOTES:
 STEEL BEAMS GRADE S355J0
 ALL STEEL CONNECTIONS GRADE S275 U.N.O
 ALL BOLTS GRADE 8.8
 FOR STRUCTURAL CHECKING REFER TO:
 E101-34-CPW-XX-CALC-024

FINISH:-
 SHOT BLAST CLEAN SA2.5 & FACTORY SPRAYED:
 - INITIAL COAT: INTERCURE 200 OR SIMILAR PRIMER RECOMMENDED BY MANUFACTURER – (100 MICRONS MIN. DFT)
 OR AS STRUCTURAL ENGINEER'S SPECIFICATION FOR CORROSION PROTECTION.
 - COLOUR: GREY.
 - FINISHING COAT: INTERGARD 400 - MICACEOUS IRON OXIDE FINISH. (100 MICRONS MIN. DFT)
 - COLOUR: DARK GREY

THIS DRAWING PREPARED IN ACCORDANCE WITH RMA DRGS:
 600-14025-CPL_C1
 600-14026-CPL_C1
 600-14153-CPH_C1
 600-14154-CPH_C2
 600-42100-CPL_C1
 600-43815-CPL_C1
 600-43816-CPL_C1
 600-43817-CPL_C1
 600-43818-CPL_C1

THIS DRAWING PREPARED IN ACCORDANCE WITH PF DRGS:
 A12504-VAA-201-S
 A12504-VAA-202-R
 A12504-VAA-214-H
 A12504-VAA-240-B

D	ATRIUM BALUSTRADE ALTERED	JS	12-05-17
C	FOR CONSTRUCTION	JS	02-03-17
B	UPDATED TO COMMENTS	LBF	14-12-16
A	FIRST ISSUE	LBF	19-07-16
Rev	Revision Details	Check	Date

Client:
Almacantar

Contractor:
MULTIPLEX

Lee Warren Fabrication and Design Ltd.
 Units 6-9 Silverdale Road Industrial Estate,
 Silverdale Road, Hayes, Middlesex
 UB3 3BL, United Kingdom

CE
 14
 0086-CPR-613428

Project:
CENTRE POINT LONDON

Title:
**STAIRCASE 2
 ISOMETRIC VIEW**

Status: FOR CONSTRUCTION	Date: 18-07-16	Scale: 1:20			
Job No.: 1689-077	Drawn by: JS [DDM]	Checked by: LBF			
Origin	CISFB Code	Bldg Code	Level	Series	Revision
E101	34	CPL	XX	262	D