

1 Plan Detail at Jamb of Sliding Folding Door - Ground Level

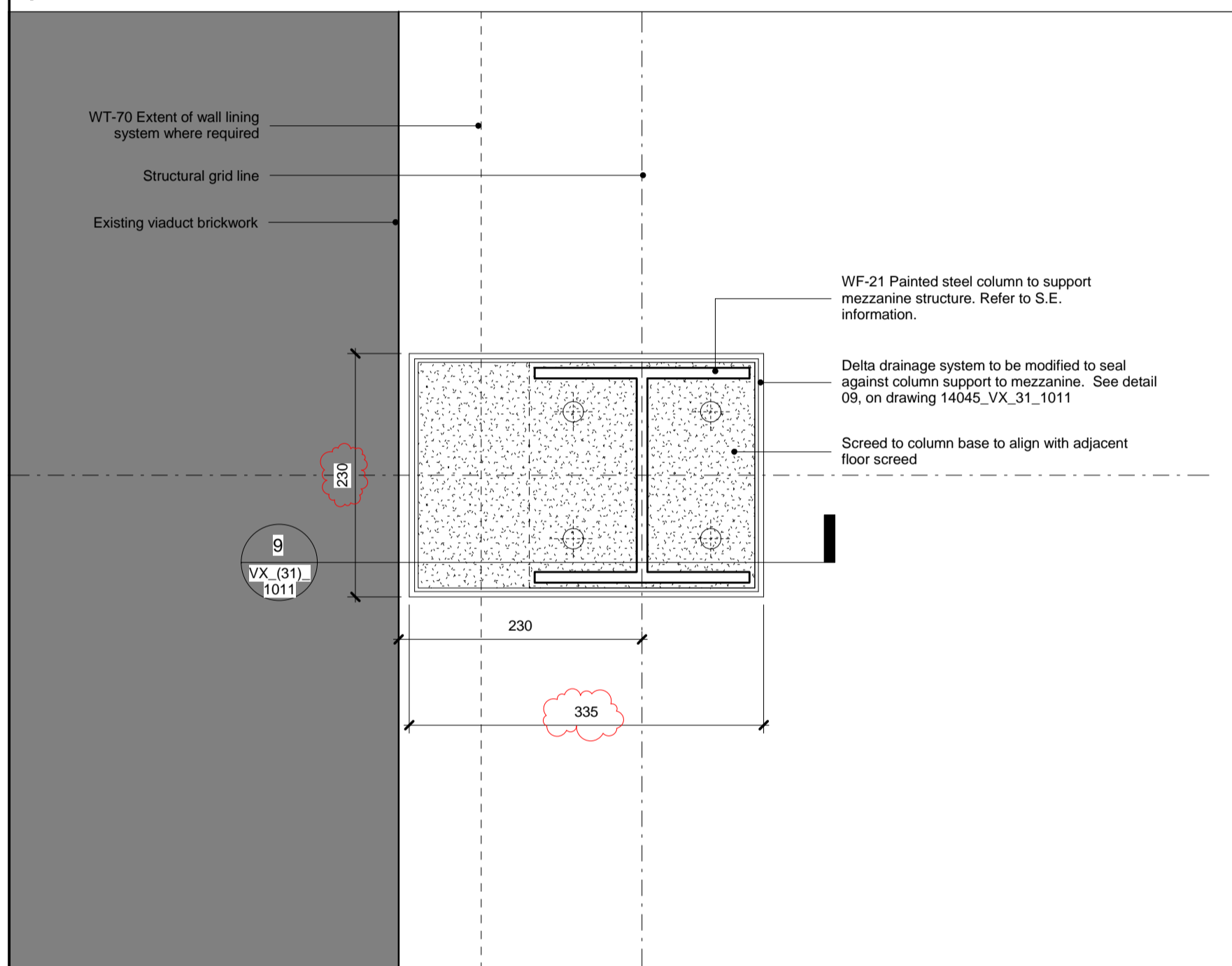

2 Plan Detail at Column Base

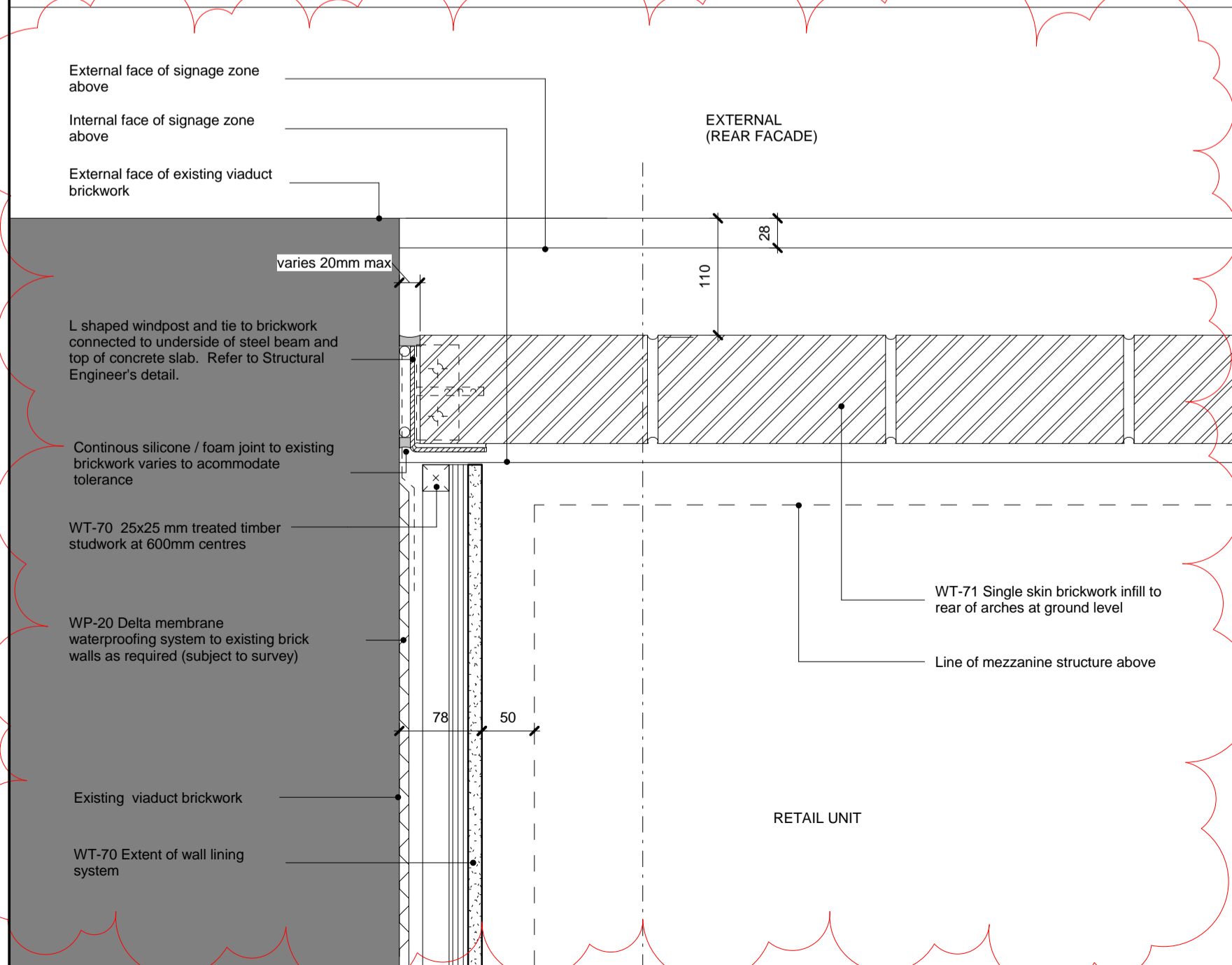

3 Plan Detail at Jamb to Rear Brick Wall - Ground Level

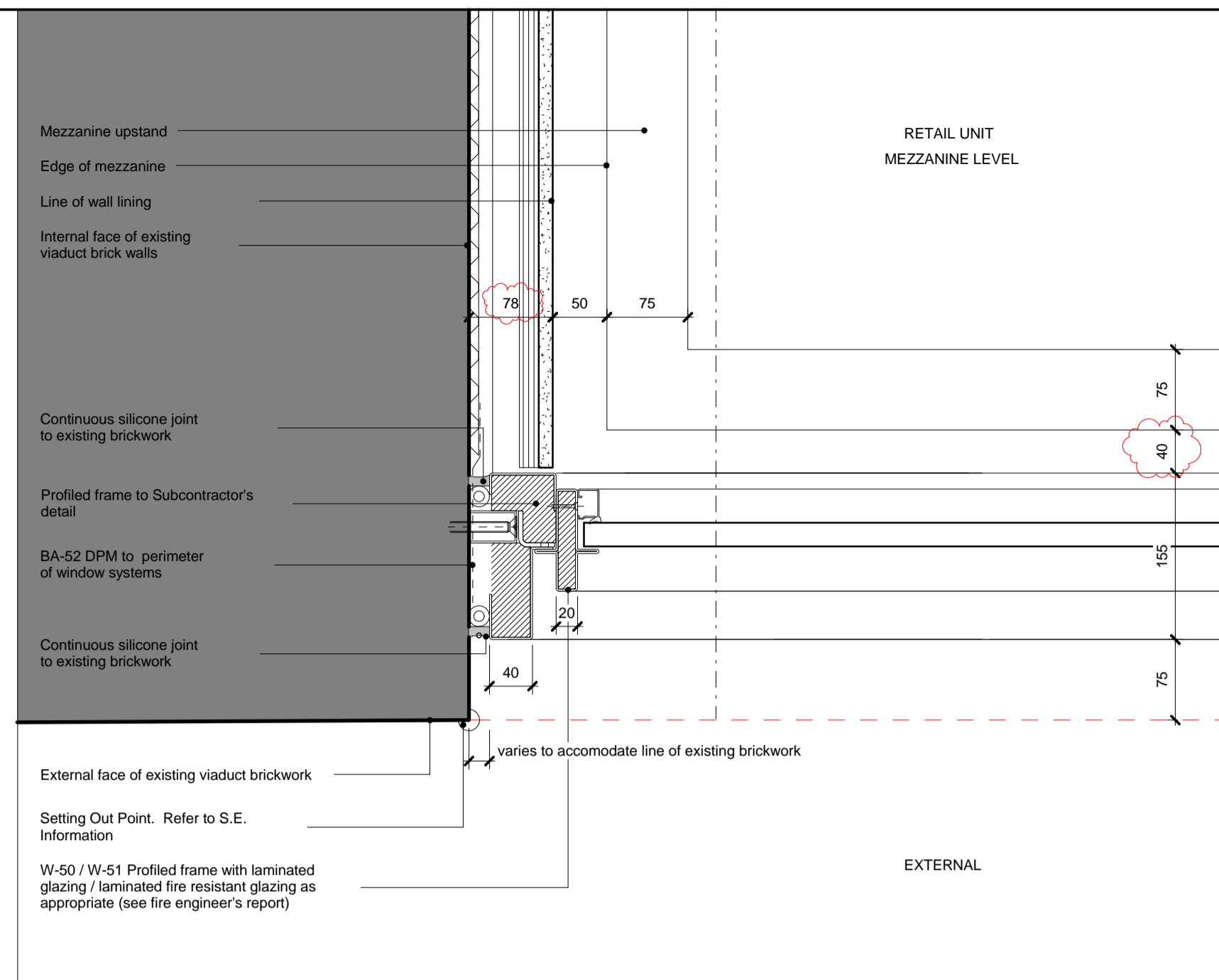

4 Plan Detail of Jamb of Fixed Facade Above Signage Zone - No Existing Corbel

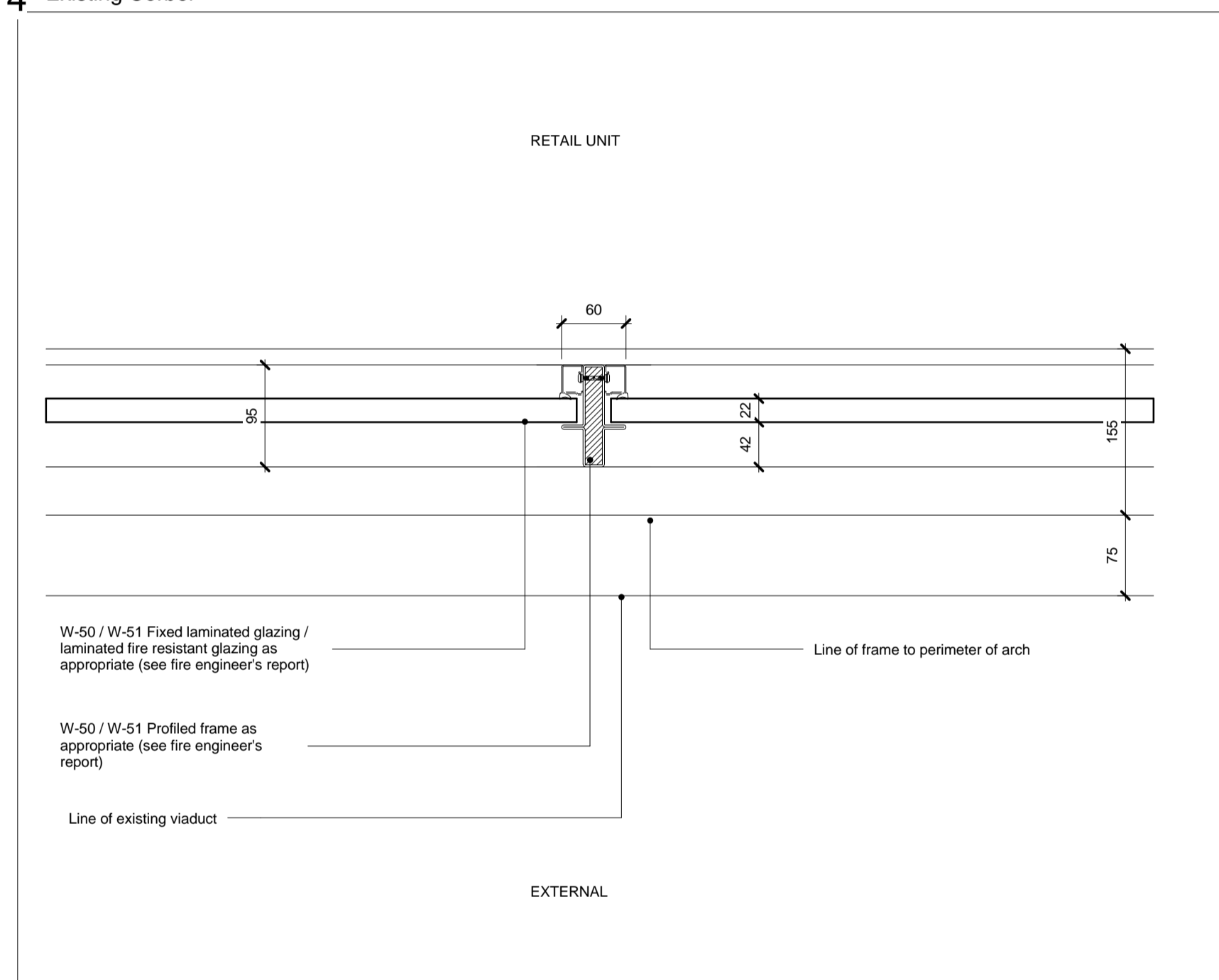

5 Plan Detail - Mullion of Fixed Glazed Facade - Mezzanine Level

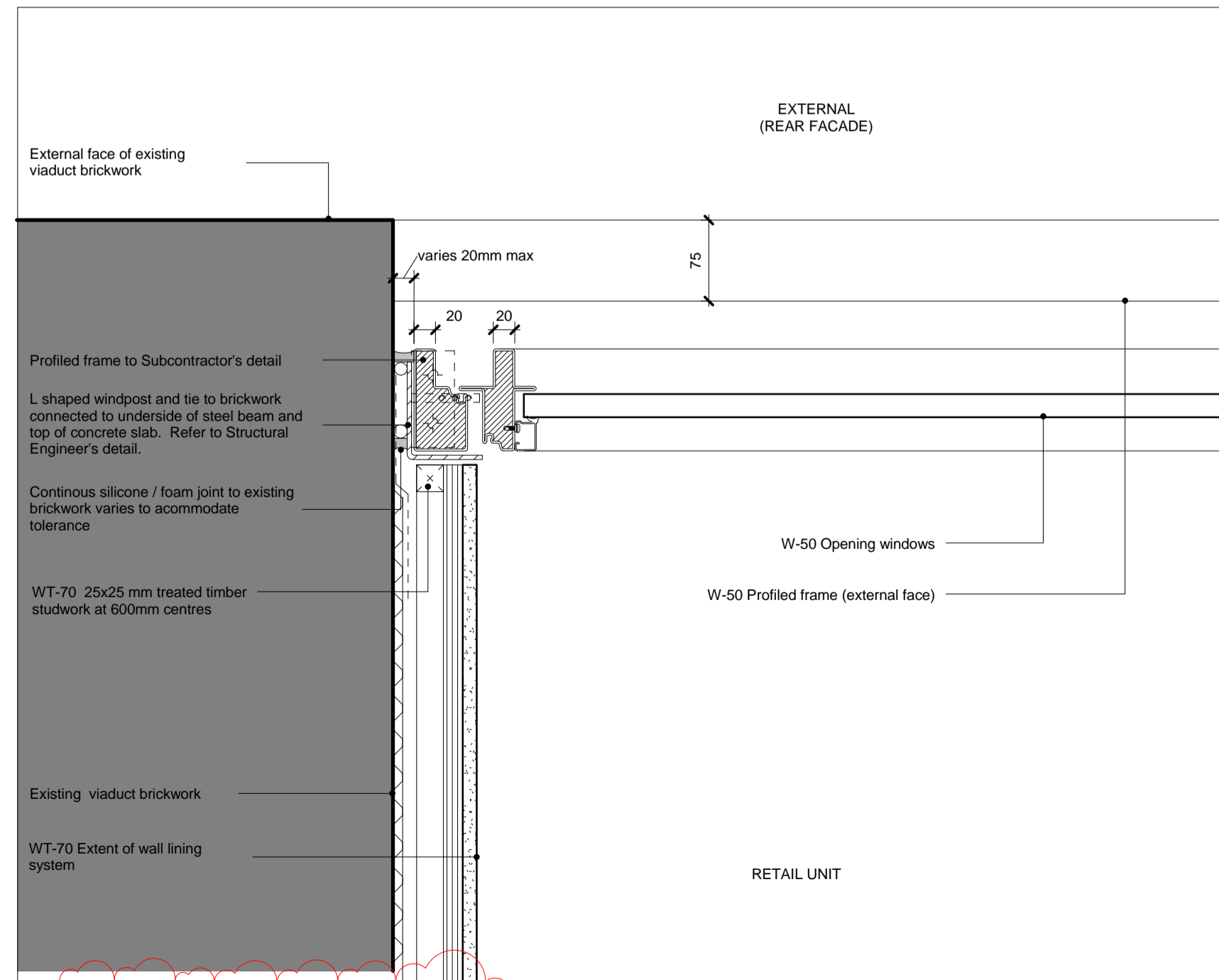

6 Plan Detail - Opening window in Rear Facade

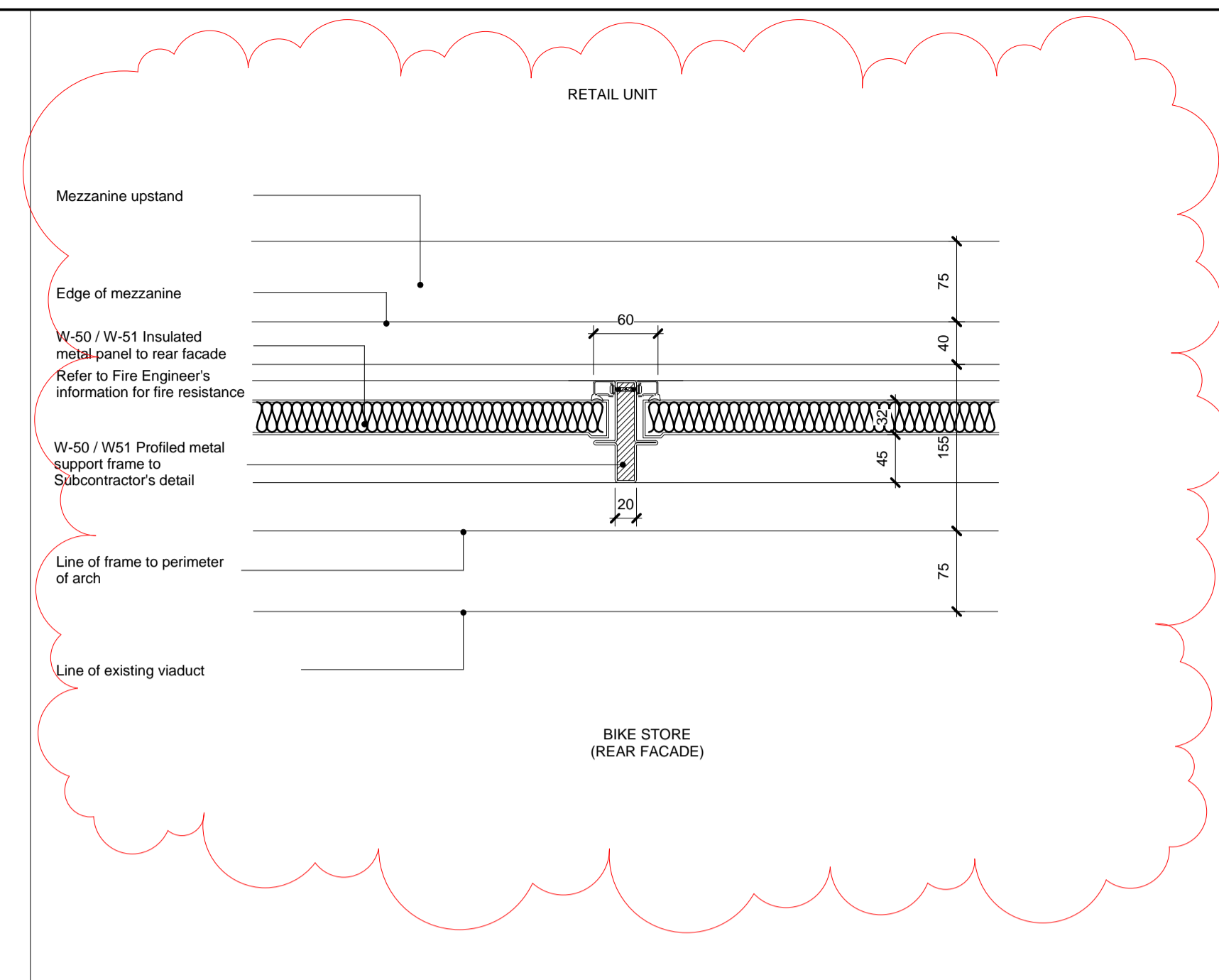

7 Plan Detail - Fixed solid panel facade to rear of arches E1 & S17

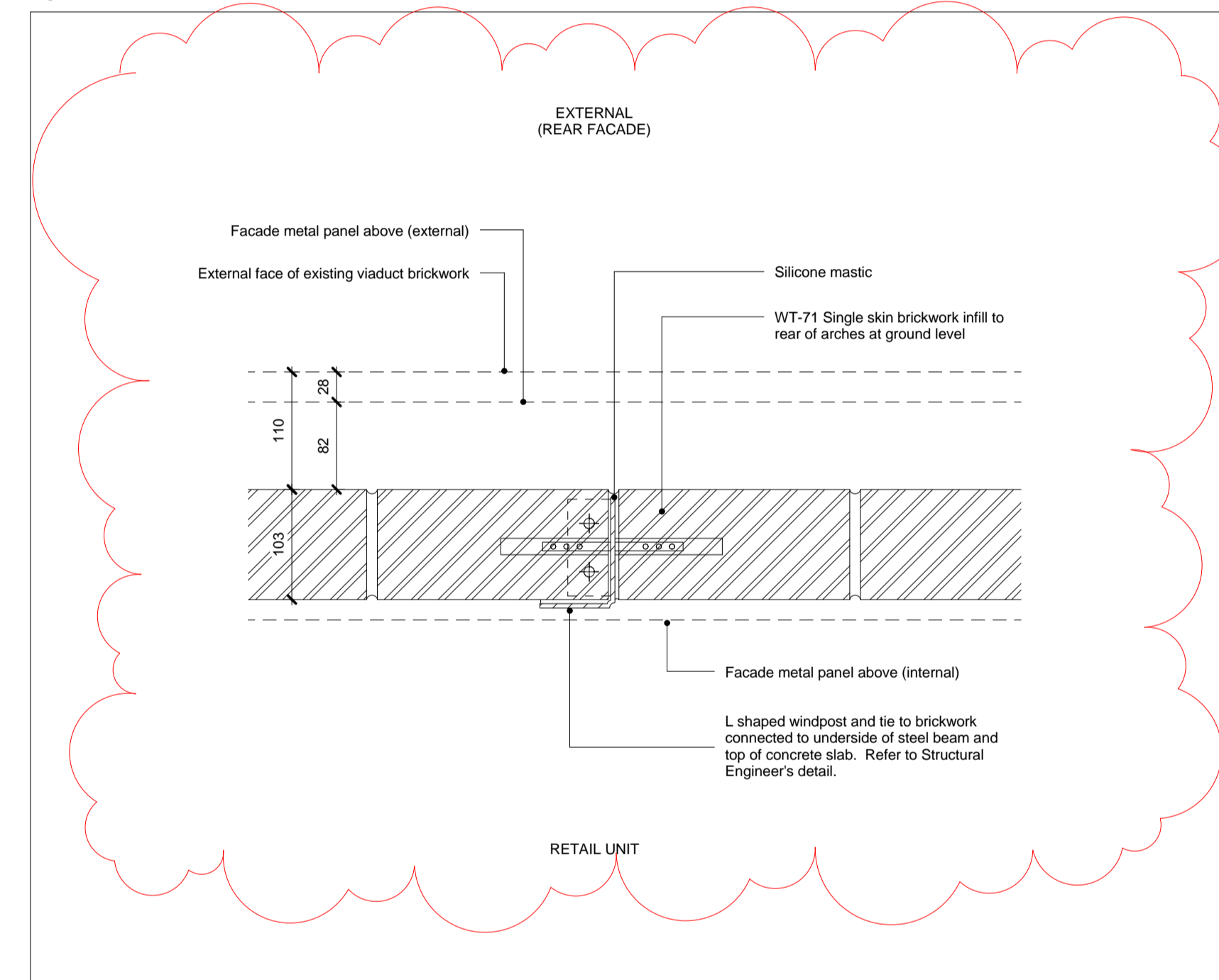

8 Plan Detail to Brick Wall Intermediate Windpost - Ground Level

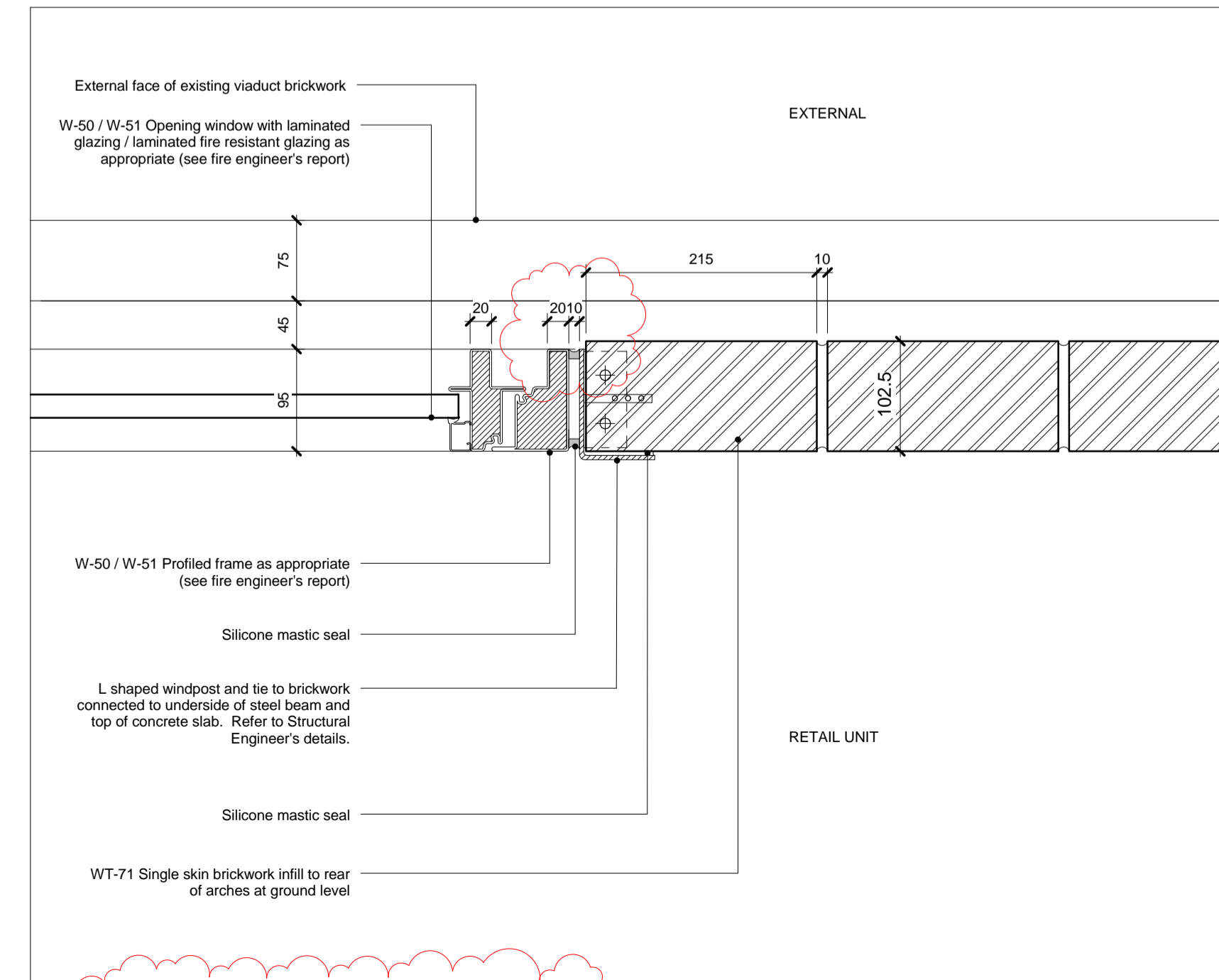

9 Plan Detail of Window in Brick wall - Ground Level

KEY

TECHNICAL REFERENCE SHEET

Refer to Detail Sheets for further information.  
Refer to Fire Engineers' information.  
Refer to Mechanical and Electrical Engineers' information.  
Refer to Hawley School Drawings for further information  
Refer to Landscape Architect's information

NOTES

1. Structural layout to be confirmed by structural engineer
2. Upstand & downstand levels to be confirmed
3. Structural grid to be offset from existing viaduct walls
4. Refer to structural engineer's Movement & Tolerance Report for horizontal & vertical movement tolerances. Tolerances are also subject to condition of existing viaduct brickwork.
5. Slab Edge & Mezzanine Structure to be further coordinated with location of existing walls. Extent of walls are based on the following Survey Drawings prepared by KND Survey LTD B0508\_AR\_GF (6 Dec 2006) E111 A G (6 June 2011)
6. Dimensions to be confirmed on site by contractor
7. All viaducts to be surveyed, repaired and cleaned out by the main Contractor and Network Rail prior to construction

Revision F03 Notes

1. Annotations & dimensions added to details
2. Detail title updated

REV	DATE	DESCRIPTION
F03	08/12/16	For Coordination
F02	24/06/16	For Coordination
F01	15/06/16	For Coordination

CONSULTANTS	
CLIENT:	Stanley Sidings
CONTRACTOR:	Mace Group
STRUCTURAL ENGINEER:	Walsh Group
MECHANICAL ENGINEER:	AECOM
COST CONSULTANT:	Gardiner & Theobald
PROJECT MANAGER:	Gardiner & Theobald
ACOUSTIC CONSULTANT:	Arup
TRANSPORT CONSULTANT:	Arup
PLANNING CONSULTANT:	Gerald Eve
LANDSCAPE ARCHITECT:	Fabrik
CDM CO-ORDINATOR:	Gardiner & Theobald

NOTE

1. Do not scale from this drawing.
2. All dimensions to be checked on site by the contractor and such dimensions to be his responsibility. Report all drawing errors, omissions and discrepancies to the architect.
3. This document may be issued in an uncontrolled CAD format to enable others to use it as background information to make alterations and/or additions. In that instance the file will be accompanied by a PDF version. It is for those making such alterations and additions to ensure that they make use of current background information.
4. AHMM Ltd accepts no liability for any such alterations or additions to the background information or arising out of changes to background information which occur prior to alterations of additions being made.

REFER TO TECHNICAL REFERENCE SHEET FOR SPECIFICATION CLAUSES  
DOCUMENT REFERENCE: 14045\_V\_TRS

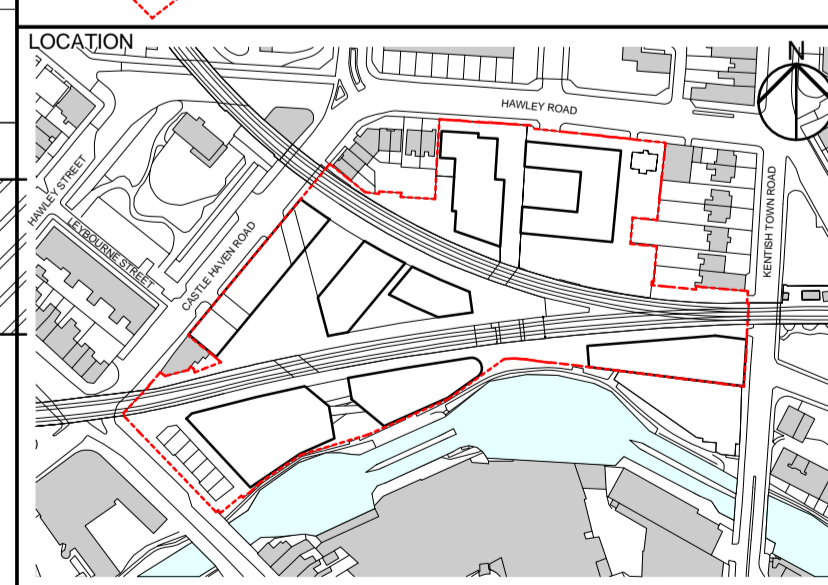
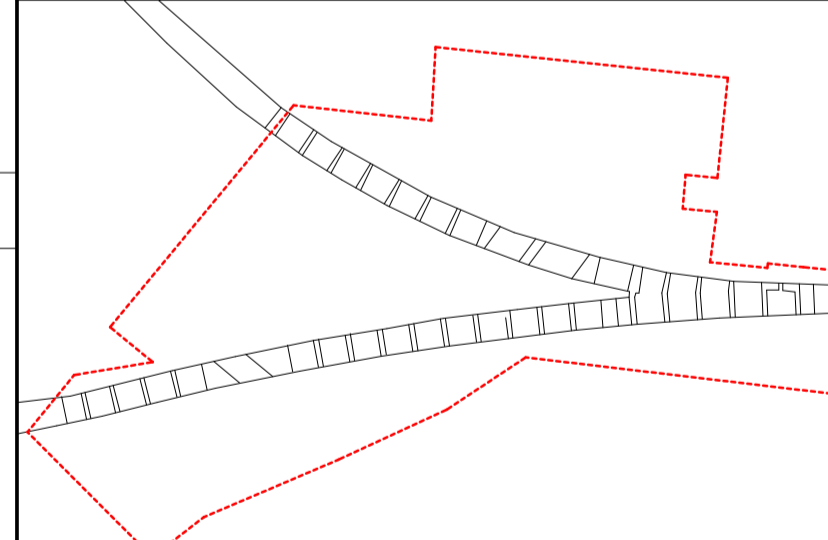

**ALLFORD HALL MONAGHAN MORRIS**  
ARCHITECTS Ltd  
8-23 OLD STREET, LONDON, EC1V 9HL  
TEL 020 7251 5261 FAX 020 7251 5123 WEB WWW.AHMM.CO.UK

job title  
**Camden Lock Village**  
drawing title / location  
**Viaduct Typical Details - Sheet 1**

drawn by	checked	scale	status
KT	AH	1 : 5 @ A1	For Construction

project	drawing no.	revision
14045	VX_(31)_ 1010	F03