

JOINERY DETAIL SHEET

5 Pairs of Sashes to Cord Hung Sash Window

<i>Customer</i> Krueger	<i>Job No</i> D31209	<i>Item No</i> 1	<i>Sheet</i> 1 of 3
-----------------------------------	--------------------------------	----------------------------	-------------------------------

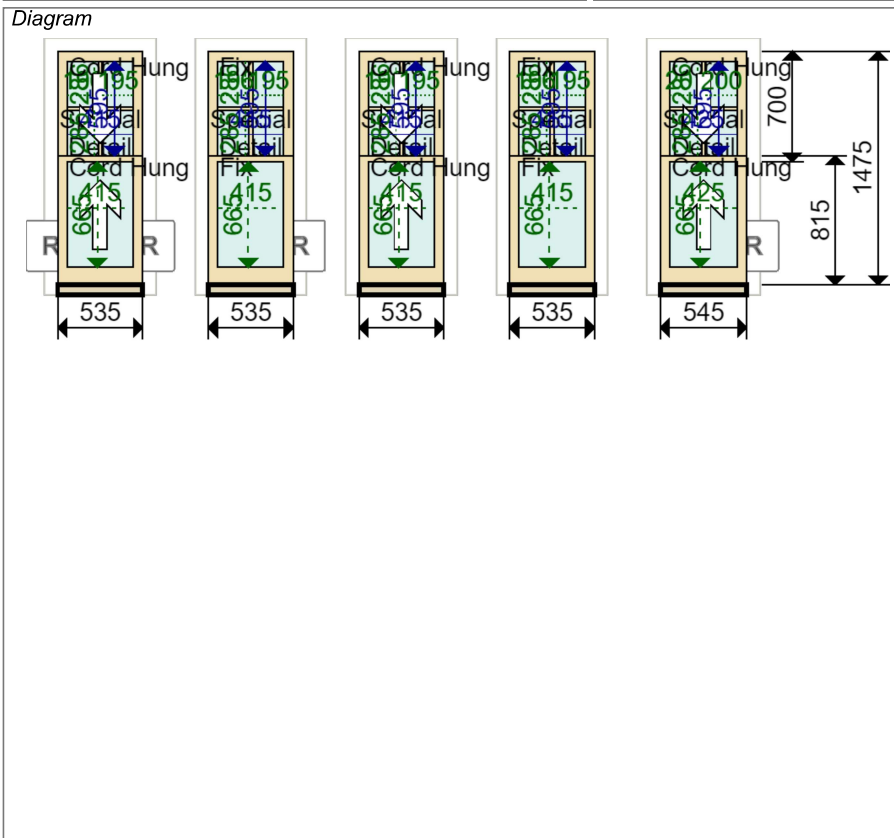

Sectional Details

Sash Head	65 mm
Sash Stile	60 mm
Sash Btm Rail	110 mm Square
Sash Midrail	40 mm
Sash Thickness	43 mm
Top Sash Horn	Template Attached
Btm Sash Horn	No horn

Location
Second Floor Front Kids Bedrooms

<i>Material</i> Accoya	<i>Quantity</i> 5 Pairs
----------------------------------	-----------------------------------

Glazing Bar	24 mm with 4 mm Nib
Profile	Ovolo
Moulding Cutter	8 x 10 with 5 mm shoulder
Glazing Rebate	15 x 26 mm

- Ironmongery*
- 3 x Fitch Catch SC
 - 3 x Lock Chubb Window Key
 - 16 x Pulley Wheel SS
 - 12 x Rola Lock Back Plate Fastener
 - 6 x Rola Lock SC
 - 6 x Sash Lift SC

Glazing

	Internal Pane	Spacer	External Pane
Top	4mm Planitherm Toughened	8mm	4mm Low Iron
Btm	4mm Planitherm Toughened	8mm	4mm Low Iron

Putty Line Bead White Tape, White Spacer Argon Filled

Paint Finish

Internal	Standard White
External	Standard White

Production Notes

- *ARCHED MEETING RAIL TO EXTERNAL TOP SASH - SEE SHEET 2.
- *MEETING RAIL MADE 40/95mm.
- *DEEPER CORD GROOVES ON RHS SASH (545 WIDTH) MADE WITH 65mm STILES.

17.9 lb, 20.8 lb, 17.9 lb, 20.8 lb, 18.2 lb, 21.2 lb (101 52 26ch lead)

Installation Notes

Installed: Internally

1. OUT OF SQ HORIZ 10mm, VERTICAL 5-10mm. FURTHEST RHS SASH IS ALSO OUT BY 15mm VERTICAL.
2. 4 X SPLICE REPAIRS PULLEY STILES.
3. PARTITION WALL IN BETWEEN 3RD AND 4TH PAIR. STAFF BEAD SUNK INTO PLASTER. CUSTOMER ADVISED PLASTER MAY BE DAMAGED WHEN STAFF BEAD REMOVED.
4. PLEASE NOTE ON RHS SASH FRAME HAS PULLED AWAY SLIGHTLY. FIT LARGE STAFF BEAD TO THIS ITEM AS EXISTING SASHES HAVE A LOT OF PLAY Laterally.

Job Tracking

Order received: 04-04-2017	Print date: 11-04-2017
Sold by: David Farebrother	Last modified by: Chris Jewiss
Surveyed by: Chris Jewiss	Last modified date: 11-04-2017

Internal Access: **Brace Bar & Harness**

KRUEGER

Job no 31209

Sheet 2 of 3

Drawn by: C JEWISS
scale: 1:10 at A3
Issue No: 01
Date: APRIL 2017

Material: See Sheet 1

Finish - Int: See Sheet 1
Ext: See Sheet 1

Glass - SEE SHEET 1

Notes:

The Sash Window Workshop
4 Kiln Lane, Bracknell,
Berks RG12 1NA
tel: +44 (0)1344 868668
fax: +44 (0)1344 868858
email: jewiss@sashwindow.com

ELEVATIONS NEW SASHES

INTERNAL VIEW

EXTERNAL VIEW

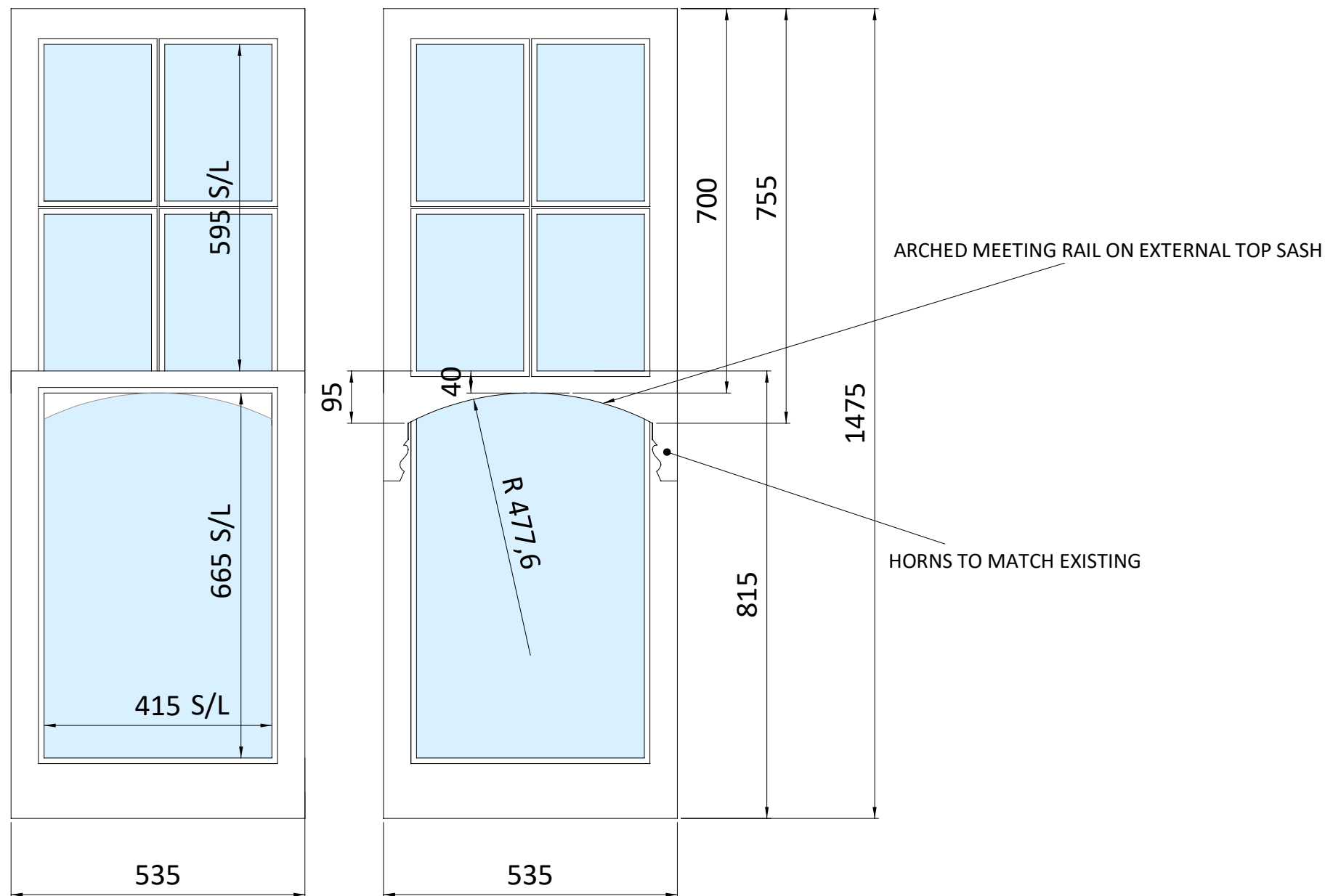

X 5 PAIRS OF SASHES

ITEM 1

SOME STILES, HEADS AND BOTTOM RAILS WILL BE MANUFACTURED OVER SIZE TO ALLOW FOR TRIMMING FOR OUT OF SQUARE FRAMES. THE DIMENSIONS ON THESE DRAWINGS SHOW THE FINISHED SIZES ONCE FITTED.

**SECTION THROUGH HEAD, MEETING RAIL AND BOTTOM RAIL
SCALE 1:1**

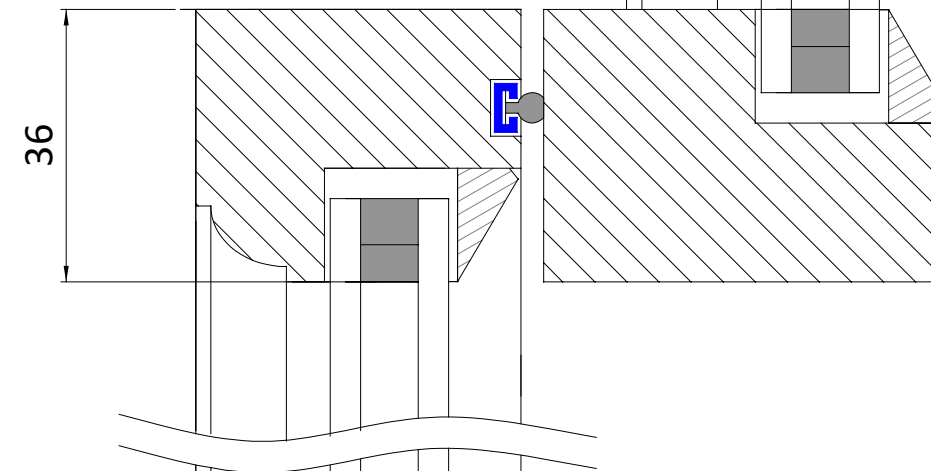
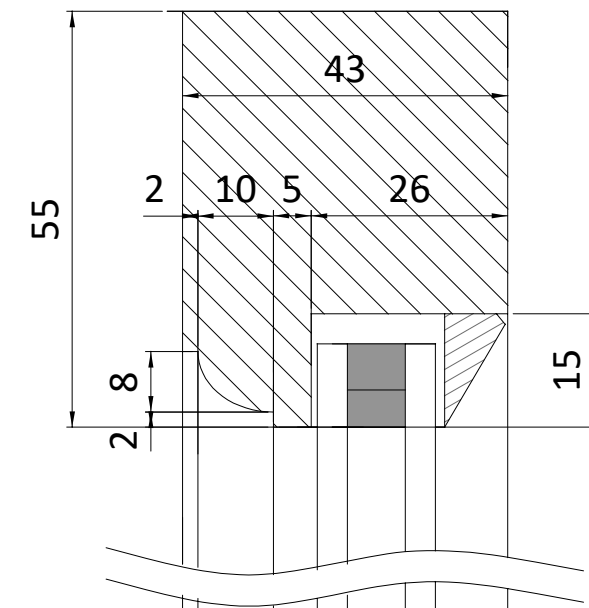

**HORIZONTAL SECTION THROUGH STILE AND GLAZING BAR
SCALE 1:1**

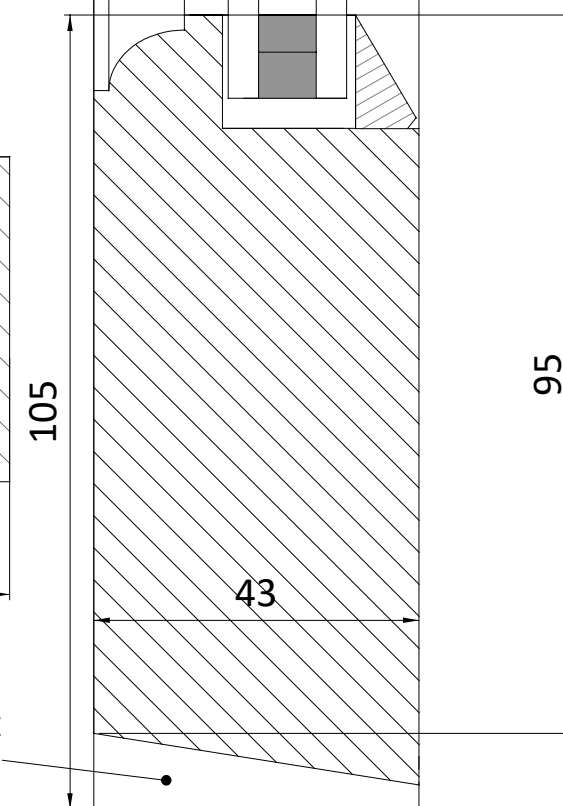
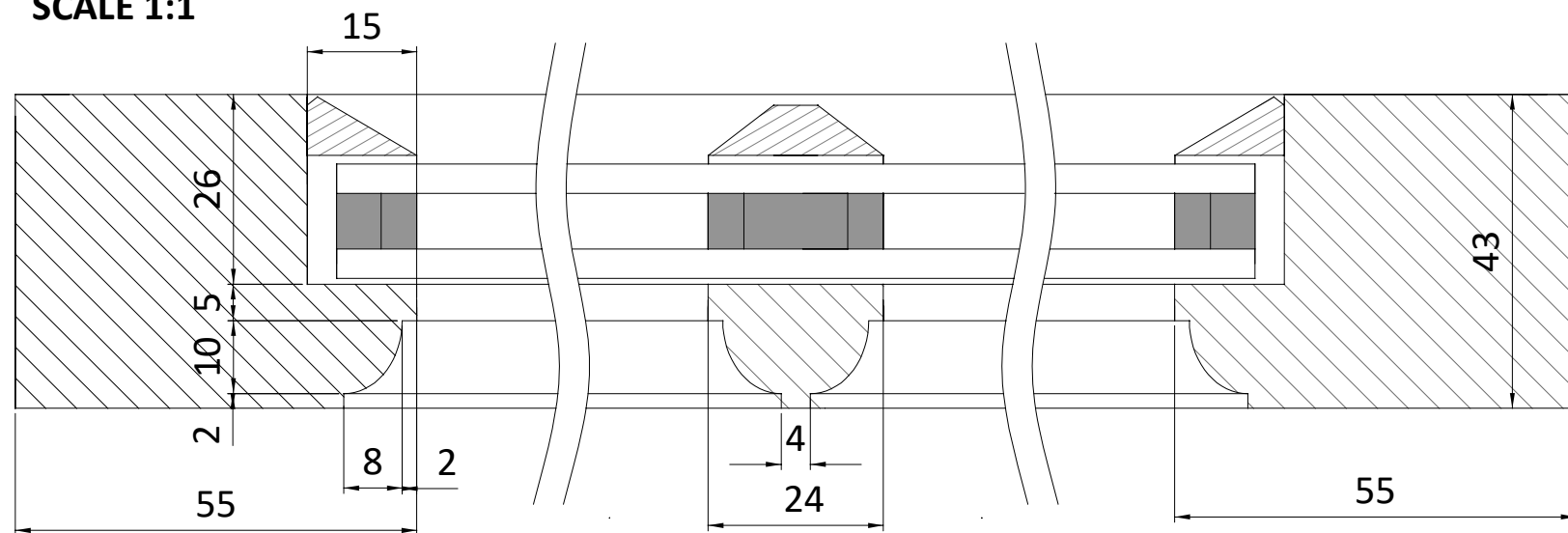

CHAMFERED ON SITE TO SUIT CILL

KRUEGER

Job no 31209

Sheet 3 of 3

Drawn by: C JEWISS
scale: 1:1 at A3
Issue No: 01
Date: APRIL 2017

Material: See Sheet 1

Finish - Int: See Sheet 1
Ext: See Sheet 1

Glass - SEE SHEET 1

Notes:

The Sash Window Workshop
4 Kiln Lane, Bracknell,
Berks RG12 1NA
tel: +44 (0)1344 868668
fax: +44 (0)1344 868858
email: jewiss@sashwindow.com

SECTIONAL DETAILS FOR
NEW SASHES
43mm THICK

ITEM 1