

GRAY'S INN SQUARE  
NO. 6 SECOND FLOOR  
TREASURERS FLAT

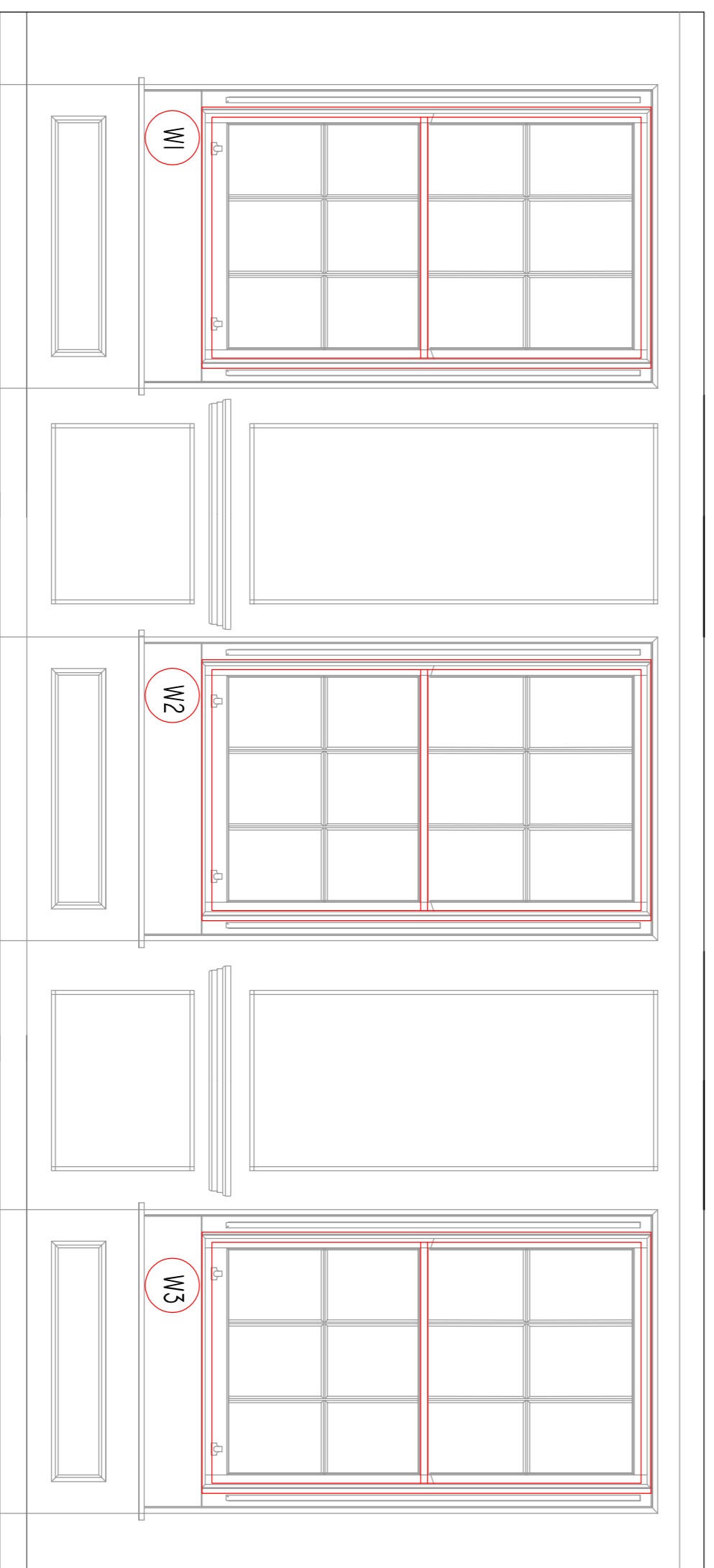

WALKS SIDE ELEVATION

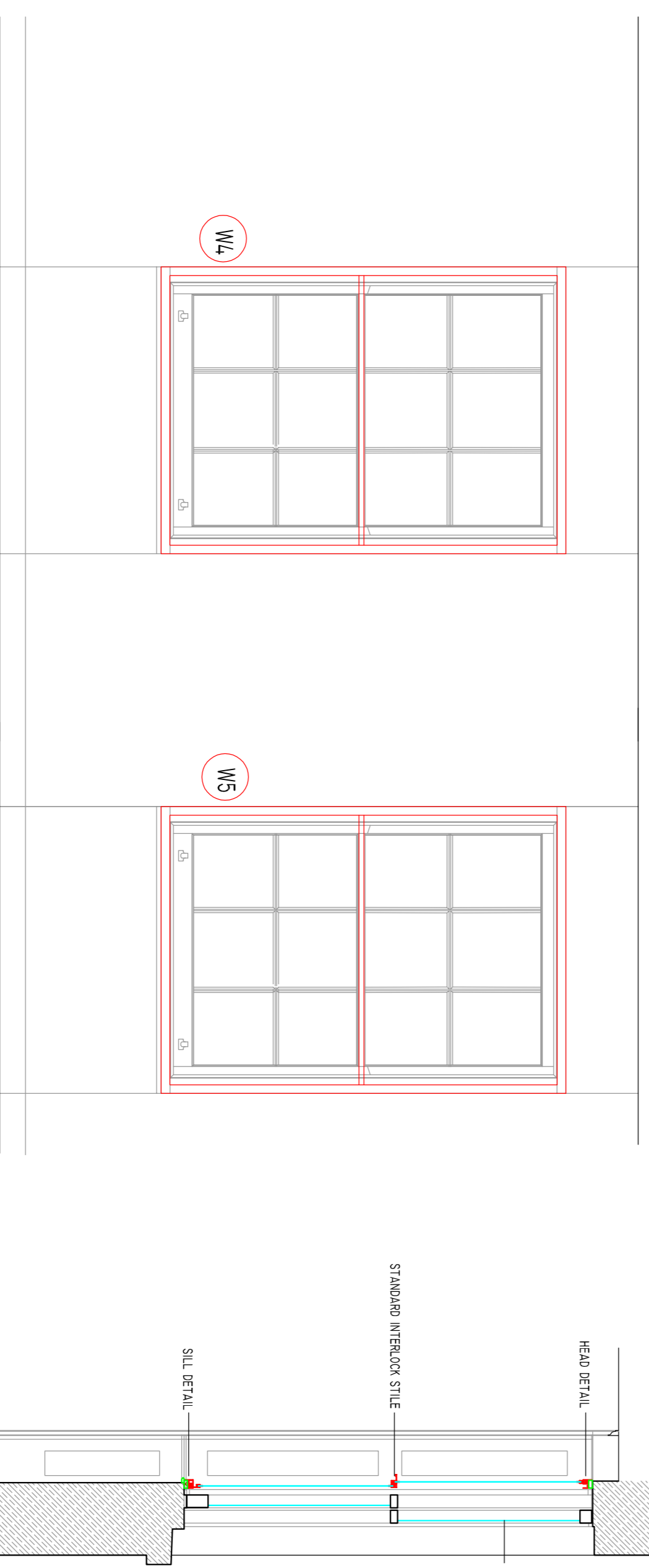

SQUARE SIDE ELEVATION

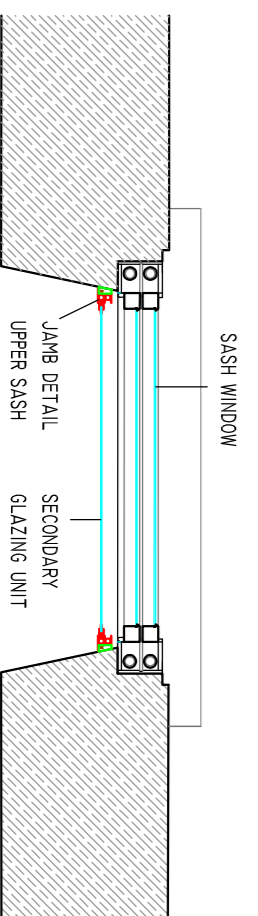

SWEPT REVEAL DETAIL

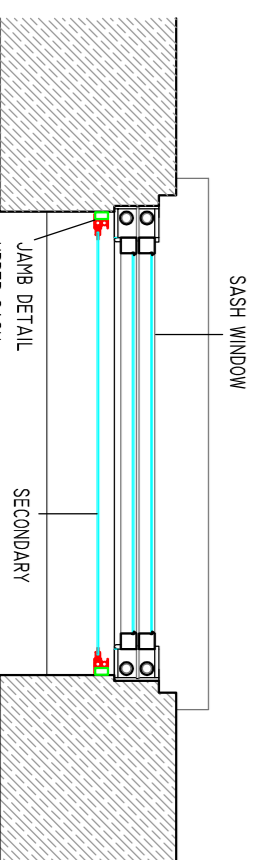

SQUARE REVEAL DETAIL

SECONDARY GLAZING UNITS TO BE SUPPLIED AND FITTED BY SELECTAGLAZE - SERIES 20 SASHLINE UNITS FINISHED IN WHITE

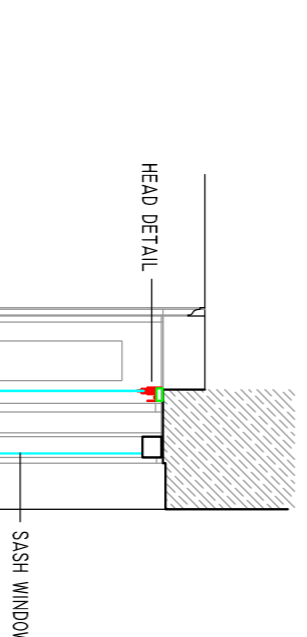

**Notes**  
Do not scale this drawing, use figured dimensions only.  
Mark Snook Planning accepts no responsibility for any errors made by others in scaling from this drawing.  
Copyright © Mark Snook Planning 2017.  
This drawing is Copyright and must not be reproduced, lent, or otherwise disclosed to any third party without the written consent of the owners of the Copyright.

**Mark Snook Planning**  
*Town Planning Consultants.*



The Pike House,  
Kingshill Road,  
Dursley, Glos.  
GL11 4BU  
Telephone:  
01453 549536  
E-Mail:  
marksnookplanning@hotmail.com

**Title:-** Secondary glazing works to Second Floor Flat (West), No. 6 Gray's Inn Square

**Client:-** The Honourable Society of Gray's Inn

**Drawing:-** Proposed floor plan and large scale joinery details + Location plan

**Date:-** 07/04/2017  
**Scale:-** 1:20, 1:50 @ A1  
**Drawn:-** M.H



The Honourable  
Society of Gray's Inn  
8 South Square,  
London,  
WC1R 5ET  
Telephone:  
020 7458 7800

Revision	INN/1064/6/SIS/PL/04/17/001/1A	File No. 1064
----------	--------------------------------	---------------

A	Final Issue	07/04/2017
---	-------------	------------