

**Notes**

All dimensions to be verified on site. Do not scale this drawing. All discrepancies to be clarified with project Architect.

This drawing is the property of Benoy Architects and is issued on the condition it is not reproduced, retained or disclosed to any unauthorised person, either wholly or in part without written consent of Benoy Ltd.

Ordnance Survey material is used with the permission of The Controller of HMSO, Crown copyright AR 159670.

The CDM hazard management procedures for the Benoy aspects of the design of this project are to be found on the "Benoy - Designer's Hazard Identification and Management Sheet" and/or drawings. The full project design team's comprehensive set of hazard management procedures are available from the Planning Supervisor/Safety Coordinator appointed for the project.

- NOTE:**
- ALL MECHANICAL AND ELECTRICAL SERVICES TO BE STRIPPED OUT
  - CARPET FINISHES TO BE STRIPPED OUT
  - WALL TILES AT BATHROOM AND WC TO BE STRIPPED OUT
  - ALL WALL LINENS TO BE STRIPPED OUT
  - WINDOW SECURITY GRILLES TO BE REMOVED

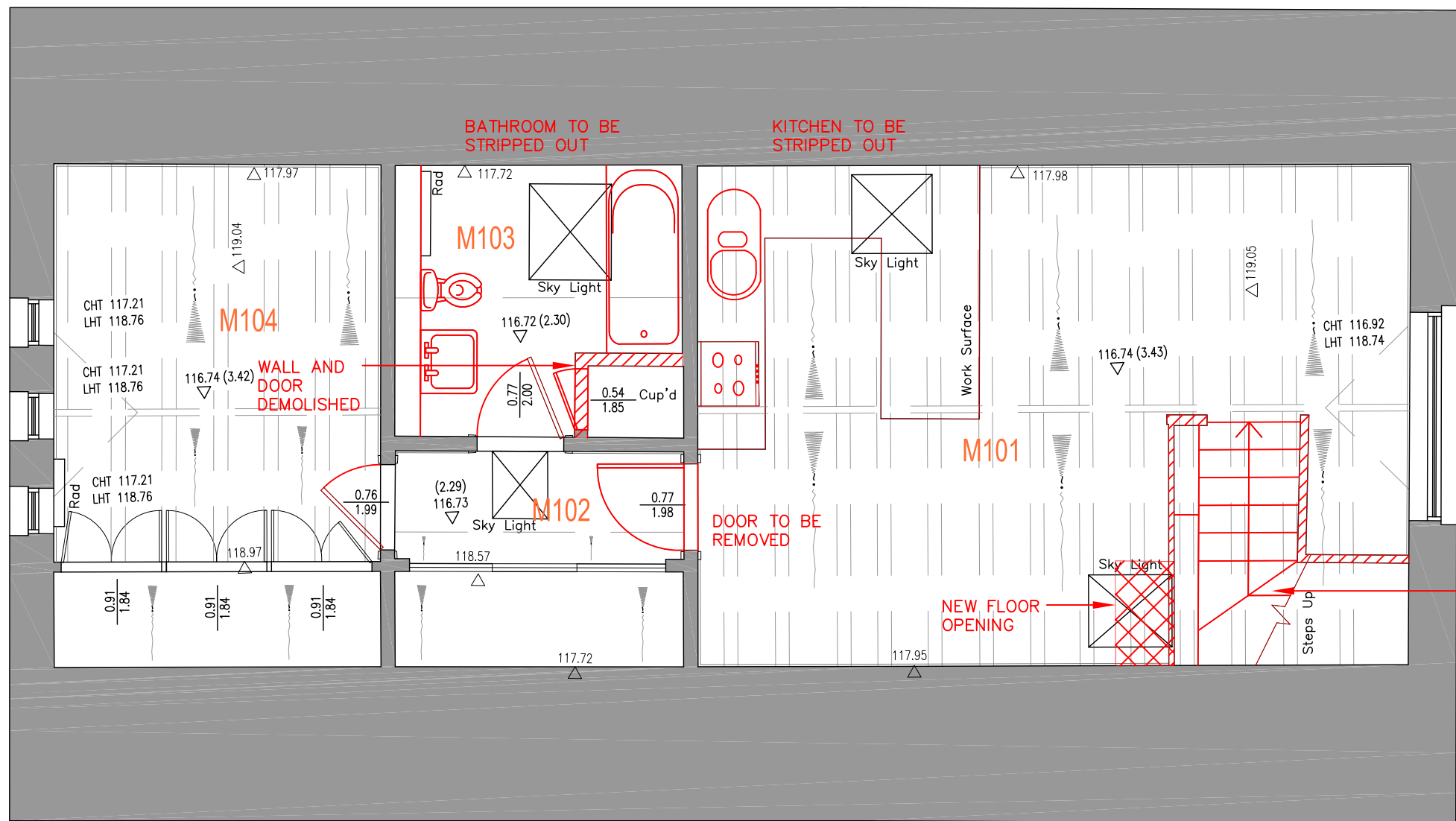

Rev	Date	Description	By	Chk'd
B00	13/04/17	Issued for Planning	OG	RP
A02	10/02/17	Stage 3 issue	PL	RP
A01	10/01/17	Drawing Update	OG	RP
A00	01/12/16	First issue	OG	RP

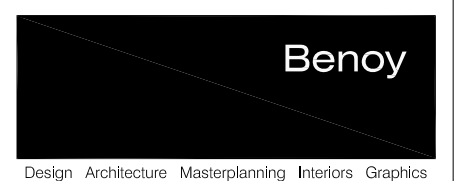

Client  
**EMBASSY OF THE PEOPLE'S REPUBLIC OF CHINA**

Project  
**CHINESE EMBASSY CULTURAL OFFICE REFURBISHMENT / EXTENSION**

Drawing Title  
**DEMOLITION FLOOR PLAN MUSE BUILDING FIRST FLOOR LEVEL**

Drawn By: OG | Checked By: RP

Scale: 1:50@A3 | Date: NOV 2016

Project No.: 5927 | Drawing No.: BNY-MU-05-1001 | Revision: B00

Status: **PLANNING**

+44 (0) 207 404 7666 | www.benoy.com  
+44 (0) 207 404 7980  
a london@benoy.com

