

Section A

Section B

Existing hanging sign
bracket removed as
beyond repair

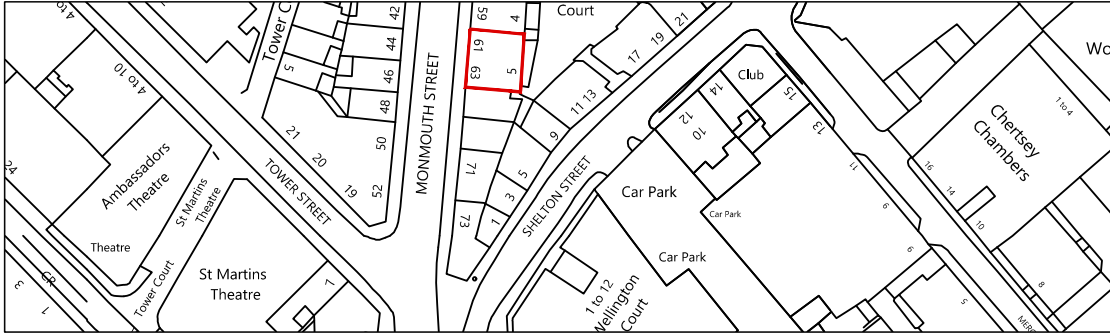

| NOTES: | | | |
|--|------|---------------|------------|
| LOCATION PLAN @ 1:1250 SCALE & NORTH UP^. | | | |
| ALL SCALES/DIMENSIONS TO BE CHECKED ON SITE. | | | |
| REV | D.B. | DESCRIPTION | DATE |
| / | RJS | Initial Issue | 26/04/2017 |
| | | | |
| | | | |
| | | | |
| | | | |

Fresson&Tee
CHARTERED SURVEYORS

1 Sandwich Street
London WC1H 9PF
020 7391 7100
www.fandt.com

| | |
|---------------|-------------------------------|
| PROJECT NAME | Hanging Signage Application |
| DRAWING TITLE | Existing Elevation + Sections |

| | |
|---------|---------------------------------------|
| CLIENT | Shaftesbury Covent Garden Ltd. |
| ADDRESS | 61-63 Monmouth Street, London, WC2 |

| | |
|-------------|-----------|
| JOB NO. | 20321 |
| DRAWING NO. | E011 |
| SCALE | 1:100@A3 |
| DATE | Apr. 2017 |

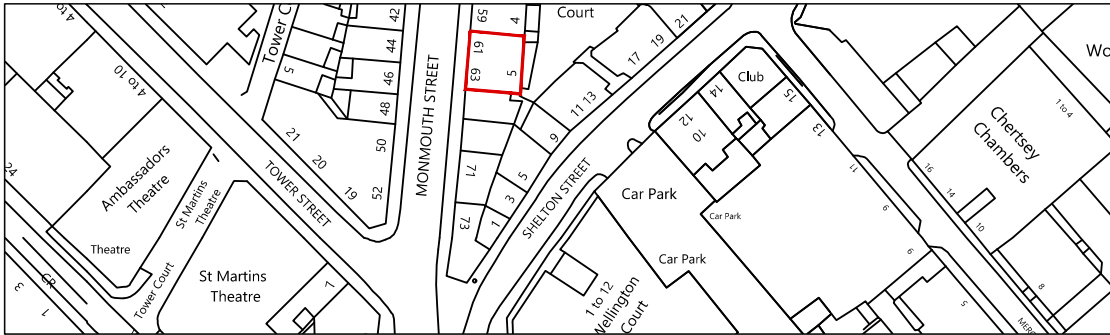
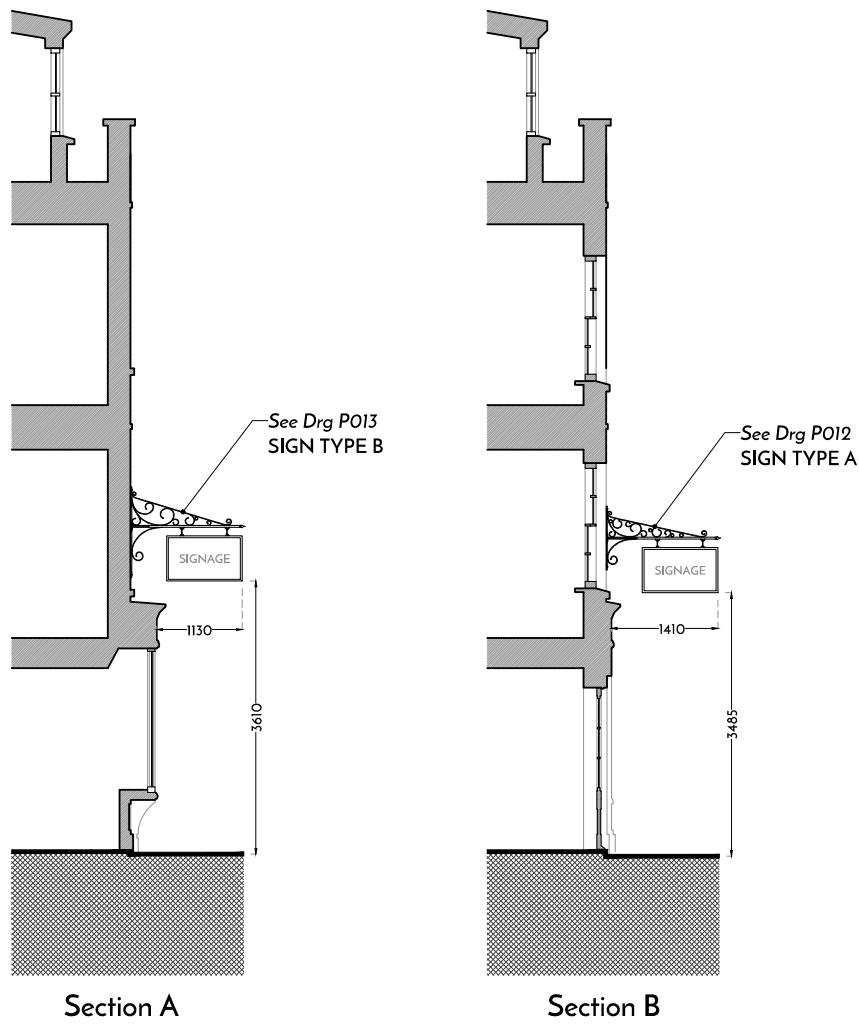

| NOTES: LOCATION PLAN @ 1:1250 SCALE & NORTH UP^. ALL SCALES/DIMENSIONS TO BE CHECKED ON SITE. | | | |
|--|------|---------------|------------|
| REV | D.B. | DESCRIPTION | DATE |
| / | RJS | Initial Issue | 26/04/2017 |
| | | | |
| | | | |
| | | | |

| | | | |
|---|---------------------------------------|--------------------------------|-------------|
| Fresson & Tee CHARTERED SURVEYORS 1 Sandwich Street London WC1H 9PF 020 7391 7100 www.fandt.com | PROJECT NAME | CLIENT | JOB NO. |
| | Hanging Signage Application | Shaftesbury Covent Garden Ltd. | 20321 |
| | DRAWING TITLE | ADDRESS | DRAWING NO. |
| Proposed Elevation + Sections | 61-63 Monmouth Street, London, WC2 | | P011 |
| | | | SCALE |
| | | | 1:100@A3 |
| | | | DATE |
| | | | Apr. 2017 |

Sign Type A

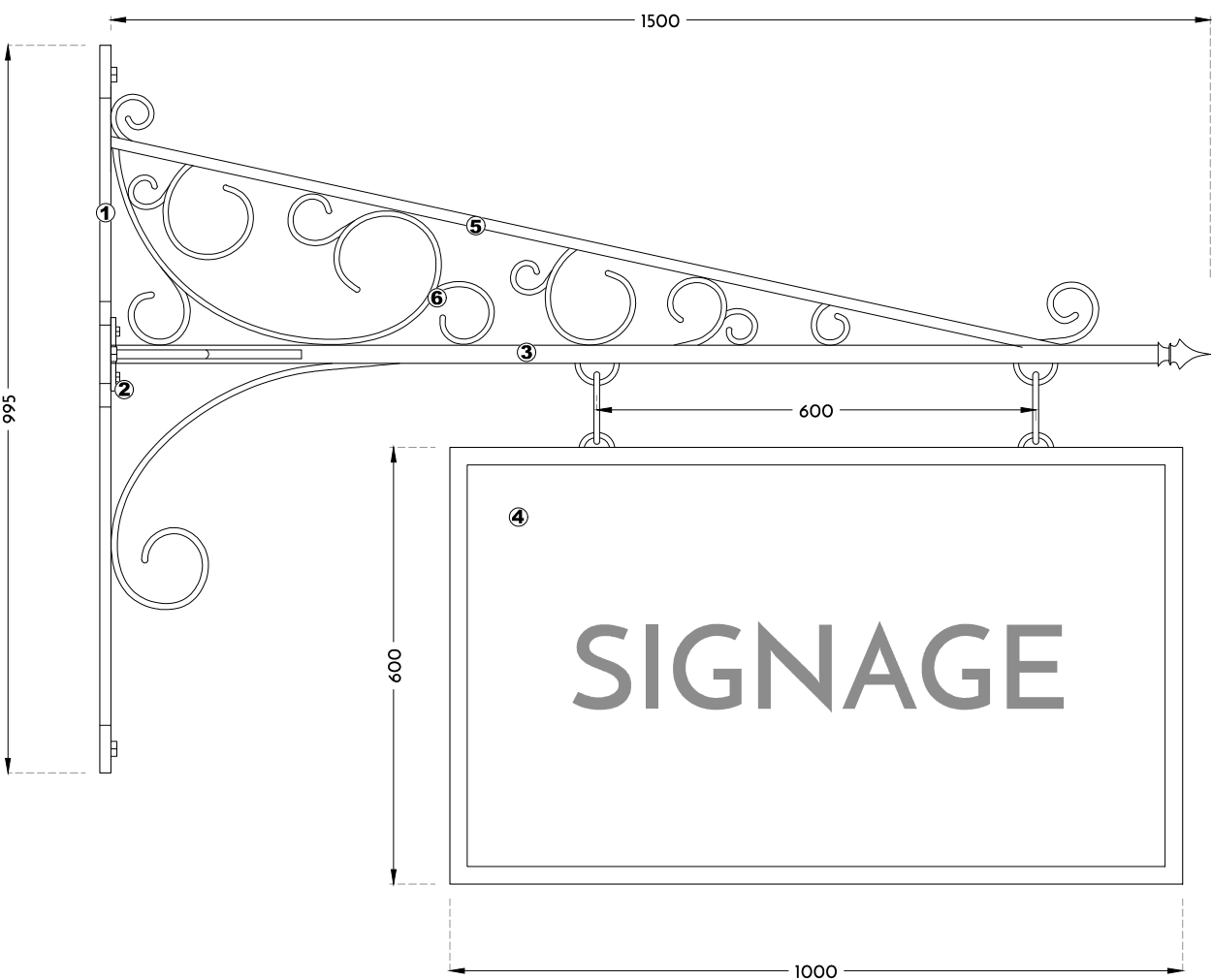
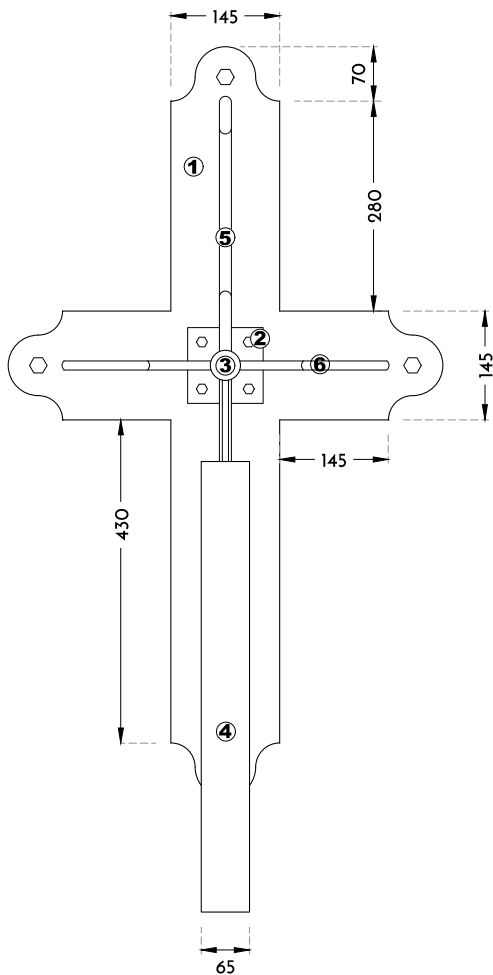

- 1 Wrought iron fixing bracket approx 15thk, painted matt black. Drilled for bolting to existing brickwork wall with 4no. RAWL bolts with heads painted matt black. Drilled to receive bolts connecting fixing plate.
- 2 Wrought iron fixing plate 100x100 7thk welded to steel barrel and drilled for bolting to fixing bracket. Matt black paint finish to plate and bolt heads.
- 3 25mm steel barrel welded to wrought iron fixing plate at one end, cast iron finial welded to other end. Matt black paint finish. Steel loops welded to underside at 600 spacing for chain/cable connection to sign board.
- 4 25mm block board with 2mm steel lip to give finished overall size of 1000x600mm. Decorated by incoming tenants. Steel loops/hooks fixed to top edge at 600 space for chain/cable connection to steel barrel.
- 5 Wrought iron 15x15mm profile welded between steel barrel and brackets.
- 6 Wrought iron 15x8mm profile scrollwork, shaped as shown and welded in place.

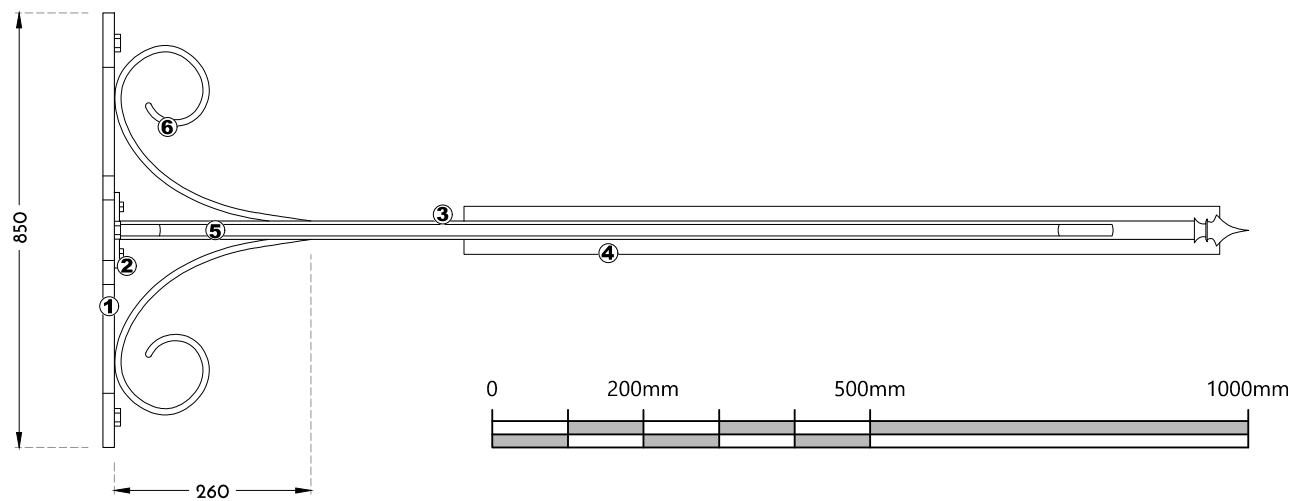

| NOTES: | | | |
|--|------|---------------|------------|
| LOCATION PLAN @ 1:1250 SCALE & NORTH UP^. | | | |
| ALL SCALES/DIMENSIONS TO BE CHECKED ON SITE. | | | |
| REV | D.B. | DESCRIPTION | DATE |
| / | RJS | Initial Issue | 26/04/2017 |
| | | | |
| | | | |
| | | | |
| | | | |

Fresson&Tee

CHARTERED SURVEYORS

1 Sandwich Street

London WC1H 9PF

020 7391 7100

www.fandt.com

| | |
|---------------|-----------------------------|
| PROJECT NAME | Hanging Signage Application |
| DRAWING TITLE | SIGN TYPE A DETAILS |

| | |
|---------|---------------------------------------|
| CLIENT | Shaftesbury Covent Garden Ltd. |
| ADDRESS | 61-63 Monmouth Street, London, WC2 |

| | |
|-------------|-----------|
| JOB NO. | 20321 |
| DRAWING NO. | P012 |
| SCALE | 1:10@A3 |
| DATE | Apr. 2017 |

Sign Type B

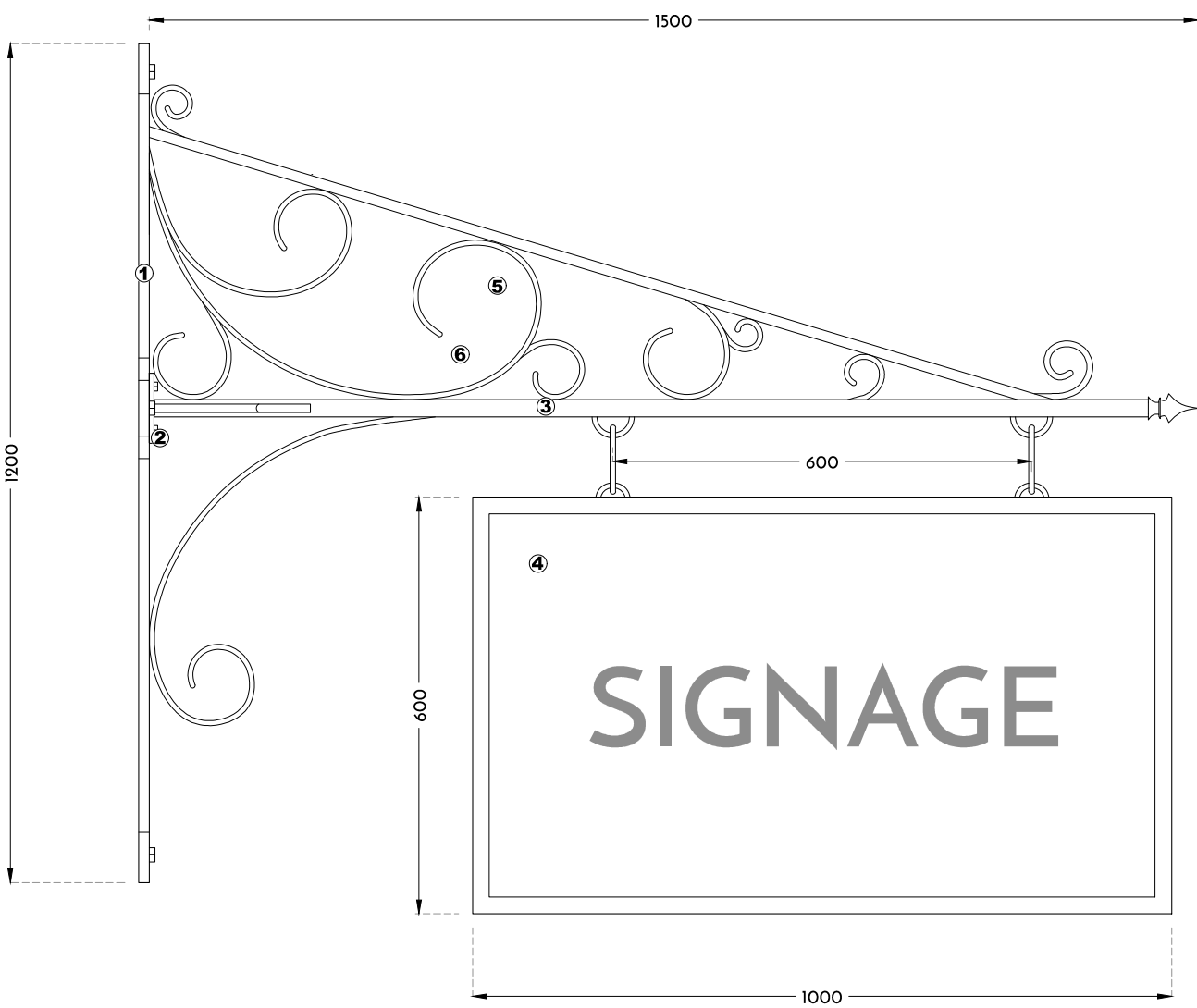
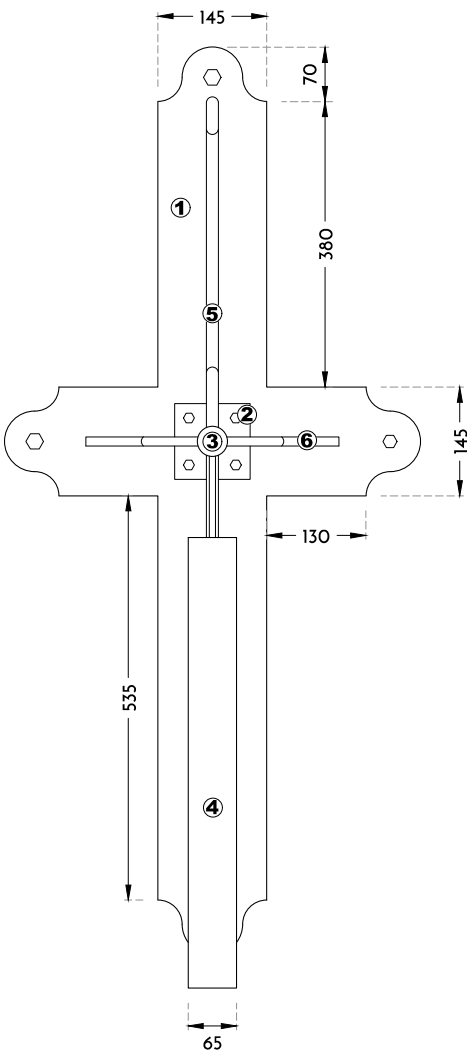

- 1 Wrought iron fixing bracket approx 15thk, painted matt black. Drilled for bolting to existing brickwork wall with 4no. RAWL bolts with heads painted matt black. Drilled to receive bolts connecting fixing plate.
- 2 Wrought iron fixing plate 100x100 7thk welded to steel barrel and drilled for bolting to fixing bracket. Matt black paint finish to plate and bolt heads.
- 3 25mm steel barrel welded to wrought iron fixing plate at one end, cast iron finial welded to other end. Matt black paint finish. Steel loops welded to underside at 600 spacing for chain/cable connection to sign board.
- 4 25mm block board with 2mm steel lip to give finished overall size of 1000x600mm. Decorated by incoming tenants. Steel loops/hooks fixed to top edge at 600 space for chain/cable connection to steel barrel.
- 5 Wrought iron 15x15mm profile welded between steel barrel and brackets.
- 6 Wrought iron 15x8mm profile scrollwork, shaped as shown and welded in place.

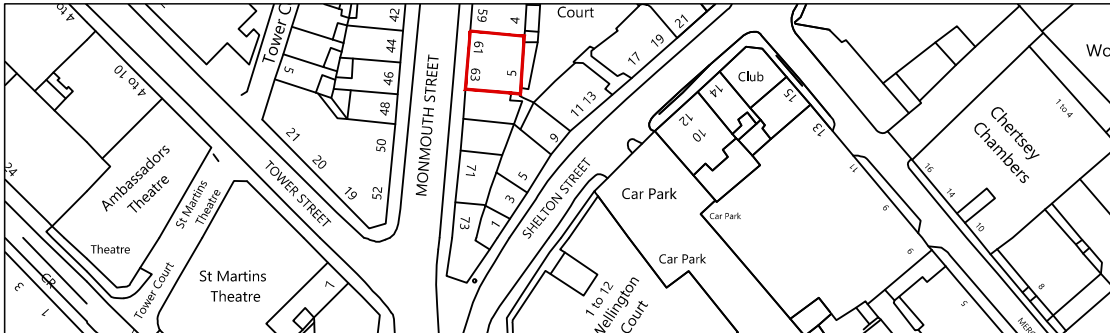
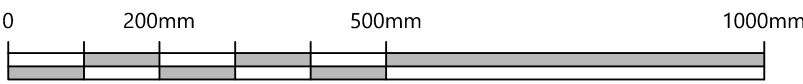
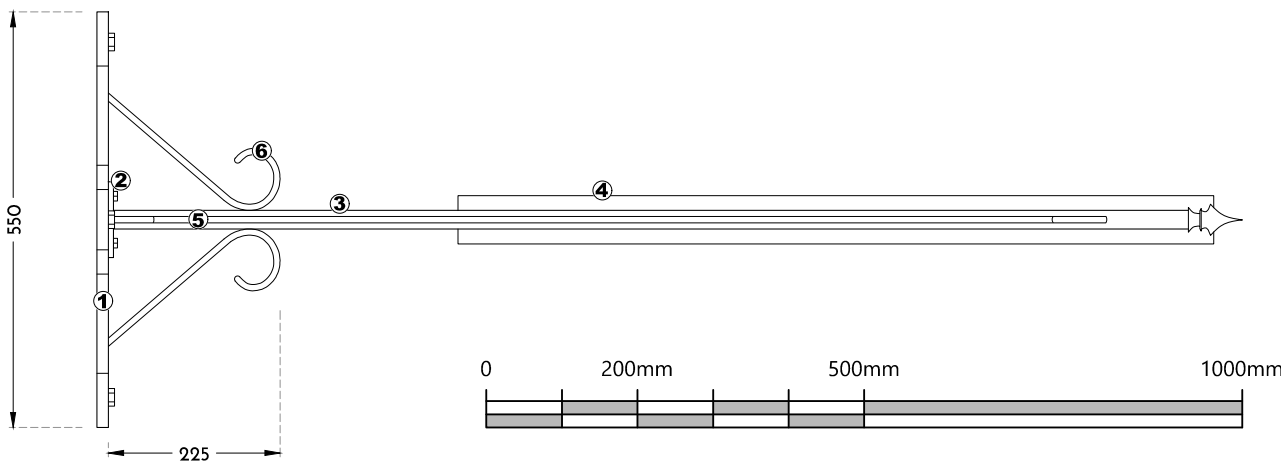

| NOTES: | | | |
|--|------|---------------|------------|
| LOCATION PLAN @ 1:1250 SCALE & NORTH UP^. | | | |
| ALL SCALES/DIMENSIONS TO BE CHECKED ON SITE. | | | |
| REV | D.B. | DESCRIPTION | DATE |
| / | RJS | Initial Issue | 26/04/2017 |
| | | | |
| | | | |
| | | | |
| | | | |

Fresson&Tee
CHARTERED SURVEYORS

1 Sandwich Street
London WC1H 9PF
020 7391 7100
www.fandt.com

| | | |
|-----------------------------|---------------------------------------|-------------|
| PROJECT NAME | CLIENT | JOB NO. |
| Hanging Signage Application | Shaftesbury Covent Garden Ltd. | 20321 |
| DRAWING TITLE | ADDRESS | DRAWING NO. |
| SIGN TYPE B DETAILS | 61-63 Monmouth Street, London, WC2 | P013 |
| | | SCALE |
| | | 1:10@A3 |
| | | DATE |
| | | Apr. 2017 |