

- Notes**
- Carefully demolish existing two storey rear extension.
 - Carefully re-open original opening between ensuite and hall
 - Carefully remove existing non-original joinery and sanitaryware to ensuite
 - Carefully remove existing timber decking
 - Carefully remove existing walk on roof light glass
 - Carefully remove non-original Planter
 - Carefully remove non-original plaster soffit around rooflight
 - Carefully remove six external lights wall mounted to rear garden walls
 - New access hatch to roof
 - Remove existing lighting to front light well
 - Remove existing redundant black and grey UPVC rainwater and soil vent pipes on rear elevation

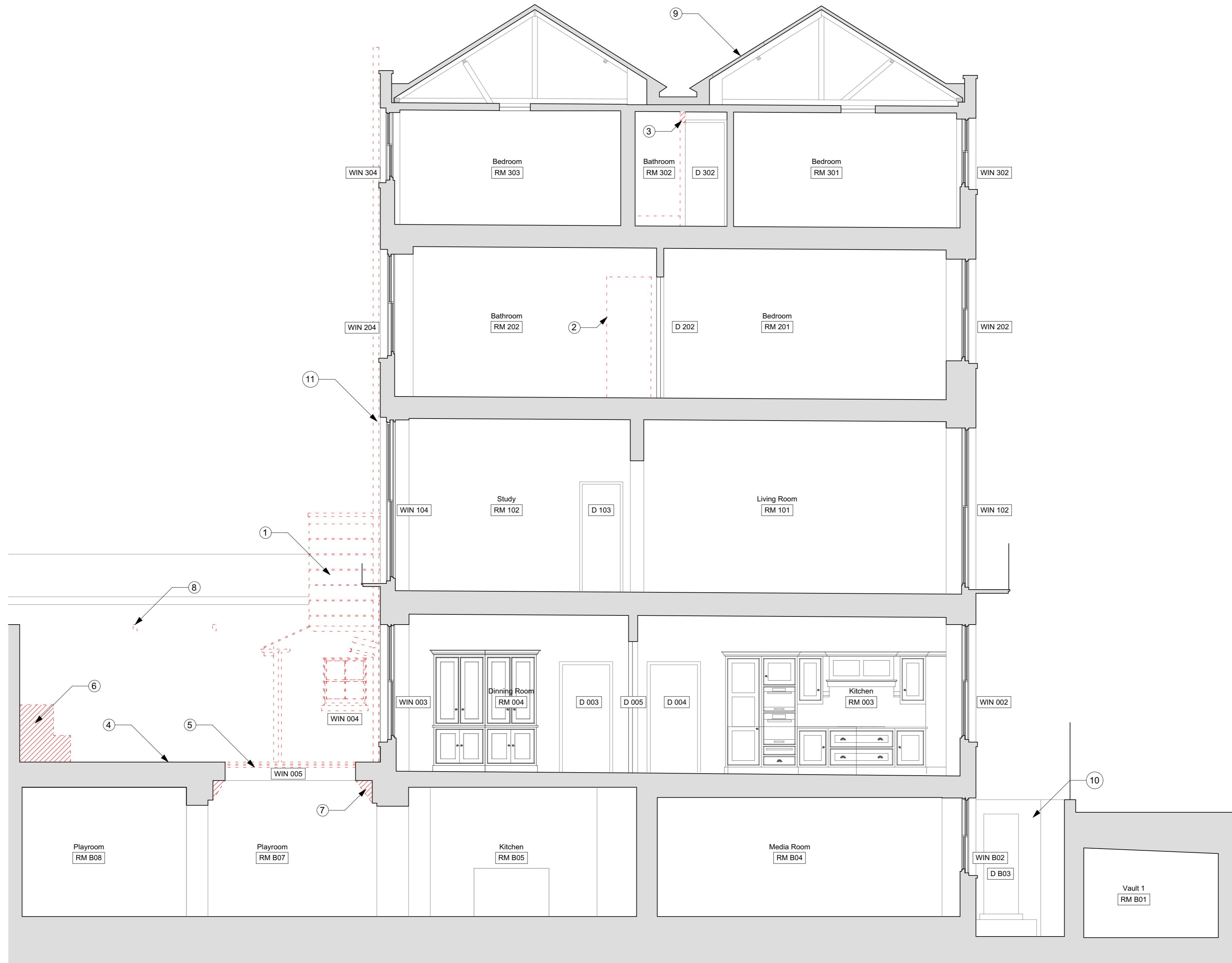

Notes
Use figured dimensions only. Do not scale from this drawing. Issued for purpose indicated only. All dimensions to be checked on site. Architect to be notified of any discrepancies before construction commences. Structural and services information is indicative only - refer to consultants' drawings and specification for details and setting out. All work and materials to be in accordance with current applicable statutory legislation and to comply with all relevant codes of practice and British and European standards. Information contained within this drawing is the sole copyright of IF_DO (IF Design Office Ltd) and not to be reproduced without expressed wishes.

Revisions

-	Issued for ---	---/---/---
A	Issued for planning	04/05/17

Consultants

Key Plan

IF_DO
IF_DO Architecture & Design
Unit 7F, Vanguard Court, Peckham Road, London, SE5 8QT
+44 (0)203 6345 6789
info@ifdo.co
www.ifdo.co

Project
17 John Street

Client
Michael + Juliette Graham

Drawing Title
Section Demolition Plan

Scale 1:50 @ A1 / 1:100 @ A3 **Drawn** WG

Date February 2017 **Check** SC

Issued for	Proj. No.	Dwg. No.	Rev
Planning	1601	DM-05	A

1 Section - Demolition
Scale 1:50 @ A1 / 1:100 @ A3

