

Notes:
 Do not scale from this drawing **except for Planning purposes.**
 Work from figured dimensions only.
 All dimensions to be checked on site prior to commencement of work.
 For Gross Internal Areas refer to separate Schedule of Areas

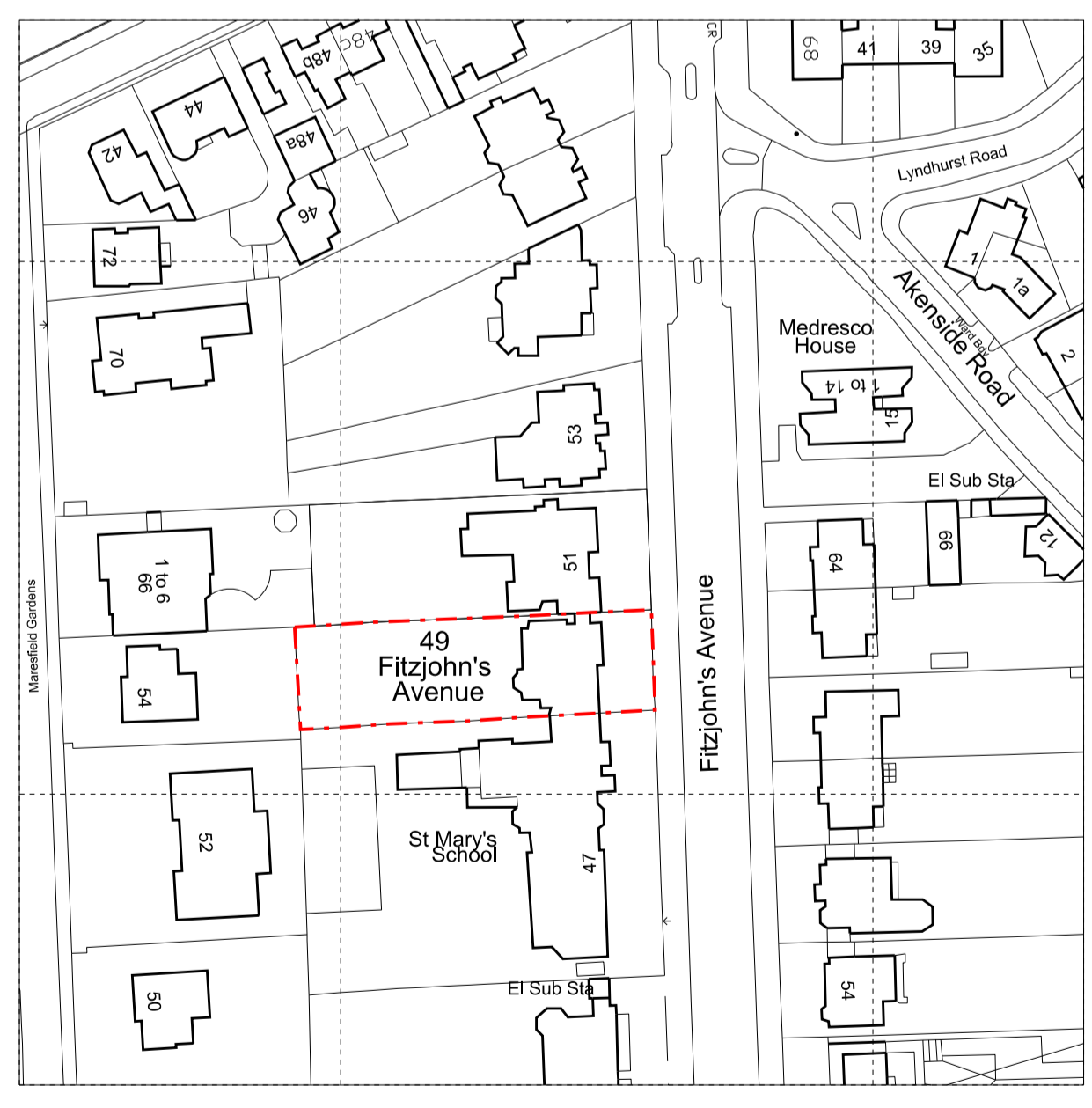
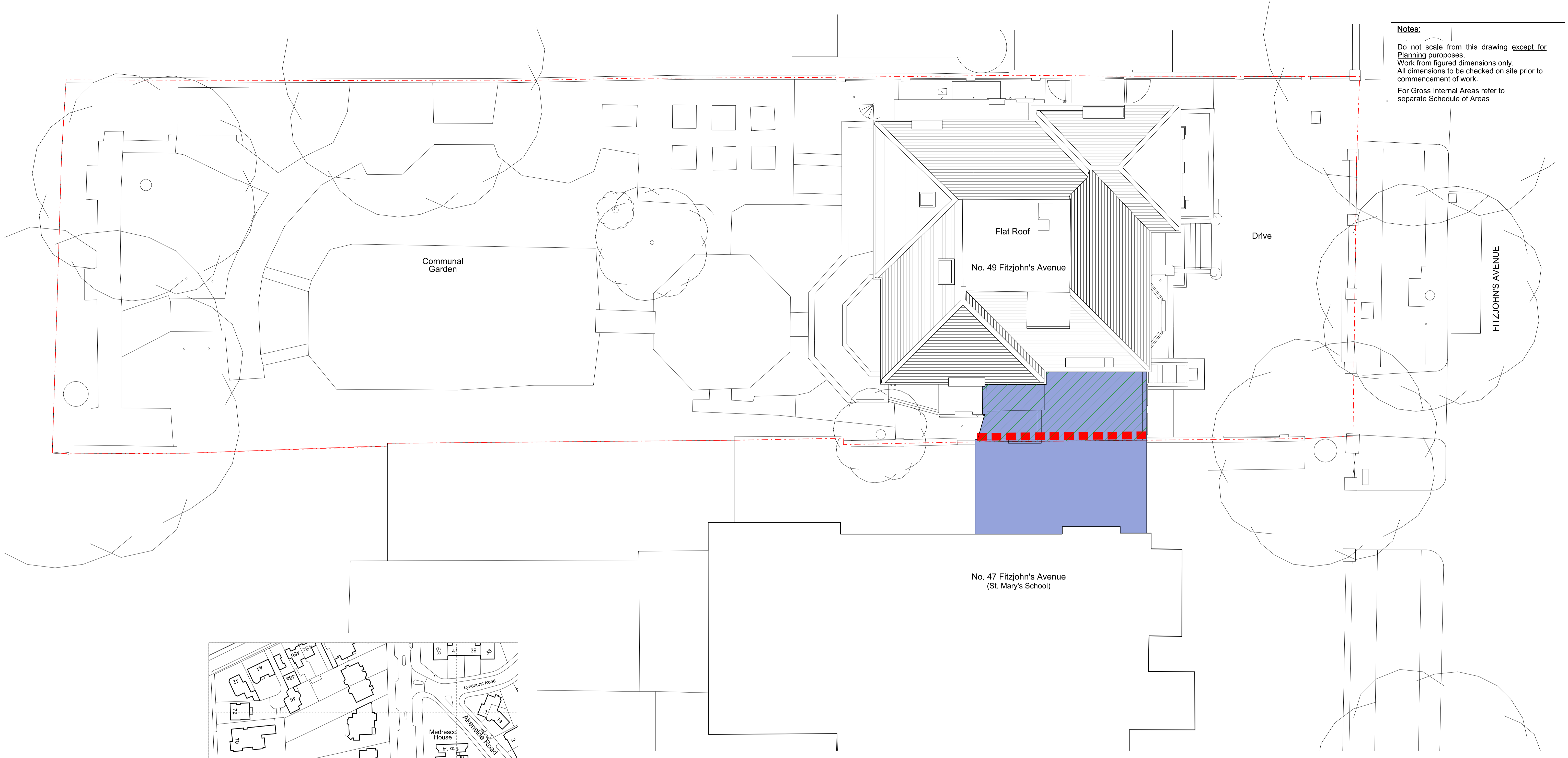

Site Location Plan
 Scale 1:1250

Existing Site/Roof Plan

- KEY:**
- Extent of the existing single storey (flat roof) link between 47 and 49 Fitzjohn's Avenue.
 - Area of the link within 49 Fitzjohn's Avenue to be demolished under Planning Approval 2015/5379/P dated 1st August 2016.
 - Line of the facing of the Party Wall in brickwork to match the existing selected from the demolished part of the link

Project:
 47-49 Fitzjohn's Avenue
 London NW3 6PH

Title: Site/Roof Plan Showing Link
 Between 47 & 49 & Site Location Plan

Scale: 1:100 & 1:1250 @ A1

Date: April 2017

Oakley Hough.

The Barn, Stebbing Farm
 Fishers Green, Stevenage,
 Hertfordshire SG1 2JB

Tel: 01438 745288
 Mobile: 07710 549 270
 e-mail: john@oakleyhough.co.uk

Drawing Number:
 892/AJ/01

