

0100mm200mm500mm

PLANNING

GENERAL NOTES

A.

Do not scale from this drawing. Check all dimensions and conditions on site. As Existing drawings are based on survey information supplied/produced by the client.

B.

All works to be carried out in accordance with current health and safety including CDM regulations. All works to comply with current British standards and regulations, codes of practice, Building regulations, and appropriate European standards.

C.

All structural work is to be carried out in accordance with the structural engineers details and calculations.

D.

Precise positions of all fixtures and fittings is subject to confirmation on site.

E.

Allow for the protection of all finishes and fittings that are to be retained.

F.

All drawings are to be read in conjunction with the scope of works and relevant specifications.

G.

All drainage shown is indicative - refer to M&E drawings for details.

H.

All works to be carried out strictly in accordance with relevant manufacturers instructions

NB:

- Refer to drawings 16009 PL109/110/111/112/113/114 for door locations.

- Refer to drawings 16009 PL425 for architrave profiles

- Refer to jamb details 16009 425 & 426

revdate drawncheckeddescription

modular studio

5a Iliffe Yard

London. SE17 3QA

t: +44 (0)20 7193 1717

e: www.modular-studio.co.uk

client.

GOLDEN HOUSES

66-67 Guilford Street, London WC1N 1DF

Internal Door Details 03

1:10 @ A1 (1:20 @ A3)

job no.

dwg no.

revision

16009 PL 422

/

©2013 do not scale from drawing report discrepancies immediately



01 No. 67, Ground floor, Door



02 No. 67, Stairs generally, Skirting Boards



03 No. 66, Third Floor, Party Wall, Architraves



04 No. 66, Second Floor, Architraves



05 No. 66, Stairs generally, Skirting Boards

GENERAL NOTES

- A. Do not scale from this drawing. Check all dimensions and conditions on site. As Existing drawings are based on survey information supplied/produced by the client.
- B. All works to be carried out in accordance with current health and safety including CDM regulations. All works to comply with current British standards and regulations, codes of practice, Building regulations, and appropriate European standards.
- C. All structural work is to be carried out in accordance with the structural engineers details and calculations.
- D. Precise positions of all fixtures and fittings is subject to confirmation on site.
- E. Allow for the protection of all finishes and fittings that are to be retained.
- F. All drawings are to be read in conjunction with the scope of works and relevant specifications.
- G. All drainage shown is indicative - refer to M&E drawings for details.
- H. All works to be carried out strictly in accordance with relevant manufacturers instructions

NB:

- Refer to drawings 16009 PL 420/421/422/423 for door elevations

- Refer to drawings 16009 PL109/110/111/112/113/114 for door & skirting locations

- Refer to drawings 16009 425 & 426 for jamb details

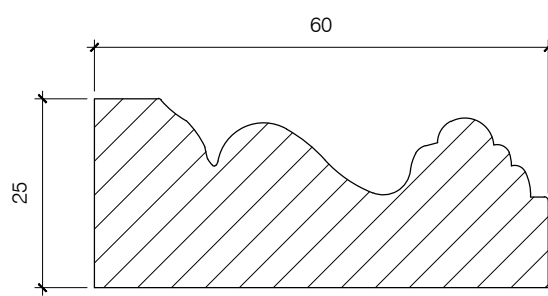

1- ARCHITRAVE TYPE AR01a

Product Spec: Skirting4U new Victorian style MDF architrave
Dimension: 25 x 60mm

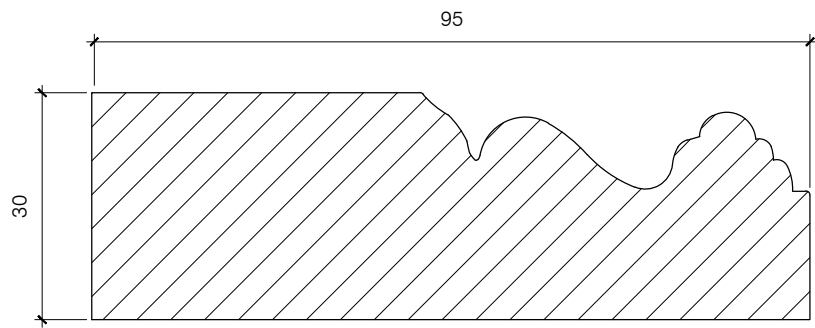

2- ARCHITRAVE TYPE AR01c

Product Spec: Skirting 4U new Victorian style MDF architrave
Dimension: 30 x 95mm

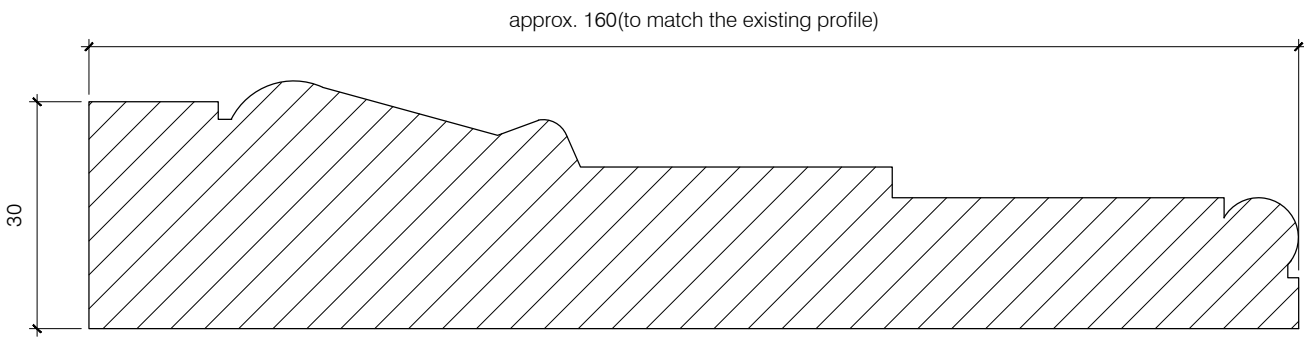

3- ARCHITRAVE TYPE AR02a

Product Spec: New bespoke Victorian style Softwood architrave to match existing profile on door D1.1.20
Dimension: approx. 30 x 160mm(to match the existing profile)

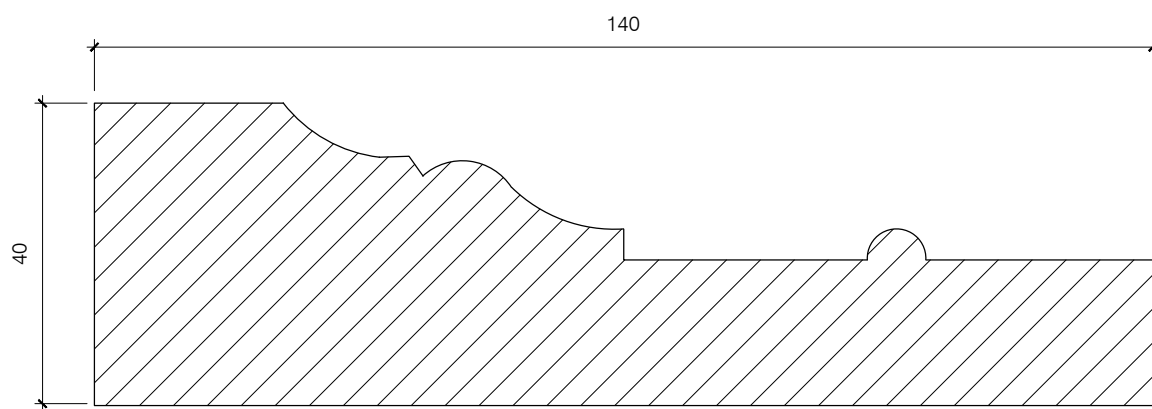

4- ARCHITRAVE TYPE AR02b

Product Spec: New bespoke Victorian style Softwood architrave to match existing profile on door D1.1.01
Dimension: approx. 40 x 140mm (to match the existing profile)

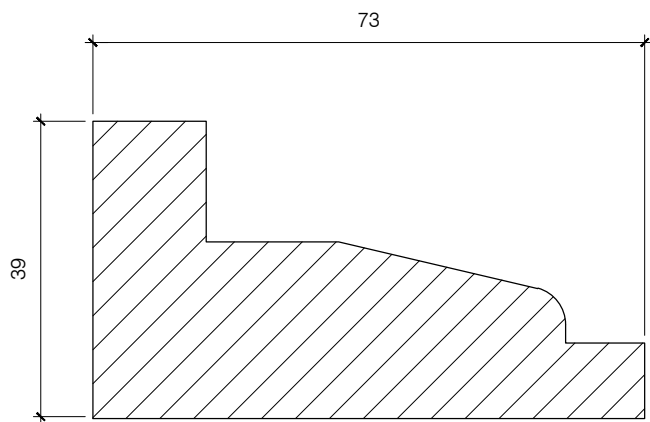

5- ARCHITRAVE TYPE AR02c

Product Spec: New bespoke Victorian style Softwood architrave to match existing inner profile on door D.1.01
Dimension: approx. 39 x 73mm (to match the existing profile)

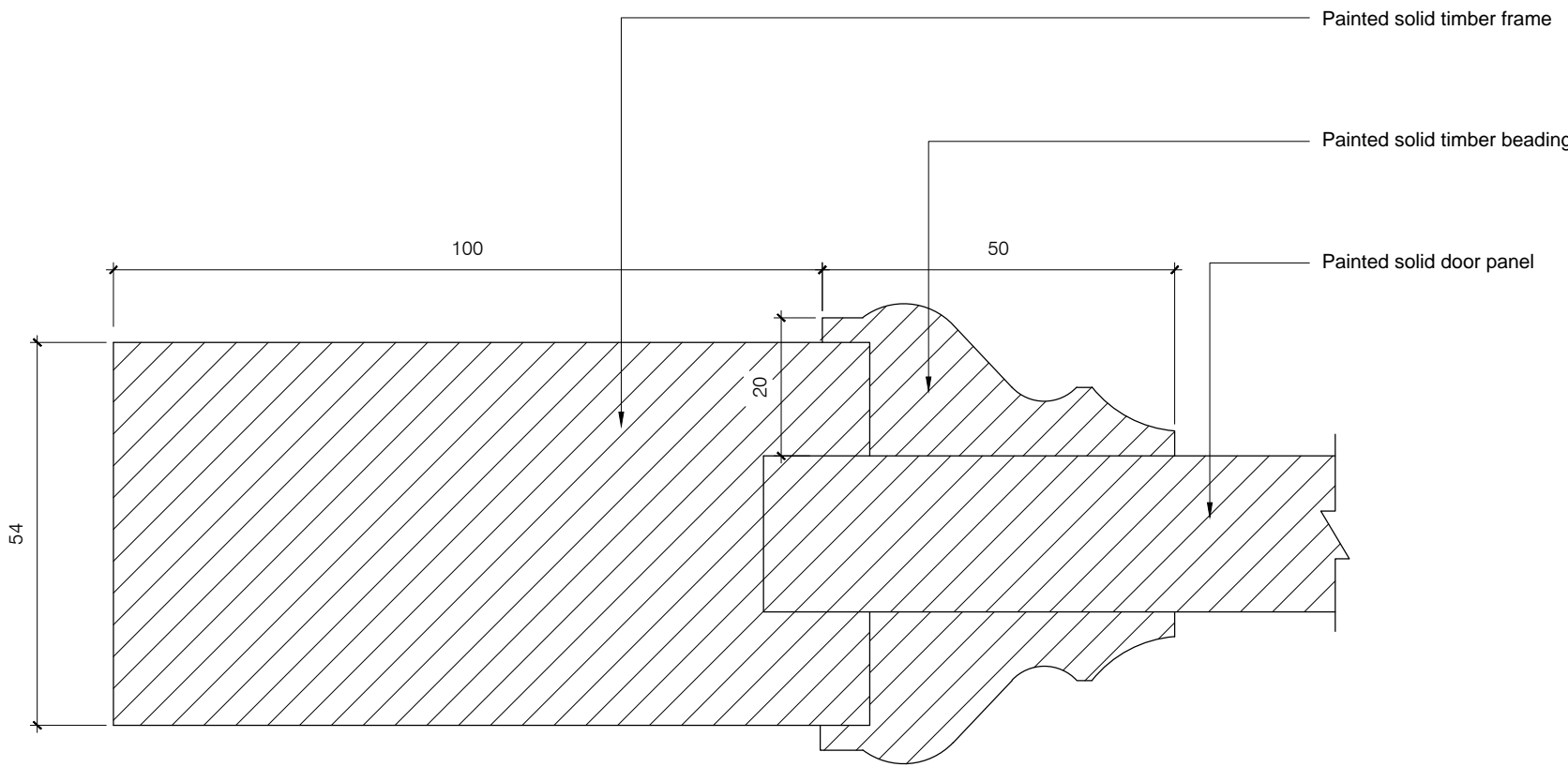

6- BEADING /MOULDING DETAIL ON PANIELLED APARTMENT ENTRANCE DOORS

Product spec: New solid timber beading
Dimension: 20 x 50mm

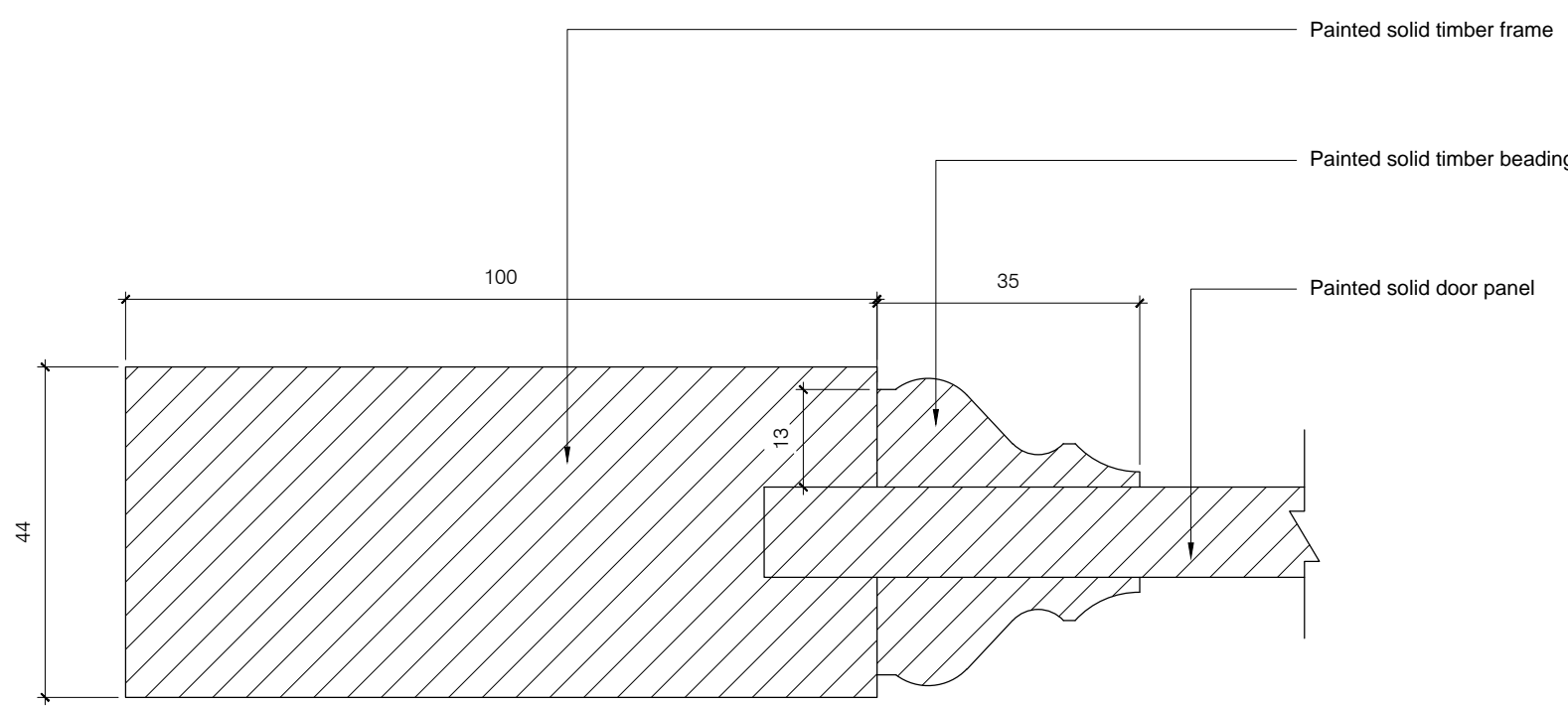

7- BEADING /MOULDING DETAIL ON PANIELLED INTERNAL DOORS

Product Spec: New solid timber beading
Dimension: 13 x 35mm

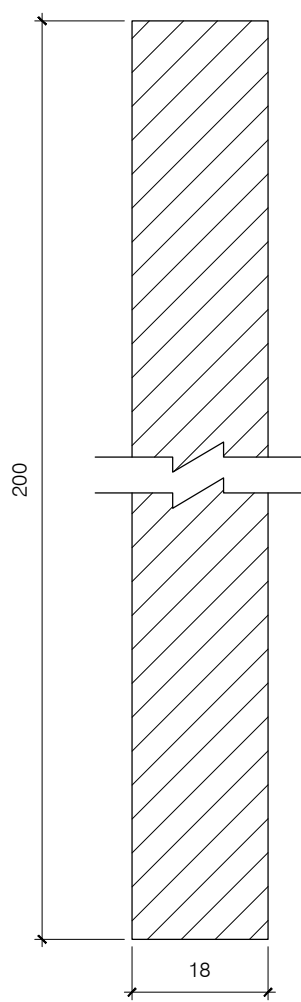

8- SKIRTING BOARDS

Type 01
Product Spec: Square edged MR MDF
Dimension: 18mmx 200mm:

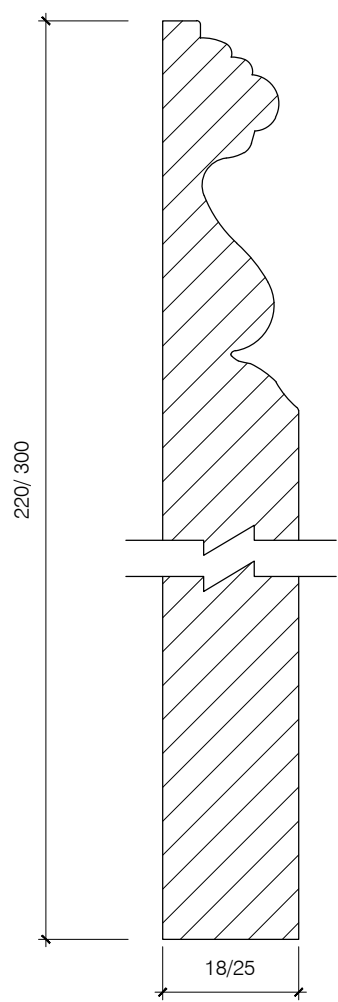

9- SKIRTING BOARDS

Type 02
Product spec: Skirting4U, Victorian Primed MDF,
Dimension: 18mm x 220mm:

Type 03
Product spec: Skirting4U, Victorian Primed MDF,
Dimension: 25mm x 300mm

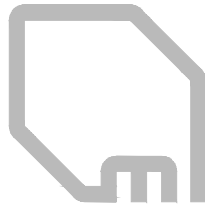

modular studio
5a Iliffe Yard
London, SE17 3QA
t: +44 (0)20 7193 1717
e: www.modular-studio.co.uk

client



project address:
66-67 Guilford Street, London WC1N 1DF
drawing title:
Architrave, Moulding & Skirting Details
scale:
1:1 @ A1 (1:2 @ A3)

job no.

16009 PL425

dwg no.

revision

/

GENERAL NOTES

- A. Do not scale from this drawing. Check all dimensions and conditions on site. As Existing drawings are based on survey information supplied/produced by the client.
- B. All works to be carried out in accordance with current health and safety including CDM regulations. All works to comply with current British standards and regulations, codes of practice, Building regulations, and appropriate European standards.
- C. All structural work is to be carried out in accordance with the structural engineers details and calculations.
- D. Precise positions of all fixtures and fittings is subject to confirmation on site.
- E. Allow for the protection of all finishes and fittings that are to be retained.
- F. All drawings are to be read in conjunction with the scope of works and relevant specifications.
- G. All drainage shown is indicative - refer to M&E drawings for details.
- H. All works to be carried out strictly in accordance with relevant manufacturers instructions

NB:

- Refer to drawings 16009 PL109/110/111/112/113/114 for door locations.
- Refer to drawings 16009 PL425 for architrave details
- Refer to jamb details 16009 425 & 426

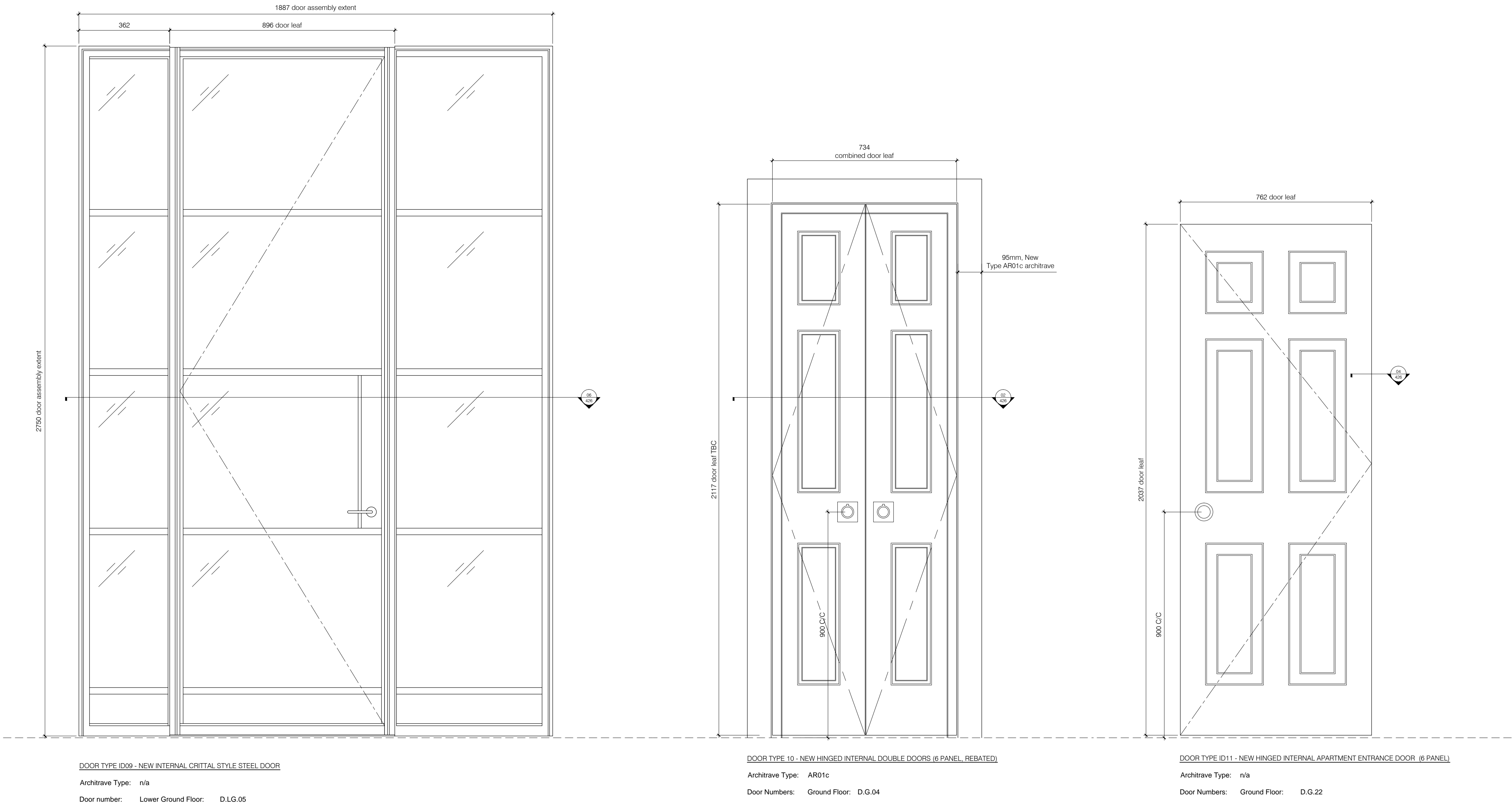

| rev | date | checked | description |
|-----|------|---------|-------------|
|-----|------|---------|-------------|

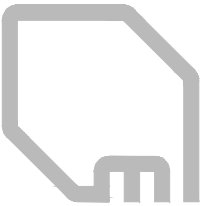

modulor studio
5a Iliffe Yard
London, SE17 3QA
t: +44 (0)20 7193 1717
e: www.modulor-studio.co.uk



client: 66-67 Guilford Street, London WC1N 1DF
drawing title: Internal Door Details 04
scale: 1:10 @ A1 (1:20 @ A3)

| job no. | dwg no. | revision |
|---------|---------|----------|
|---------|---------|----------|

16009 PL 423



01 No. 66, First Floor, Front Room, Cornice



04 No. 67, First / Second Floor Half landing, Cornice



07 No. 67, Ground Floor, Front Room, Cornice



02 No. 66, First Floor, Rear Room, Cornice



05 No. 67, Ground / First Floor Half landing, Cornice



08 No. 67, Ground Floor, Front Room, Cornice



03 No. 66, Ground Floor, Entrance Hall, Cornice

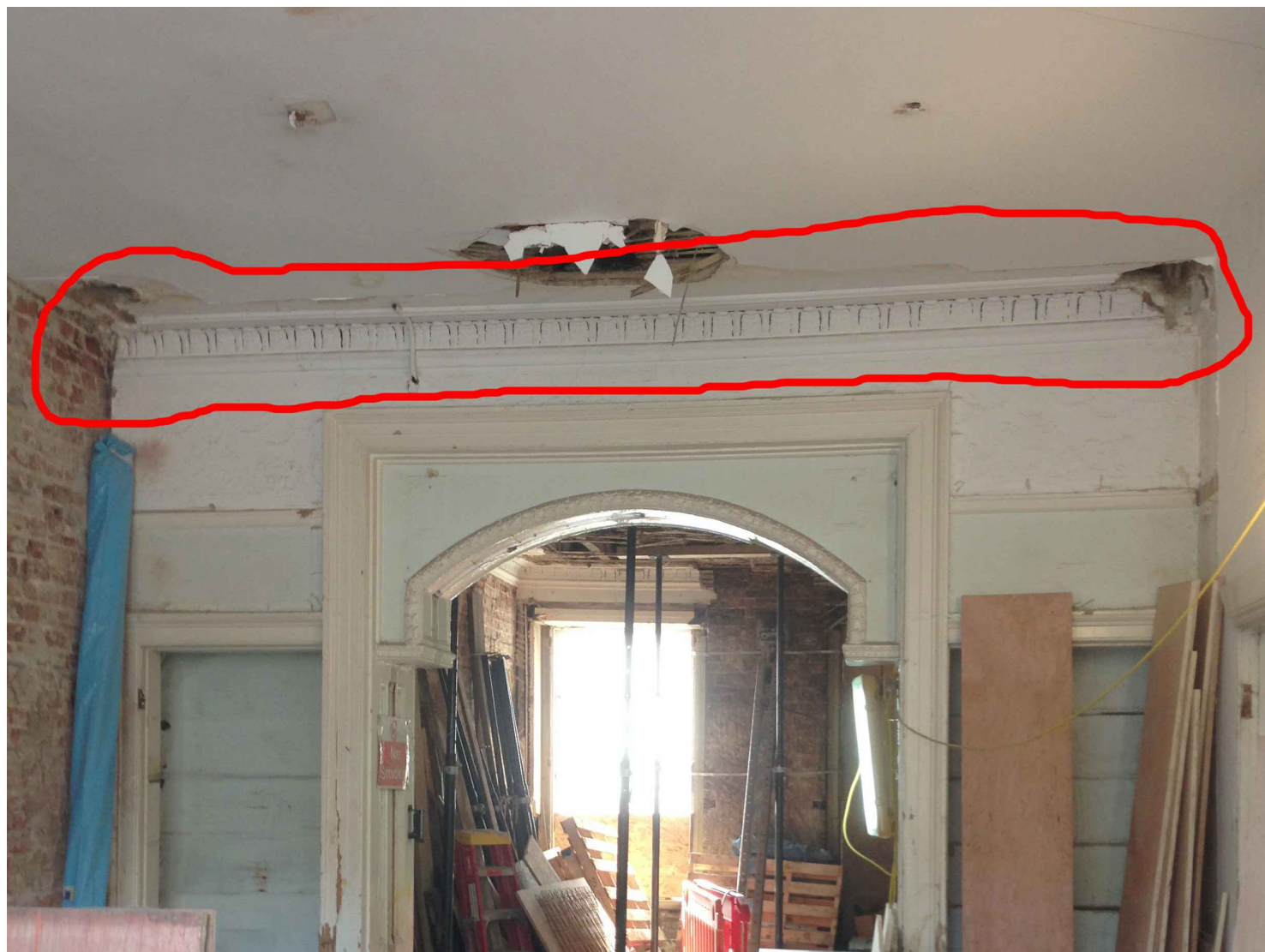

06 No. 67, Ground Floor, Rear Room, Cornice

GENERAL NOTES

- A. Do not scale from this drawing. Check all dimensions and conditions on site. As Existing drawings are based on survey information supplied/produced by the client.
- B. All works to be carried out in accordance with current health and safety including CDM regulations. All works to comply with current British standards and regulations, codes of practice, Building regulations, and appropriate European standards.
- C. All structural work is to be carried out in accordance with the structural engineers details and calculations.
- D. Precise positions of all fixtures and fittings is subject to confirmation on site.
- E. Allow for the protection of all finishes and fittings that are to be retained.
- F. All drawings are to be read in conjunction with the scope of works and relevant specifications.
- G. All drainage shown is indicative - refer to M&E drawings for details.
- H. All works to be carried out strictly in accordance with relevant manufacturers instructions

NB:

- Refer to drawings 16009 PL120 & 121 for cornice locations

- No corning proposed to floors LG/ 02/03/04



1- CORNICE TYPE 01

Product spec: EG 09, Mompesson House Dining Room Plain Georgian cornice by Stevensons of Norwich

Dimension: H:250mm x W:225mm

Location: Heritage areas on Ground & First Floors



2- CORNICE TYPE 01 IMAGE

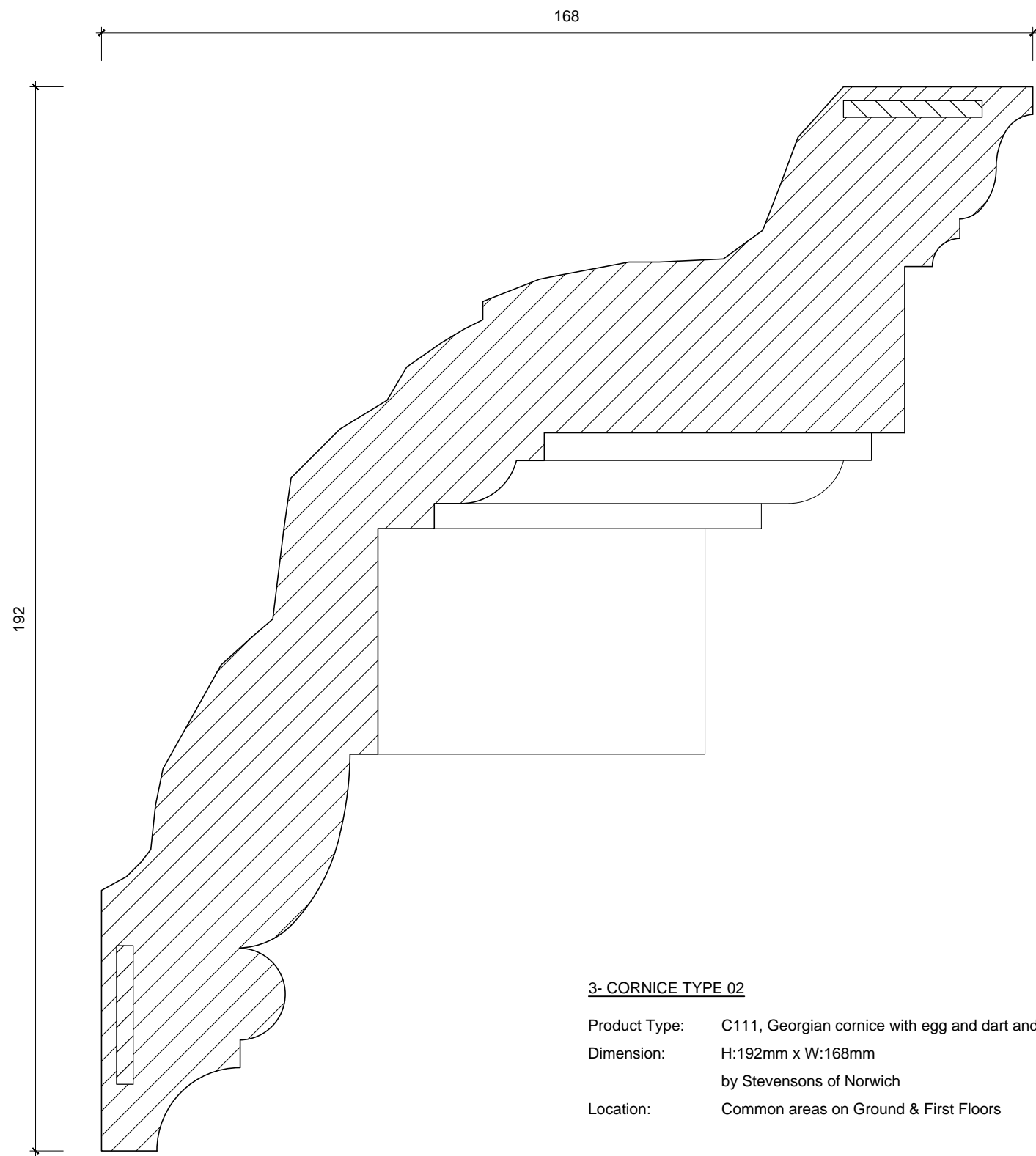

3- CORNICE TYPE 02

Product Type: C111, Georgian cornice with egg and dart and modillion block

Dimension: H:102mm x W:168mm

Location: Common areas on Ground & First Floors



4- CORNICE TYPE 02 IMAGE

| rev | date | checked | description |
|-----|------|---------|-------------|
|-----|------|---------|-------------|

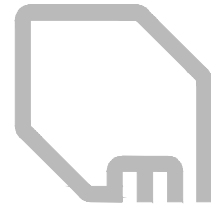

modulor studio
5a Iliffe Yard
London, SE17 3QA
t: +44 (0)20 7193 1717
e: www.modulor-studio.co.uk

client



project address:
66-67 Guilford Street, London WC1N 1DF

drawing title:
Cornice Profile Details

scale:
1:1 @ A1 (1:2 @ A3)

job no.

dwg no.

revision

16009 PL426

/