

19 x DESKS (1.6m x 0.8m)
 15 x CABINETS
 RETAINED:
 PRINT ROOM
 2 x TOILETS
 KITCHEN

P-01 PROPOSED GROUND FLOOR PLAN
 0525 FLOOR SPACE AREA: 200.7m²

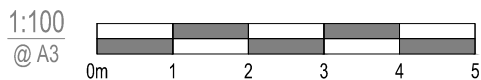
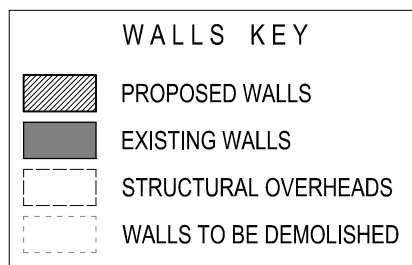

Client : Nyman Lisbon Paul	design solutions (London) Ltd Architectural & Property Design Services The Studio 7 Station Approach Stoneleigh Epsom KT19 0QZ tel : + 44 (0) 20 8393 8809 mobile : 07970 700773 email : design.solutions@talktalk.net web : designsolutionslondonltd.co.uk		Title : Proposed Ground Floor Plan		
			Designed by : A.A / S.J.T	Date : March 2017	Scale : 1:100 @ A3
Project : Regina House, 124 Finchley Road London NW3 5JS	Architecture Design & Planning Building Surveys Planning Appeals Party Wall Matters Building Construction				