

1/00	General Items	
1/01	Supporting Frame	<p>Simply and rigidly support the work in a manner to support the proposed casting. The primary things to be considered are:</p> <ul style="list-style-type: none"> How securely the work will be held to the steel table to prevent the movement of the work. How the work will be held to the steel table to prevent the movement of the work. How the work will be held to the steel table to prevent the movement of the work.
1/02	Insulation	<p>Insulation should be placed between the work and the steel table to prevent the work from being damaged by the heat of the molten metal.</p> <p>Insulation should be placed between the work and the steel table to prevent the work from being damaged by the heat of the molten metal.</p> <p>Insulation should be placed between the work and the steel table to prevent the work from being damaged by the heat of the molten metal.</p>
1/03	Overhead Material	<p>Provide and fix overhead the work in a manner to support the work in a manner to support the proposed casting.</p> <p>Provide and fix overhead the work in a manner to support the work in a manner to support the proposed casting.</p> <p>Provide and fix overhead the work in a manner to support the work in a manner to support the proposed casting.</p>
1/04	Casting	<p>Simply and rigidly support the work in a manner to support the proposed casting.</p> <p>Simply and rigidly support the work in a manner to support the proposed casting.</p> <p>Simply and rigidly support the work in a manner to support the proposed casting.</p>
1/05	Casting Frame	<p>Simply and rigidly support the work in a manner to support the proposed casting.</p> <p>Simply and rigidly support the work in a manner to support the proposed casting.</p> <p>Simply and rigidly support the work in a manner to support the proposed casting.</p>
1/06	Edge and Oil Dishes	<p>Simply and rigidly support the work in a manner to support the proposed casting.</p> <p>Simply and rigidly support the work in a manner to support the proposed casting.</p> <p>Simply and rigidly support the work in a manner to support the proposed casting.</p>
1/07	Partial Casting	<p>Simply and rigidly support the work in a manner to support the proposed casting.</p> <p>Simply and rigidly support the work in a manner to support the proposed casting.</p> <p>Simply and rigidly support the work in a manner to support the proposed casting.</p>
1/08		<p>Simply and rigidly support the work in a manner to support the proposed casting.</p> <p>Simply and rigidly support the work in a manner to support the proposed casting.</p> <p>Simply and rigidly support the work in a manner to support the proposed casting.</p>
1/09		<p>Simply and rigidly support the work in a manner to support the proposed casting.</p> <p>Simply and rigidly support the work in a manner to support the proposed casting.</p> <p>Simply and rigidly support the work in a manner to support the proposed casting.</p>

[illegible]

PROJECT:
External
Cladding Works

Site	Client
Albany Police Station London NW1 4EB	Metropolitan Police Service



www.arcadls.com

TITLE:
**Albany Police Station
External Cladding Works
Proposed Cladding Section**

Quality Description	Designed	Approved	2024
	Drawn	Approved	2024
	Checked	Approved	2024
	Approved	Approved	2024
	Scale	Drawn	
Original Size	A3	G&B	
Sustainability Code		Project Number:	33254116

Drawing Number:	APS_33254116_11	Revision:	Rev
-----------------	-----------------	-----------	-----

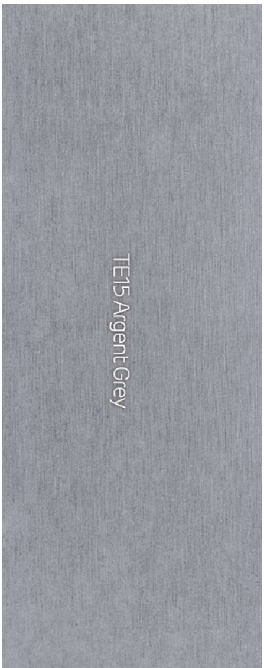

Proposed Cladding Colour

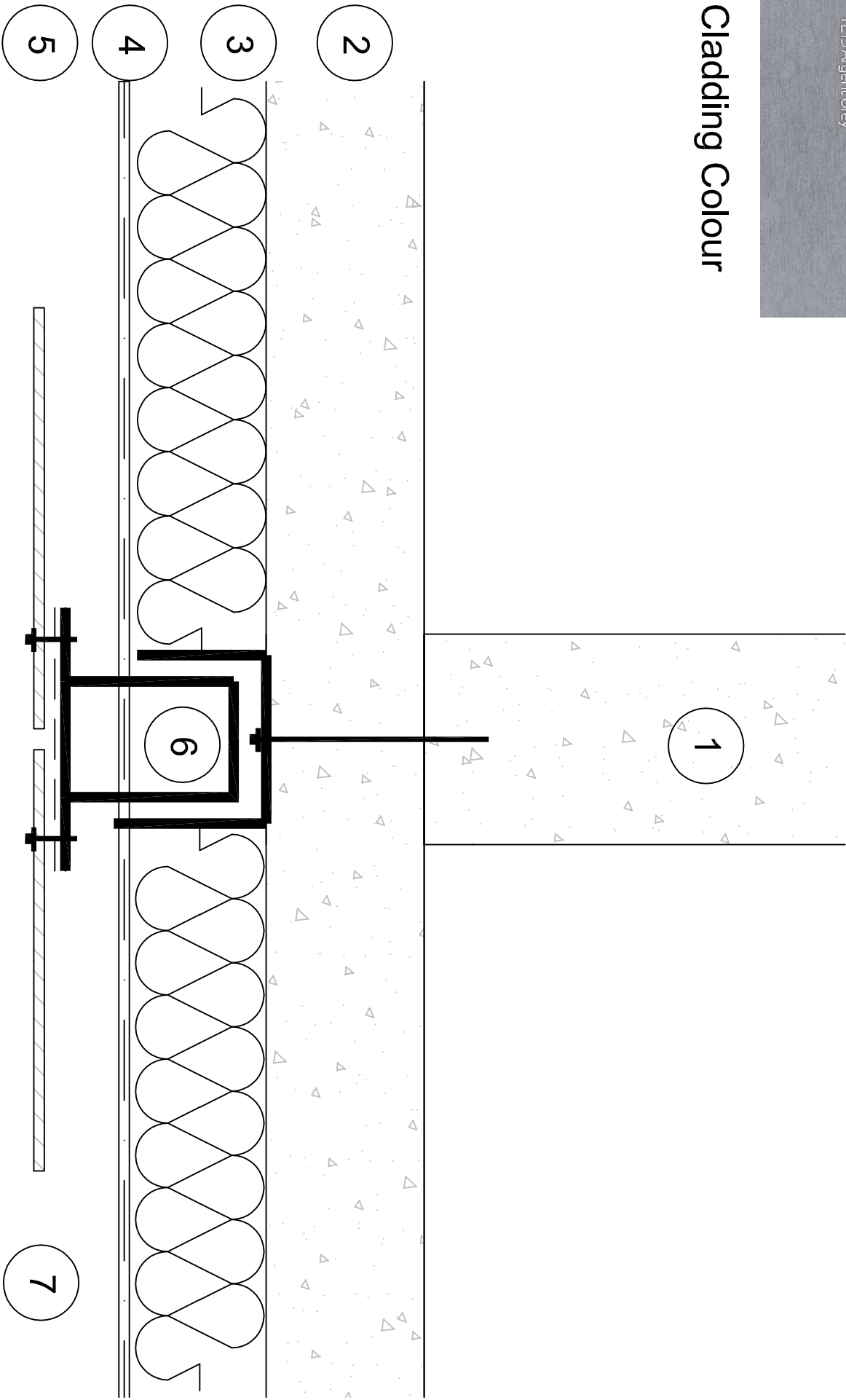

泰

- 1) Existing concrete frame
- 2) Existing concrete cladding
- 3) Rockwool rainscreen duo slab insulation 130mm
- 4) Tyvek black uv facade protective membrane
- 5) Cavity 30mm
- 6) Nvelope NV2F2 floor spanning frame
- 7) Marley eternite equitone tectiva cladding (uncut panel size 10mm x 1220mm x 2500mm)