

GROUND FLOOR PLAN

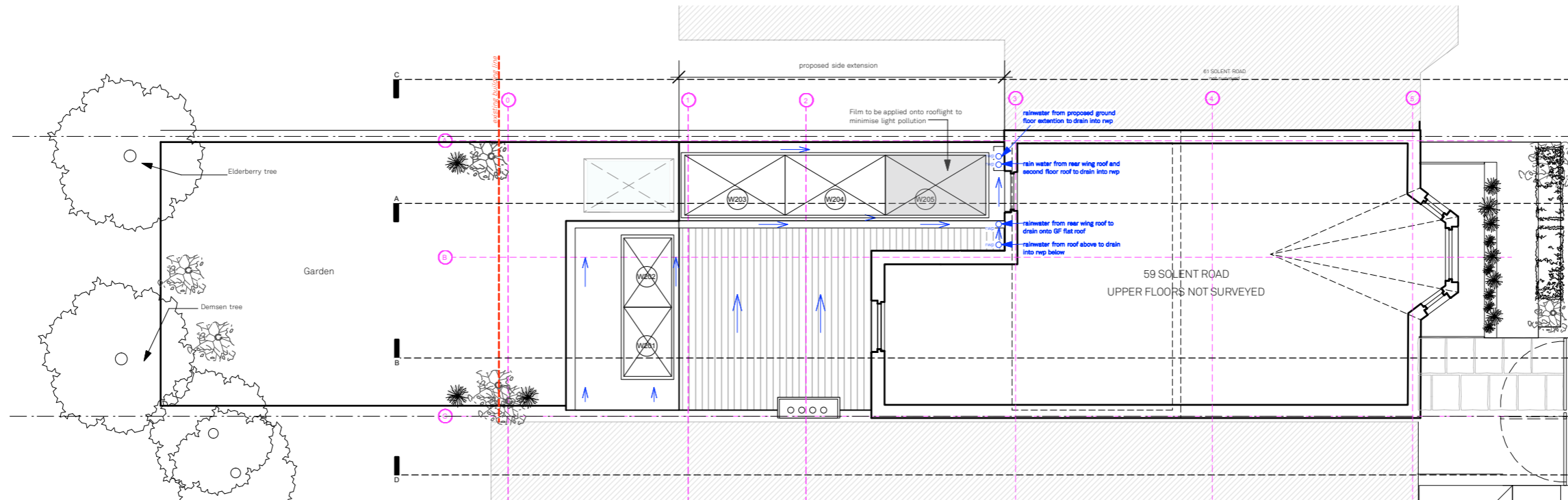

- Assumed existing drainage run
- Proposed drainage
- Soil Vent Pipe (ex indicates existing)
- Rainwater Pipe (ex indicates existing)
- Rodding access point
- Tapered gully
- Existing radiator to be retained
- Thermostat, ref: to suit manufacturer's system, electronic, location shown indicatively, exact location to be agreed with architect
- UPHV, ref: Nu Heat zones and design, zones shown indicatively, to be agreed through manufacturer, design contractor to allow for different floor build-ups throughout - manufacturer layout drawings and calculations to be submitted for architect comments prior to order and installation, supplier to guarantee performance meets specific design criteria of property and works, incl. all relevant Approved Document, show for B zones
- Manifold, ref: to suit manufacturer's system, location shown indicatively, exact location to be agreed with architect
- Water Softener, ref: make and model to suit pressure and capacity of property
- direction of fall

FIRST FLOOR PLAN

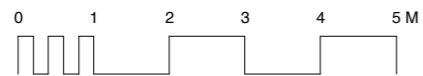

**Proposed GF and First Floor**

Solent Road

Drawn By SU  
 Scale 1:100 @ A3  
 Status Planning

Paul Archer Design Ltd

**Issue Notes**

- a) PLANNING revision
- b) PLANNING revision
- c) PLANNING revision
- d) PLANNING revision (BIA)

**Date**

- 01.12.2016
- 04.01.2017
- 13.01.2017
- 20.02.2017

103 Farringdon Road London EC1C3BS Tel. 020 3668 2668

**700.211d**

paul archer  
design

www.paularcherdesign.co.uk