

**EXTERNAL WALLS** - u-value to achieve 0.17W/m<sup>2</sup>K  
 102.5mm brickwork  
 100mm cavity with 50mm Kingspan Kooltherm K8  
 cavity board fixed to the inner leaf  
 100mm Fibrolite blockwork  
 37.5mm Kingspan Kooltherm K17 insulated  
 plasterboard & skim coat

**INTERNAL PARTITIONS**  
 12.5mm plasterboard & skim  
 100x50mm studwork wall  
 acoustic insulation, min. density to  
 be 45kg/m<sup>3</sup> between studs  
 12.5mm plasterboard & skim

**WINDOWS** - u-value to achieve 1.6W/m<sup>2</sup>K

**BUILDING CONTROL NOTES**

**Electrical:**  
 All electrical work required, is to meet with the requirements of Part P (Electrical safety) of the Building Regulations, and must be designed, installed, inspected and tested by a person competent to do so.

All new lights to have dedicated energy efficient fittings.

**Fire Escape:**  
 Escape provision is to be met by providing a protected stair well (FD20 doors to all habitable rooms).

All opening windows are to be fully openable (450x 450mm min) allowing these to be used for escape purposes.

**Background ventilation:**  
 All windows to provide background ventilation through trickle vents, etc.

**Extract ventilation:**  
 Mechanical extract to serve mini kitchen - 30L/sec and shower room - 15L/sec  
 Extracts to be ducted through wall

**Smoke detectors:**  
 Self contained mains operated smoke alarms to comply with BS:5466:Part 1 and located 300mm from walls to comply with BS:5839:Part 1.  
 Smoke detectors to be hard wired & interlinked.

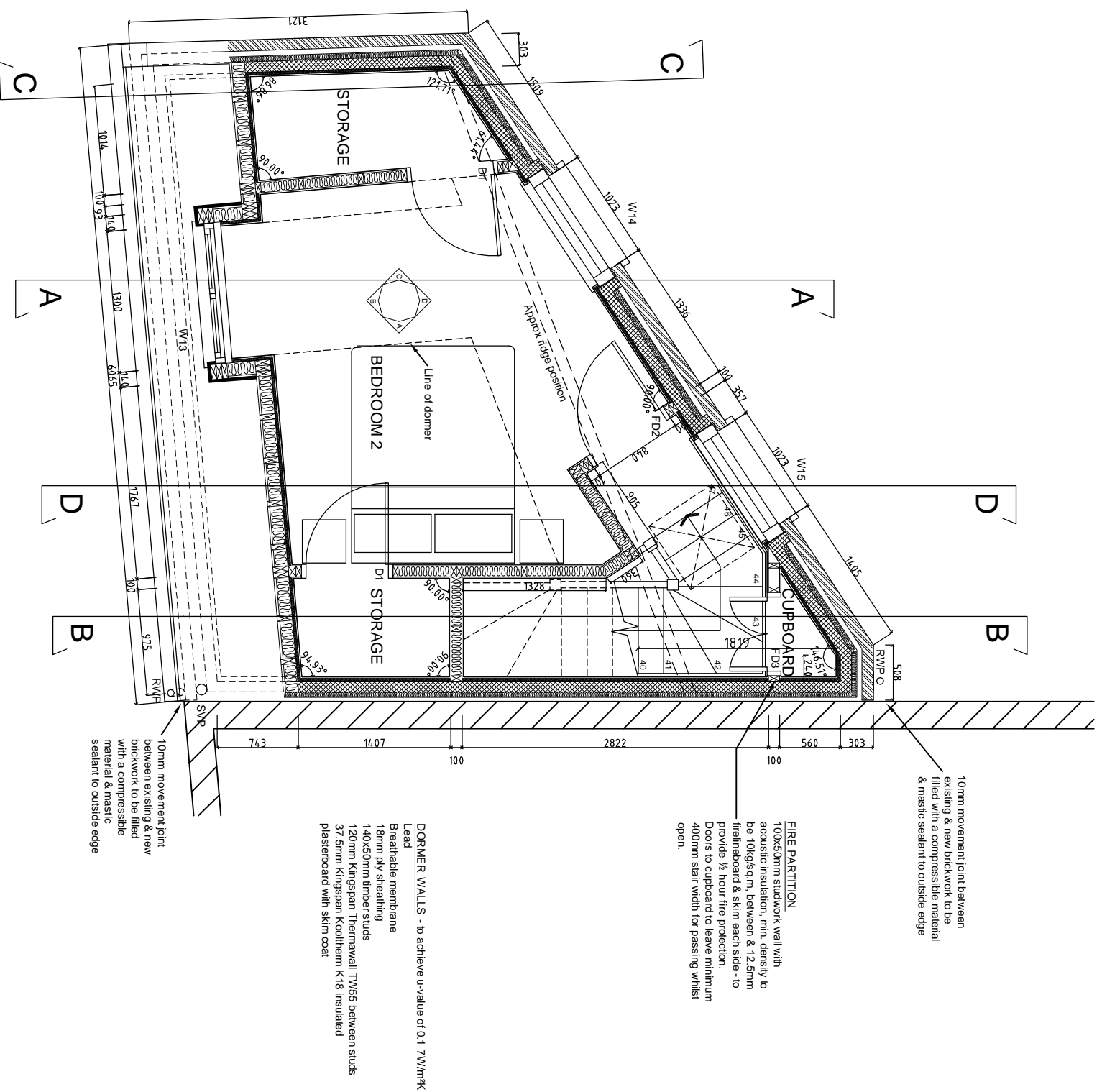

10mm movement joint between existing & new brickwork to be filled with a compressible material & mastic sealant to outside edge

**FIRE PARTITION**  
 100x50mm studwork wall with acoustic insulation, min. density to be 10kg/sqm, between & 12.5mm firelineboard & skim each side - to provide 1/2 hour fire protection.  
 Doors to cupboard to leave minimum 400mm stair width for passing whilst open.

**DORMER WALLS** - to achieve u-value of 0.17W/m<sup>2</sup>K  
 Lead  
 Breathable membrane  
 18mm ply sheathing  
 140x50mm timber studs  
 120mm Kingspan ThermaWall TW55 between studs  
 37.5mm Kingspan Kooltherm K18 insulated plasterboard with skim coat

10mm movement joint between existing & new brickwork to be filled with a compressible material & mastic sealant to outside edge

**DOOR SCHEDULE**  
 ED1 - 1023mm wide structural opening with external quality hardwood door  
 FD1 - 915mm wide structural opening with 838mm leaf internal door, fire rated to a min. of 20 minutes  
 FD2 - 840mm wide structural opening with 762mm leaf internal door, fire rated to a min. of 20 minutes  
 FD3 - 764mm wide structural opening with 2no 343mm leaf internal doors, fire rated to a min. of 20 minutes  
 D1 - 840mm wide structural opening with 762mm leaf internal door

Revisions		
No.	Description	Date
B	Window references	20.04.17
A	Tender Revision	17.11.16
Hodges Row London NW3 2JZ		
Mr G Hodges		
Third Floor Plan		
Scale:	Date:	Ref:
1:50@A3	MAY '16	590/06B

**CLARKE ASSOCIATES**  
 CHARTERED BUILDING SURVEYORS  
 5 Abbey Parade, Ealing, London, W5 1EJ  
 Tel: 020 8997 0099 Fax: 020 8991 0449  
 E-mail: post@clarkeassociates.co.uk