

Section A-A'
Scale 1:50

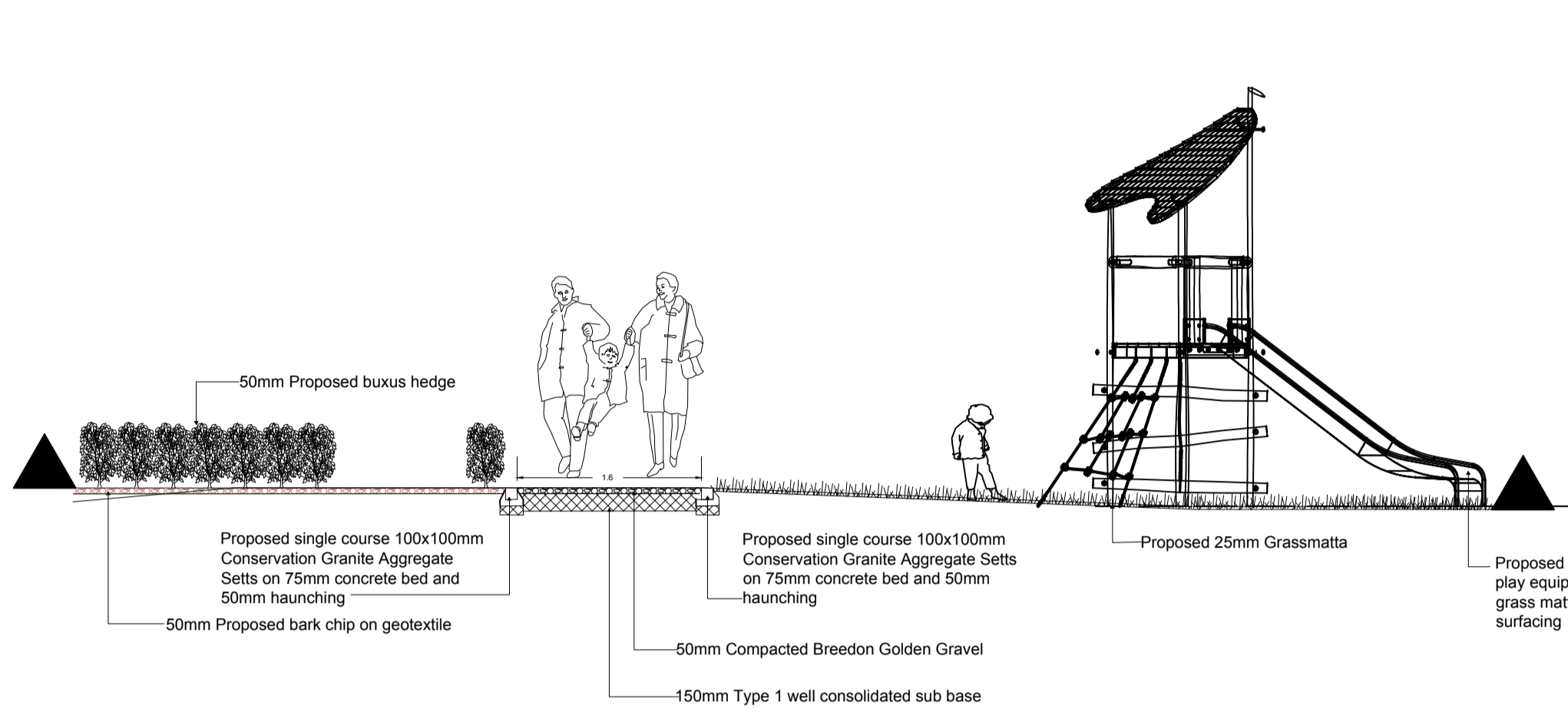

Section B-B'
Scale 1:50

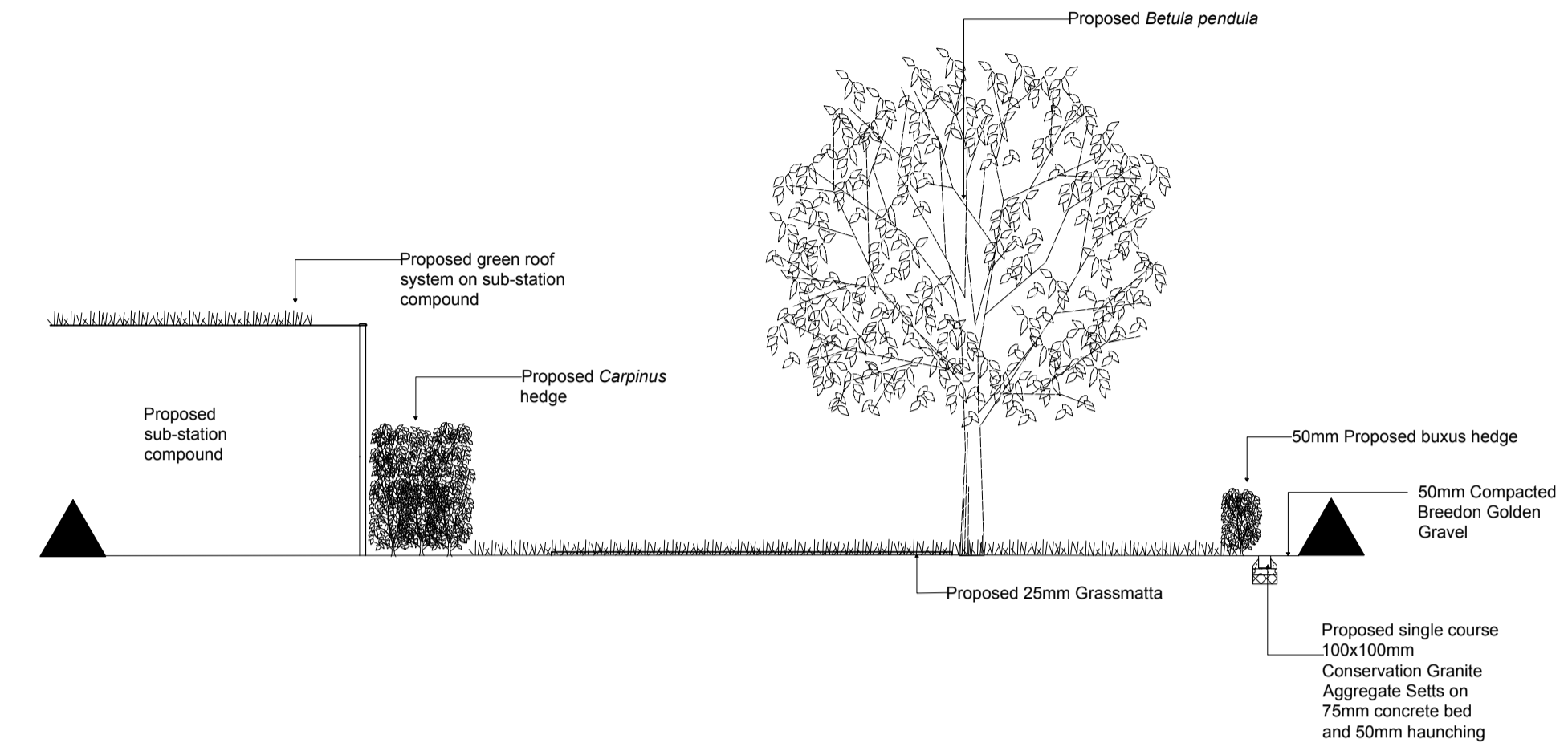

Section C-C'
Scale 1:50

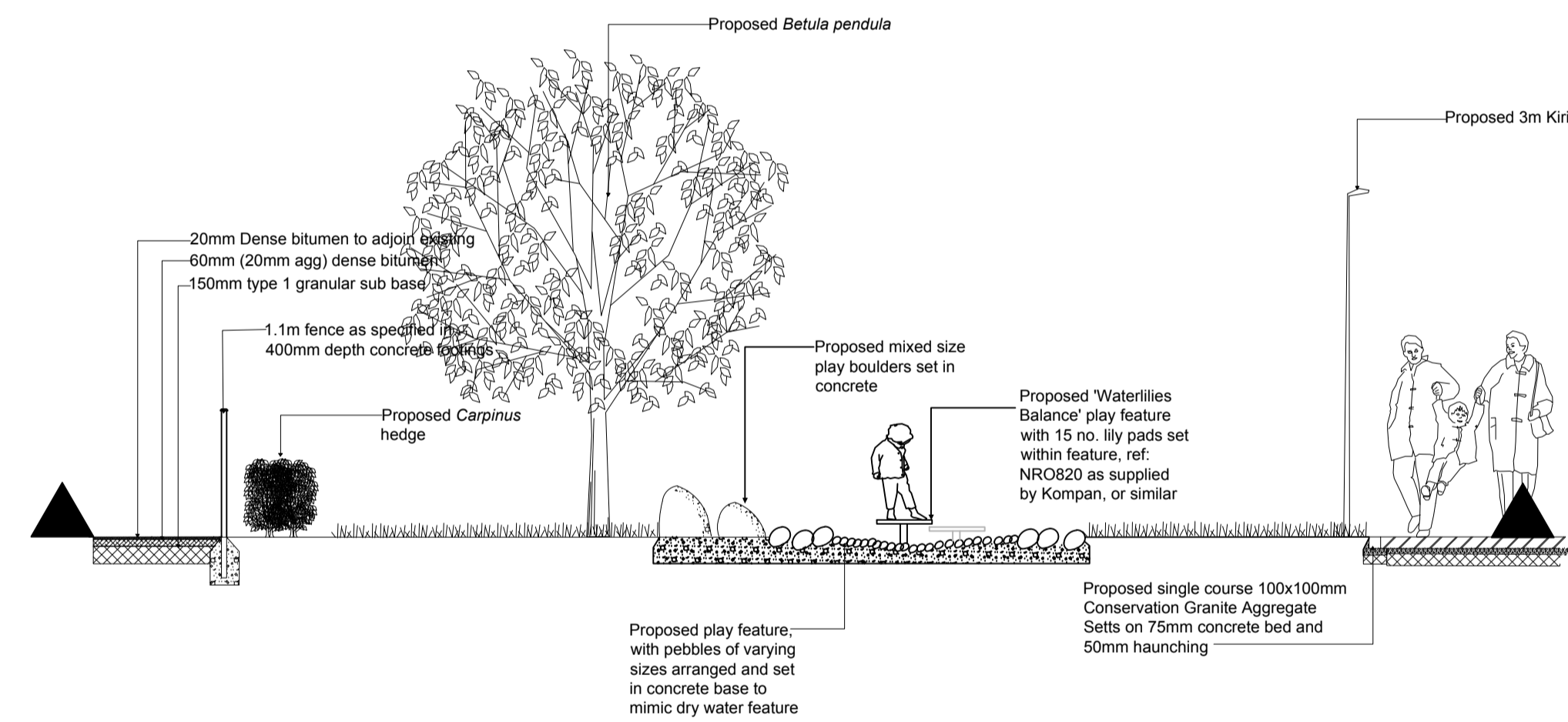

Section D-D'
Scale 1:50

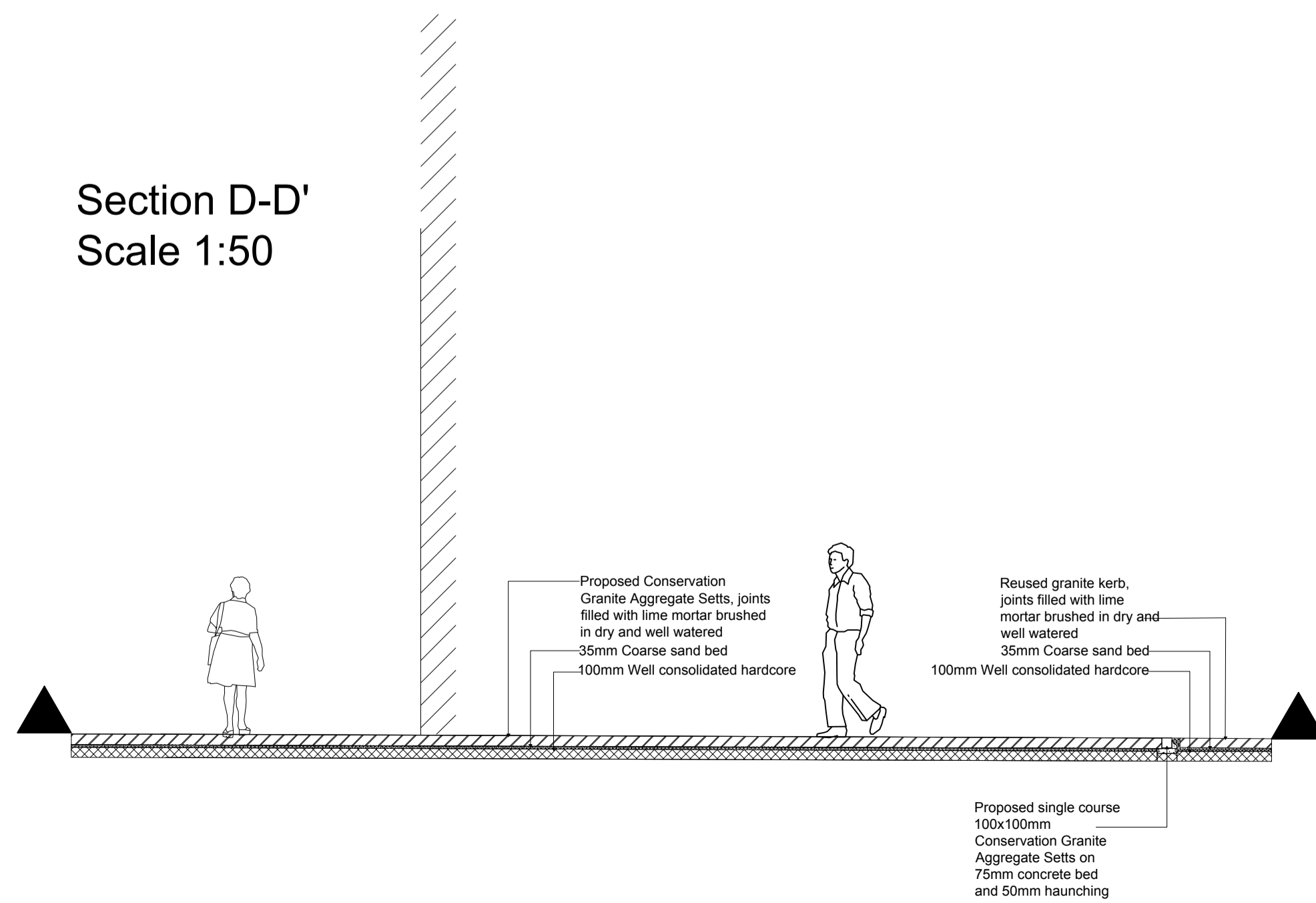

Section E-E'
Scale 1:50

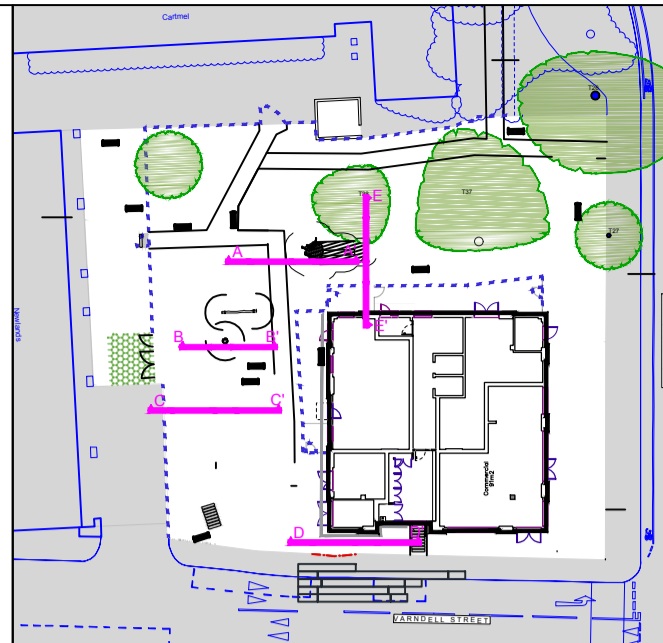
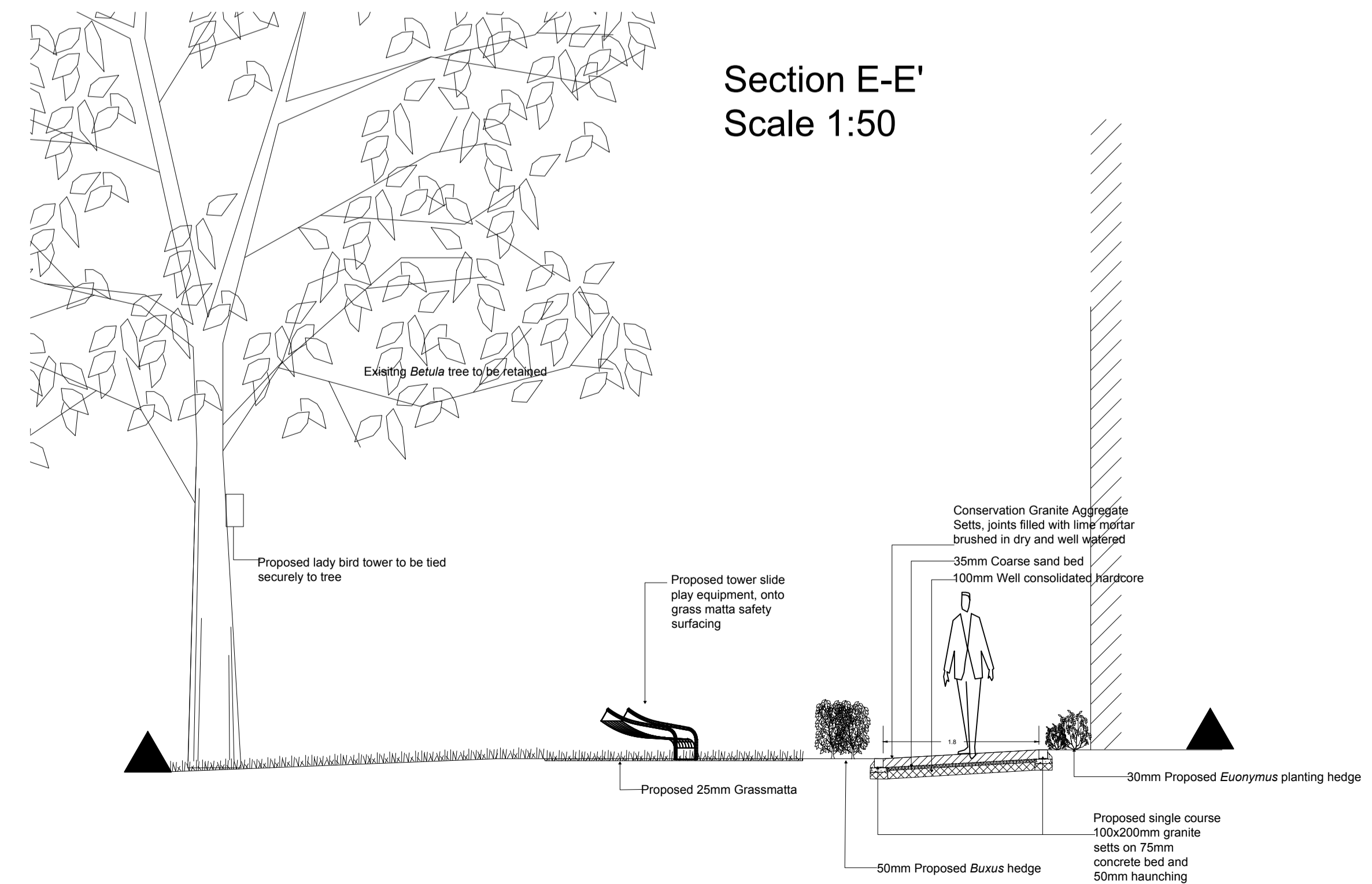

Cross section location plan

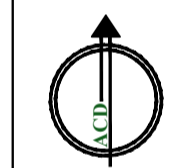

Rev	Date	Details	Drawn
C	22.11.16	Client comments	JS
B	14.04.16	Add sub-station	JS
A	26.02.16	VE updates	JS

ACD ENVIRONMENTAL

Ecology
Archaeology
Arboriculture
Landscape Architecture

ACD at these offices:
Rodbourne Rail Business Centre, Grange Lane,
Malmesbury, SN16 0ES
Tel: 01666 825646

Courtyard House, Mill Lane, Godalming, GU7 1EY
Tel: 01483 425714

Suite 6, Crescent House, Yonge Close, Eastleigh, SO50 9SX
Tel: 02382 026 300
email: mail@acdenv.co.uk
www.acdenvironmental.co.uk

Lovell Partnerships Limited

scheme: Regent's Park Estates
Newlands
client: Lovell Partnerships Ltd
drawing: Cross Sections
date: December 2015
scale: 1:50@A1
drawing no: LOV20035-13C
drawn: JNT checked: JS

Copyright of ACD Environmental Ltd. All rights described in Chapter IV of the Copyright, Designs and Patents Act 1988 have been generally asserted. 2011. Copyright of this plan remains with ACD until all fees have been paid in full.