

- 17 No. Carex hachijoensis 'Evergold' 20%
- 17 No. Stipa gigantea 20%
- 17 No. Verbena bonariensis 20%
- 17 No. Echinacea purpurea 20%
- 17 No. Allium hollandicum 'Purple Sensation' 20%

- Herbaceous Planting Mix
- 5 No. Achillea millefolium 'Cerise Queen' 25%
 - 5 No. Erigeron karvinskianus 25%
 - 5 No. Euphorbia amygdaloides 'Purpurea' 25%
 - 5 No. Salvia officinalis 25%

WORKS WITHIN
HS2 DRAWINGS TO
BE INSTALLED AT
A LATER DATE

- Herbaceous Planting Mix
- 12 No. Carex comans 'Bronze Form' 20%
 - 6 No. Geranium 'Ann Folkard' 10%
 - 6 No. Hebe franciscana 'Blue Gem' 10%
 - 12 No. Lavandula angustifolia 'Twickel Purple' 20%
 - 6 No. Potentilla fruticosa 'Abbotswood White' 10%
 - 6 No. Rosmarinus officinalis 'Miss Jessopp's Upright' 10%
 - 12 No. Salvia officinalis 'Purpurascens' 20%

SPECIFICATION
All works generally, to comply with the written Soft Landscape Specification.

Capping layer to be provided by excavating to a depth of 1m and importing 700mm subsoil and 300mm topsoil, unless specific requirements for tree pits as detailed within landscape specification.

NOTE: DO NOT SCALE FROM DRAWING

Soft Landscape Legend

- Proposed site boundary
- Existing trees to be removed
- Existing trees to be retained and protected during construction
- Proposed tree planting within soft landscape. See detail
- Proposed specimen shrub planting
- Proposed Buxus (box) hedge planting to be planted in a single row at 300mm centres and maintained at 500mm height
- Proposed native hedge planting to be planted in a double staggered row 300mm apart and at 500mm centres in each row. To be maintained at 1m height
- Proposed shrub planting to receive 75mm bark mulch after planting operations
- Proposed grass areas to receive good quality amenity grass turves laid in line with good horticultural practices
- Proposed drive to be 38mm Pre-Grown Golpla Grass Paver and 150mm Cellweb to be laid to suppliers specification as supplied by geosyn.co.uk
- Proposed topsoil within planters for communal use
- Proposed pre-cast bespoke concrete planters, 1.2m high. Free draining into ground to avoid need for additional drainage

- Ecology enhancements**
- Proposed bat box to be schwegler 2FN or similar
 - Proposed bird box to be schwegler 1B or similar
 - Proposed insect house to be a ladybird tower
 - Proposed swift box to be Schwegler 17A or similar
 - Proposed sparrow terrace to be schwegler 1SP or similar

Rev	Date	Details	Drawn
C	22.11.16	Client comments	JS
D	07.07.16	Amend existing tree position	JNT
C	09.05.16	Amend planter details	JS
B	08.04.16	Client comments	JS
A	22.02.16	Update for VE	JS

NEW FLAG PAVING TO ADJOIN EXISTING FLAG PAVING ON FOOTPATH

3 No. Sorbus hupehensis

EXISTING ASPHALT SURFACE

81 No. Buxus sempervirens

1 No. Salix babylonica v. 'Tortuosa'

EXISTING FLAG PAVING

- 15 No. Corylus avellana 25%
- 15 No. Crataegus monogyna 25%
- 15 No. Prunus spinosa 25%
- 15 No. Rosa arvensis 25%

CUT BACK CANOPY TO CREATE A POLLARD FRAMEWORK

PROPOSED WILLOW PLAY STRUCTURES

1 No. Morus nigra

Rydal Water

1 No. Cercis canadensis 'Forest Pansy'

45 No. Buxus sempervirens

81 No. Lavandula angustifolia 'Hidcote'

82 No. Lavandula angustifolia 'Hidcote'

2 No. Cercis siliquastrum (Judas Tree)

EXISTING ASPHALT SURFACE

EXISTING FLAG PAVING

NEW FLAG PAVING AS REQUIRED TO MATCH

EXISTING ASPHALT SURFACE

48 No. Buxus sempervirens

EXISTING FLAG PAVING

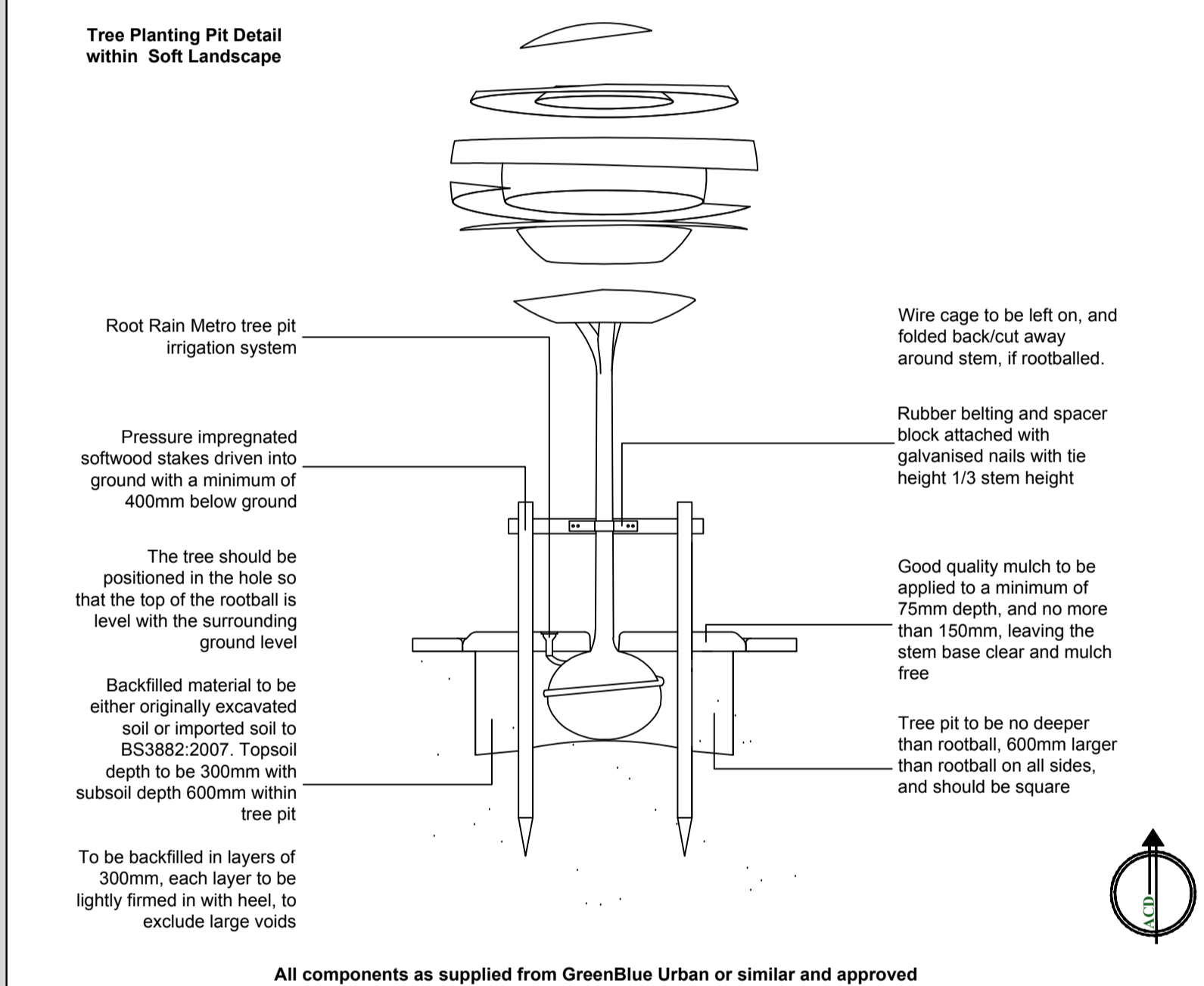
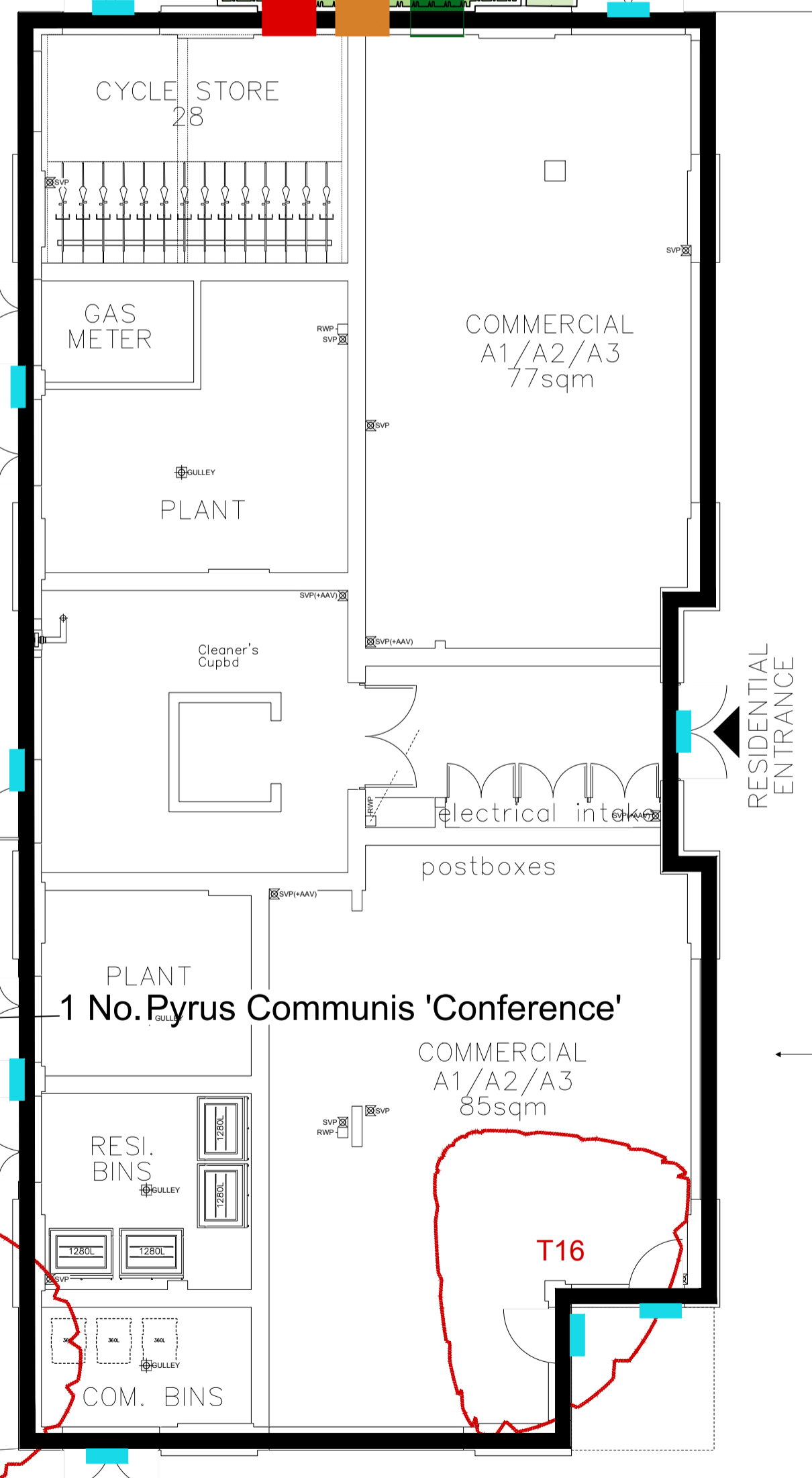

Planting Schedule

Trees	Species Name	Height	Pot Size	Specification	Density	No.
	Pyrus Communis 'Conference'	1.2-1.5 m	10L	Extra Light Standard :RB	0.3Ctr	1 No.
	Prunus 'Morello'	1.2-1.5 m	Counted	Maiden :RB	Counted	1 No.
	Cercis siliquastrum (Judas Tree)	1.5-2.0m	Counted	Extra Light Standard :C	Counted	2 No.
	Cercis canadensis 'Forest Pansy'	2.5-3.0m	Counted	Extra Light Standard :C	Counted	1 No.
	Morus nigra	2.5-3.0m	Counted	Extra Light Standard :RB	Counted	1 No.
	Sorbus hupehensis	3.0-4.0m	Counted	Light Standard 'Clear Stem 150-175' :RB	Counted	3 No.
	Corylus avellana	80-100cm	0.5Ctr Double Staggered at 0.3m offset	3 Stems :BR	0.5Ctr	15 No.
	Crataegus monogyna	80-100cm	0.5Ctr Double Staggered at 0.3m offset	3 Stems :BR	0.5Ctr	15 No.
	Salix babylonica v. 'Tortuosa'	350-400cm	Counted	Standard :RB	Counted	1 No.

Shrubs	Species Name	Height	Pot Size	Specification	Density	No.
	Buxus sempervirens	50-80cm	10L	C : plant and maintain as hedge	0.3Ctr	174 No.
	Fuchsia 'Mrs Poppie'	80-80cm	10L	Standard :C	Counted	2 No.
	Hebe franciscana 'Blue Gem'	40-60cm	5-7.5L	Bushy : 7 brks :C	5/m²	6 No.
	Lavandula angustifolia 'Hidcote'	30-40cm	3L	Bushy :C	0.3Ctr	163 No.
	Lavandula angustifolia 'Twickel Purple'	30-40cm	5-7.5L	Bushy : 7 brks :C	5/m²	12 No.
	Potentilla fruticosa 'Abbotswood White'	30-40cm	5-7.5L	Bushy : 7 brks :C	5/m²	6 No.
	Prunus spinosa	80-100cm	2/3 brks :BR	0.5Ctr Double Staggered at 0.3m offset	15 No.	15 No.
	Rosa arvensis	80-100cm	2/3 brks :BR	0.5Ctr Double Staggered at 0.3m offset	15 No.	15 No.
	Rosmarinus officinalis	60-80cm	10L	Bushy :C	Counted	2 No.
	Rosmarinus officinalis 'Miss Jessopp's Upright'	30-40cm	3L	Bushy : 4 brks :C	Counted	2 No.
	Salvia officinalis	60-80cm	3L	C	Counted	2 No.
	Salvia officinalis 'Purpurascens'	20-30cm	3L	Branches :5 brks :C	5/m²	12 No.

Herbaceous	Species Name	Height	Pot Size	Specification	Density	No.
	Achillea millefolium 'Cerise Queen'	2L	C	5/m²	5 No.	5 No.
	Allium hollandicum 'Purple Sensation'	5-7.5L	C	5/m²	17 No.	17 No.
	Carex comans 'Bronze Form'	3L	C	5/m²	12 No.	12 No.
	Carex hachijoensis 'Evergold'	5-7.5L	C	4/m²	17 No.	17 No.
	Echinacea purpurea	5-7.5L	C	4/m²	17 No.	17 No.
	Erigeron karvinskianus	2L	C	5/m²	5 No.	5 No.
	Euphorbia amygdaloides 'Purpurea'	2L	C	5/m²	5 No.	5 No.
	Geranium 'Ann Folkard'	3L	C	5/m²	6 No.	6 No.
	Salvia officinalis	2L	C	5/m²	5 No.	5 No.
	Stipa gigantea	5-7.5L	C	4/m²	17 No.	17 No.
	Verbena bonariensis	5-7.5L	C	4/m²	17 No.	17 No.

ACD ENVIRONMENTAL
Ecology
Archaeology
Arboriculture
Landscape Architecture

ACD at these offices:
Roudbourne Rail Business Centre, Grange Lane,
Maldenbury, SN16 0ES
Tel: 01666 825646

Courtyard House, Mill Lane, Godalming, GU7 1EY
Tel: 01483 425714

Suite 6, Crescent House, Yonge Close, Eastleigh, SO50 9SX
Tel: 02382 026 300
email: mail@acdenv.co.uk
www.acdenvironmental.co.uk

Lovell Partnerships Limited

scheme: Regent's Park Estates
Rydell Water (Former One Stop)
client: Lovell Partnerships Ltd
drawing: Soft Landscape Proposals
date: September 2015
scale: 1:100@A1
drawing no: LOV20033-11E
drawn: JNT checked: JS

Copyright of ACD Environmental Ltd. All rights described in Chapter IV of the Copyright, Designs and Patents Act 1988 have been generally asserted. 2011. Copyright of this plan remains with ACD until all fees have been paid in full.