

Notes:
 BASE ARCHITECT DRAWING - 1702-02-03-04-ELEV-GA
 DATE RECEIVED - 03-04-17

GENERAL NOTES
 1. ALL DIMENSIONS ARE IN MILLIMETRES UNLESS INDICATED.
 2. DO NOT SCALE FROM THIS DRAWING.
 3. THIS DRAWING SHALL BE READ IN CONJUNCTION WITH THE PROJECT SPECIFICATION & ALL OTHER PROJECT DOCUMENTATION.

WATER NOTES
 1. THE ENTIRE INSTALLATION SHALL FULLY COMPLY WITH CURRENT WATER REGULATIONS.
 2. DRAIN OFF COCKS SHALL BE INSTALLED AT ALL SYSTEM LOW POINTS.
 3. ALL CONCEALED PIPEWORK SHALL BE INSULATED THROUGHOUT IT'S LENGTH.
 4. THIS DRAWING SHALL BE READ ALONGSIDE CATERING PROJECTS INFORMATION.
 5. THE EXISTING HOT & COLD WATER INSTALLATIONS WITHIN THE BASEMENT SHALL BE MODIFIED TO SUIT THE ABOVE. EXISTING RISERS TO THE GF AREA CAN BE RE-USED IF PRACTICAL.
 6. THE WC WATER SERVICES SHALL BE RETAINED WITH TM'S REPLACED TO WH'S.

LEGEND

- TM HORNE THERMOSTATIC MIXING VALVE
- BCW BOOSTED COLD WATER
- HWS HOT WATER SERVICES
- SC LEVEL HANDED STOP COCK
- DW DISH WASHER
- WM WASHING MACHINE
- WS WATER SOFTENER
- HWC HEATRAE SADA MULTIPPOINT 100 6kW WATER HEATER, TEMPERATURE / PRESSURE RELIEF VALVE TO RUN OVER CLEANERS SINK
- ⊘ LEVER HANDED ISOLATION VALVE
- ⊘ DOUBLE CHECK VALVE ASSEMBLY

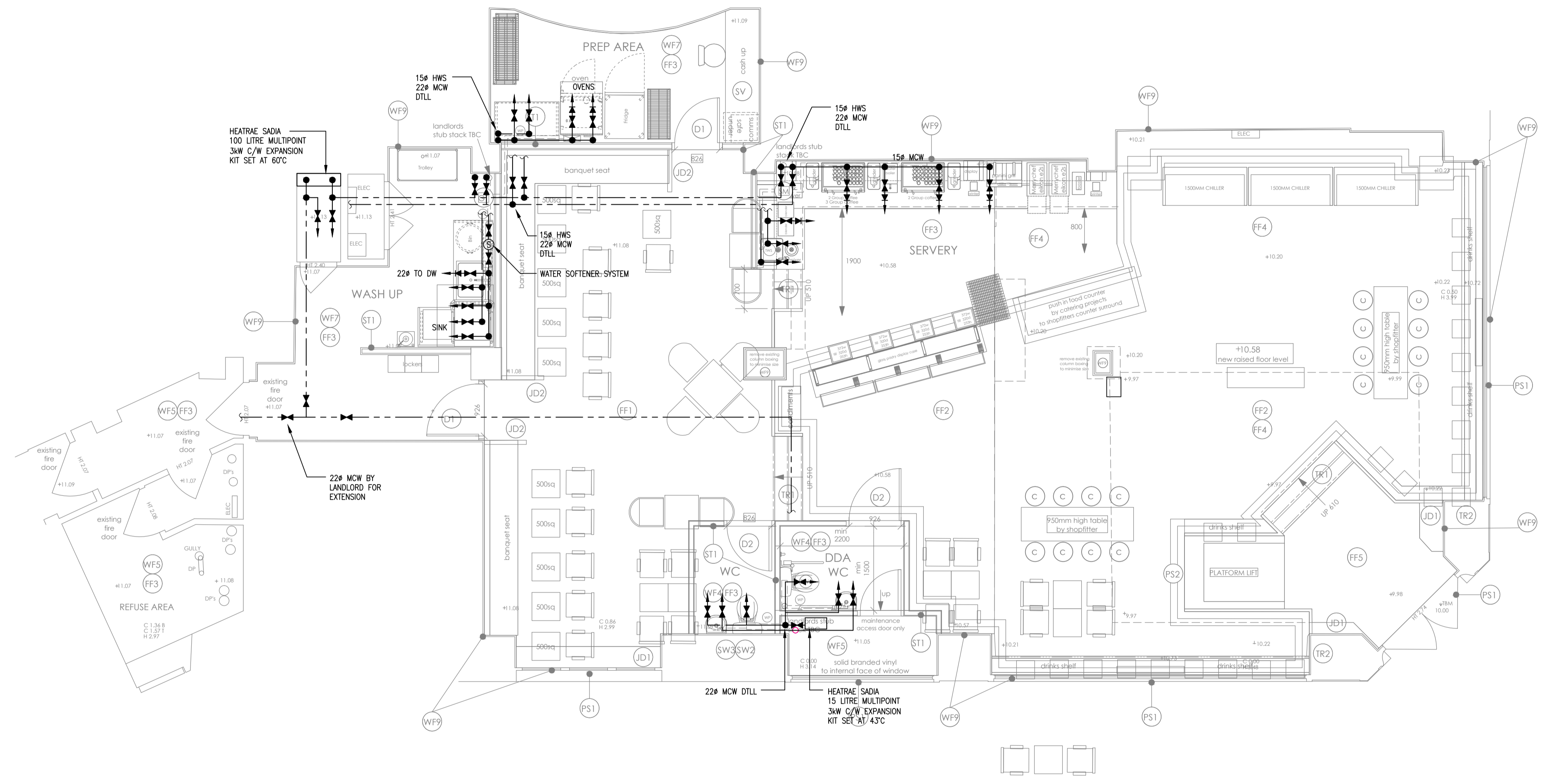

P1	PRELIMINARY ISSUE	PLR	PH	03.04.17
REV	DESCRIPTION	DWN	CHK'D	DATE

STATUS
PRELIMINARY ISSUE

THIS DRAWING IS CONFIDENTIAL AND MUST NOT BE DISCLOSED TO THIRD PARTIES, REPRODUCED OR USED, OR THE CONTENT THEREON COPIED OR REPRODUCED WITHOUT THE WRITTEN CONSENT OF VIRIDIAN CONSULTING ENGINEERS LTD.

DWN	DATE	CHK'D	DATE	APP'D	DATE	SCALE
						1:50

CLIENT
SOHO COFFEE CO

PROJECT
**SOHO COFFEE CO
 65 KINGS WAY
 LONDON**

TITLE
PROPOSED WATER SERVICES LAYOUT



Lloyds House
 18 Lloyd Street
 Manchester M2 5WA
 Tel: 0161 478 6256 Email: general@viridian-consulting.co.uk

DRAWING No.	V1694(53)001	REV	P1
-------------	---------------------	-----	-----------