

Location Door Ref	KH_LEVEL LG																		
Door Ref	KH-D-LG-01	KH-D-LG-02	KH-D-LG-03	KH-D-LG-04	KH-D-LG-05	KH-D-LG-06	KH-D-LG-07	KH-D-LG-08	KH-D-LG-09	KH-D-LG-10	KH-D-LG-11	KH-D-LG-12	KH-D-LG-13	KH-D-LG-14	KH-D-LG-15	KH-D-LG-16	KH-D-LG-17	KH-D-LG-18	KH-D-LG-19
Nominal leaf size W x H (excluding undercut)	820x2,120	838x2,120	820x2,120	820x2,120	820x2,120	820x2,120	820x2,120	1,354x2,072	762x2,120	762x1,981	762x1,981	762x1,981	762x1,981	762x1,981	820x2,120	820x2,120	820x2,120	1,372x2,400	820x2,120
Elevation																			
Fire Rating	FD20	Zero	FD30s	FD30s	FD20	FD20	FD20	FD20	FD30s	FD20	FD20	FD20	FD20	FD20	Zero	FD20	Zero	FD20	FD20
Status	New Door, existing opening	Existing Door	New Door, existing opening	New Door, existing opening	New Door	Existing Door	Existing Door	New Door	New Door	New Door, existing opening	New Door, existing opening	New Door, existing opening	New Door, existing opening	New Door, existing opening	Existing Door	New Door, existing opening	Existing Door	New Door, existing opening	New Door, existing opening
Glazing	N/A	N/A	N/A	N/A	N/A	N/A	N/A	N/A	N/A	N/A	Single Glazed	Single Glazed	Single Glazed	Single Glazed	N/A	N/A	N/A	Single Glazed	N/A
Description	Timber 4 paneled door	Timber 4 paneled door	Timber 4 paneled door by Ahmarra - Chatsworth 4A	Timber 4 paneled door by Ahmarra - Chatsworth 4A	Timber 4 paneled door by Ahmarra - Chatsworth 4A	Timber 4 paneled door	Timber 4 paneled door	2 paneled door with glazing section each. Glazing bars and pane configuration to match existing.	Timber 4 paneled door by Ahmarra - Chatsworth 4A	Top arched timber door	Top arched timber door with glazed panel. Glazing bars and pane configuration to match existing.	Top arched timber door with glazed panel. Glazing bars and pane configuration to match existing.	Top arched timber door with glazed panel. Glazing bars and pane configuration to match existing.	Top arched timber door with glazed panel. Glazing bars and pane configuration to match existing.	Timber 4 paneled door	Timber 4 paneled door by Ahmarra - Chatsworth 4A	Timber 4 paneled door	Top arched timber double door with glazed panel. Glazing bars and pane configuration to match existing.	Timber 4 paneled door by Ahmarra - Chatsworth 4A
Proposed Approach	New frame, leaf and architrave	Completely refurbish and repair existing Door. New frame and architrave	New frame, leaf and architrave	New frame, leaf and architrave	N/A	Completely refurbish and repair existing Door. New frame and architrave	Completely refurbish and repair existing Door. New frame and architrave	N/A	N/A	New frame, leaf and architrave	New frame, leaf and architrave	New frame, leaf and architrave	New frame, leaf and architrave	New frame, leaf and architrave	Completely refurbish and repair existing Door. New frame and architrave	N/A	Completely refurbish and repair existing Door. New frame and architrave	N/A	New frame, leaf and architrave
Ironmongery	New ironmongery to match in style throughout the building.	Existing ironmongery to be replaced with new similar in style throughout the building.	New ironmongery to match in style throughout the building.	New ironmongery to match in style throughout the building.	New ironmongery to match in style throughout the building.	Existing ironmongery to be replaced with new similar in style throughout the building.	Existing ironmongery to be replaced with new similar in style throughout the building.	New ironmongery to match in style throughout the building.	New ironmongery to match in style throughout the building.	New ironmongery to match in style throughout the building.	New ironmongery to match in style throughout the building.	New ironmongery to match in style throughout the building.	New ironmongery to match in style throughout the building.	New ironmongery to match in style throughout the building.	Existing ironmongery to be replaced with new similar in style throughout the building.	New ironmongery to match in style throughout the building.	Existing ironmongery to be replaced with new similar in style throughout the building.	New ironmongery to match in style throughout the building.	New ironmongery to match in style throughout the building.

Location Door Ref	KH_LEVEL UG																	
Door Ref	KH-D-UG-01	KH-D-UG-02	KH-D-UG-03	KH-D-UG-04	KH-D-UG-05	KH-D-UG-06	KH-D-UG-07	KH-D-UG-08	KH-D-UG-09	KH-D-UG-10	KH-D-UG-11	KH-D-UG-13	KH-D-UG-14	KH-D-UG-15	KH-D-UG-16	KH-D-UG-17		
Nominal leaf size W x H (excluding undercut)	1,280x2,400	875x2,410	1,200x2,410	875x2,410	901x2,410	786x2,410	762x2,410	915x2,410	1,985x3,020	1,985x3,020	785x2,410	785x2,410	875x2,410	875x2,410	1,015x2,420	825x2,410		
Elevation																		
Fire Rating	FD20	FD20	FD30s	FD20	FD30s - false door	FD30s - false door	Zero	FD30s - false door	FD20	FD20	FD20	FD20	FD20	FD20	Zero	N/A - existing	FD20	
Status	Existing Door	Existing Door	New Door, existing opening	New Door	Existing Door	Existing Door	New Door	Existing Door Handled	Existing Door	Existing Door	New Door	Existing Door Relocated	Existing Door	Existing Door Relocated	Existing Door Relocated	Existing Door Relocated	Existing Door Flipped	
Glazing	Single Glazed	N/A	N/A	N/A	N/A	N/A	N/A	N/A	N/A	N/A	Single Glazed	N/A	N/A	N/A	N/A	N/A	N/A	
Description	2 paneled door with glazing section each.	Timber 4 paneled door	Timber 4 paneled door by Ahmarra - Chatsworth 4A	Timber 4 paneled door by Ahmarra - Chatsworth 4A	Timber 4 paneled door with decorative architrave to Hall Side. Existing Door to be blocked off	Timber 4 paneled door with decorative architrave to Hall Side. Existing Door to be blocked off	Timber 4 paneled door by Ahmarra - Chatsworth 4A. Architraves to match existing in style	Timber 4 paneled door. Door forms part of decorative room paneling which includes fake door.	Timber 4 paneled double door. have decorated architraves and classical crosshead.	Timber 4 paneled double door. have decorated architraves and classical crosshead.	Timber, glazed door. Glazing bars and pane configuration to match existing in style.	Timber 4 paneled door with decorative architrave.	Timber 4 paneled door with decorative architrave.	Timber 4 paneled door with decorative architrave.	Timber 4 paneled door with decorative architrave.	Timber 4 paneled door with decorative architrave.	Timber 4 paneled door with decorative architrave.	
Proposed Approach	Completely refurbish and repair existing Door, Frame and Architrave.	Completely refurbish and repair existing Door, Frame and Architrave.	N/A	Completely refurbish and repair existing Door, Frame and Architrave.	Completely refurbish and repair existing Door, Frame and Architrave.	Completely refurbish and repair existing Door, Frame and Architrave.	N/A	Completely refurbish and repair existing Door, Frame and Architrave.	Completely refurbish and repair existing Door, Frame and Architrave.	Completely refurbish and repair existing Door, Frame and Architrave.	Timber door with glazed panel. Glazing bars and pane configuration to match existing.	Completely refurbish and repair existing Door, Frame and Architrave.	Completely refurbish and repair existing Door, Frame and Architrave.	Completely refurbish and repair existing Door, Frame and Architrave.	Completely refurbish and repair existing Door, Frame and Architrave.	Completely refurbish and repair existing Door, Frame and Architrave.	Completely refurbish and repair existing Door, Frame and Architrave.	
Ironmongery	Existing ironmongery to be replaced with new similar in style throughout the building.	Existing ironmongery to be replaced with new similar in style throughout the building.	New ironmongery to match in style throughout the building.	New ironmongery to match in style throughout the building.	Existing ironmongery to be replaced with new similar in style throughout the building.	Existing ironmongery to be replaced with new similar in style throughout the building.	New ironmongery to match in style throughout the building.	Existing ironmongery to be replaced with new similar in style throughout the building.	Existing ironmongery to be replaced with new similar in style throughout the building.	Existing ironmongery to be replaced with new similar in style throughout the building.	New ironmongery to match in style throughout the building.	Existing ironmongery to be replaced with new similar in style throughout the building.	Existing ironmongery to be replaced with new similar in style throughout the building.	Existing ironmongery to be replaced with new similar in style throughout the building.	Existing ironmongery to be replaced with new similar in style throughout the building.	Existing ironmongery to be replaced with new similar in style throughout the building.	Existing ironmongery to be replaced with new similar in style throughout the building.	

Location Door Ref	KH_LEVEL UG				
Door Ref	KH-D-UG-18	KH-D-UG-19	KH-D-UG-20	KH-D-UG-21	KH-IW-UG-12
Nominal leaf size W x H (excluding undercut)	860x2,410	917x2,410	850x2,410	927x2,410	785x2,410
Elevation					
Fire Rating	FD20 - false door	FD30s - false door	Zero	FD30s - false door	FD20
Status	Existing Door	Existing Door	New Door	Existing Door	New Fixed Window
Glazing	N/A	N/A	N/A	N/A	Single Glazed
Description	Timber 4 paneled door by Ahmarra - Chatsworth 4A. Fixed door	Timber 4 paneled door with decorative architrave. Fixed door	Single leaf, Enigma pocket sliding door by Selo. Architraves to match existing in style.	Timber 4 paneled door with decorative architrave. Fixed door	Timber, glazed fixed window. Glazing bars and pane configuration to match existing in style.
Proposed Approach	Completely refurbish and repair existing Door, Frame and Architrave.	Completely refurbish and repair existing Door, Frame and Architrave.	N/A	Completely refurbish and repair existing Door, Frame and Architrave.	Timber door with glazed panel. Glazing bars and pane configuration to match existing.
Ironmongery	Existing ironmongery to be replaced with new similar in style throughout the building.	Existing ironmongery to be replaced with new similar in style throughout the building.	New ironmongery to match in style throughout the building.	Existing ironmongery to be replaced with new similar in style throughout the building.	N/A

INTERNAL DOOR NOTES:

All Doors CONTRACTORS, SUB-CONTRACTORS AND MANUFACTURERS TO ENSURE THAT ALL MATERIALS AND COMPONENTS ARE SUITABLE FOR THEIR INTENDED PURPOSE AND LOCATION; DESIGNED, MANUFACTURED AND INSTALLED IN ACCORDANCE WITH ALL RELEVANT CURRENT BRITISH STANDARDS, CODES OF PRACTICE, AND MANUFACTURER'S SPECIFICATIONS.

Any reference to an Approved Document in this Specification relates to the relevant Approved Document of the Building Regulations.

All door leaf sizes shown exclude undercuts and packing zones.

ALL existing and proposed structural openings, frames, door leafs and associated structures (ceilings, stairs, etc) to be confirmed on site prior to manufacture.

For door handing, refer to GA Plans.

Sliding Doors
Scheduled sliding door widths and height are shown as the visible width only. Manufacturer to advise on actual width and height required. Sliding door gear, pockets and jambs to be confirmed and sized prior to manufacture to ensure structural openings are adequate

Fire Doors
All FD30s doors to receive smoke seals and intumescent strips.

All fire door sets to meet all requirements of BS 5588. Fire door sets to tested to meet BS 476-22 or BS EN4967 and supplied with product conformity certificates.

Door linings, stops, vision panels, cold smoke seals (denoted by the 's' suffix) etc., all to meet doors manufacturers standard fire tested details to achieve fire ratings as noted.

Door schedules to be read in conjunction with relevant joinery details.

* For ALL apartment doors, refer to Fire Drawings

Ironmongery
All ironmongery TBC.

Plant room doors to meet BS 3621 and engineers requirements.

Cycle store doors to have PAS 24 doors (or LPS 175 Security 2) and fob access.

Door Finishes:
Refer to finishes schedule.

NOTE: Existing opening sizes to be confirmed on site and new door sizes to be set (to suit opening size) and agreed prior to manufacture.

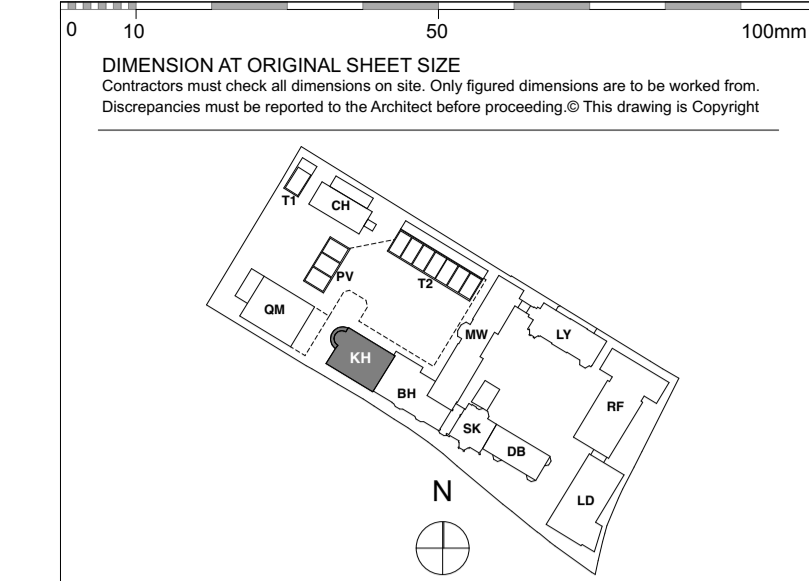

KEY PLAN

NOTE: ALL DIMENSIONS ARE FOR GUIDELINES ONLY - ALL DIMENSIONS TO BE CHECKED ON SITE PRIOR MANUFACTURING

FOR CONSTRUCTION

REVISION	DRN	CHKD	DATE
C1 Issued for Construction	MRR	TW	17/01/2017
C2 Revised to Conservation Officer's Comments	KFC	KC	10/02/2017



CLIENT
MOUNT ANVIL LTD



PROJECT
KIDDERPORE AVENUE

DRAWING
Kidderpore Hall
Internal Windows And Doors Schedule Sheet 1 of 2

SCALE NTS @ A1 DATE February 2017

DRAWING No. 15 230
9000-SCH-KH-005
DRAWN BY GC
REV C2

A & Q PARTNERSHIP (LONDON) LTD
THE LUX BUILDING, 2-4 HOXTON SQUARE, LONDON N1 6 NU
Tel: 020 7613 2244 Fax: 020 7613 2642 Email: london@a&q.co.uk
ARCHITECTURE DESIGN MASTERPLANNING INTERIORS