

Location	MW Level 1							MW_Level 02										
Door / Window Reference	MW-W-01-38	MW-W-01-39	MW-W-01-40	MW-W-01-41	MW-W-01-42	MW-W-01-43	MW-W-01-44	MW-ED-02-017	MW-W-02-02	MW-W-02-03	MW-W-02-04	MW-W-02-05	MW-W-02-06	MW-W-02-07	MW-W-02-08	MW-W-02-09	MW-W-02-10	
H+R Reference	MH-1-W29	MH-1-W28	MH-1-W27	MH-1-W26	MH-1-W25	MH-1-W24	MH-1-W30	N/A	MH-2-W17	MH-2-W16/W15	MH-2-W14	MH-2-W13	MH-2-W12	MH-2-W11	MH-2-W10	MH-2-W9	MH-2-W8	
Approx W x H Size	1,195x1,915	1,195x1,915	1,195x1,915	1,195x1,915	1,195x1,915	1,195x1,915	1,195x1,915	1,500x2,100	1,800x1,200	2,200x1,050	1,800x1,200	450x300	630x1,695	1,150x1,695	1,045x1,695	1,045x1,695	1,150x1,695	
Elevation																		
Status	Existing Window	Existing Window	Existing Window	Existing Window	Existing Window	Existing Window	Existing Window	New Double Door	Existing Window	Replacement Window	Existing Window	Existing Window	Existing Window	Existing Window	Existing Window	Existing Window	Existing Window	
Glazing	Single Glazing	Single Glazing	Translucent Single Glazing	Single Glazing	Single Glazing	Single Glazing	Single Glazing	Single Glazing	Single Glazing	Single Glazing	Single Glazing	Single Glazing	Single Glazing	Translucent Single Glazing	Translucent Single Glazing	Single Glazing	Single Glazing	
Glazing Bar Reference	Existing	Existing	Existing	Existing	Existing	Existing	Existing	GB8	Existing	GB8	Existing	Existing	Existing	Existing	Existing	Existing	Existing	
External Frame Colour	White	White	White	White	White	White	White	White	White	White	White	White	White	White	White	White	White	
Description	6 over 6 pane sliding timber sash.	6 over 6 pane sliding timber sash.	6 over 6 pane sliding timber sash.	6 over 6 pane sliding timber sash.	6 over 6 pane sliding timber sash.	6 over 6 pane sliding timber sash.	6 over 6 pane sliding timber sash.	2no paneled Timber Double door. 6 panes each	Venetian window with flanking side hung casements, 17 panes in total.	Pair of twin 6 pane side hung casements.	Venetian window with flanking side hung casements, 17 panes in total.	2 pane fixed casement	2 over 2 pane sliding timber sash.	6 over 6 pane sliding timber sash.	6 over 6 pane sliding timber sash.	6 over 6 pane sliding timber sash.	6 over 6 pane sliding timber sash.	
Proposed Approach / Rationale for new or replacement	Completely refurbish and repair existing window, including incorporating draught stripping. Window to be eased. Broken bead to be replaced.	Completely refurbish and repair existing window, including incorporating draught stripping. Window to be eased.	Completely refurbish and repair existing window, including incorporating draught stripping. Window to be eased.	Completely refurbish and repair existing window, including incorporating draught stripping. Window to be eased.	Completely refurbish and repair existing window, including incorporating draught stripping. Window to be eased.	Completely refurbish and repair existing window, including incorporating draught stripping. Window to be eased.	Completely refurbish and repair existing window, including incorporating draught stripping. Window to be eased.	Non-original door replaced with new door with period features.	Completely refurbish and repair existing window, including incorporating draught stripping. Window to be eased. Replace broken mullion to match existing.	Entire existing unit to be replaced to match existing. Existing unit delapidated.	Completely refurbish and repair existing window, including incorporating draught stripping. Left casement to be replaced to match existing. Broken pane to be replaced.	Completely refurbish and repair existing window, including incorporating draught stripping.	Completely refurbish and repair existing window, including incorporating draught stripping. Window to be eased.	Completely refurbish and repair existing window, including incorporating draught stripping. Window to be eased.	Completely refurbish and repair existing window, including incorporating draught stripping. Window to be eased.	Completely refurbish and repair existing window, including incorporating draught stripping. Window to be eased.	Completely refurbish and repair existing window, including incorporating draught stripping. Window to be eased.	Completely refurbish and repair existing window, including incorporating draught stripping. Window to be eased. Obscure glazing to be replaced with clear glass.
Ironmongery	Existing ironmongery to be replaced with new to match existing in style. Additional latches to be installed.	Existing ironmongery to be replaced with new to match existing in style. Additional latches to be installed.	Existing ironmongery to be replaced with new to match existing in style. Additional latches to be installed.	Existing ironmongery to be replaced with new to match existing in style. Additional latches to be installed.	Existing ironmongery to be replaced with new to match existing in style. Additional latches to be installed.	Existing ironmongery to be replaced with new to match existing in style. Additional latches to be installed.	Existing ironmongery to be replaced with new to match existing in style. Additional latches to be installed.	New Ironmongery to match existing in style	Existing ironmongery to be replaced with new to match existing in style. Additional latches to be installed.	New ironmongery to match existing in style.	Existing ironmongery to be replaced with new to match existing in style. Additional latches to be installed.	Existing ironmongery to be replaced with new to match existing in style. Additional latches to be installed.	Existing ironmongery to be replaced with new to match existing in style. Additional latches to be installed.	Existing ironmongery to be replaced with new to match existing in style. Additional latches to be installed.	Existing ironmongery to be replaced with new to match existing in style. Additional latches to be installed.	Existing ironmongery to be replaced with new to match existing in style. Additional latches to be installed.	Existing ironmongery to be replaced with new to match existing in style. Additional latches to be installed.	Existing ironmongery to be replaced with new to match existing in style. Additional latches to be installed.

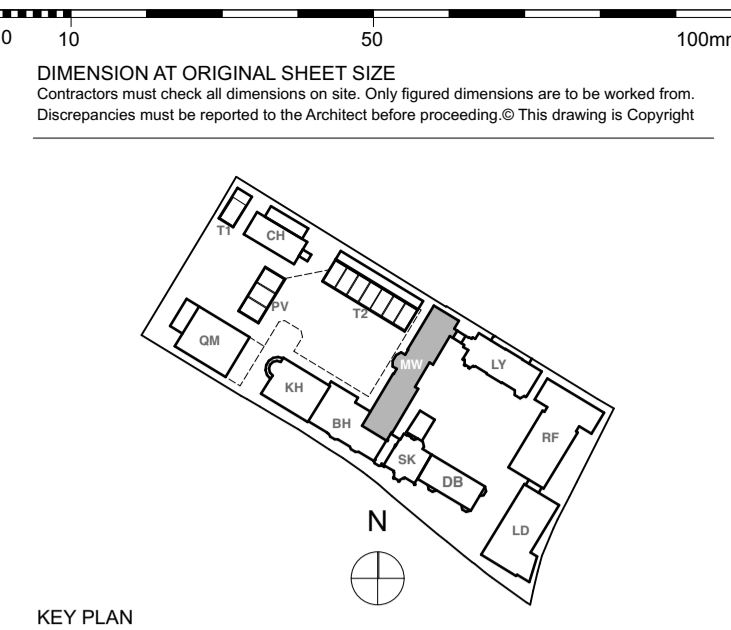

KEY PLAN

NOTE:

ALL DIMENSIONS ARE FOR GUIDELINES ONLY - ALL DIMENSIONS TO BE CHECKED ON SITE PRIOR TO MANUFACTURING

TO BE READ IN CONJUNCTION WITH HUTTON + ROSTRON WINDOW CONDITION SURVEYS WHERE APPLICABLE.

ALL ADDITIONAL IRONMONGERY TO BE AGREED WITH THE ARCHITECT PRIOR TO INSTALLATION

Note:

All new and replacement window and door shop drawings are to be reviewed and approved by the architect prior to manufacture.

Key:

References in red apply to the surrounding masonry conditions of doors and windows:

H1 - Head Detail reference

J2 - Jamb detail reference

TS/SD1 - Sill Detail Reference

Ex - Existing condition

Details for individual door and window frames, glazing bars, mouldings, stiles, etc., where not shown in the details above, are annotated in blue:

HD1 - Door / window component detail reference

Refer to: drawings 9000-DRG-00GN-DE047 to 9000-DRG-00GN-DE048 for details outlined above.

Glazing

Any 'new' glazing panels below 800mm in windows or 1200mm in glazed doors or screens within 300mm of doors, will need to be able to break safely on impact.

FOR CONSTRUCTION

REVISION	DRN	CHKD	DATE
C1 Issued for Construction Reference Added/Revised Opening size Added/Revised Glazing bar references Added/Revised Head/Jamb/Sill detail references Added/Revised	MRR	TW	17/02/2017
C2 Revised Annotations Added/Revised	MRR	TW	10/03/2017
C3 Annotations Added/Revised	KFC	TW	03/04/2017

Location	MW Level 2																	
Door / Window Reference	MW-W-02-11	MW-W-02-12	MW-W-02-13	MW-W-02-14	MW-W-02-15	MW-W-02-16	MW-W-02-18	MW-W-02-19	MW-W-02-20	MW-W-02-21	MW-W-02-22	MW-W-02-23	MW-W-02-24	MW-W-02-25	MW-W-02-26	MW-W-02-27	MW-W-02-28	MW-W-02-29
H+R Reference	MH-2-W7	MH-2-W6	MH-2-W5	MH-2-W4/W3	MH-2-W2	MH-2-W1	MH-2-W33	MH-2-W32	MH-2-W31/W30	MH-2-W29	MH-2-W28	MH-3-W5	MH-2-W27	MH-2-W26	MH-2-W25	MH-2-W24	MH-2-W23	MH-2-W22
Approx W x H Size	630x1,695	450x300	1,800x1,200	2,200x1,050	1,800x1,200	600x475	600x475	1,625x1,050	2,200x1,050	1,625x1,050	525x550	1,195x1,915	1,195x1,715	1,045x1,715	1,045x1,715	1,195x1,715	1,195x1,715	525x550
Elevation																		
Status	Existing Window	Existing Window	Existing Window	Replacement	Existing Window	Existing Window	Existing Window	Replacement Existing Window	Replacement Existing window	Existing window	Existing Window	Existing Window	Existing Window	Existing Window	Existing Window	Existing Window	Existing Window	Existing Window
Glazing	Translucent Single Glazing	Single Glazing	Single Glazing	Single Glazing	Single Glazing	Single Glazing	Back Painted Single Glazing	Single Glazing	Single Glazing	Single Glazing	Back Painted Single Glazing	Single Glazing	Single Glazing	Single Glazing	Single Glazing	Single Glazing	Single Glazing	Back Painted Single Glazing
Glazing Bar Reference	Existing	Existing	Existing	GB8	Existing	Existing	Existing	GB8	GB8	Existing	Existing	Existing	Existing	Existing	Existing	Existing	Existing	Existing
External Frame Colour	White	White	White	White	White	White	White	White	White	White	White	White	White	White	White	White	White	White
Description	2 over 2 pane sliding timber sash.	2 pane fixed casement	Venetian window with flanking side hung casements, 17 panes in total.	Pair of twin 6 pane side hung casements.	Venetian window with flanking side hung casements, 17 panes in total.	2 pane fixed casement	2 pane fixed casement	Triple 6 pane casements, alternating fixed and side hung.	Pair of twin 6 pane side hung casements.	Triple 6 pane casements, alternating fixed and side hung.	2 pane fixed casement	6 over 6 pane sliding timber sash. To Serve as an OV.	6 over 6 pane sliding timber sash.	6 over 6 pane sliding timber sash.	6 over 6 pane sliding timber sash.	6 over 6 pane sliding timber sash.	6 over 6 pane sliding timber sash.	2 pane fixed casement.
Proposed Approach / Rationale for new or replacement	Completely refurbish and repair existing window, including incorporating draught stripping. Window to be eased.	Completely refurbish and repair existing window, including incorporating draught stripping.	Completely refurbish and repair existing window, including incorporating draught stripping. Window to be eased. Broken casement to be replaced to match existing.	Entire existing unit to be replaced to match existing. Existing unit delapidated.	Completely refurbish and repair existing window, including incorporating draught stripping. Window to be eased.	Completely refurbish and repair existing window, including incorporating draught stripping.	Completely refurbish and repair existing window, including incorporating draught stripping.	Entire existing unit to be replaced to match existing. Existing unit delapidated.	Entire existing unit to be replaced to match existing. Existing unit delapidated. Mid Mullion to be thickened to accommodate for party wall behind.	Completely refurbish and repair existing window, including incorporating draught stripping. Cill to be replaced to match existing.	Completely refurbish and repair existing window, including incorporating draught stripping.	Completely refurbish and repair existing window, including incorporating draught stripping. Window to be eased. Actuator to be installed.	Completely refurbish and repair existing window, including incorporating draught stripping. Window to be eased.	Completely refurbish and repair existing window, including incorporating draught stripping. Broken glazing bars to match existing.	Completely refurbish and repair existing window, including incorporating draught stripping. Damaged frame to be replaced.	Completely refurbish and repair existing window, including incorporating draught stripping. Window to be eased.	Completely refurbish and repair existing window, including incorporating draught stripping. Window to be eased.	Completely refurbish and repair existing window, including incorporating draught stripping.
Ironmongery	Existing ironmongery to be replaced with new to match existing in style. Additional latches to be installed.	N/A	Existing ironmongery to be replaced with new to match existing in style. Additional latches to be installed.	New ironmongery to match existing in style.	Existing ironmongery to be replaced with new to match existing in style. Additional latches to be installed.	N/A	N/A	New ironmongery to match existing in style.	New ironmongery to match existing in style.	New ironmongery to match existing in style.	N/A	Existing ironmongery to be replaced with new to match existing in style. Additional latches to be installed.	Existing ironmongery to be replaced with new to match existing in style. Additional latches to be installed.	Existing ironmongery to be replaced with new to match existing in style. Additional latches to be installed.	Existing ironmongery to be replaced with new to match existing in style. Additional latches to be installed.	Existing ironmongery to be replaced with new to match existing in style. Additional latches to be installed.	Existing ironmongery to be replaced with new to match existing in style. Additional latches to be installed.	N/A



PROJECT
KIDDEPORE AVENUE

DRAWING
Maynard Wing
External Windows And Doors Schedule Sheet 4 of 5

SCALE NTS @ A1 DATE

DRAWING No. 15 230
9000-SCH-MW-004

DRAWN BY KFC
REV C3

A & Q PARTNERSHIP (LONDON) LTD
THE LUX BUILDING, 2-4 HOXTON SQUARE, LONDON N1 6 NU
Tel: 020 7613 2244 Fax: 020 7613 2642 Email: london@aqp.co.uk
ARCHITECTURE DESIGN MASTERPLANNING INTERIORS