

Location	MW_Level 01																		
Door / Window Reference	MW-ED-01-01	MW-W-01-01	MW-W-01-02	MW-W-01-03	MW-W-01-04	MW-W-01-05	MW-W-01-06	MW-W-01-07	MW-W-01-08	MW-W-01-09	MW-W-01-10	MW-W-01-11	MW-W-01-12	MW-W-01-13	MW-W-01-14	MW-W-01-15	MW-W-01-16	MW-W-01-17	MW-W-01-18
H+R Reference	N/A	MH-1-W22	MH-1-W21	MH-1-W20	MH-1-W19	MH-1-W18	MH-1-W17	MH-1-W16	MH-1-W15	MH-1-W14	MH-1-W13	MH-1-W12	MH-1-W11	MH-1-W10	MH-1-W9	MH-1-W8	MH-1-W7	MH-1-W6	MH-1-W5
Approx W x H Size	1,750x2,100	1,195x1,915	1,195x1,915	1,195x1,915	1,195x1,915	1,195x1,915	1,195x1,915	1,195x1,915	1,195x1,915	600x1,915	1,150x1,915	1,025x1,775	1,025x1,775	1,150x1,915	600x1,915	1,195x1,915	1,195x1,915	1,195x1,915	1,195x1,915
Elevation																			
Status	Existing Door	Existing Window	Existing Window	Existing Window	Existing Window	Existing Window	Existing Window	Existing Window	Existing Window	Existing Window	Existing Window	Existing Window	Existing Window	Existing Window	Existing Window	Existing Window	Existing Window	Existing Window	Existing Window
Glazing	Single Glazing	Single Glazing	Single Glazing	Translucent Single Glazing	Single Glazing	Translucent Single Glazing	Single Glazing	Single Glazing	Single Glazing	Translucent Single Glazing	Translucent Single Glazing	Single Glazing	Single Glazing	Single Glazing	Single Glazing	Single Glazing	Single Glazing	Single Glazing	Single Glazing
Glazing Bar Reference	Existing	Existing	Existing	Existing	Existing	Existing	Existing	Existing	Existing	Existing	Existing	Existing	Existing	Existing	Existing	Existing	Existing	Existing	Existing
External Frame Colour	White	White	White	White	White	White	White	White	White	White	White	White	White	White	White	White	White	White	White
Description	Timber 4 no panes door. Timber side hung casement window to each side. 4 panes each.	6 over 6 pane sliding timber sash.	6 over 6 pane sliding timber sash.	6 over 6 pane sliding timber sash.	6 over 6 pane sliding timber sash.	6 over 6 pane sliding timber sash.	6 over 6 pane sliding timber sash.	6 over 6 pane sliding timber sash.	6 over 6 pane sliding timber sash.	6 over 6 pane sliding timber sash.	2 over 2 pane sliding timber sash.	6 over 6 pane sliding timber sash.	6 over 6 pane sliding timber sash.	6 over 6 pane sliding timber sash.	2 over 2 pane sliding timber sash.	6 over 6 pane sliding timber sash.	6 over 6 pane sliding timber sash.	6 over 6 pane sliding timber sash.	6 over 6 pane sliding timber sash.
Proposed Approach / Rationale for new or replacement	Completely refurbish and repair existing door, including incorporating draught stripping. Door to be eased.	Completely refurbish and repair existing window, including incorporating draught stripping. Window to be eased. Broken bead to be replaced to match existing.	Completely refurbish and repair existing window, including incorporating draught stripping. Window to be eased.	Completely refurbish and repair existing window, including incorporating draught stripping. Window to be eased.	Completely refurbish and repair existing window, including incorporating draught stripping. Window to be eased.	Completely refurbish and repair existing window, including incorporating draught stripping. Broken pane to be replaced.	Completely refurbish and repair existing window, including incorporating draught stripping.	Completely refurbish and repair existing window, including incorporating draught stripping.	Completely refurbish and repair existing window, including incorporating draught stripping.	Completely refurbish and repair existing window, including incorporating draught stripping.	Completely refurbish and repair existing window, including incorporating draught stripping. Window to be eased. Broken pane to be replaced.	Completely refurbish and repair existing window, including incorporating draught stripping.	Completely refurbish and repair existing window, including incorporating draught stripping. Window to be eased.	Completely refurbish and repair existing window, including incorporating draught stripping. Damaged glazing bar to be replaced to match existing.	Completely refurbish and repair existing window, including incorporating draught stripping. Window to be eased. Broken bead to be replaced.	Completely refurbish and repair existing window, including incorporating draught stripping.	Completely refurbish and repair existing window, including incorporating draught stripping.	Completely refurbish and repair existing window, including incorporating draught stripping.	Completely refurbish and repair existing window, including incorporating draught stripping.
Ironmongery	New Ironmongery to match existing in style.	Existing ironmongery to be replaced with new to match existing in style. Additional latches to be installed.	Existing ironmongery to be replaced with new to match existing in style. Additional latches to be installed.	Existing ironmongery to be replaced with new to match existing in style. Additional latches to be installed.	Existing ironmongery to be replaced with new to match existing in style. Additional latches to be installed.	Existing ironmongery to be replaced with new to match existing in style. Additional latches to be installed.	Existing ironmongery to be replaced with new to match existing in style. Additional latches to be installed.	Existing ironmongery to be replaced with new to match existing in style. Additional latches to be installed.	Existing ironmongery to be replaced with new to match existing in style. Additional latches to be installed.	Existing ironmongery to be replaced with new to match existing in style. Additional latches to be installed.	Existing ironmongery to be replaced with new to match existing in style. Additional latches to be installed.	Existing ironmongery to be replaced with new to match existing in style. Additional latches to be installed.	Existing ironmongery to be replaced with new to match existing in style. Additional latches to be installed.	Existing ironmongery to be replaced with new to match existing in style. Additional latches to be installed.	Existing ironmongery to be replaced with new to match existing in style. Additional latches to be installed.	Existing ironmongery to be replaced with new to match existing in style. Additional latches to be installed.	Existing ironmongery to be replaced with new to match existing in style. Additional latches to be installed.	Existing ironmongery to be replaced with new to match existing in style. Additional latches to be installed.	Existing ironmongery to be replaced with new to match existing in style. Additional latches to be installed.

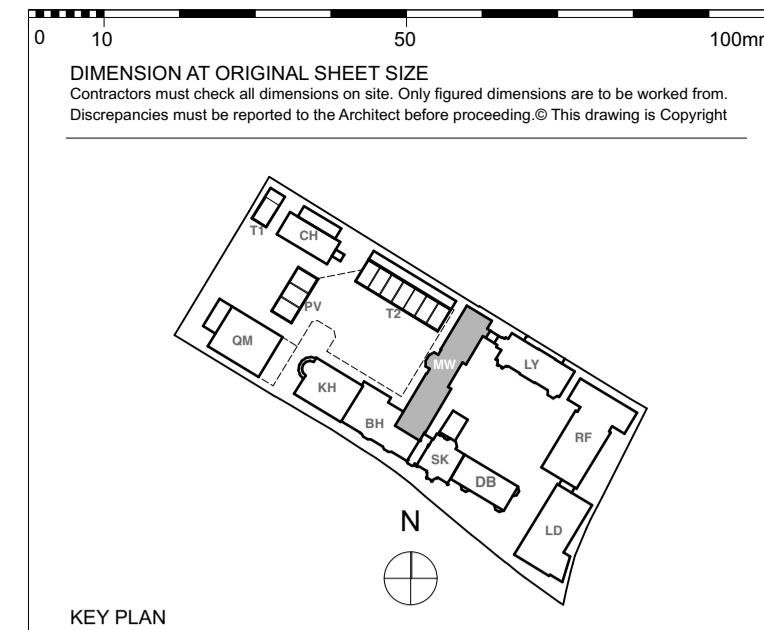

KEY PLAN

NOTE:
ALL DIMENSIONS ARE FOR GUIDELINES ONLY - ALL DIMENSIONS TO BE CHECKED ON SITE PRIOR TO MANUFACTURING
TO BE READ IN CONJUNCTION WITH HUTTON + ROSTRON WINDOW CONDITION SURVEYS WHERE APPLICABLE.
ALL ADDITIONAL IRONMONGERY TO BE AGREED WITH THE ARCHITECT PRIOR TO INSTALLATION

Note:
All new and replacement window and door shop drawings are to be reviewed and approved by the architect prior to manufacture.

Key:
References in red apply to the surrounding masonry conditions of doors and windows:
H1 - Head Detail reference
J2 - Jamb detail reference
TS/SD1 - Sill Detail Reference
Ex - Existing condition

Details for individual door and window frames, glazing bars, mouldings, stiles, etc., where not shown in the details above, are annotated in blue:
HD1 - Door / window component detail reference

Refer to: drawings 9000-DRG-00GN-DE047 to 9000-DRG-00GN-DE048 for details outlined above.

Glazing
Any 'new' glazing panels below 800mm in windows or 1200mm in glazed doors or screens within 300mm of doors, will need to be able to break safely on impact.

FOR CONSTRUCTION

REVISION	DRN	CHKD	DATE
C1 Issued for Construction Reference Added/Revised Opening size Added/Revised Glazing bar reference Added/Revised Head/Jamb/Sill detail references Added/Revised	MRR	TW	17/02/2017
C2 Revised Annotations Added/Revised	MRR	TW	10/03/2017
C3 Annotation Added/Revised	KFC	TW	03/04/2017

Location	MW_Level 01																		
Door / Window Reference	MW-W-01-19	MW-W-01-20	MW-W-01-21	MW-W-01-22	MW-W-01-23	MW-W-01-24	MW-W-01-25	MW-W-01-26	MW-W-01-27	MW-W-01-28	MW-W-01-29	MW-W-01-30	MW-W-01-31	MW-W-01-32	MW-W-01-33	MW-W-01-34	MW-W-01-35	MW-W-01-36	MW-W-01-37
H+R Reference	MH-1-W4	MH-1-W3	MH-1-W2	MH-1-W1	N/A	MH-1-W43	MH-1-W42	MH-1-W41	MH-1-W40	MH-1-W39	MH-1-W38	MH-1-W37	MH-1-W36	MH-1-W35	MH-1-W34	MH-1-W33	MH-1-W32	MH-1-W31	MH-1-W30
Approx W x H Size	1,195x1,915	1,195x1,915	1,195x1,915	1,195x1,915	1,200x1,750	1,195x1,915	1,195x1,915	1,195x1,915	1,195x1,915	1,195x1,915	1,195x1,915	1,195x1,915	1,195x1,915	1,195x1,915	1,195x1,915	1,045x1,940	1,045x1,940	1,195x1,915	1,195x1,915
Elevation																			
Status	Existing Window	Existing Window	Existing Window	Existing Window	New Window	Existing Window	Existing Window	Existing Window	Existing Window	Existing Window	Existing Window	Existing Window	Existing Window	Existing Window	Existing Window	Existing Window	Existing Window	Existing Window	Existing Window
Glazing	Single Glazing	Single Glazing	Single Glazing	Single Glazing	Translucent Single Glazing	Single Glazing	Single Glazing	Translucent Single Glazing	Single Glazing	Single Glazing	Translucent Single Glazing	Single Glazing	Single Glazing	Single Glazing	Single Glazing	Single Glazing	Single Glazing	Single Glazing	Single Glazing
Glazing Bar Reference	Existing	Existing	Existing	Existing	GB8	Existing	Existing	Existing	Existing	Existing	Existing	Existing	Existing	Existing	Existing	Existing	Existing	Existing	Existing
External Frame Colour	White	White	White	White	White	White	White	White	White	White	White	White	White	White	White	White	White	White	White
Description	6 over 6 pane sliding timber sash.	6 over 6 pane sliding timber sash.	6 over 6 pane sliding timber sash.	6 over 6 pane sliding timber sash.	6 over 6 pane sliding timber sash.	6 over 6 pane sliding timber sash.	6 over 6 pane sliding timber sash.	6 over 6 pane sliding timber sash.	6 over 6 pane sliding timber sash.	6 over 6 pane sliding timber sash.	6 over 6 pane sliding timber sash.	6 over 6 pane sliding timber sash.	6 over 6 pane sliding timber sash.	6 over 6 pane sliding timber sash.	6 over 6 pane sliding timber sash.	6 over 6 pane sliding timber sash. To serve as an OV.	6 over 6 pane sliding timber sash.	6 over 6 pane sliding timber sash.	6 over 6 pane sliding timber sash.
Proposed Approach / Rationale for new or replacement	Completely refurbish and repair existing window, including incorporating draught stripping. Broken pane to be replaced.	Completely refurbish and repair existing window, including incorporating draught stripping.	Completely refurbish and repair existing window, including incorporating draught stripping.	Completely refurbish and repair existing window, including incorporating draught stripping.	Existing door replaced with window	Completely refurbish and repair existing window, including incorporating draught stripping. Window to be eased. Broken glazing bar to be replaced to match existing.	Completely refurbish and repair existing window, including incorporating draught stripping. Broken pane to be replaced.	Completely refurbish and repair existing window, including incorporating draught stripping. Window to be eased. Broken bead to be replaced.	Completely refurbish and repair existing window, including incorporating draught stripping.	Completely refurbish and repair existing window, including incorporating draught stripping. Window to be eased.	Completely refurbish and repair existing window, including incorporating draught stripping. Damaged corner joint to be fixed.	Completely refurbish and repair existing window, including incorporating draught stripping. Window to be eased.	Completely refurbish and repair existing window, including incorporating draught stripping. Window to be eased.	Completely refurbish and repair existing window, including incorporating draught stripping. Window to be eased. Actuator to be installed.	Completely refurbish and repair existing window, including incorporating draught stripping. Window to be eased. Broken bead to be replaced.	Completely refurbish and repair existing window, including incorporating draught stripping. Damaged corner joints to be replaced. Window to be eased.	Completely refurbish and repair existing window, including incorporating draught stripping. Window to be eased.	Completely refurbish and repair existing window, including incorporating draught stripping. Window to be eased. Broken bead to be replaced.	Completely refurbish and repair existing window, including incorporating draught stripping. Window to be eased.
Ironmongery	Existing ironmongery to be replaced with new to match existing in style. Additional latches to be installed.	Existing ironmongery to be replaced with new to match existing in style. Additional latches to be installed.	Existing ironmongery to be replaced with new to match existing in style. Additional latches to be installed.	Existing ironmongery to be replaced with new to match existing in style. Additional latches to be installed.	New ironmongery to match existing in style.	Existing ironmongery to be replaced with new to match existing in style. Additional latches to be installed.	Existing ironmongery to be replaced with new to match existing in style. Additional latches to be installed.	Existing ironmongery to be replaced with new to match existing in style. Additional latches to be installed.	Existing ironmongery to be replaced with new to match existing in style. Additional latches to be installed.	Existing ironmongery to be replaced with new to match existing in style. Additional latches to be installed.	Existing ironmongery to be replaced with new to match existing in style. Additional latches to be installed.	Existing ironmongery to be replaced with new to match existing in style. Additional latches to be installed.	Existing ironmongery to be replaced with new to match existing in style. Additional latches to be installed.	Existing ironmongery to be replaced with new to match existing in style. Additional latches to be installed.	Existing ironmongery to be replaced with new to match existing in style. Additional latches to be installed.	Existing ironmongery to be replaced with new to match existing in style. Additional latches to be installed.	Existing ironmongery to be replaced with new to match existing in style. Additional latches to be installed.	Existing ironmongery to be replaced with new to match existing in style. Additional latches to be installed.	Existing ironmongery to be replaced with new to match existing in style. Additional latches to be installed.



CLIENT
MOUNT ANVIL LTD

PROJECT
KIDDEPORE AVENUE

DRAWING
Maynard Wing
External Windows And Doors Schedule Sheet 3 of 5

SCALE NTS @ A1 DATE /

DRAWING No. 15 230
9000-SCH-MW-003

DRAWN BY KFC
REV C3

A & Q PARTNERSHIP (LONDON) LTD
THE LUX BUILDING, 2-4 HOXTON SQUARE, LONDON N1 6NU
Tel: 020 7613 2244 Fax: 020 7613 2642 Email: london@aqq.co.uk
ARCHITECTURE DESIGN MASTERPLANNING INTERIORS