

Proposed rear elevation
Outline of fenestration to be removed shown dotted

Scale 1:200 @ A3

Reason for amendment:

The window is proposed to be removed to accommodate a more efficient kitchen layout. See plan extract and 3d image opposite

The kitchen/dining/living room would still benefit from a great deal of sunlight/daylight from the two full height window and large sliding doors on the side elevation

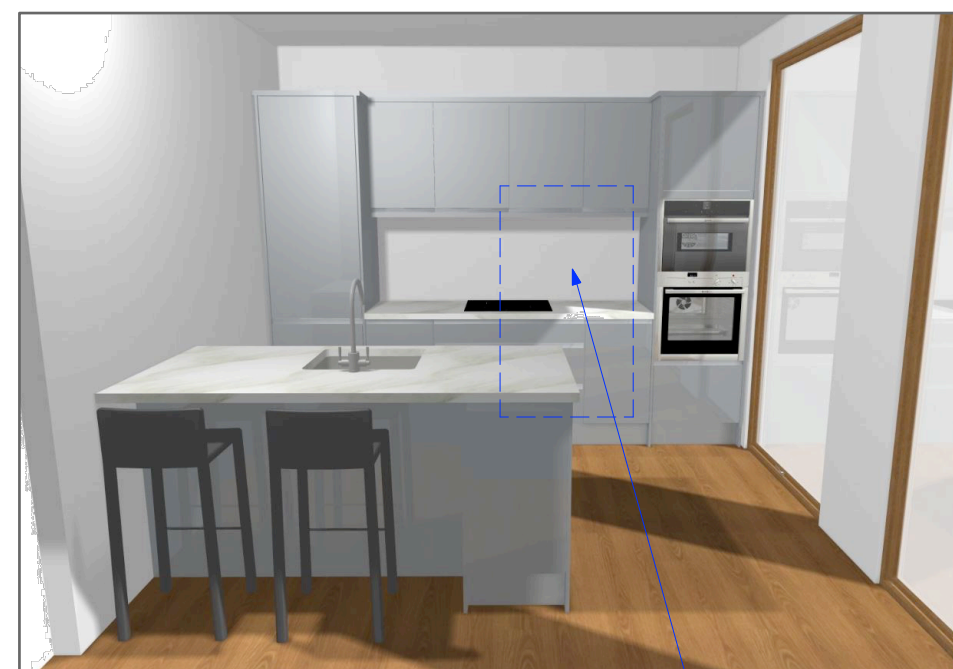

The window (indicatively shown dotted) would prevent the desired kitchen layout

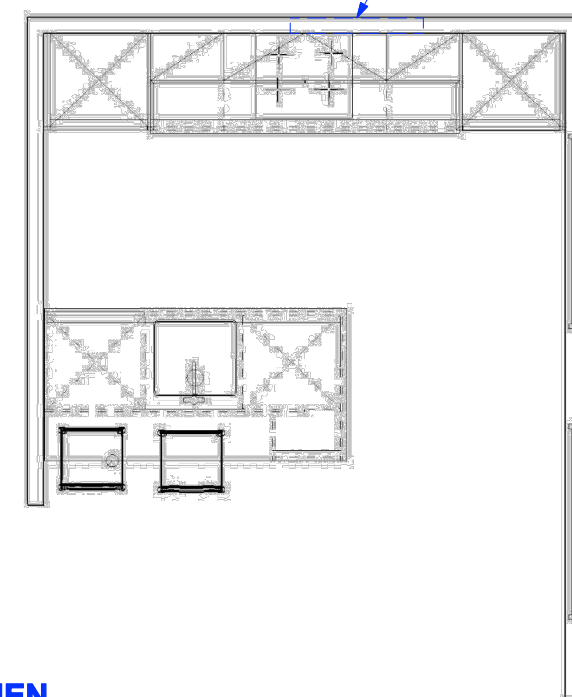

**KITCHEN
 PLAN EXTRACT**

DO NOT SCALE THIS DRAWING WRITTEN DIMENSIONS ONLY TO BE USED ALL DIMENSIONS ARE IN MILLIMETRES ALL DIMENSIONS TO BE VERIFIED ON SITE ANY INCONSISTENCIES TO BE REPORTED TO THE ARCHITECT IMMEDIATELY	Job No 7155		p-ad 192D Compden Hill Road, Notting Hill Gate, London, W8 7TH t: 0208 4590172 e: info@p-ad.co.uk		p-ad	
	FOR CONSTRUCTION					
	87-93 Kingsgate Road, London, NW6 4LA		Title	NMA JUSTIFICATION		
			Drawn by SG	Scale 1:200 @ A3		Number 7155/GA /3.0